



Wall Mount Remote Ballast **MODEL BM4**

120/208/240/277 Volt, 150 Watt Max.

Specifications:

Housing: NEMA Type 3R steel box with screw cover. 18-8 stainless steel hardware. 304 stainless steel mount brackets (Mounting hardware not included).

Electrical: Box constructed with conduit entry knockouts on the bottom for conduit connection and cable entry. (Conduit and cable not included.) Terminal strip allows for fast, easy wiring; as well as choice of input voltages.

Ballast: 60 Hz input, high power factor, magnetic metal halide ballast available in 39W, 70W, 100W, or 150W. Multi-tap (120V, 208V, 240V, 277V) input allows for field wiring to desired voltage. Minimum lamp starting

temperature: -30°C. Maximum remote distance: 50 feet.

Finish: TGIC thermo-set polyester powder coat paint available in 14 standard colors.

Certification: CSA tested & certified to US and Canadian safety standards for wet location wall mount use per UL1598 & CSA C22.2 No. 250-00.

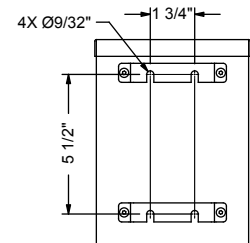
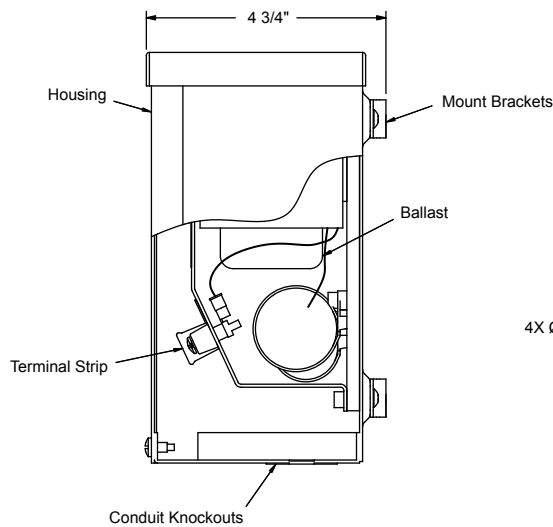
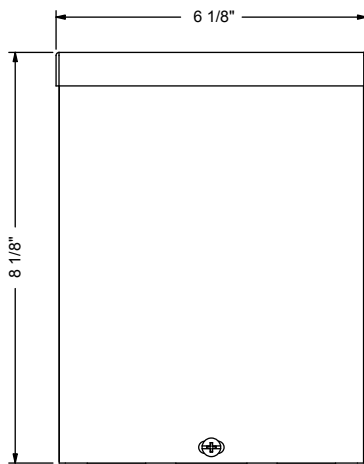

Mount Bracket Detail



Ordering Information:

Fixture Catalog String ^{1,2}	BM4 Model	Finish	M-MH Ballast Type ³	Wattage ³	LR Ignitor
		BL - Black	M-MH - Magnetic Metal Halide	39 - 39 Watts	LR - Long Range
		BLT - Textured Black		70 - 70 Watts	
		BN - Bronze		100 - 100 Watts	
		BNT - Textured Bronze		150 - 150 Watts	
		BAT - Textured Bark			
		WI - White			
		GRT - Textured Green			
		SI - Silver			
		GY - Grey			
		BE - Beige			
		GNT - Textured Granite			
		SAT - Textured Sand			
		PAT - Textured Patina			
		EAT - Textured Earth			

Notes:

- Ballast must be specified with an approved Vision3 Lighting metal halide fixture.
- See fixture submittal for specifications, limitations, and correct catalog number logic.
- Ballast type and wattage must match fixture lamp type
- Specifications, certifications, and ordering information are subject to change. Please check website for latest specification sheets.

Example: *Fixture Catalog String - BM4 - BN - M-MH - 70 - LR*