

Installation Instructions

INSTRUCTIONS PERTAINING TO A RISK OF FIRE, OR INJURY TO PERSONS. IMPORTANT SAFETY INSTRUCTIONS

Warning! To reduce the risk of FIRE OR INJURY TO PERSONS:

1. Do not touch luminaire while lamp is on. Turn off/unplug and allow to cool before replacing lamp.
2. Lamp gets HOT quickly! Contact only switch/plug when turning on.
3. Do not touch hot lens, body, cap, or knuckle.
4. Keep lamp away from materials that may burn.
5. Do not touch lamp at any time. Use a soft cloth. Oil from your skin may damage lamp.
6. Do not operate the luminaire with damaged or missing parts.
7. Do not disassemble luminaire beyond cap removal to facilitate lamp and/or accessory installation or replacement
8. Remove any debris accumulated in the cap periodically.
9. Do not install luminaire within 10 feet of a pool, spa, or fountain.
10. Have fixture installed in accordance with all applicable installation codes and standards by a person familiar with the construction and operation of the fixture and the hazards involved.
11. Use only cable rated for low voltage. Cable buried more than 6" must be suitable for direct burial. Direct burial cable may be ordered from Vision3 Lighting.

SAVE THESE INSTRUCTIONS

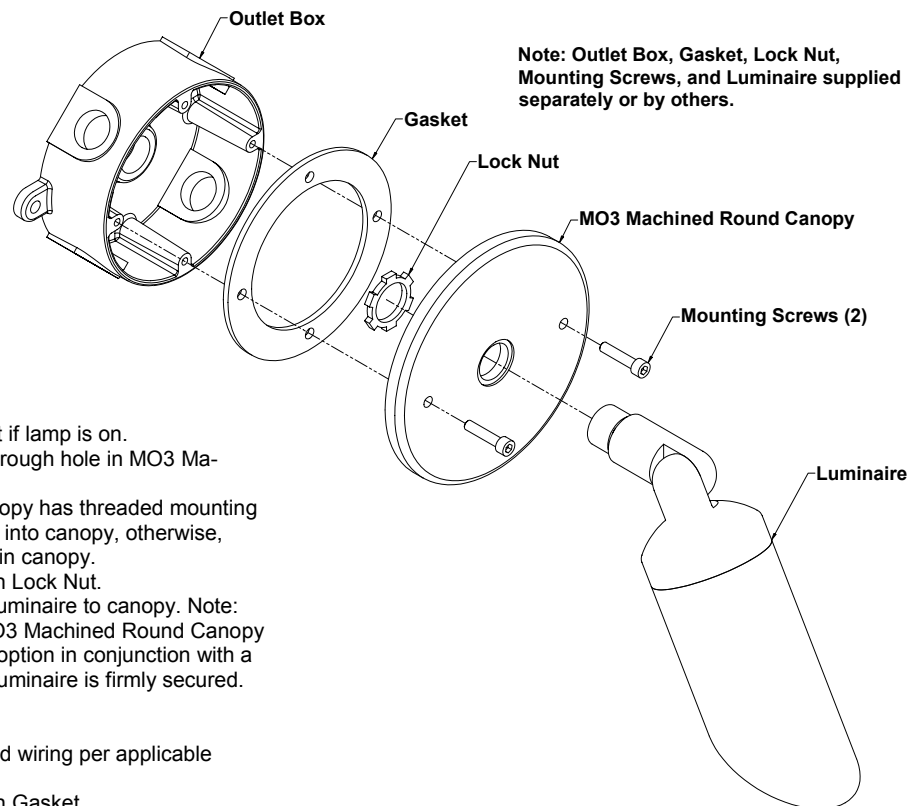

Mount Fixture on Canopy:

1. Caution! Luminaire will be hot if lamp is on.
2. Feed leads from Luminaire through hole in MO3 Machined Round Canopy.
3. If MO3 Machined Round Canopy has threaded mounting hole option, thread Luminaire into canopy, otherwise, push Luminaire through hole in canopy.
4. Feed Luminaire leads through Lock Nut.
5. Tighten Lock Nut to secure Luminaire to canopy. Note: We recommend using the MO3 Machined Round Canopy with threaded mounting hole option in conjunction with a Lock Nut to ensure that the Luminaire is firmly secured.

Mount Canopy on Outlet Box:

1. Install Outlet Box, conduit, and wiring per applicable codes.
2. Feed Luminaire leads through Gasket.
3. Connect Luminaire leads to power supply wires using the appropriate connectors per applicable codes. Note: Be sure Luminaire is rated for power being supplied by power supply leads.
4. Attach MO3 Machined Round Canopy and Gasket to Outlet Box using the appropriate Mounting Screws. Note: Ensure that Gasket is not pinched and fully covers the flat sealing surface of the outlet box.