



MR16 Dual Sign Light MODEL SL9
120/277V, 75W Max. each lamp, Dual MR16 Halogens

Specifications:

Material: Machined 6061-T6 aluminum.

Knuckle: A Rotate and Lock knuckle (protected under U.S. Patents #6,966,679 and #7,108,405) mounts each body to the mount cap and allows for infinite adjustability. Double taper design allows fixture to hold position during aiming and ensures a solid lock when tightened. See Model MO7 - Rotate and Lock submittal for complete specifications.

Cap: Machined caps come in three styles, lock in place with one 18-8 stainless steel set screw, and are sealed to the body with a high temperature silicone O-ring. Regressed caps have drain holes for water drainage from top of lens if mounted in the up position. All caps accept up to three internal accessories, held in place by a stainless steel clip.

Mount Canopy: Available with the following mount options: MO3 (Machined Round Canopy), MO15 (Machined Square Canopy), and MO12 & MO13 (Surface Mount Powered Canopies). Stem is permanently attached to mount canopy using a 304 stainless steel threaded nipple to prevent loosening or sagging. See mount specification sheets for more information. (Mount canopy must be mounted to an appropriate wall or junction box, in such a manner that is capable of holding the weight and torque created by the fixture. Junction box and hardware not included).

Electrical: Includes integral 75VA, 12V output, magnetic transformers with

120V or 277V, 60Hz input.

Finish: TGIC thermo set polyester powder coat paint available in 14 standard colors. Finish is applied over a corrosion resistant chromate conversion coating. Also available in one additional metal finish: Clear Anodized.

Socket: Two GY-6.35 porcelain sockets with 600V, 250°C, PTFE coated 18 ga leads.

Lamp: Two 12 Volt Bi-pin MR16 halogens up to 75 watts each.

Lens: Each cap contains a tempered, clear lens, secured with a high temperature, UV curing, silicone adhesive.

Certification: CSA tested & certified to US and Canadian safety standards for wet location wall mount use per UL1598 (Must be mounted in such a manner to properly support the fixture).

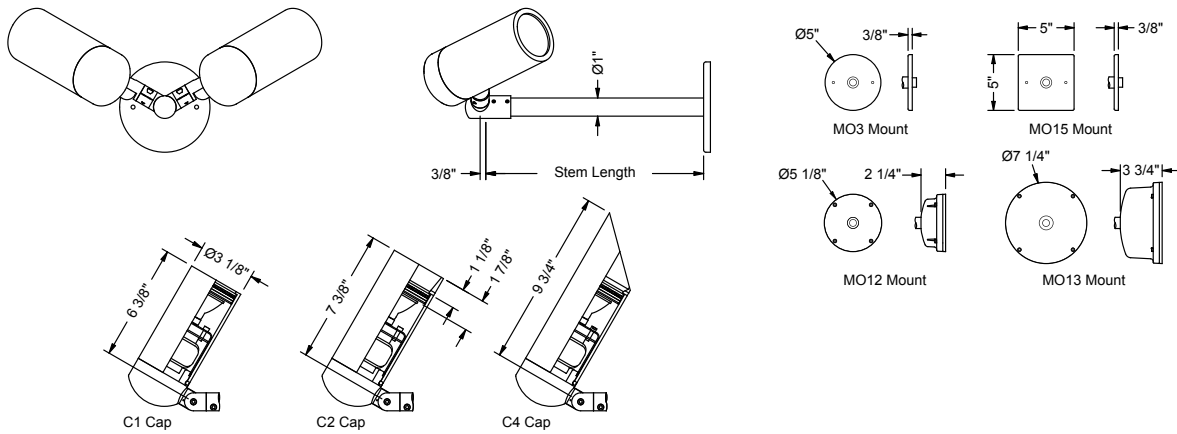

Ordering Information:

SL9A									
Model	Finish	Cap Style	Stem ¹	Mount ²	Transformer	Lamp ³	Lens Accy ³	Filter ³	Louver
SL9A - Aluminum	BL - Black	C1 - Flush	6 - 6" Stem	MO3 - Round Canopy	120 - 120 Volt Input	0 - None	0 - None	0 - None	0 - None
	BLT - Textured Black	C2 - Regress Lens	12 - 12" Stem	MO15 - Square Canopy	277 - 277 Volt Input	MR16 Halogen:	L1 - Spread Lens	F1 - Red	H1 - Honeycomb Louver
	BN - Bronze	C4 - 45° Angled	18 - 18" Stem	MO12 - Surface Mount Canopy		01 - ESX, 20W, 12° Narrow Spot	L2 - Linear Lens	F2 - Blue	
	BNT - Textured Bronze		24 - 24" Stem	MO13 - Surface Mount Canopy		02 - BAB, 20W, 40° Flood	L3 - Softening Lens	F3 - Light Blue	
	BAT - Textured Bark		30 - 30" Stem			03 - FRB, 35W, 12° Narrow Spot		F4 - Green	
	WI - White					04 - FRA, 35W, 23° Narrow Flood		F5 - Amber	
	GRT - Textured Green					05 - FMW, 35W, 40° Flood		F6 - Pink	
	SI - Silver					06 - EYR, 42W, 12° Narrow Spot			
	GY - Grey					07 - EYS, 42W, 25° Narrow Flood			
	BE - Beige					08 - EYP, 42W, 40° Flood			
	GNT - Textured Granite					09 - EXT, 50W, 13° Narrow Spot			
	SAT - Textured Sand					10 - EXZ, 50W, 26° Narrow Flood			
	PAT - Textured Patina					11 - EXN, 50W, 40° Flood			
	EAT - Textured Earth					12 - FNV, 50W, 60° Wide Flood			
	CLA - Clear Anodized					13 - EYF, 75W, 13° Narrow Spot			
						14 - EYJ, 75W, 26° Narrow Flood			
						15 - EYC, 75W, 44° Flood			

- Notes:**
- Other stem lengths are available upon request. Consult your Vision3 Lighting sales representative.
 - See MO3, MO12, MO13, MO15 specification sheet for mount details.
 - LED lamps available separately. Contact your Vision3 lighting CSR. ('Lens Accy' & 'Filter' options should not be used with LED lamps.)
 - Specifications, certifications, and ordering information are subject to change. Please check website for latest specification sheets.

Example: **SL9A - BL - C4 - 12 - MO15 - 120 - 07 - L1 - 0 - 0**