

### Specifications:

**Material:** Available in machined 6061-T6 aluminum, C36000 brass, or 304 stainless steel.

**Cap:** Machined caps come in four styles, lock in place with one 18-8 stainless steel set screw, and are sealed to the body with a high temperature silicone O-ring. Regressed caps have drain holes for water drainage from top of lens if mounted in the up position. 'Flush Lens' cap styles incorporate a stepped lens to reduce the collection of water and debris on the lens. All caps accept up to three internal accessories, held in place by a stainless steel clip.

**Mount Canopy:** Available with the following mount options: MO3 (Machined Round Canopy), MO15 (Machined Square Canopy), and MO12 (Surface Mount Powered Canopy); and may be mounted in the up or down position. Stem is permanently attached to the mount canopy to prevent loosening. MO3 & MO15 mount options come mounted to a steel universal mounting ring for ease of mounting and adjustment on an industry standard round junction box (box and hardware not supplied). See mount specification sheets for more information. (Mount canopy must be mounted to an appropriate wall or junction box, in such a manner that is capable of holding the weight of the fixture. Junction box and hardware not included).

**Finish:** TGIC thermo set polyester powder coat paint available in 14 standard colors. On aluminum model, finish is applied over a corrosion resistant chromate conversion coating. Aluminum model available in one additional metal finish: Clear Anodized. Brass model available in three additional metal finishes:

Natural, Polished, and Aged. Stainless steel model available in three additional metal finishes: Natural, Polished, and Brushed.

**Socket:** GY-6.35 porcelain socket with 600V, 250°C, PTFE coated 18 ga leads.

**Lamp:** 12 Volt Bi-pin MR16 halogen up to 50 watts. (See **Certification** heading for wattage limitations.)

**Lens:** Tempered, clear lens, secured to cap with a high temperature, UV curing, silicone adhesive. Stepped lens is used in 'Flush Lens' cap style options to reduce the collection of water and debris on the lens.

**Certification:** CSA tested & certified to US and Canadian safety standards for wet location wall mount use (UL1598):

MO3 & MO15 mount options:

**WM1A - 50W Max. MR16 Halogen lamp.**

**WM1B - 37W Max. MR16 Halogen lamp.**

**WM1S - 20W Max. MR16 Halogen lamp.**

MO12 mount option:

**WM1A - 50W Max. MR16 Halogen lamp.**

**WM1B - 42W Max. MR16 Halogen lamp.**

**WM1S - Not available.**

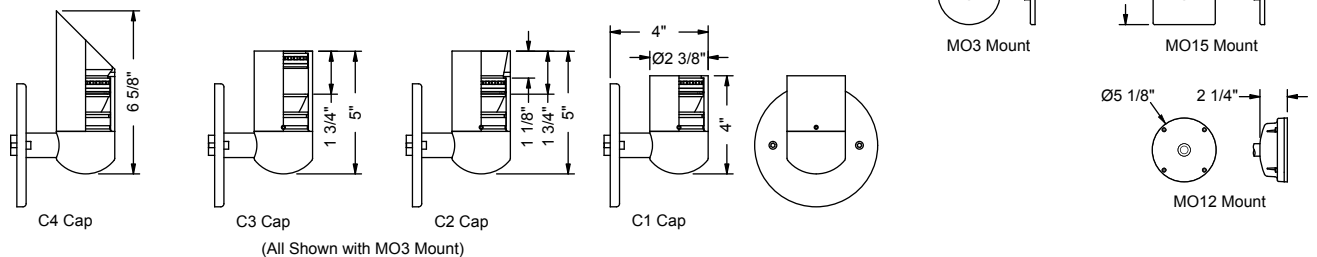

### Ordering Information:

Model	Finish	Cap Style	Mount <sup>1</sup>	Lamp <sup>2,4</sup>	Lens Accy <sup>4</sup>	Filter <sup>4</sup>	Louver
WM1A - Aluminum	BL - Black	<b>Standard Lens:</b>	MO3 - Round Canopy	0 - None	0 - None	0 - None	0 - None
WM1B - Brass	BLT - Textured Black	C1 - Flush	MO15 - Square Canopy	<b>MR16 Halogen:</b>	L1 - Spread Lens	F1 - Red	H1 - Honeycomb
WM1S - Stainless	BN - Bronze	C2 - Regress Lens	MO12 - Surface Mount Canopy <sup>3</sup>	01 - ESX, 20W, 12° Narrow Spot	L2 - Linear Lens	F2 - Blue	Louver
	BNT - Textured Bronze	C3 - Regress Lamp	MO12-75-120 - MO12 w/ 75W, 120V transformer <sup>3</sup>	02 - BAB, 20W, 40° Flood	L3 - Softening Lens	F3 - Light Blue	
	BAT - Textured Bark	C4 - 45° Angled	MO12-75-230 - MO12 w/ 75W, 230V transformer <sup>3</sup>	03 - FRB, 35W, 12° Narrow Spot		F4 - Green	
	WI - White	<b>Flush Lens:</b>	MO12-75-277 - MO12 w/ 75W, 277V transformer <sup>3</sup>	04 - FRA, 35W, 23° Narrow Flood		F5 - Amber	
	GRT - Textured Green	C1F - Flush		05 - FMW, 35W, 40° Flood		F6 - Pink	
	SI - Silver	C2F - Regress Lens		06 - EYR, 42W, 12° Narrow Spot		F7 - Mercury Vapor	
	GY - Grey	C3F - Regress Lamp		07 - EYS, 42W, 25° Narrow Flood			
	BE - Beige	C4F - 45° Angled		08 - EYP, 42W, 40° Flood			
	GNT - Textured Granite			09 - EXT, 50W, 13° Narrow Spot			
	SAT - Textured Sand			10 - EXZ, 50W, 26° Narrow Flood			
	PAT - Textured Patina			11 - EXN, 50W, 40° Flood			
	EAT - Textured Earth			12 - FNV, 50W, 60° Wide Flood			
	CLA - Clear Anodized (WM1A only)						
	NAT - Natural (WM1B & WM1S only)						
	POL - Polished (WM1B & WM1S only)						
	AGE - Aged (WM1B only)						
	BRU - Brushed (WM1S only)						

**Notes:**

- See MO3, MO12, or MO15 specification sheet for mount details.
- Allowable wattage depends on model and application. See **Certification** heading above.
- MO12 mount options not available with WM1S.
- LED lamps available separately. Contact your Vision3 lighting CSR. ('Lens Accy' & 'Filter' options should not be used with LED lamps.)
- Specifications, certifications, and ordering information are subject to change. Please check website for latest specification sheets.

Example: **WM1B - AGE - C3F - MO12-75-120 - 02 - 0 - F2 - H1**