

Atrio 21 059

Thermostatic Roman Tub Filler

Exploded View

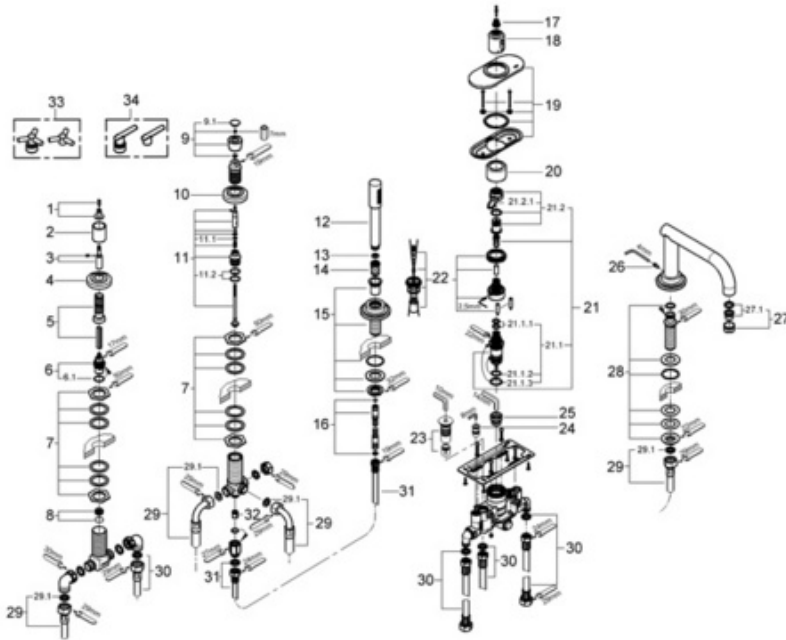

Parts Breakdown

Pos No.	Spare Part Description	Product No.	Pcs.
21 059			
1	Handle connection set	45 605	1
2	Flange sleeve	11 221	1
3	Spindle	45 607	1
4	Hot/cold valve flange	11 222	1
5	Primary spindle	45 202	1
6	90 degree 3/4" carbodur cartridge	45 686	1
6.1	O-ring	45 583	1
7	L/p handshower mounting set	45 444	1
8	Seal	45 345	1
9	Chrome diverter knob/08.270	07 576	1
9.1	Diverter cap	03 288	1
10	Diverter flange	11 223	1
11	L/p diverter cartridge	45 443	1
11.1	O-ring	01 283	1
11.2	O-ring	01 205	1
12	Sena hand shower	28 341	1
13	Filter screen	07 002	1
14	Adaptor	08 864	1
15	Hand shower receiver	47 688	1
16	Hand shower hose	28 146	1
17	Handle insulator	08 943	1
18	Temperature handle	07 627	1
19	THM escutcheon	47 665	1
20	Body sleeve	04 952	1
21	THM cartridge complete	47 715	1
21.1	Cartridge o-ring kit	47 649	1
21.1.1	O-ring	01 218	1
21.1.2	Body seal o-ring for 47.119	01 206	1
21.1.3	O-ring	02 680	1
21.2	Non-rising spindle	47 300	1
21.2.1	Clip	05 744	1
22	Extension kit	47 653	1
23	3/4" check valve	47 466	1
24	Service stop	47 467	1
25	Thermostat seat 34 908	09 872	1
26	Spout set screw	47 670	1
27	Flow regulator	13 927	1
27.1	Flow regulator set	45 029	1
28	Mounting shank	45 163	1
29	L/p hose - diverter to spout	45 446	1
29.1	Fiber washer for 12.007	01 386	1
30	Inlet supply	45 449	1
31	Flexible supply hose	07 300	1
32	Check valve	08 565	1
Special Accessories			
33	Trio spoke handles	21 072	1
34	Lever handles	21 073	1