

Exploded View

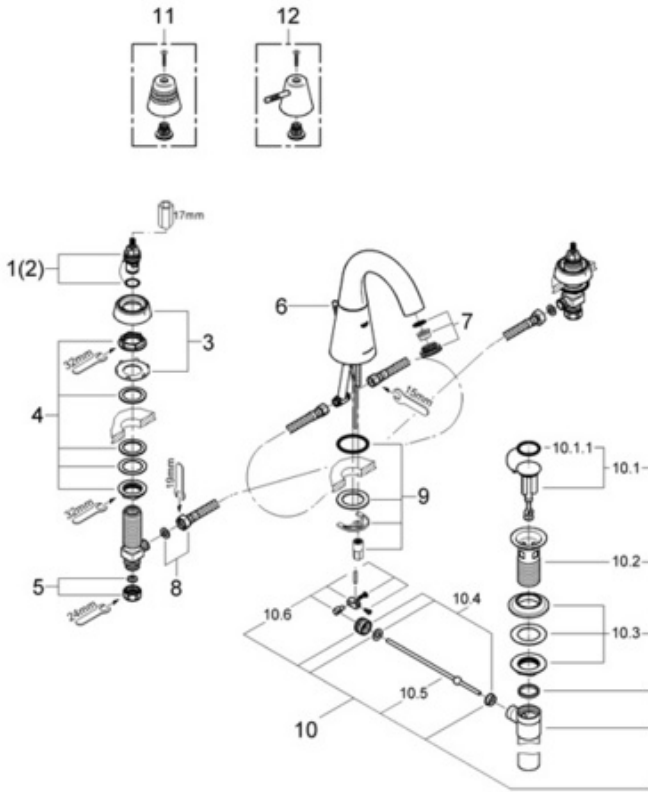

Parts Breakdown

| Pos No. | Spare Part Description | Product No. | Pcs. |
|----------------------------|-------------------------------|-------------|------|
| 21 079 | | | |
| 1 | Ceramic cartridge | 45 882 | 1 |
| 2 | 90 degree cartridge | 45 883 | 1 |
| 3 | Valve escutcheon | 45 015 | 1 |
| 4 | Classic widerset mounting set | 45 025 | 1 |
| 5 | 1/2" coupling nut | 12 902 | 1 |
| 6 | Lift Rod | 45 089 | 1 |
| 7 | Flow control | 45 091 | 1 |
| 8 | Flex hose for widesets | 45 442 | 1 |
| 9 | Mounting kit | 46 055 | 1 |
| 10 | Pop-up drain | 28 957 | 1 |
| 10.1 | Stopper | 45 324 | 1 |
| 10.1.1 | Stopper o-ring | 01 147 | 1 |
| 10.2 | Flange | 01 153 | 1 |
| 10.3 | Shank nut & bushing | 45 266 | 1 |
| 10.4 | Nut & bushings | 45 265 | 1 |
| 10.5 | Ball rod | 45 264 | 1 |
| 10.6 | Toggle lever | 45 485 | 1 |
| Special Accessories | | | |
| 11 | Cone handles | 21 085 | 2 |
| 12 | Lever handles | 21 084 | 2 |