

### EBLA SEMI-ENCASTRE LAVATORY, MODEL 2302X

- Italian contemporary design
- Space-saving lavatory
- Vitreous china
- Rear overflow
- Chrome overflow ring included
- Optional European Complete Pop-up Drain Assembly #M953460 with available finishes
- Made in Italy

☐ **23021** Center hole only

☐ **23028** Faucet holes on 8" (203mm) centers

#### Nominal Dimensions:

25-1/2" x 20-1/2" x 7-1/4" (650 x 520 x 184mm)

#### Bowl Inside Dimensions:

21" (533mm) wide

12-3/4" (324mm) front to back

5-1/4" (133mm) depth

**Fixture Dimensions** conform to ASME Standard A112.19.2

#### To Be Specified

- ☐ Color:
- ☐ Faucet:
- ☐ Faucet Finish:
- ☐ Supplies:
- ☐ 1-1/4" Trap:
- ☐ Nipple:

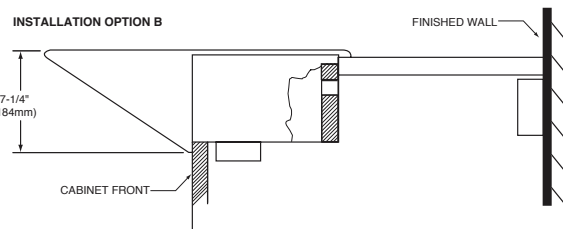
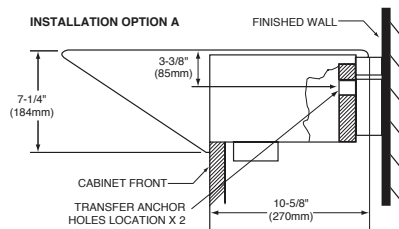
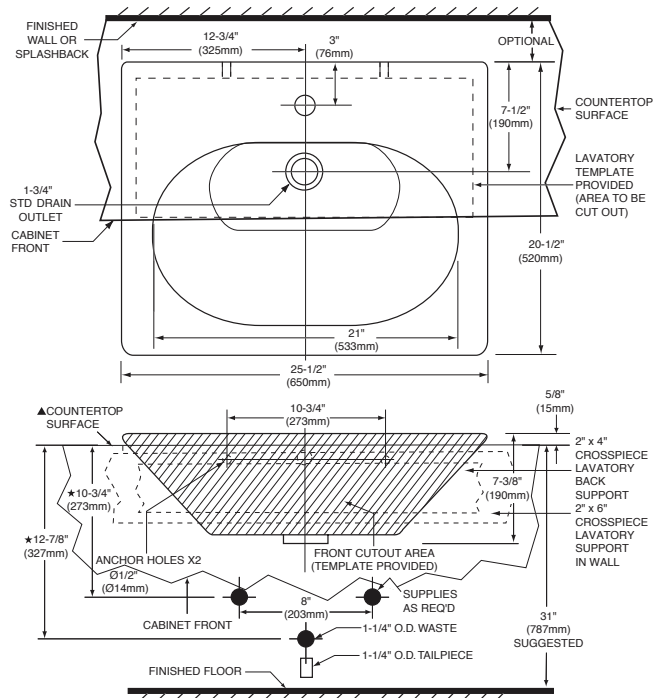

#### NOTES:

- ★ DIMENSIONS SHOWN FOR LOCATION OF SUPPLIES AND "P" TRAP ARE SUGGESTED.
- ▲ FOR COUNTERTOP CUTOUT AND INSTALLATION INSTRUCTIONS, USE TEMPLATE SUPPLIED WITH LAVATORY. PROVIDE SUITABLE REINFORCEMENT FOR ALL WALL SUPPORTS. FITTINGS NOT INCLUDED AND MUST BE ORDERED SEPARATELY.

IMPORTANT: Dimensions of fixtures are nominal and may vary within the range of tolerances established by ASME Standard A112.19.2. These measurements are subject to change or cancellation. No responsibility is assumed for use of superseded or voided pages.