

**SAMPLE CATALOG NUMBER**

OW1410 - 1CH70T6(MTAP) - SUNG - XPS  
 Model Number Lamping Option (Voltage) Finish Option

| Model         |            | Lamping Options |          | Finish   | Options    |            |
|---------------|------------|-----------------|----------|--|------------|------------|
| Model Number  | Dimensions |                 |          |  |            |            |
| <b>OW1410</b> | W          | 14"             | (356 mm) | <b>1N150</b><br><b>1CH70T6</b><br><b>1CH150T6</b><br><b>1PH70</b><br><b>1PH100</b> | <b>PTD</b> | <b>XPS</b> |
|               | H          | 14"             | (356 mm) |  |            |            |
|               | D          | 4-3/4"          | (121 mm) |  |            |            |
|               | RD         | 5-1/4"          | (133 mm) |  |            |            |
| <b>OW1412</b> | W          | 18"             | (457 mm) | <b>1N150</b><br><b>1CH70T6</b><br><b>1CH150T6</b><br><b>1PH70</b><br><b>1PH100</b> | <b>PTD</b> | <b>XPS</b> |
|               | H          | 18"             | (457 mm) |  |            |            |
|               | D          | 4-3/4"          | (121 mm) |  |            |            |
|               | RD         | 5-1/4"          | (133 mm) |  |            |            |
| <b>OW1430</b> | W          | 14"             | (356 mm) | <b>1N150</b><br><b>1CH70T6</b><br><b>1CH150T6</b><br><b>1PH70</b><br><b>1PH100</b> | <b>PTD</b> | <b>XPS</b> |
|               | H          | 14"             | (356 mm) |  |            |            |
|               | D          | 4-3/4"          | (121 mm) |  |            |            |
|               | RD         | 5-1/4"          | (133 mm) |  |            |            |
| <b>OW1432</b> | W          | 18"             | (457 mm) | <b>1N150</b><br><b>1CH70T6</b><br><b>1CH150T6</b><br><b>1PH70</b><br><b>1PH100</b> | <b>PTD</b> | <b>XPS</b> |
|               | H          | 18"             | (457 mm) |  |            |            |
|               | D          | 4-3/4"          | (121 mm) |  |            |            |
|               | RD         | 5-1/4"          | (133 mm) |  |            |            |

**LINE DRAWINGS**

**OW1410 / OW1412**

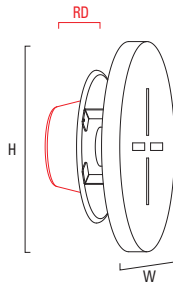

**OW1430 / OW1432**

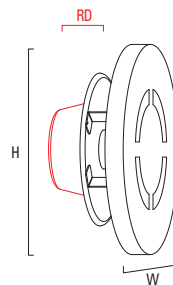

**ABBREVIATION KEY**

**Dimensions**

- W** Width
- H** Height
- D** Depth (measured from wall to front of fixture)
- RD** Recessed Depth

**Lamping Options (Voltage)**

- N150** 150w A-21, medium base, INC (120V)
- CH70T6** 70w T-6, G12 base, ceramic MH (MTAP; 347V)
- CH150T6** 150w T-6, G12 base, ceramic MH (MTAP; 347V)
- PH70** 70w ED-17, medium base, pulse start MH (MTAP; 347V)
- PH100** 100w ED-17, medium base, pulse start MH (MTAP; 347V)

Specify Voltage or MTAP  
 MTAP is a ballast that operates 120V or 277V  
 A clear lamp is required for a sharp pattern effect

**Finishes (see inside back cover)**

- PTD** Painted - specify color code (ex. BRNZ for Bronze)

**Options**

- XPS** Express 10 day shipping

**BIM**

Complete BIM (Building Information Modeling) for these models may be downloaded from [www.visalighting.com](http://www.visalighting.com)

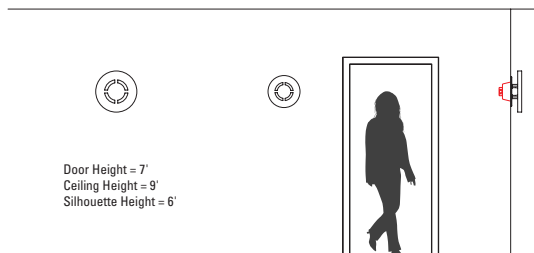

# LIGHTSHOWER®

OUTDOOR

DECORATIVE AND PERFORMANCE

WALL



OW1410-SUNG



OW1430-BSIL

## FEATURES

- 5 year product warranty
- Spun metal front shield
- Cast aluminum, fully gasketed and sealed lamp chamber with clear tempered glass enclosure
- Oven cured no VOC acrylic powder coat
- Selection of front shield styles
- Front shield features snap lock for easy tool-less relamping
- HID or incandescent lamping
- Clear lamp required for sharp pattern effect
- Remote mounted HID ballast with long distance ignitor standard, 50' maximum ballast to lamp distance, PH70(347V) is 20' maximum, PH100(347V) is 15' maximum
- Recessed mounted housing for shallower extension from wall
- UL wet location listed for mounting 4' above grade

## COMPANIONS

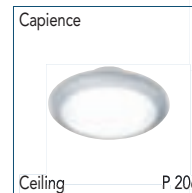
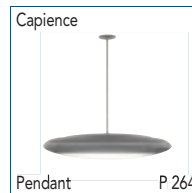

## SUGGESTED VARIATIONS

- Increase front shield up to 24" maximum
- Colored front diffuser or glass lamp enclosure
- Mix and match front shields and light patterns
- Custom cutout or logo in front shield

