

DIVIDING WALL RV.

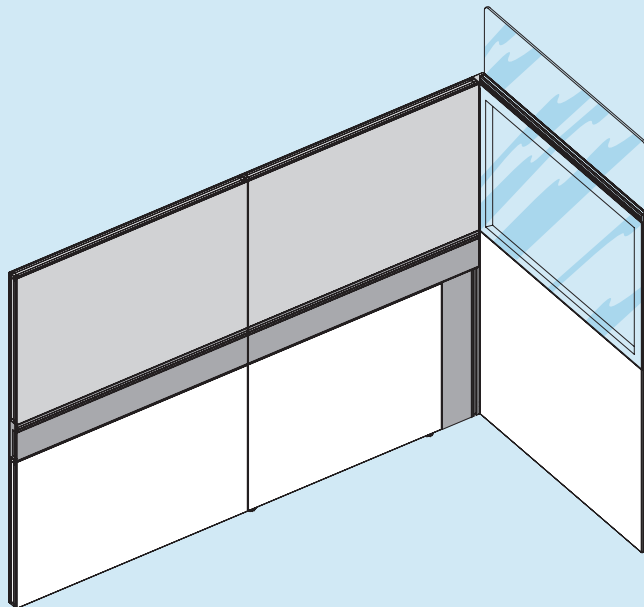

Product Overview.....	2
Installation of electric module.....	3
Installation of attachment module.....	4
Horizontal connection of modules.....	5
Horizontal connection of modules.....	6
Connection of corner junction.....	7
Levelling and corner junction fixing.....	8
Leg cantilever. Strain relief.....	9
Leg cantilever. Strain relief.....	10
Countertop.....	12
Glass side panel.....	13
Corner junction.....	14
Coat rack.....	15
Cleaning Instructions.....	16
Safety Instructions. Disposal.....	17
Notes.....	18

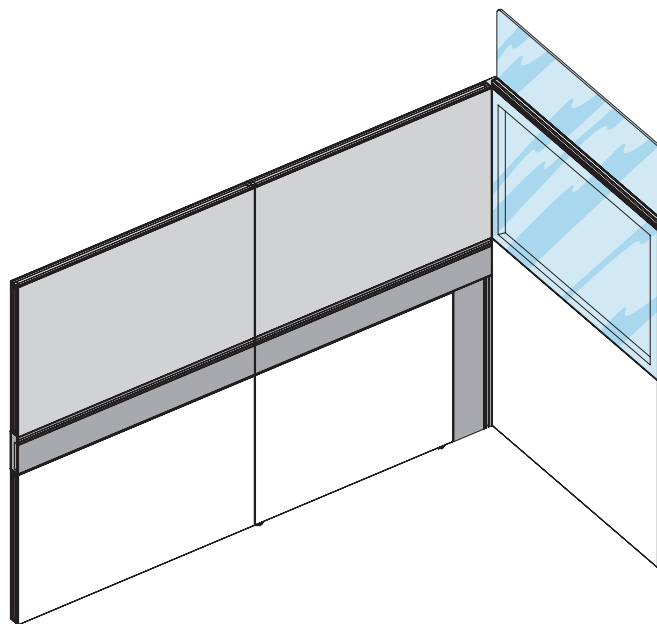
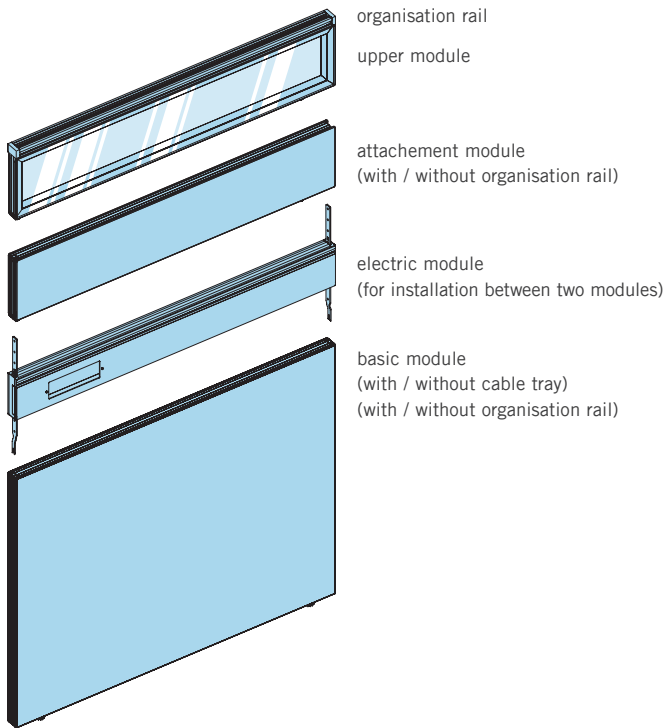

This assembly instruction refers to the proposal type above.

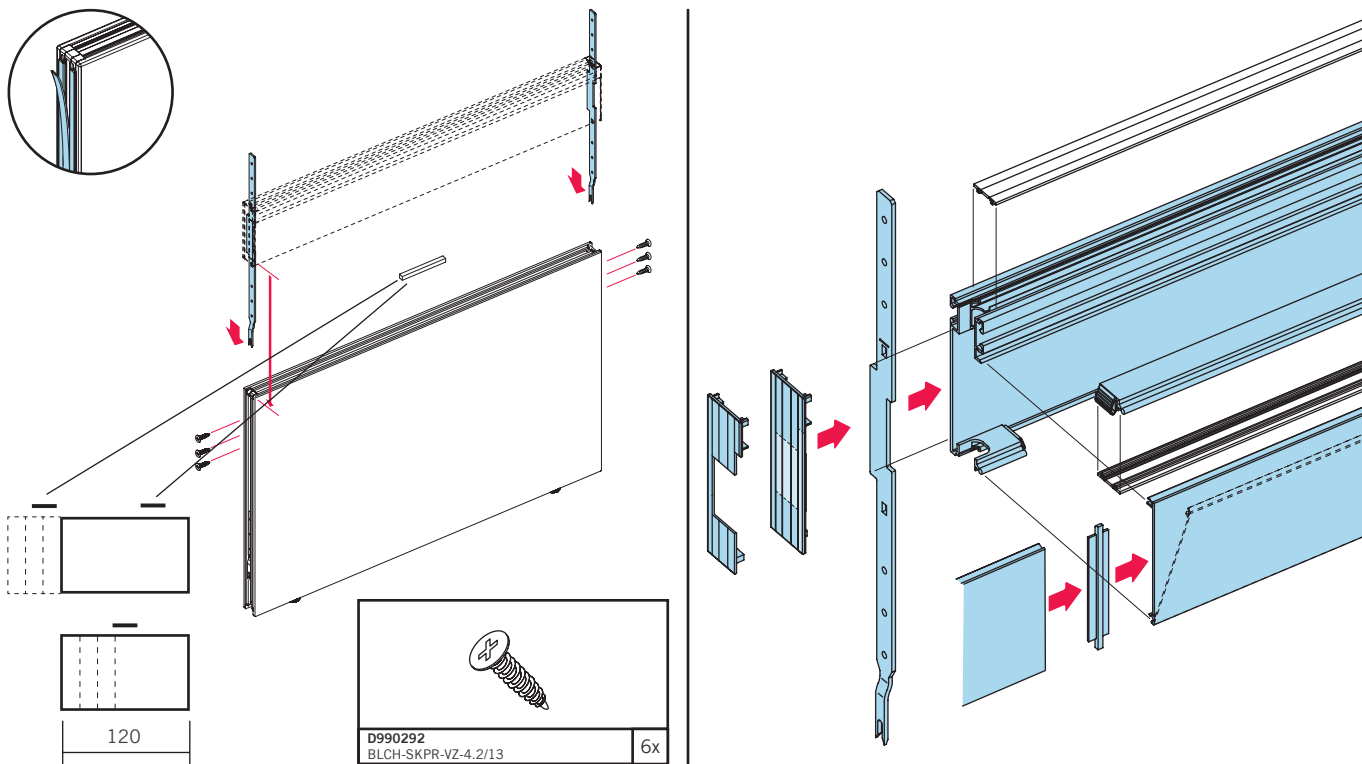

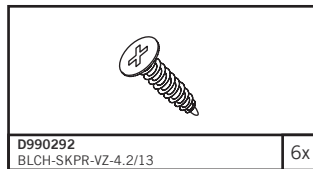
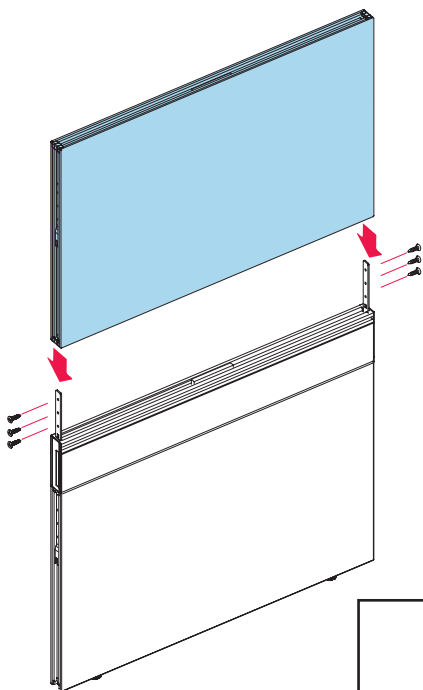

horizontal cover profile included in delivery.

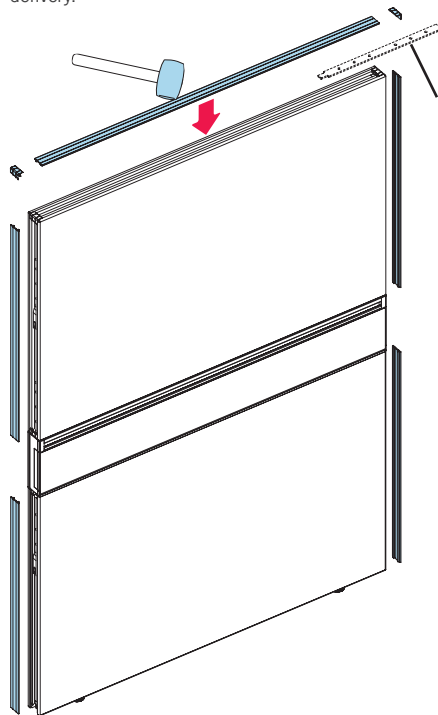

In case of series arrangement, please fix vertical cover profiles before fixing horizontal connector. (see next page)

vertical cover profile preassembled.

1. The cover profile creates a distance between two modules. In case of a horizontal connection, the middle part of the cover profile has to be removed.

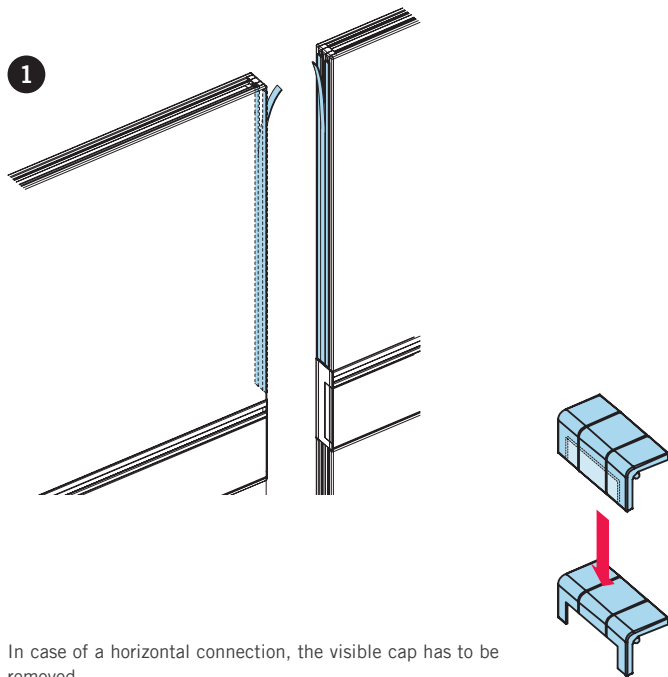

In case of a horizontal connection, the visible cap has to be removed.

2. When a perspex screen is attached to the dividing wall, a specific horizontal connector with a counter sunk drilling has to be used.

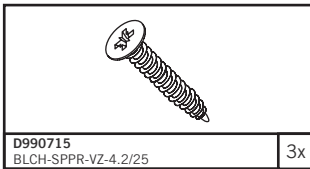
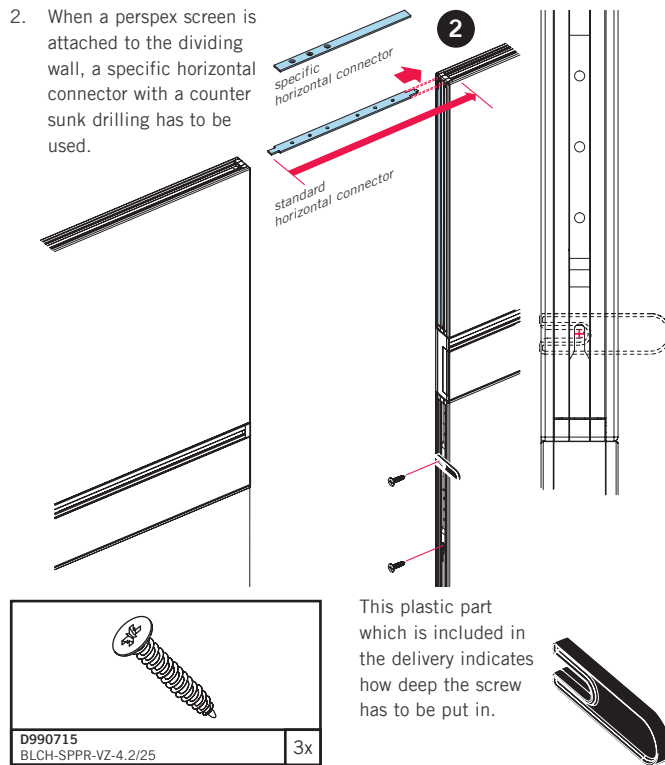

This plastic part which is included in the delivery indicates how deep the screw has to be put in.



3. Link elements together.
4. Slide horizontal connector to the left and fix it with screws.
5. Clip on cover profiles.

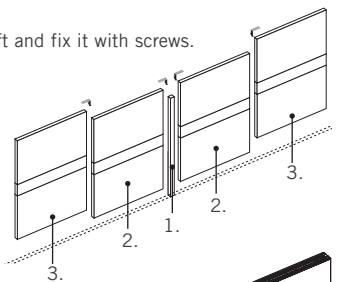

3

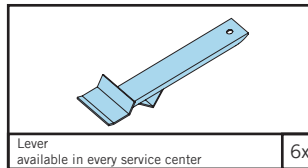
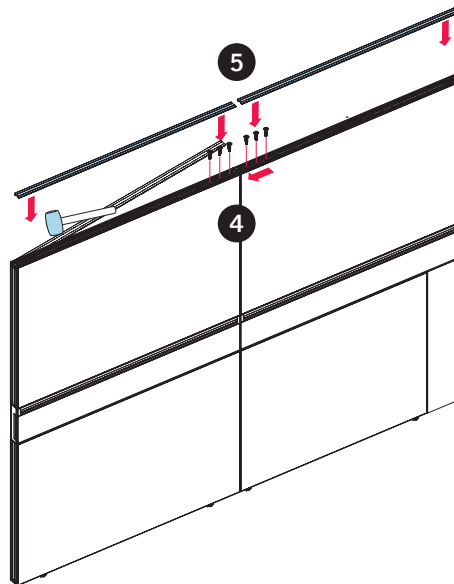
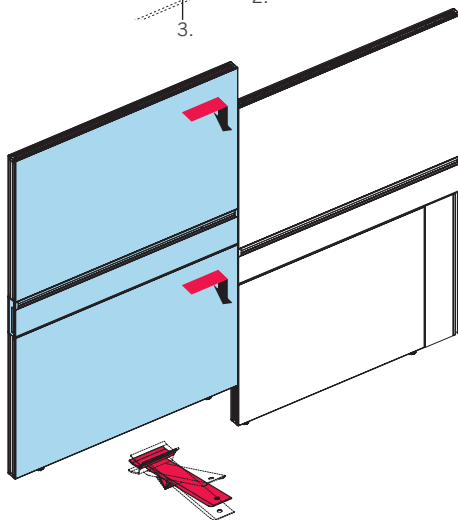

6x

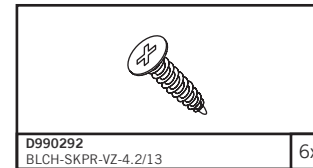

6x

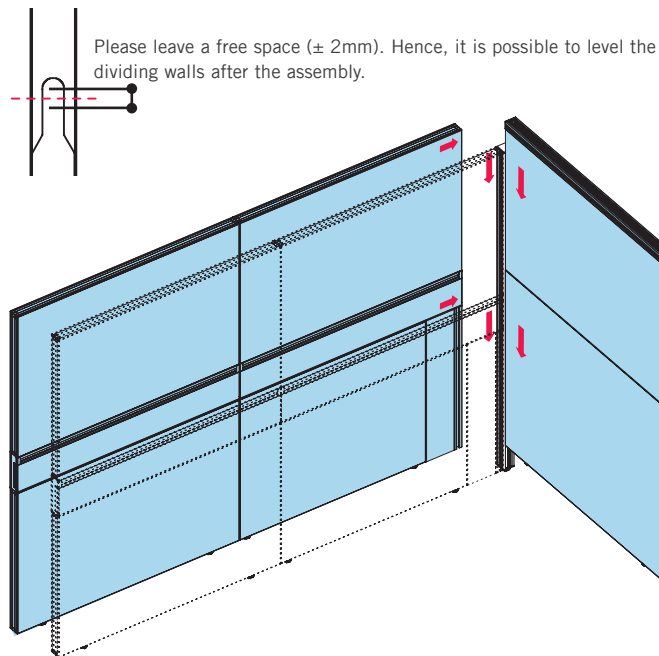
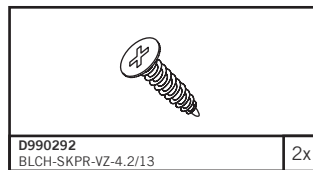
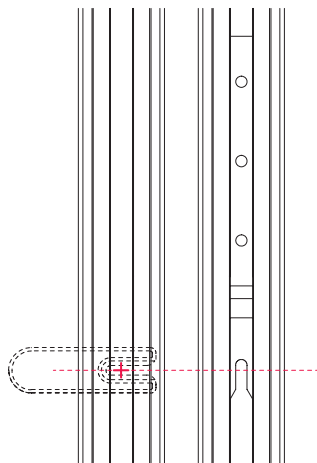
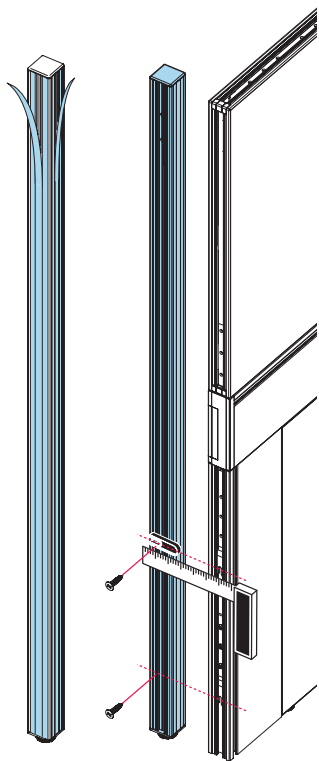

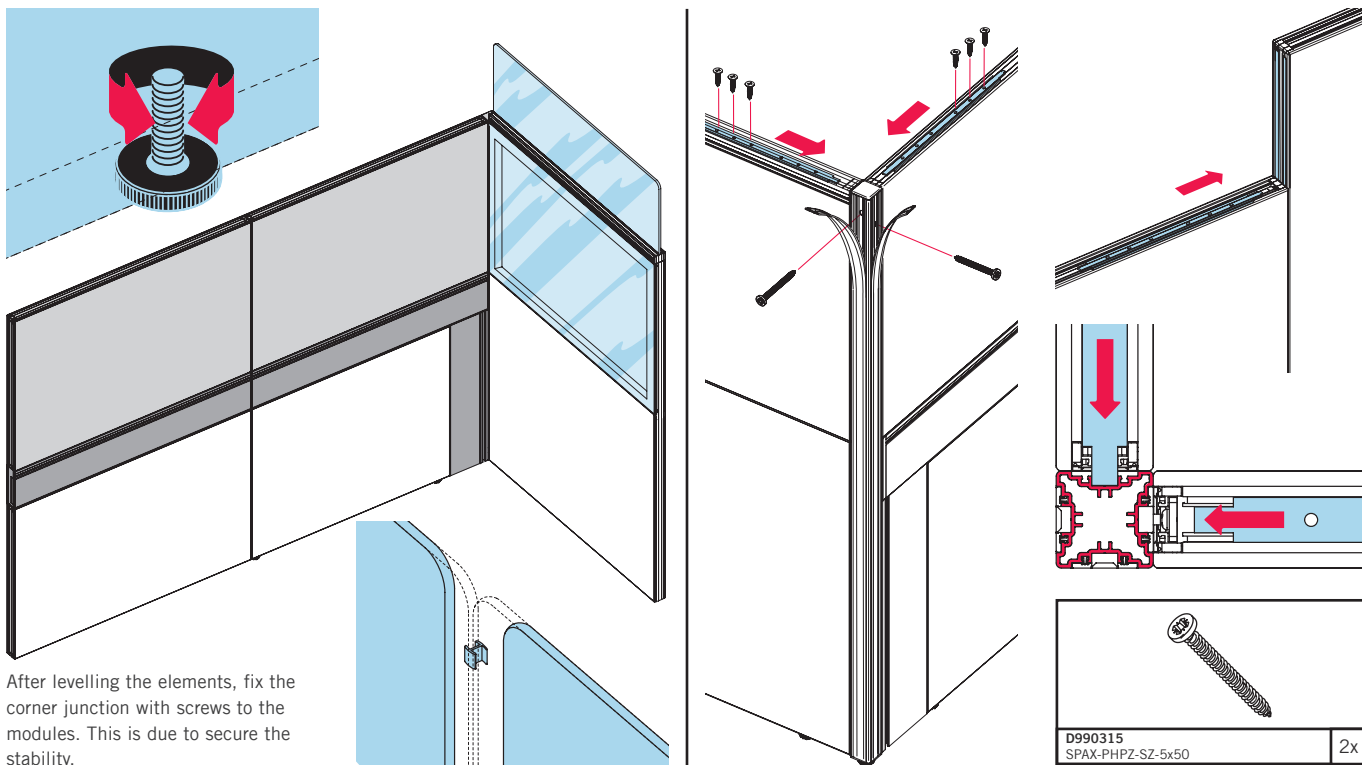

After levelling the elements, fix the corner junction with screws to the modules. This is due to secure the stability.

D990315
SPAX-PHPZ-SZ-5x50

2x

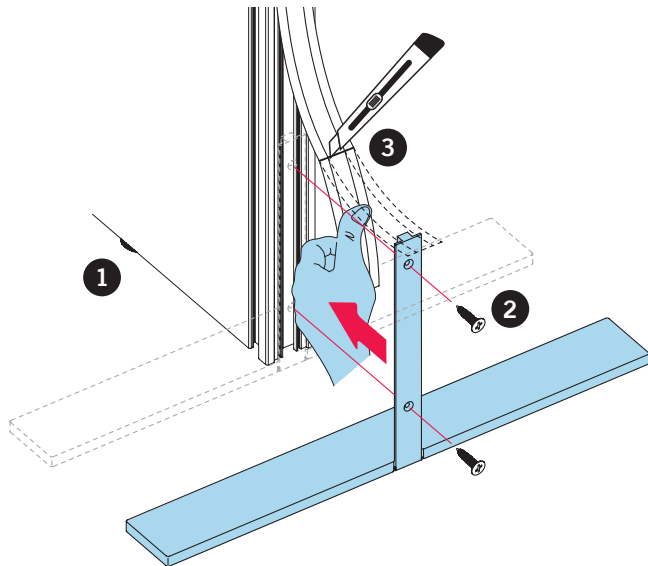
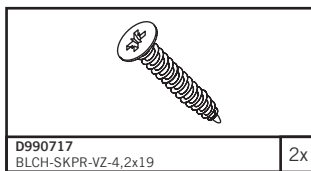
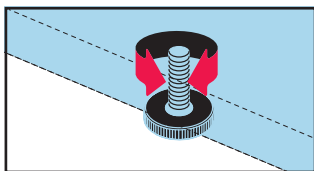

1. Level dividing wall.
2. Screw leg cantilever.
3. Shorten cover profile and fix it.
4. Screw adjustment leg. Thus, the leg cantilever carries the wall.

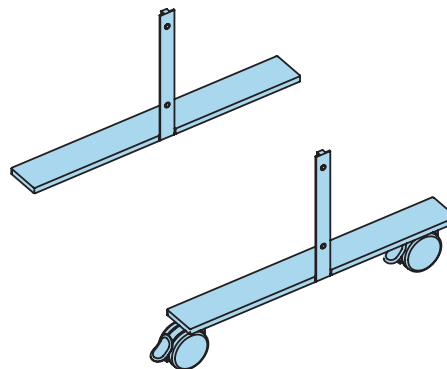

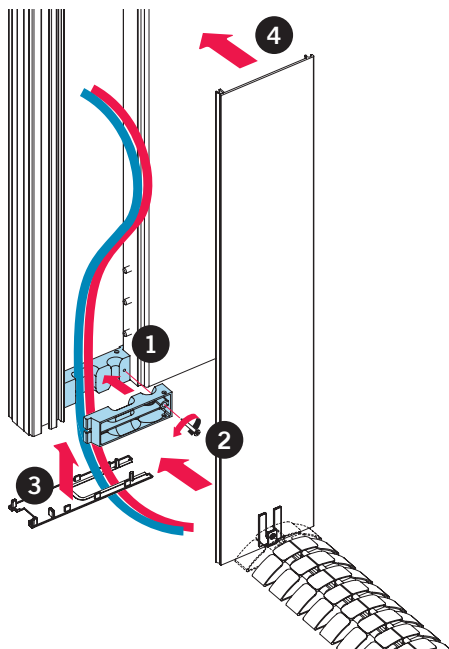

1. Put cables in the slot of the strain relief.
2. Screw cover of strain relief.
3. Clip on cover profile.
4. Clip on cover of wire trunking.

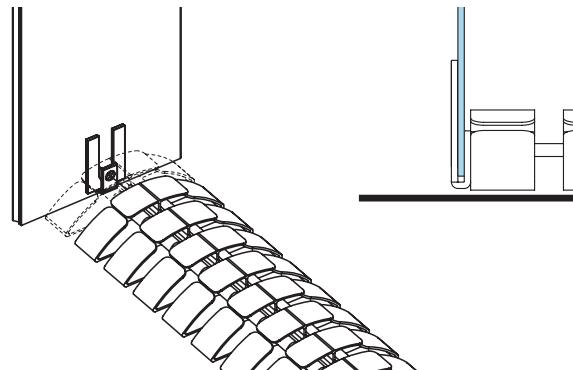
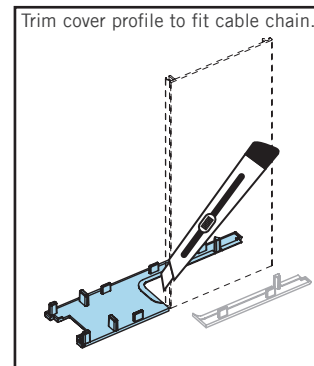
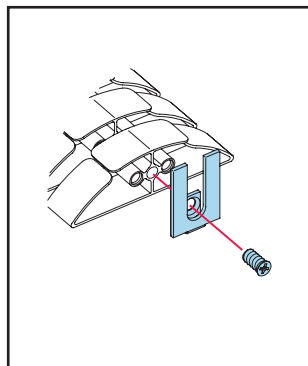

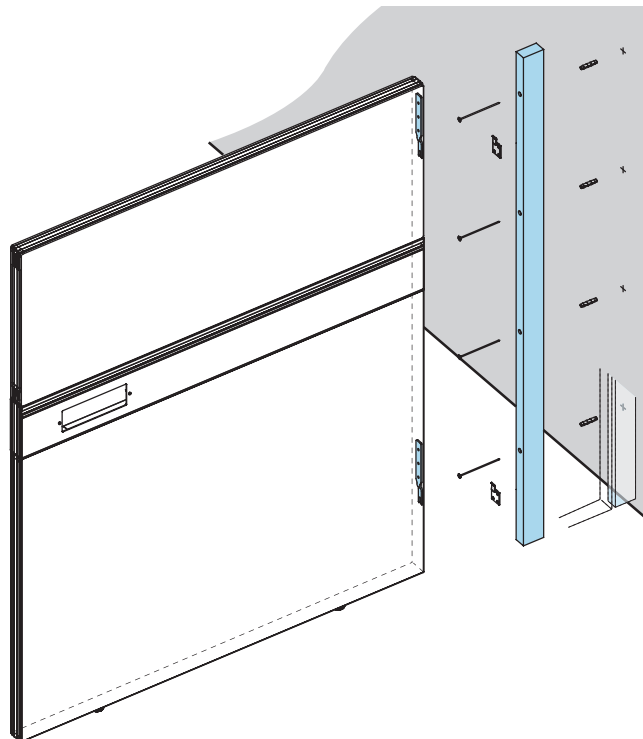
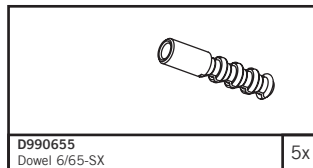
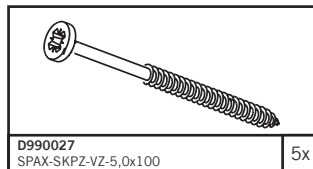
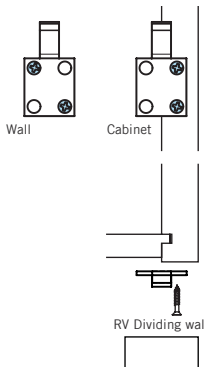
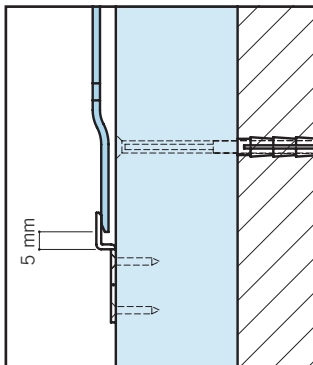
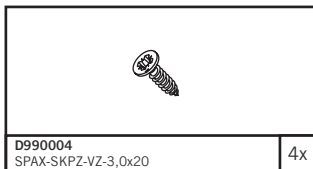
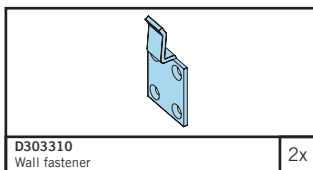

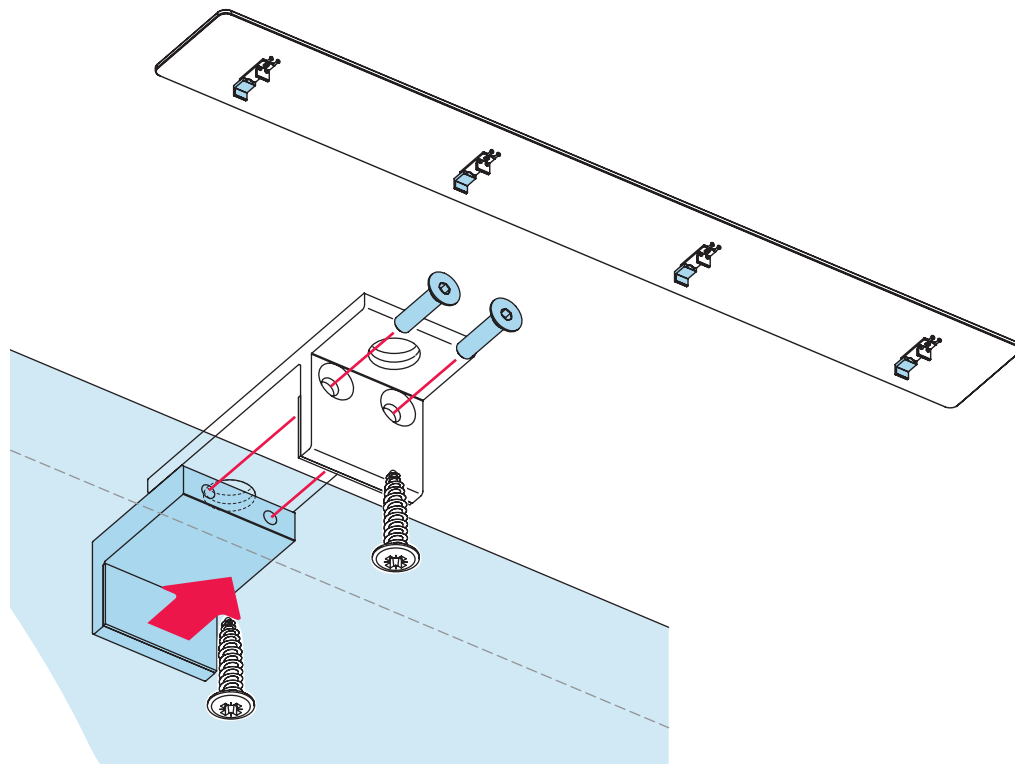
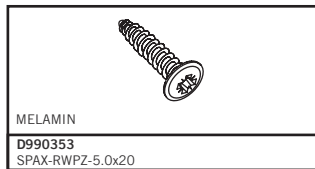
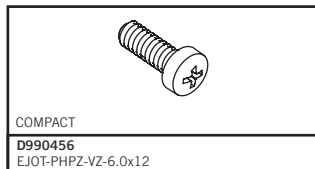

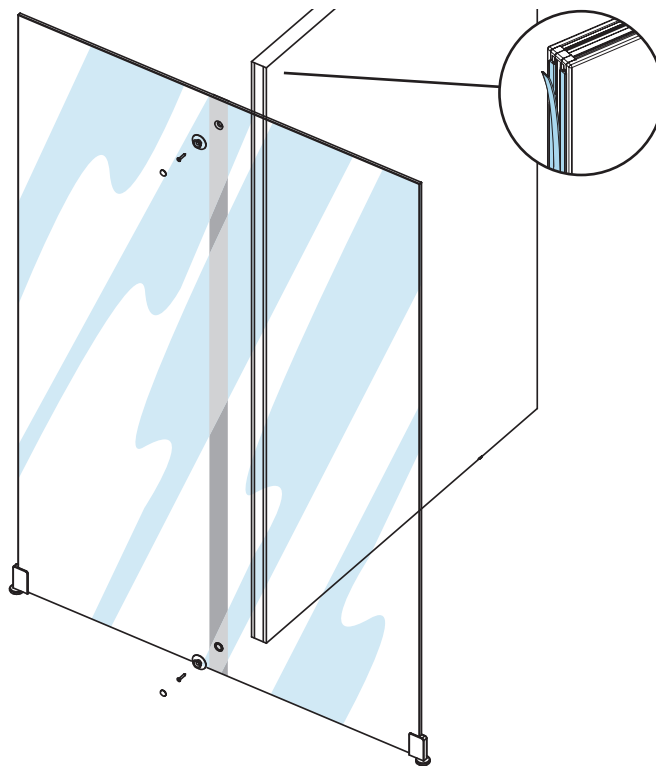
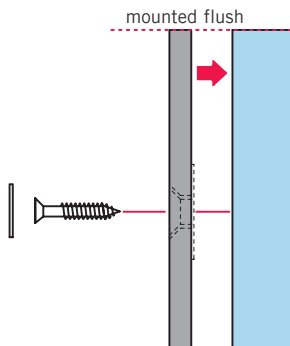
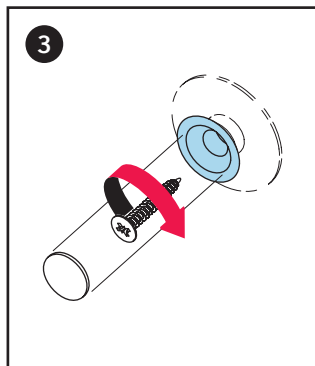
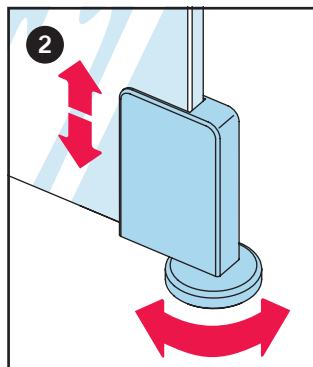
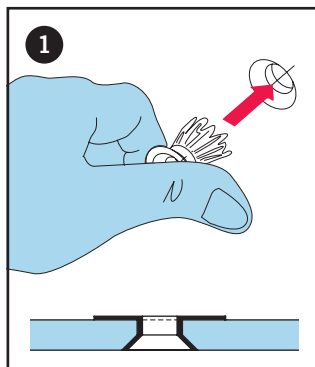

Cover profile with corner junction

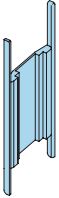
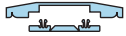

Cover profile without corner junction



Inner corner cover profile

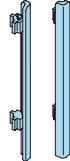

Exterior corner cover profile

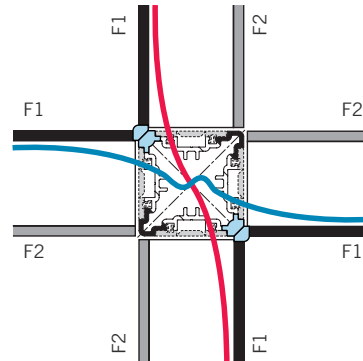
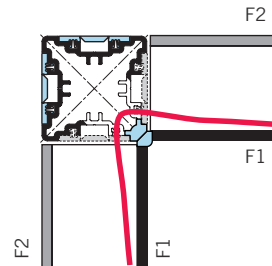
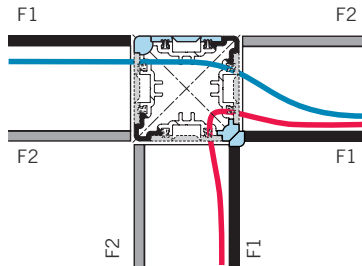
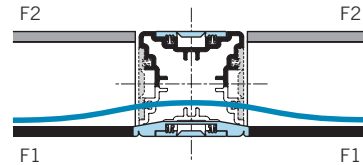
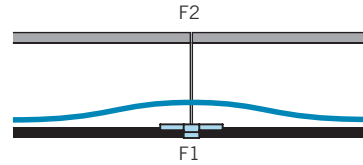
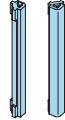

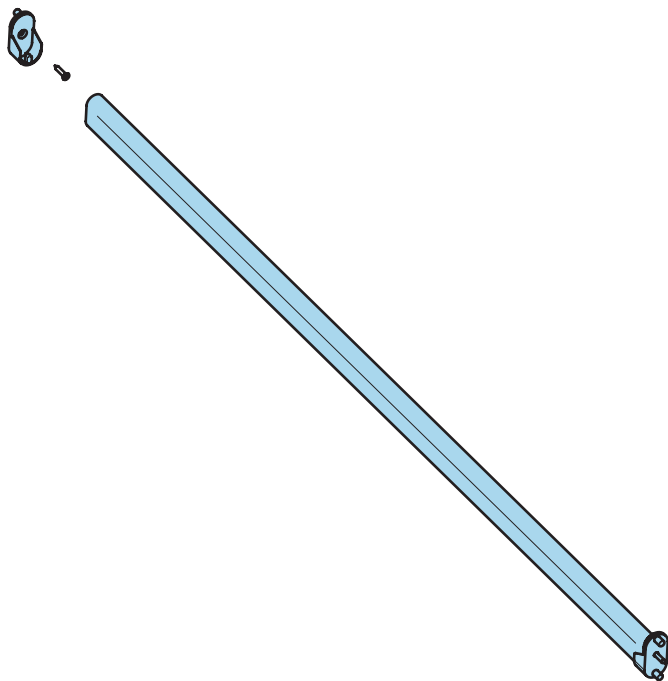

Assembly instructions

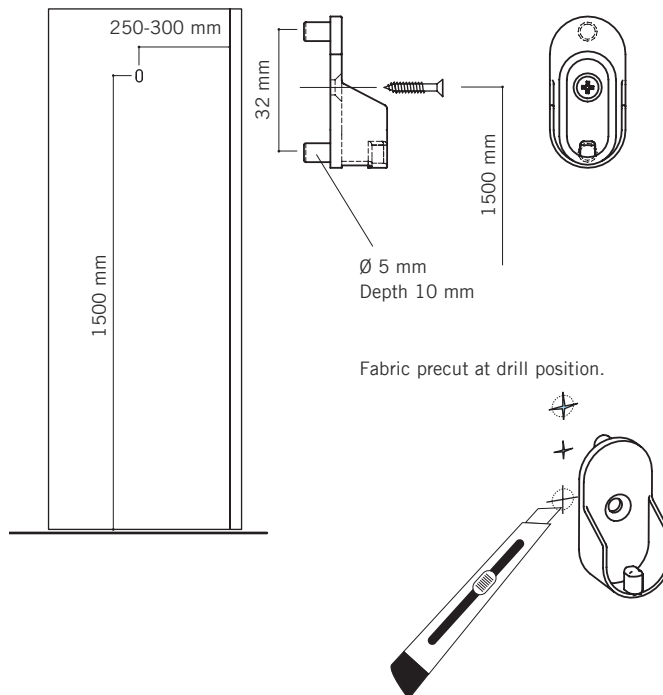

Fabric precut at drill position.

Gentle and proper cleaning of furniture surfaces and partition walls is especially important in retaining their optimum condition for as long as possible.

We generally recommend cleaning with a moist, fluff-free cloth, moistened with pure water without the addition of any cleaning agents; furniture polishes or similar.

If cleaning with a damp cloth proves not to be adequate, careful use of a mild plastics cleaner without abrasive additive is admissible on melamine surfaces.

Wood polishes must not be used on open-pored lacquered veneer surfaces (oak, walnut, Macassar and Zebrano). This settles into the open pores, closes them and gives the surface a greasy, glossy appearance after a while. The desired semi-gloss and open-pored veneer appearance is ruined.

Furniture polishes available off-the-shelf can be used for closed-pore lacquered surfaces (cherry, beech and maple). They fill the finest of scratches in the lacquer and cover them up relatively well. An enhanced glossy appearance of the surface is difficult to prevent.

Never use polishes containing silicon, caustic cleaning agents with ammonia additives, alcohol or softeners. The same applies for scratching cleaning agents with abrasive additives.

Glass and material surfaces are to be cleaned in accordance with manufacturer's instructions. Please contact Bene for information and documentation on this matter.

Bene can not assume any liability for damage to surfaces caused as a result of improper cleaning.



Dr. Michael Raufeisen
(Head of Quality & Environment Management)



DI (FH) Karl Zankl
(Departmental Head, Management Furniture)

Safety Instructions



Multiple socket outlets must be fixed correctly and located that way that the plugs can be plugged in and withdrawn easily. Plugs and multiple socket outlets must be positioned that way that in case of correct use of the office furnitures no liquids can flow into or on the electrical equipment.



The cables must be mounted tightly into the strain relief of the foot frame. Connection cables can be installed loose. All lines and cables must be installed that way that there is no danger of shearing off, abrasion or any other mechanical damages.



In case of working tables, which are equipped with movable working surfaces adjustable in height, special care is required. The cable lengths must be dimensioned sufficiently so that the movement of the working surfaces is possible without tensioning or pressing the cable.

Disposal

Instructions for the disposal of Bene products can be found in the environmental report at:
<http://www.bene.com>



BENE HEADOFFICE A-3340 WAIDHOFEN/BBS SCHWARZWIESENSTRASSE 3 TELEFON +43-7442-500-0 E-MAIL OFFICE@BENE.COM

ÖSTERREICH: BREGENZ, GRAZ, INNSBRUCK, KLAGENFURT, LINZ, SALZBURG, ST. PÖLTEN, WIEN. **BELGIUM:** BRUSSELS-ZAVENTEM.
BULGARIA: SOFIA. **CZECH REPUBLIC:** PRAGUE. **DEUTSCHLAND:** ASCHAFFENBURG, BERLIN, BONN, DÜSSELDORF, ESSEN, FRANKFURT,
HAMBURG, HANNOVER, LEIPZIG, MANNHEIM, MÜNCHEN, SCHWENNINGEN, STÜTTGART. **HUNGARY:** BUDAPEST.
IRELAND: DUBLIN. **MIDDLE EAST:** DUBAI. **POLAND:** WARSAW. **ROMANIA:** BUCHAREST. **RUSSIAN FEDERATION:** MOSCOW. **SERBIA:** BELGRAD.
SLOVAKIA: BRATISLAVA. **SLOVENIA:** LJUBLJANA. **SWITZERLAND:** ZÜRICH-WALLISELEN. **UKRAINE:** KIEV. **UNITED KINGDOM:** LONDON.

FACHHANDELPARTNER / TRADING PARTNERS: AUSTRALIA: SYDNEY. **CHINA:** HONG KONG, SHANGHAI. **CROATIA:** ZAGREB.
DENMARK: COPENHAGEN. **DEUTSCHLAND:** BAYREUTH, BREMEN, DONAUWÖRTH, ERLANGEN, MÜNSTER, NÜRNBERG,
REGENSBURG, SAARBRÜCKEN, SAARLOUIS, SÜSSEN. **FRANCE:** ANNECY, AVIGNON, LILLE, LYON, MONTPELLIER, NANTES,
NICE, NIMES, PARIS, REIMS, TOULOUSE. **ITALY:** MÉRAN. **JAPAN:** OSAKA, TOKYO. **KUWAIT:** KUWAIT. **LIECHTENSTEIN:** SCHAAN.
LUXEMBOURG: LUXEMBOURG. **NETHERLANDS:** HAARLEM, ROTTERDAM, WILP. **SPAIN:** BARCELONA. **TURKEY:** ISTANBUL.

HTTP://BENE.COM