

## Product Features

- Full spray
- > 1 gpm
- Angle adjustable
- Easily interchangeable spray nozzle in select finishes
- 1/2" NPT female inlet

## Code Compliance

This unit meets or exceeds the following:

- ASME A112.18.1
- CSA B125.1
- Listed by IAPMO
- Approved for use in Massachusetts

## Available Finishes

Chrome	28405001
Oil Rubbed Bronze	28405621
Brushed Nickel	28405821
Polished Nickel	28405831
Polished Brass	28405931

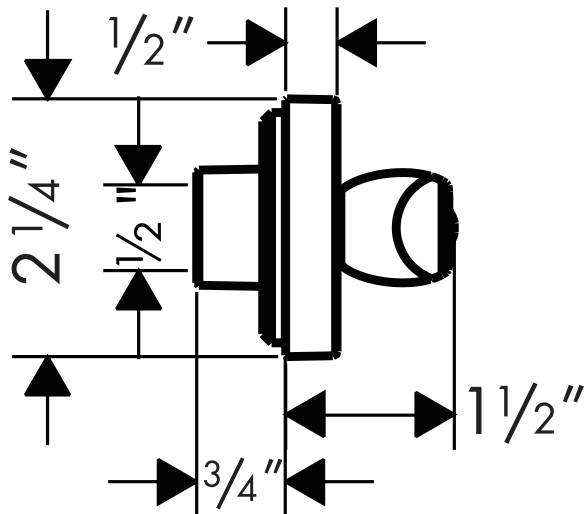

## Optional Accessories

Replacement bodyspray – full	28406XX0*
Replacement bodyspray – massage	28408XX0*
Replacement bodyspray – fog	28409XX0*

\*available in Chrome and Brushed Nickel only

The measurements shown are for reference only.

Products and specifications shown are subject to change without notice.

Specification sheet revised 1/2009