

# Nautilus™ Wall Sheathing Installation Instructions



## Wall Installation

When installing Georgia-Pacific Nautilus™ wall sheathing, the building wrap should face outside of the frame. Maintain 1/8" spacing at all edge and end joints.

Use a minimum 6d common nail spaced 6" o.c. along panel edges and 12" o.c. at intermediate supports. If pneumatic nail guns are used, be sure to set air pressure to drive nail heads flush or a maximum 1/16" below the panel surface to avoid loss of nail holding and shear strength and a point of water entry. Nail guidelines are printed on the panel surface to aid in locating supports for nailing.

**Cutting and Installation of Cut Panels** When cutting Nautilus panels with a circular saw, the panels should be positioned with the building wrap facing down. The cut edge of the panel, when possible, should be installed toward the ground. If the panel's cut edge is vertical or facing away from the ground, tape that edge immediately after installation.

For more detailed installation instructions for Nautilus wall sheathing, please refer to the APA Engineered Wood Construction Guide, Form No. E30 (available in the publication section of [www.apawood.org](http://www.apawood.org)) and to Figures 1 and 2 below. For support and nail spacing, refer to Table 23, and for additional information on wall bracing in high wind or seismic loading areas, refer to Table 28 of the Guide.

Fig. 1 Nautilus™ Wall Sheathing

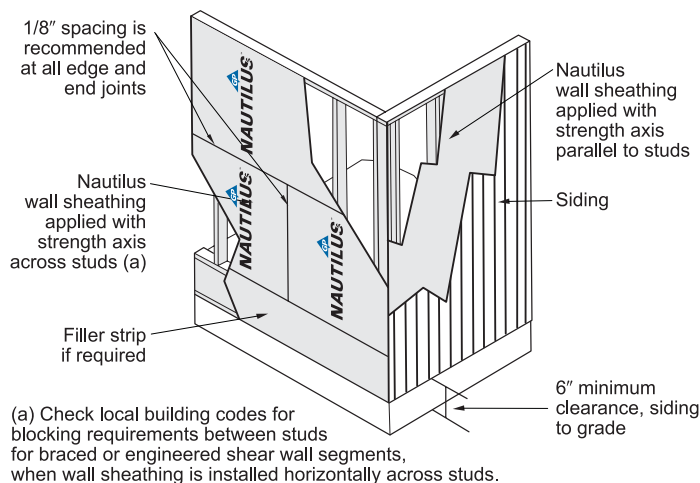
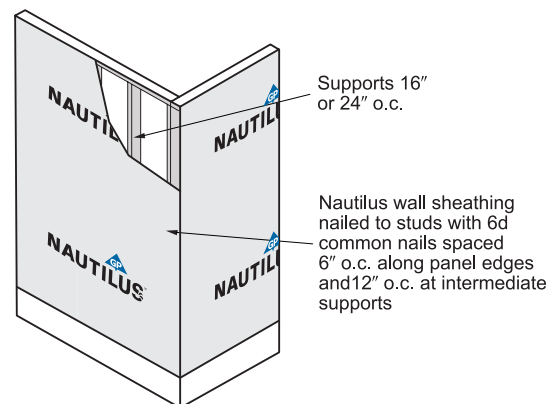

Fig. 2 Nautilus Wall Sheathing  
Corner Bracing



## Taping the Panel Seams

Georgia-Pacific Nautilus™ 3" seam tape must be used to seal over the seams between sheathing panels. Tape substitutions are not allowed and will void warranty. For best performance results, immediate sealing of joints with tape is required.

Before the application of tape, make sure the sheathing surfaces are free from moisture, dirt and other debris. Ensure that the tape is centered over the seam. Apply pressure over the tape to minimize wrinkles and air bubbles and to ensure proper seal.

Whenever tape splices occur, a 3" overlap should be provided. At T joints, the tape should overlap by 1"

## Flashing and Sealing of Penetrations

For window and door installation, please consult the installation instructions for the respective door or window manufacturer as well as code requirements for your area.

For penetrations and terminations of the exterior wall, exterior wall intersections with roofs, chimneys, porches, decks, balconies, and similar projections, and at built-in gutters and similar locations where moisture could enter the wall, follow local building code requirements. Flashing tape must comply with ICC-ES Acceptance Criteria for Flashing Materials (AC148).

The following figures are representative of typical flashing installations and are not intended to address all possible construction scenarios.

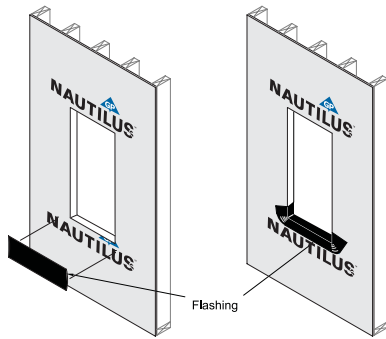

**Installation of Window Sill Flashing**

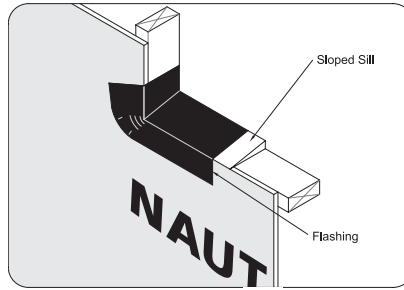

**Installation of Window Sloped Sill**

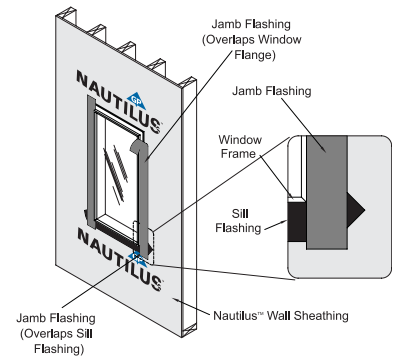

**Installation of Window Jamb Flashing**

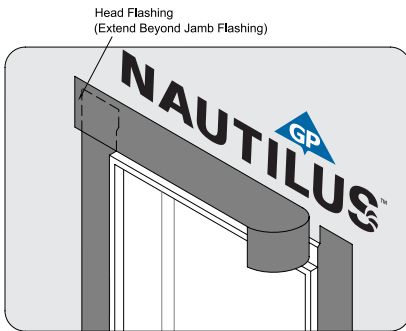

**Installation of Window Head Flashing**

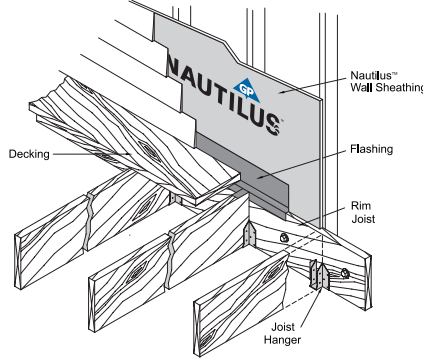

**Installation of Flashing Ledger Board**

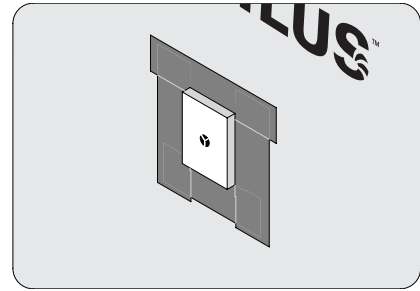

**Installation of Flashing Mounting Block**

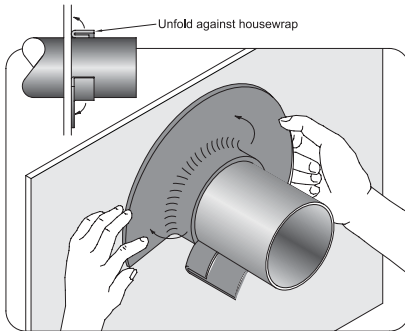

**Installation of Flashing Pipe Penetration**

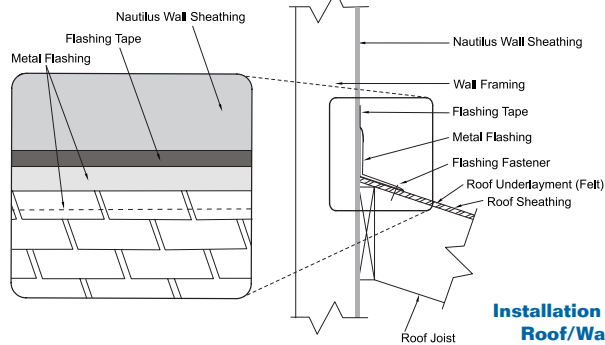

**Installation of Flashing Tape Roof/Wall Intersection**

## Safety Guidelines

Follow all OSHA regulations and any other safety practices when installing Nautilus™ Wall Sheathing. This product is not designed or recommended for roof sheathing uses. Do not stand or walk on top of Nautilus Wall Sheathing panels. Panel surfaces may be slippery especially when they are wet.

## Warranty Coverage

Nautilus Wall Sheathing is covered by a 90-day exposure warranty to the builder or contractor, and a lifetime limited warranty to the original homeowner. Please see the complete warranty from Georgia-Pacific Wood Products LLC for details.\* Nautilus Wall Sheathing must be covered with exterior cladding within 90 days of purchase for warranty coverage. Installation of exterior cladding products should follow manufacturers' installation instructions.

\* Warranty available upon request or at [www.gp.com/build](http://www.gp.com/build).

**NOTE:** The user is responsible for proper installation of our products. Our products must be installed in strict conformity with our instructions and all applicable building code requirements and other regulations. In addition, if not specifically covered by our installation instructions or construction detail illustrations, the products must be installed in accordance with generally accepted design and construction practices. When installing our products, the user must also consider the effects of local climate and geography. We do not warrant and are not responsible for the design and construction of any finished structure or system into which our products may be incorporated or other building components that may be used with our products. A Material Safety Data Sheet (MSDS) containing potential physical and health hazard information is available from your employer or by contacting the Products Safety and Health Information Department at Georgia-Pacific LLC, P.O. Box 105605, Atlanta, GA 30348-5605, (404) 652-5119 or visit [www.gp.com/build](http://www.gp.com/build).

NAUTILUS, the NAUTILUS logo and the GEORGIA-PACIFIC logo are trademarks owned by or licensed to Georgia-Pacific Wood Products LLC.  
©2008 Georgia-Pacific Wood Products LLC. U.S. patent pending.  
All rights reserved. Printed in the U.S.A. 9/08 GP-TM Lit. Item #512126.



**Georgia-Pacific**  
Wood Products

Georgia-Pacific Wood Products LLC  
55 Park Place, 17th Floor  
Atlanta, GA 30303  
**877-437-9759** [www.gp.com/build](http://www.gp.com/build)