



IMPORTANT CONSUMER INFORMATION

sinks + faucets

Care and Cleaning Instructions

Your Elkay faucet has been constructed of the finest materials, however, certain precautions must be taken to maintain the lustrous decorative finish.

Do not use abrasive cleansers or harsh chemical cleansers on this product which could damage the finish.

A warm water wash with a wipedown using a soft cloth will generally remove dry water spots. Never use alcohol or other organic solvents.

A high quality wax, which does not contain abrasives, should be applied periodically to preserve the fine finish of your faucet.

Replacement Cartridge

These faucets use cartridge A54236R.

ELKAY LIMITED LIFETIME FAUCET WARRANTY ON RESIDENTIAL FAUCETS

Limited Lifetime Functional and Finish Warranty

Elkay warrants to the original consumer purchaser that the Elkay faucet purchased will be free from defects in material and workmanship for as long as the original consumer purchaser owns the faucet. Elkay will, at its option, supply replacement parts (or if no longer available a comparable product) if the faucet fails due to a defect in material or workmanship. This warranty does not apply in the event of product surface damage caused by abuse, misuse or improper care and maintenance. This warranty excludes damage caused by harsh or abrasive cleaners and/or materials. This warranty excludes all industrial, commercial and business use, whose purchasers are hereby extended a limited lifetime on mechanical parts and 5 years on finish. Product replacement does not include transportation cost or labor installation cost. Elkay reserves the right to examine product in question and its installation prior to replacement.

OTHER WARRANTY CONDITIONS ON FAUCETS

Our warranty does not cover product failure or damage caused by abusive treatment, misuse, environmental factors, improper care and cleaning, or damage due to handling or faulty installations. This warranty is extended only to the original consumer purchaser of the product. This warranty does not cover shipping costs, labor costs, or any other charges for such items as installation or replacement of the sink, diagnosis or replacement of any faucet or component part, or any other expense or loss.

All incidental or consequential damages are specifically excluded. No additional warranties, express or implied are given. Any implied warranty, including one of merchantability or fitness for a particular purpose, is limited to the duration of this written warranty.

Some states do not allow the exclusion or limitation of incidental or consequential damages or limitations on how long an implied warranty lasts, so the above limitations or exclusions may not apply to you.

This warranty gives you specific legal rights, and you may also have other rights which vary from state to state.

TO OBTAIN SERVICE UNDER WARRANTY

1. Write to: Elkay
Attention: Consumer Services
2222 Camden Court
Oak Brook, IL 60523
2. Include a letter containing the following information:
 - a. Date of purchase and installation
 - b. Description of nature of defect
 - c. Model number or description of model and/or component part if possible.



Installation Instructions

sinks + faucets

How to Install Allure® Faucets

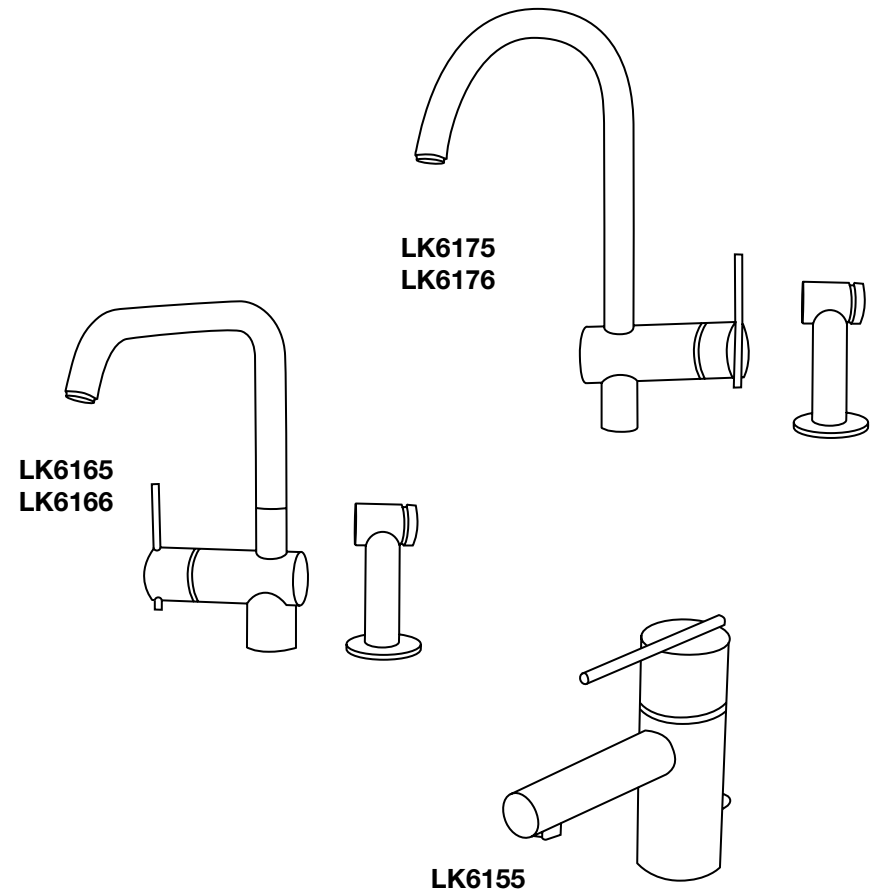

SAVE FOR CONSUMER

Elkay

elkay.com

2222 Camden Court
Oak Brook, IL 60523

Printed in U.S.A.
©2007 Elkay

(Rev. B 7/07) A-55335

ELKAY • 2222 CAMDEN COURT • OAK BROOK, IL 60523

NOTE: DUE TO THE WEIGHT OF THE ALLURE FAUCETS, ELKAY RECOMMENDS THESE FAUCETS BE INSTALLED TO AN 18 GAUGE STAINLESS STEEL SINK (OR HEAVIER) OR TO A SOLID SURFACE COUNTERTOP.

Maximum thickness for solid surface countertop is 1-1/2".

Installation Instructions for LK6155

1. Place the faucet base in the faucet hole. Make sure O-ring is placed between the faucet and the sink (or countertop).
2. Slip the shaped rubber washer over the supply pipes and fasten by fixing the claw and the mounting nut to be tightened on the bolt.
3. Connect the flexible supply tubes to water supply.
4. Place the washer and drain in faucet hole. Washer (1) to be in between drain and sink.
5. Place other washer (2) on top of body and screw onto the drain.
6. Fix the horizontal rod (with ball) to the drain. The horizontal rod must be perpendicular to the wall.
7. Insert the vertical rod in the hole in the back of the faucet and connect it to the horizontal rod with the clamp.

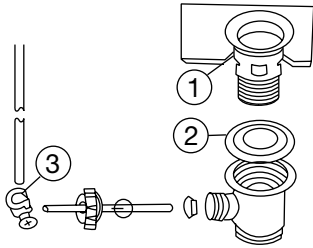

Installation Instructions for LK6165, LK6166, LK6175 and LK6176

1. Insert the spout into the faucet body and lock it with set screw. (Some models are pre-assembled.)
2. Position base sleeve into faucet body. Place plastic washer onto base.
3. Attach 2 supply hoses to faucet body, passing through faucet base.
4. Attach mounting shank to faucet body in similar manner. Attach diverter return hose in similar manner.
5. Pass hoses through hole in deck, making sure plastic ring is positioned between faucet base and deck.
6. If required position support bracket underneath deck.
7. Slip rubber C washer and C bracket over shank and around hoses. Secure faucet assembly with mounting nut.

8. Connect shank extension to mounting shank using 2 copper gaskets. Then attach diverter housing to bottom of shank after inserting a 3/4" fiber washer. Note: Ensure white retaining sleeve remains in diverter housing.
9. Connect check valve adaptor to diverter housing and diverter return hose to adaptor using two 7/16" fiber washers.
10. Attach spray hose adaptor to bottom of diverter using a 1/2" fiber washer.

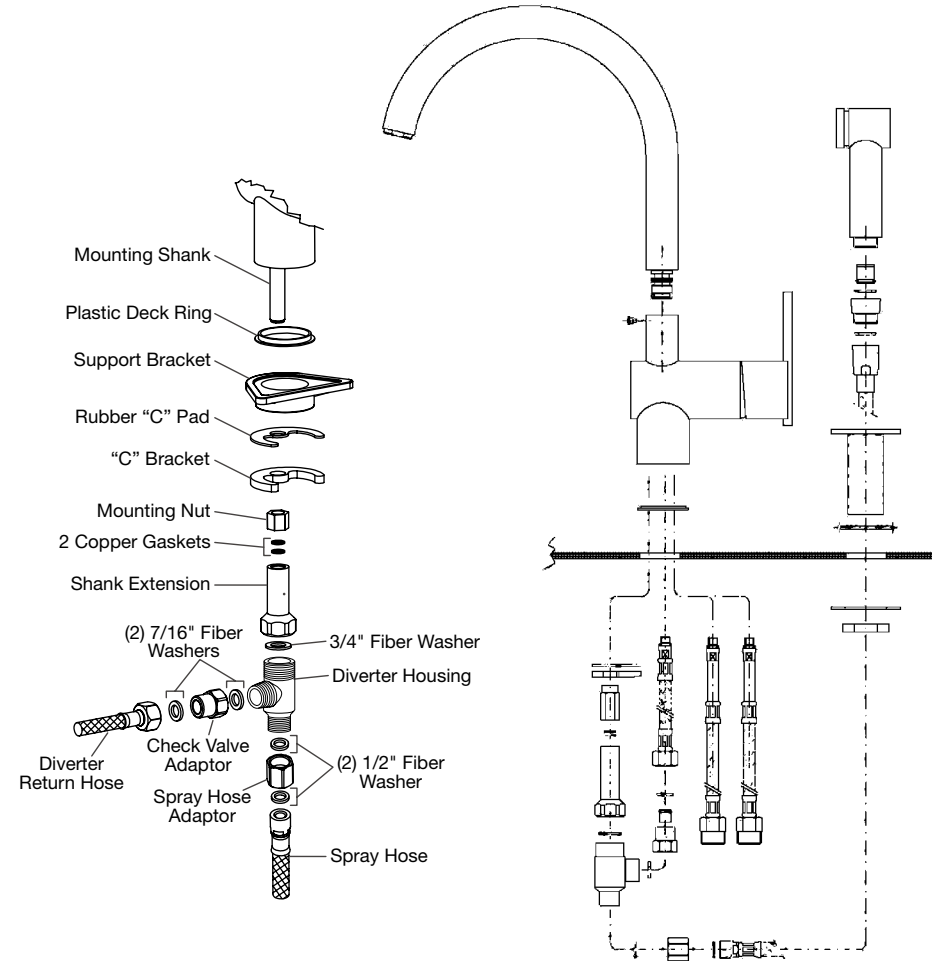

1. Place side spray escutcheon through deck hole. Ensure o-ring remains in position under escutcheon.
2. Place metal washer on shank and secure escutcheon with nut.
3. Slip hose through escutcheon and attach spray hose to side spray adaptor using a 1/2" fiber washer.
4. Check that all fittings are tight. Check for leaks.