

**K&O 3<sup>rd</sup> Generation TV lift**  
with attached  
**K&O Top Slide mechanism**

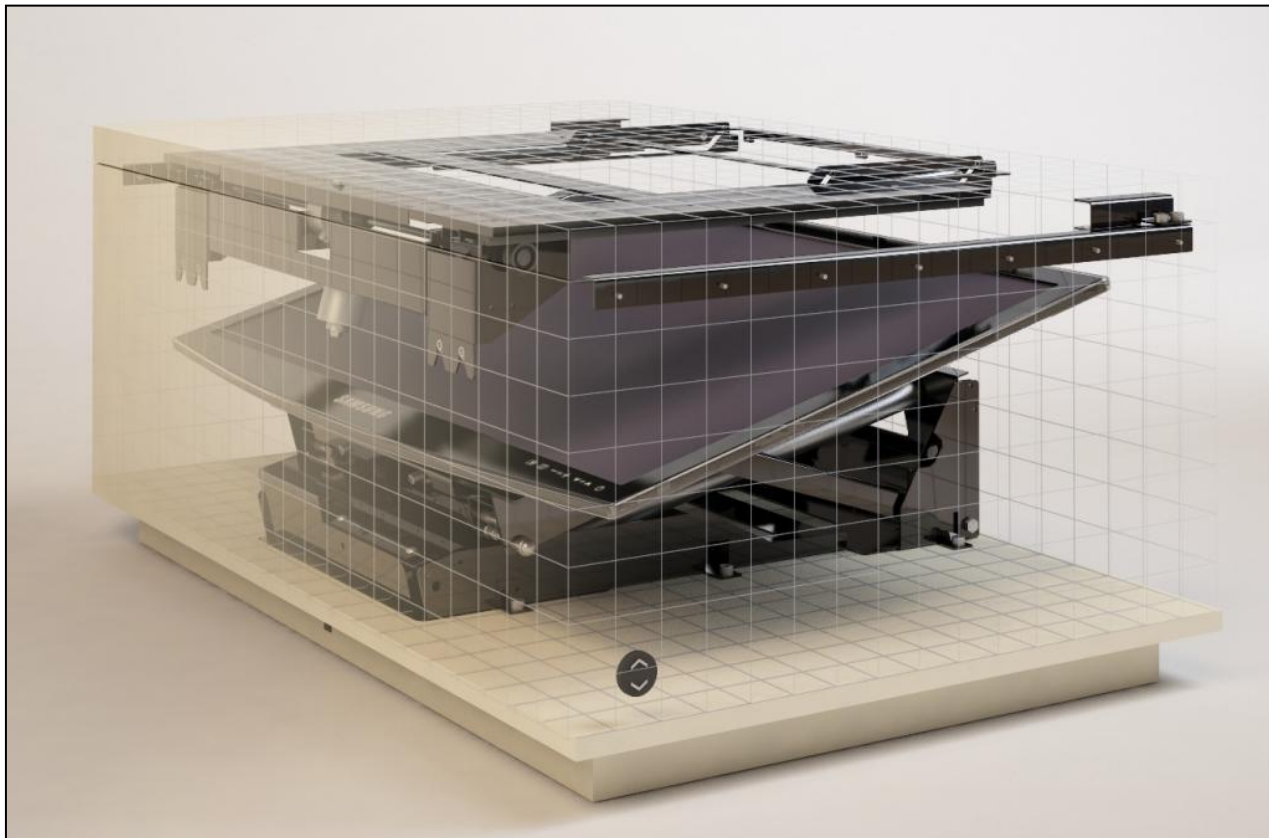

---

Klink & Osse B.V.  
Turfkade 13  
7602 PA Almelo  
Nederland

Tel: +31 (0)644661163  
Fax: +31 (0)546488801  
info@klink-osse.nl  
[www.lcdtvlift.eu](http://www.lcdtvlift.eu)  
[www.klink-osse.nl](http://www.klink-osse.nl)



## GENERAL PRODUCT DESCRIPTION

### 3<sup>rd</sup> Generation 'K&O TV lift' with accessory 'Top Slide' mechanism:

Hide a lcd led or plasma TV up to 47-55 inch in low boards of only 400mm height, hanging the flatscreen at an ideal viewing height.

#### One size fits all:

- Able to handle every brand flatscreen with VESA mounting up to 47-55 inch (W 1250mm H 708mm D 105mm).
- The TV lift includes the 'K&O Top Slide' mechanism, for [horizontal](#) opening and closing of the cabinet.
- When the TV is hidden away the Top Slide is closed entirely.
- Custom cabinet design possibilities for furniture manufacturer.

#### Plug and Play:

- No additional adjustments or installation needed (hardware or software) to install the TV lift in the cabinet or to mount the flatscreen onto the TV lift by the installer or end user.
- Immediately ready when taken out of the box.
- The average TV lift installation time for the installer is less than 30 minutes.
- TV lift installation and cabinet construction manual are included.

#### Ideal viewing height:

- In vertical position (TV UP) the center of the flatscreen is located around 900mm measured from the ground up when installed in a low board; ***an ideal viewing height when lounging in a relaxing sofa or couch.***

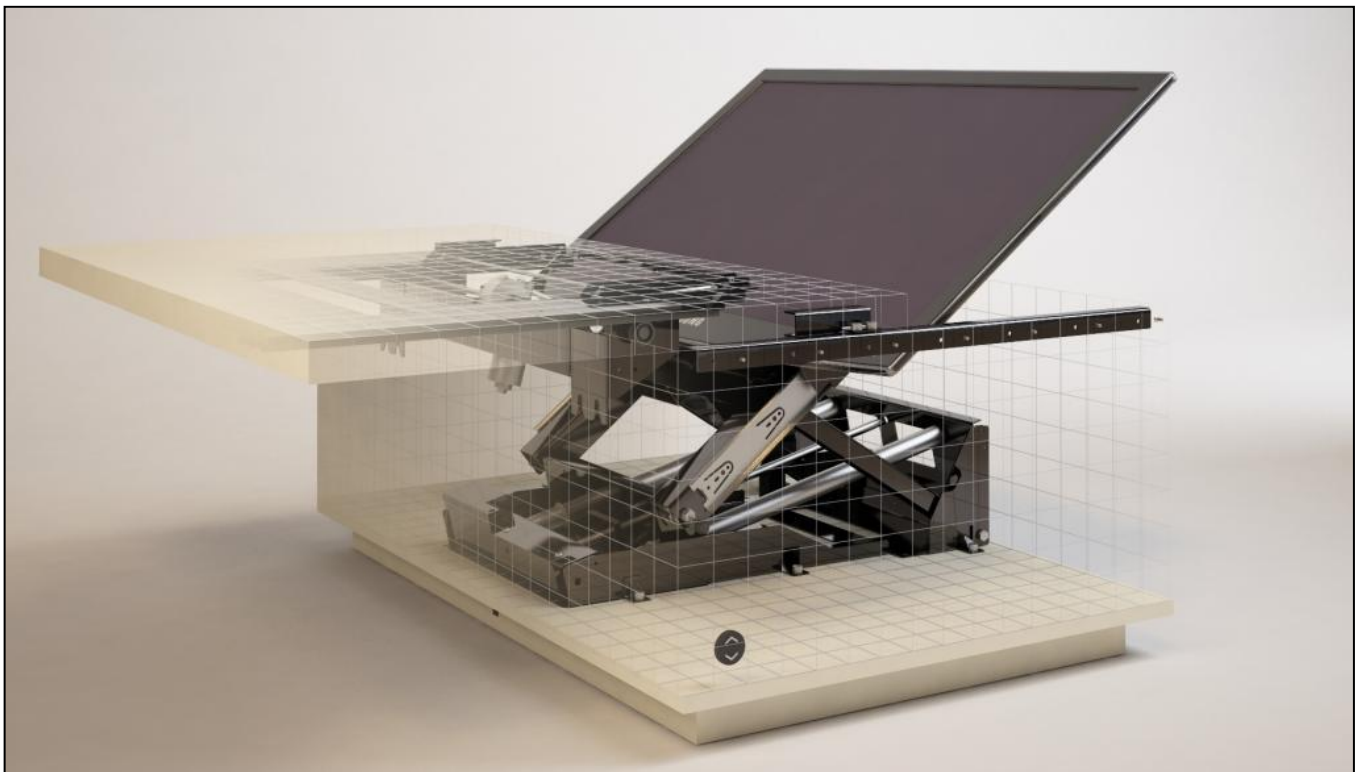

## INDEX

GENERAL PRODUCTDESCRIPTION .....	
INDEX.....	3
1. TV LIFT AND TOP SLIDE MECHANISM.....	
1.1 GENERAL PRODUCTDESCRIPTION .....	4
1.1.1 TV lift.....	4
1.1.2 Top Slide mechanism .....	5
1.1.3 Other content.....	5
2. CABINET DESIGN .....	
2.1 Dimensions cabinet - TV's .....	7
2.2 COMPARTMENT .....	7
2.3 TOP SLIDE .....	8



## 1. TV LIFT AND TOP SLIDE MECHANISM

### 1.1 GENERAL PRODUCT DESCRIPTION

#### 1.1.1 TV LIFT

When the flatscreen is hidden away the TV lift tilts the flatscreen, laying it on its back, significantly reducing the minimal installing height to: **325 mm + depth TV (mm) + 68mm plinth**. This enables the furniture manufacturer to hide flatscreens up to 47-50 inch in cabinets of only 450 mm height, hanging them at an ideal viewing height.

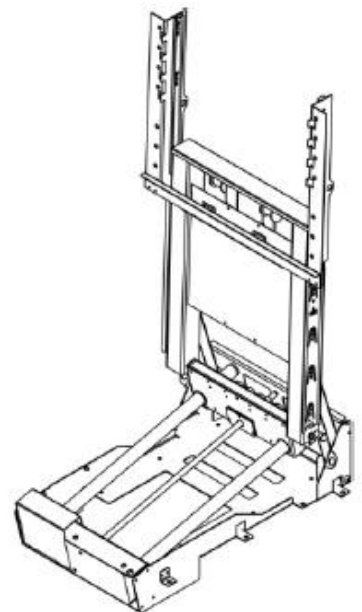
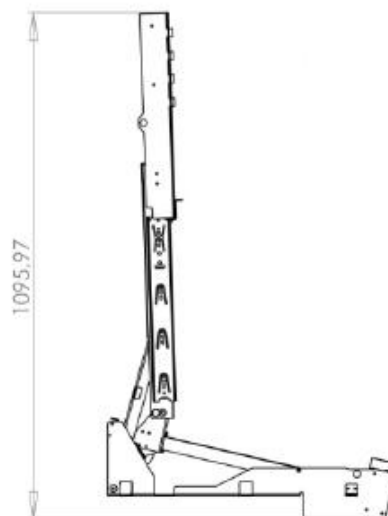
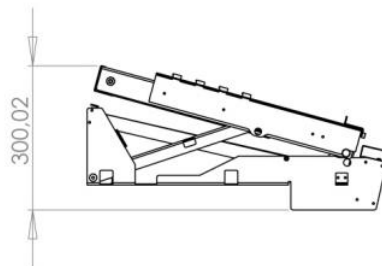
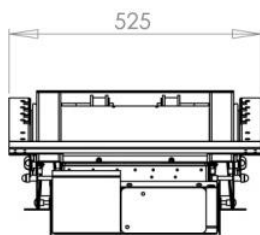
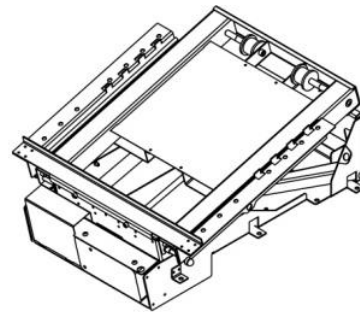
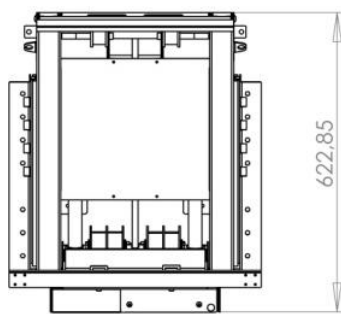

## 1.1.2 TOP SLIDE MECHANISM

The 'Top Slide mechanism' is specially designed for horizontal opening and closing of the cabinet, and standard included with the K&O 3<sup>rd</sup> generation TV lift. The integrated 'Slide mechanism' in the 'Top Slide mechanism' enables the top slide to close entirely when the TV lift is in upright position, by sliding under the top slide. When the TV is hidden away the 'Slide mechanism' fills up the opening in the top slide entirely.

> For more info look at paragraph 2.3 Top Slide or our video's on the internet.

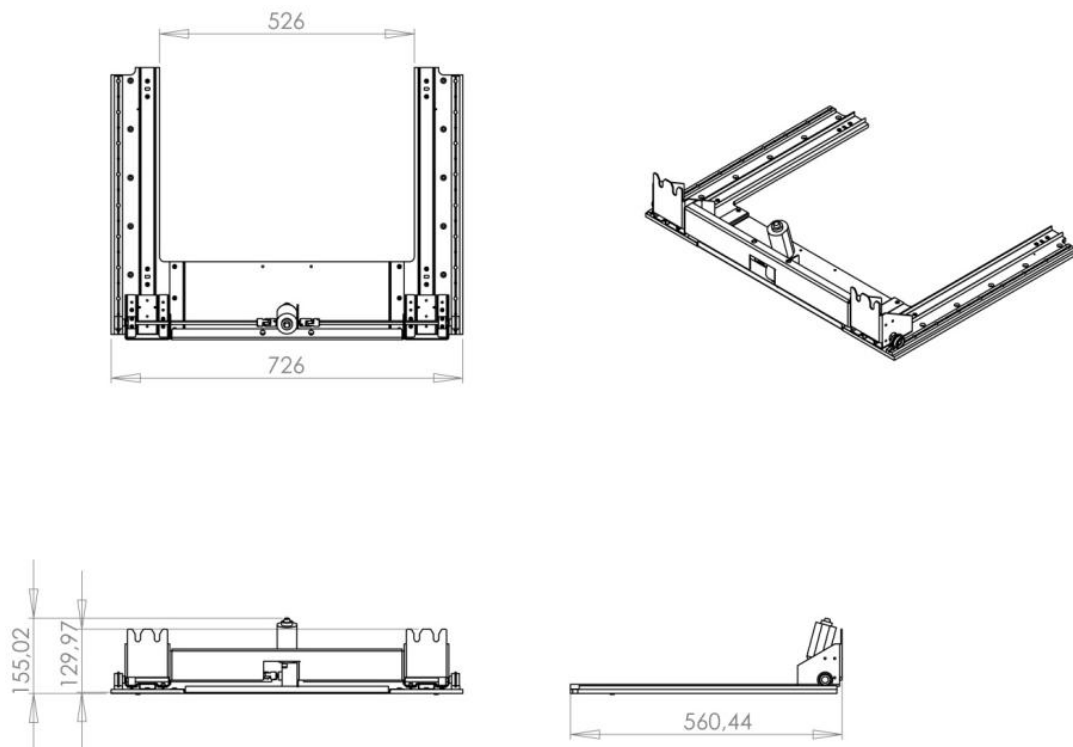

## 1.1.3 OTHER CONTENT

- Remote control

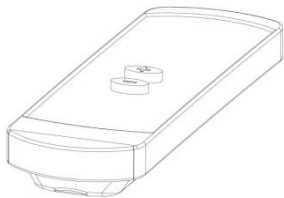

- IR sensor

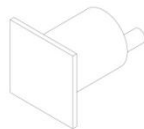

- Manual control

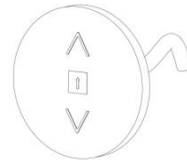

- Sliding strips (2x)

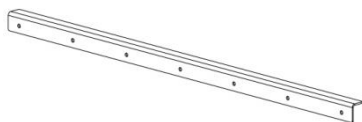

- Sliding brackets (2x)

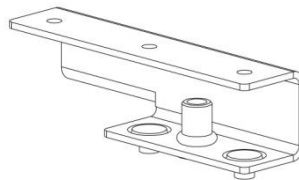

- Sliding plates (2x)



- Top Slide mounting

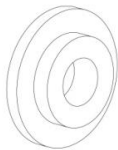

- Allen M8x20 (4x)



- TV mounting brackets

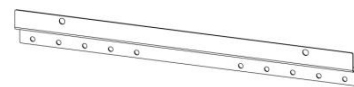

- Tool for cablemanagement

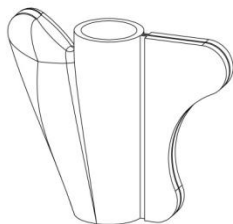

- Power cable

- Manual

## 2. CABINET DESIGN

The furniture manufacturer is free to design their own cabinets as long as they take notice of the minimal requirements. Use at least MDF 18 mm or stronger.

### 2.1 DIMENSIONS CABINET - TV'S

Maximum dimensions flatscreen: 1250 x 708 x 105 mm (wxhxd). For bigger TV's you will need the 3<sup>rd</sup> Generation XL TV lift (delivery not possible yet).

The minimal dimensions of the cabinet are depend of the size of the flatscreen, but the cabinet can never be smaller than 780 x 450 x 660 mm (wxhxd) outer dimensions.

The cabinet is made out of a 'compartment' and a 'top slide'.

### 2.2 COMPARTMENT

The minimal dimensions of the compartment can be measured by the dimensions of the TV:

- Width cabinet = 90 mm + width TV (mm)
- Height cabinet = 325 mm + depth TV (mm) + 68mm plinth
- Depth cabinet = 125 mm + height TV (mm)

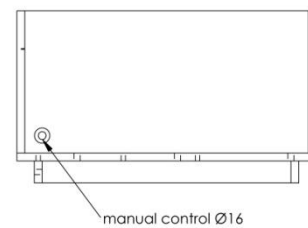
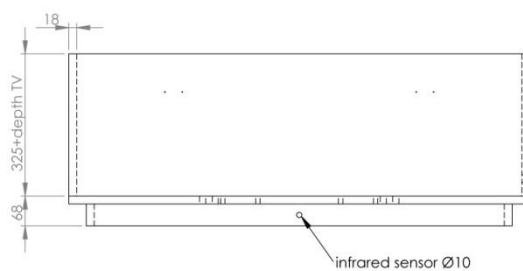
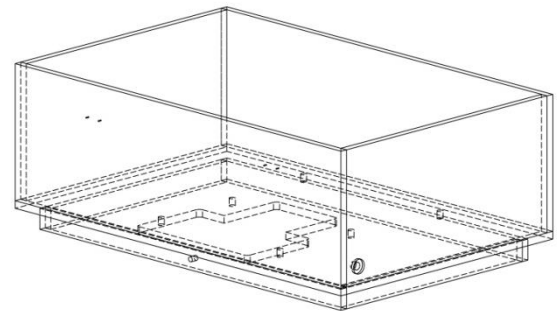
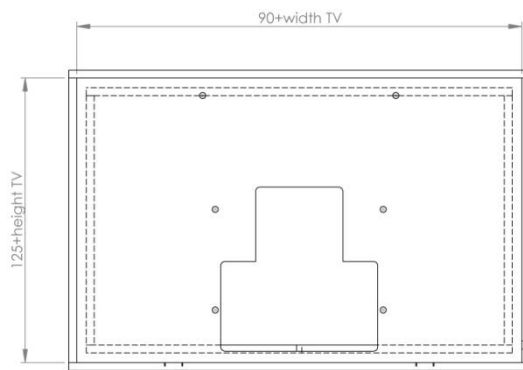

## 2.3 TOP SLIDE

The dimensions of the top slide are depend of the dimensions of the compartment

The top slide needs a minimal free space of 22 mm for proper installation and friction free movement of the top slide.

The slide in the top slide can handle a maximum thickness of 10 mm.

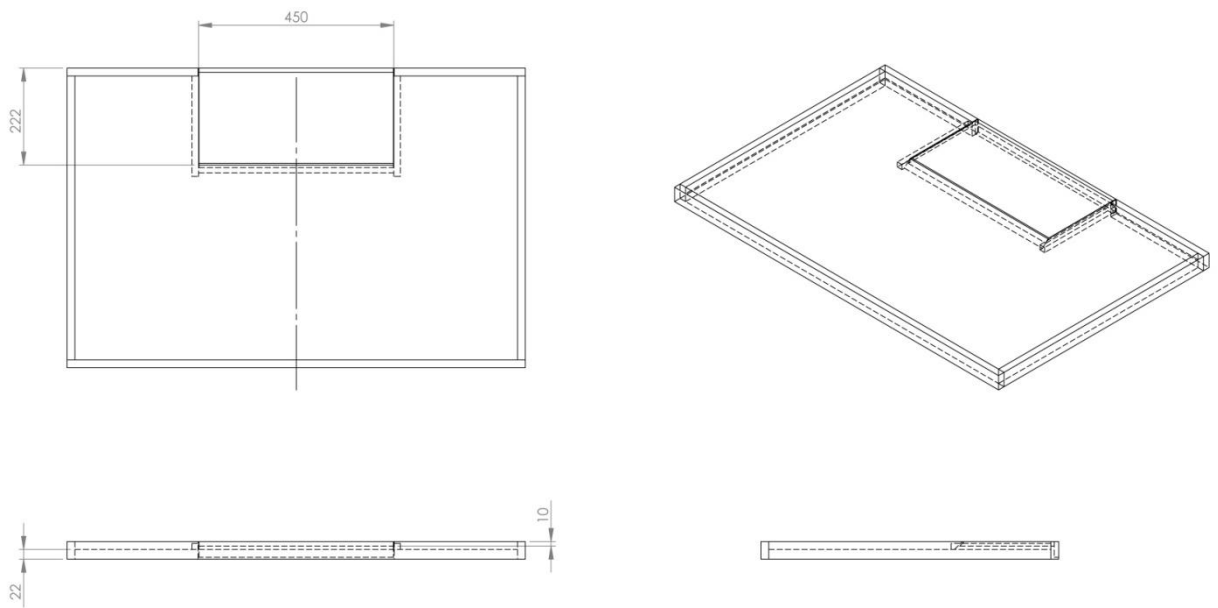

A detailed construction and installation manual is included at delivery of the TV lift