

FDWO76 (drain)
ZUPWO01 (optional plated 8" tailpiece)

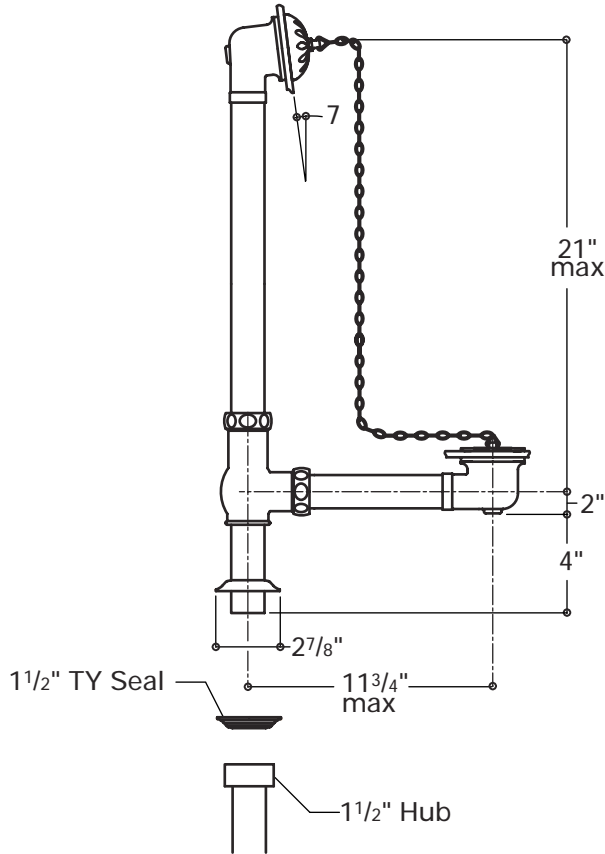

Immediately after receiving the bathtub and removal of packing, you MUST inspect the unit for freight damage. Any claims for damage, whether apparent or hidden, must be made to the carrier immediately in order for them to assume all associated costs. If inspection reveals any defect in the finish, do not install the bath tub. Damage or defect to the finish claimed after the bathtub is installed is excluded from the warranty. The warranty DOES NOT cover labor or materials to remove or reinstall the bathtub.

IMPORTANT:

- To ensure this product is installed properly, you must read and follow these guidelines.
- The owner/user of the bathtub must keep this information for future reference.
- All final connections are made below the finished floor. Accessibility below the finished floor is recommended:
 - For installations that have access from below the finished floor, trap adapter can be used instead of the TY seals supplied.
 - For installations where access from below the finished floor is limited, i.e. slabs, the TY seals supplied are required. The drain

hub and TY seal MUST be installed as close to the surface of the finished floor as possible.

- Be sure your installation conforms to all applicable codes.
- This product must be installed by a professional contractor.
- Refer to the specification and assembly drawings attached.
- Inspect this product to assure it is the correct model and you have all parts required for proper installation.
- Take all necessary precautions to ensure the tub is protected during installation.

DRAIN AND OVERFLOW ROUGH-IN:

1. Dry fit the drain assembly.
 - a. Place the drain collar(20) into the drain opening of the tub.
 - b. Position the shoe(22) under the drain opening and place a gasket(21) between the shoe and the drain opening. Secure the shoe to the drain collar using the screw (19) provided.
2. Dry-fit the overflow assembly
 - a. Determine which tub you are installing - the 70" Savoy (DUBT89) or the 60" Savoy (DUBT26).
 Use 2 flat overflow gaskets(9) on the DUBT89.
 Use 1 flat overflow gasket(9) and 1 wedge overflow gasket(9a) on the DUBT26.
 - b. Place the proper overflow gaskets on the overflow pipe (8) and then hold the pipe flush against the exterior wall of the tub. Secure the overflow cover(11) and stopper assembly(10-18) to the overflow pipe using the screw(12, 13) provided.
3. Connect the overflow to the drain using the tee(5) and then make sure the overflow pipe is plumb and there are no gaps between the overflow gaskets and tub wall. Cut the overflow or shoe pipe to the proper length if the overflow pipe is not plumb.
4. Thread the tail piece(4) into the tee.
5. Determine the placement of the tub and then mark the floor where the tail piece will pass through.
6. Drill a hole through the floor to accommodate the tail piece.
7. Rough in 1 1/2" ABS/PVC and assure all pipe and fittings are well supported to eliminate the possibility of shifting.

11.07.07
 These guidelines have been prepared for the professional contractor to aid in the installation of:
TRADITIONAL WASTE AND OVERFLOW (FDWO76)
OPTIONAL PLATED 8" TAILPIECE (ZUPWO01)
 All dimensions are based on original specifications and are subject to change and variation.
 Please consult your Design Associate for current specifications.

8. **IMPORTANT:** If using TY seals, verify that the face of the 1 ½" hub that will hold the TY seal is positioned as close to the surface of the finished floor as possible to allow the tail piece to be fully inserted into the TY seal/hub.

DRAIN AND OVERFLOW INSTALLATION:

- 9. Clean the drain hole area in the bathtub in preparation of setting the drain. The area should be dry and free of any debris and oil.
- 10. Apply a bead of clear adhesive silicone around the drain collar(20) and then insert it into the drain opening.
- 11. Apply a generous bead of silicone to the drain collar and surrounding area on the underside of the tub. Secure the shoe(22) using the gasket(21) and screw(19) provided. Make sure the screw is fully tightened.
- 12. See step 2 to verify that the proper gaskets for use between the tub wall and overflow head are used. Secure the overflow cover to the overflow pipe using the screw (12,13) provided.
- 13. Connect the overflow to the drain using the tee(5) while making sure the tee hardware (6,7,23,24) is installed properly. Slide the escutcheon(1-3) onto the tail piece(4), apply pipe thread sealant and then thread it into the tee. Position the tub so the tail piece passes through the hole in the floor.

FOR INSTALLATIONS THAT HAVE ACCESS FROM BELOW THE FINISHED FLOOR:

- 14. Tighten the tee hardware and complete final drain connections to the trap adapter(not included).
- 15. Go to step #19.

FOR INSTALLATIONS WHERE ACCESS FROM BELOW THE FINISHED FLOOR IS LIMITED, I.E. SLABS:

DRAIN AND OVERFLOW INSTALLATION:

- 16. Dry-fit the TY seal into the 1 ½" hub, position the tub over the hole in the floor and make sure the tailpiece will fully insert into the TY seal.
- 17. Remove the TY seal, apply clear adhesive silicone to the outside of a TY seal, then insert it into the 1 ½" hub. Apply clear adhesive silicone to the inside of the TY seal.
- 18. With the drain and tailpiece attached, position the tub so the tailpiece passes through the hole in the floor and slides into the TY seal and drain hub as shown.

FINAL INSPECTION:

- 19. Fill the tub with water to the point where water enters the overflow opening. Drain the tub while inspecting all connections above and below the flooring for leaks.

20. Cover the bathtub surface with a bathtub liner or other form of protection until construction is completed.

➤ If further assistance is required, please contact Product Support at 1-800-927-2120 (8am-7pm EST).

WARNING: The following basic safety precautions should always be followed when using your bathtub.

- Caution should always be exercised when entering or leaving the bathtub.
- **DANGER:** To reduce the risk of injury, do not permit children or persons with a disability to use the bathtub without close supervision.
- Keep all electrical appliances such as radios and hairdryers at a safe distance from the bathtub.
- Do not use the bathtub when sleepy or drowsy, under the influence of alcohol or prescription medications or when overheated.

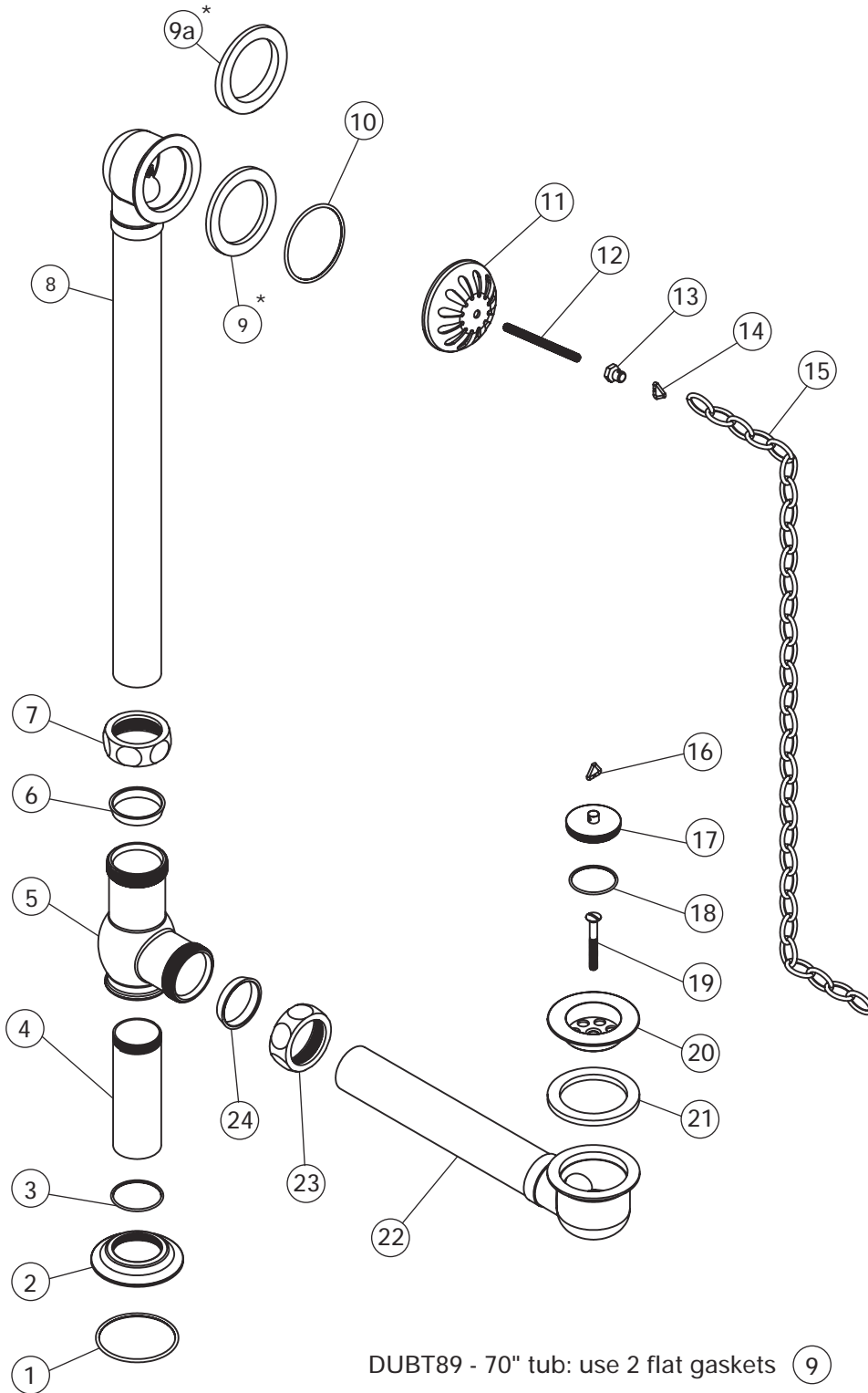

DUBT89 - 70" tub: use 2 flat gaskets (9)

DUBT26 - 60" tub: use 1 flat gasket (9) and 1 wedge gasket (9a)

*Optional 8" tailpiece not shown

11.07.07 These guidelines have been prepared for the professional contractor to aid in the installation of:
TRADITIONAL WASTE AND OVERFLOW (FDWO76)
OPTIONAL PLATED 8" TAILPIECE (ZUPW001)
 All dimensions are based on original specifications and are subject to change and variation.
 Please consult your Design Associate for current specifications.

CARE AND CLEANING

The lustrous finish on your fitting or fixture should be treated with care. Improper handling or cleaning can damage the surface of any finish and void the warranty.

To clean the finish, wipe gently with a soft, damp cloth and then with a soft, dry towel. A mild soap solution can be used for daily cleaning. THE USE OF UNAUTHORIZED POLISHES, ABRASIVE CLEANERS, SOLVENTS, AMMONIA-BASED PRODUCTS, OR ACID BASE CLEANERS MAY DAMAGE THE FINISH AND WILL VOID THE WARRANTY.

Water contains lime and other minerals that are deposited after the water has evaporated. You can prevent deposits from forming by always wiping the fitting dry after use.

In addition to the aforementioned care instructions, the following points are specific to certain finishes or products only. Always read and follow the instructions when using any cleaning or polishing products.

NON-METAL TUBS

In addition to mild soap and water, a non-abrasive basin tub and tile cleaner is recommended for regular cleaning and disinfecting. The use of any other cleaners or disinfectants may alter the surface finish and void the warranty.

WHIRLPOOL AND AIRTUB SYSTEMS

Jet Fresh whirlpool cleaning solution is recommended for maintaining waterworks.

ANTIQUED COPPER AND BRASS

Select Waterworks fittings and basins are offered in finishes that have been artificially weathered, creating a patina that will develop and change with time. In addition to mild soap and water, a natural citrus-based product may be used for regular cleaning. The use of any other cleaners or disinfectants may alter the surface finish and void the warranty. Please note that prolonged contact with certain items such as toothpaste, acidic fruits and vegetables, and wines will alter the surface finish. Also, the use of polishing agents will remove the patina and restore the metal to its original shine. Once removed, the patina will naturally redevelop with time.

ARCHITECTURAL BRONZE

In addition to mild soap and water, a natural citrus-based product may be used for regular cleaning. The use of any other cleaners or disinfectants may alter the surface finish and void the warranty. Please note that prolonged contact with certain items such as toothpaste, acidic fruits and vegetables, and wines will alter the surface finish. Also, the use of polishing agents will remove the finish.

CHINA, CERAMIC AND PORCELAIN

Do not use abrasive cleaners, as this will dull the surface finish. A non-abrasive basin tub and tile cleaner is recommended for regular cleaning and disinfecting. The use of any other cleaners or disinfectants may alter the surface finish and void the warranty.

CHROME

In addition to mild soap and water, a non-abrasive basin tub and tile cleaner is recommended for regular cleaning and disinfecting. The use of any other cleaners or disinfectants may alter the surface finish and void the warranty. Cape Cod Polishing Cloths may be used for the occasional polishing. If you desire additional protection, the use of Faucet Brite will aid in protecting the surface finish from mineral deposits present in your water supply. This should be reapplied as necessary to continue protection.

MATTE NICKEL, LUMIN AND GOLD

In addition to mild soap and water, a non-abrasive basin tub and tile cleaner is recommended for regular cleaning and disinfecting. The use of any other cleaners or disinfectants may alter the surface finish and void the warranty. Also, the use of polishing agents will remove the finish. If you desire additional protection, the use of Faucet Brite will aid in protecting the surface finish from mineral deposits present in your water supply. This should be reapplied as necessary to continue protection.

NICKEL

In addition to mild soap and water, a non-abrasive basin tub and tile cleaner is recommended for regular cleaning and disinfecting. The use of any other cleaners or disinfectants may alter the surface finish and void the warranty. Cape Cod Polishing Cloths may be used for the occasional polishing. The use of any other polishing agents will remove the finish and void the warranty. If you desire additional protection, the use of Faucet Brite will aid in protecting the surface finish from mineral deposits present in your water supply. This should be reapplied as necessary to continue protection.

SILVER

Fittings offered in a silver finish will tarnish with age. This finish may be restored to its original luster by using Faucet Brite or a non-abrasive silver polish. This should be reapplied as necessary to continue protection. Faucet Brite will also help to prolong the time between regular polishing.

UNLACQUERED BRASS AND COPPER

Items purchased in the unlacquered brass and copper finishes will change with time as they develop a natural patina. The original shine can be restored using Faucet Brite or an appropriate polishing compound. If you desire additional protection, the use of Faucet Brite will aid in protecting the surface finish from mineral deposits present in your water supply and prolong the time between regular polishing. This should be reapplied as necessary to continue protection.

WARRANTY

LIMITED LIFETIME MECHANICAL WARRANTY:

Waterworks warrants to the initial purchaser all plumbing and accessory products sold by Waterworks, which are installed in a residence to be used in a residential application, to be free from manufacturing defects in materials and workmanship for as long as the purchaser continues to own and maintain the residence where the products are initially installed.

FIVE-YEAR FINISH WARRANTY:

Waterworks warrants to the purchaser the finish of all plumbing and accessory products sold by Waterworks, which are installed in a residence to be used in a residential application, to be free from manufacturing defects in materials and workmanship for a period of five years from installation of the products. Waterworks must receive notice of any warranty claim within the five-year warranty period.

REPAIR OR REPLACEMENT:

If within the applicable warranty period the covered products shall be proved to the satisfaction of Waterworks to be defective, Waterworks will repair or replace such products, at its expense (provided that such repair or replacement shall not include installation costs). Waterworks' obligation shall be limited to such repair and replacement and shall be conditioned upon Waterworks' receiving notice of any alleged defect within the applicable warranty period. Purchaser shall be responsible for all shipping charges for returned products.

LIMITATIONS ON WARRANTY COVERAGE:

The warranties set forth above shall be extended only to the purchaser and do not apply to any purchaser where the products are used for commercial applications and usage. Furthermore, the warranties do not cover installation or any other labor charges and do not apply to:

- (i) products which have been repaired, altered or modified in any way by purchaser or any person other than Waterworks or not using original Waterworks spare parts, unless previously authorized in writing by Waterworks;
- (ii) products which have not been installed, used, maintained or stored in accordance with the instructions provided to purchaser by Waterworks;
- (iii) products which have been used for purposes other than or in a manner contrary to their intended and normal use;
- (iv) products which have been damaged as a result of misuse, negligence, freezing, accident or faulty installation or maintenance; and
- (v) products damaged by the effects of dirt, salt water air, hard water, limescale, or abrasive or aggressive cleaners. If the normal life span of any product is shorter than the applicable warranty period, the warranty shall apply only during the period of such shorter life span.

NOTICE OF WARRANTY CLAIMS:

For all warranty claims please call Waterworks Product Support at 800-927-2120, or write to Waterworks Product Support at 60 Backus Avenue, Danbury, Connecticut 06810.

The warranties provided herein are conveyed only to the purchaser of products sold by Waterworks after January 1, 2000, and installed in a residential application.

Except as specifically set forth above, Waterworks does not make any other warranty, express or implied, including without limitation, any implied warranty of merchantability or fitness for a particular purpose. In no event shall Waterworks be liable to any person or entity for any indirect, special, incidental or consequential damages or loss (including damages for loss of business, loss of profits, or the like), whether based on breach of contract, tort (including negligence), product liability or otherwise, even if it has been advised of the possibility of such damages. Waterworks' liability on any claim of any kind, including negligence, shall in no case exceed the contract price paid by the purchaser for the product claimed to be defective or unsuitable.