

VISION[™]

The Next Generation in Stainless Seating

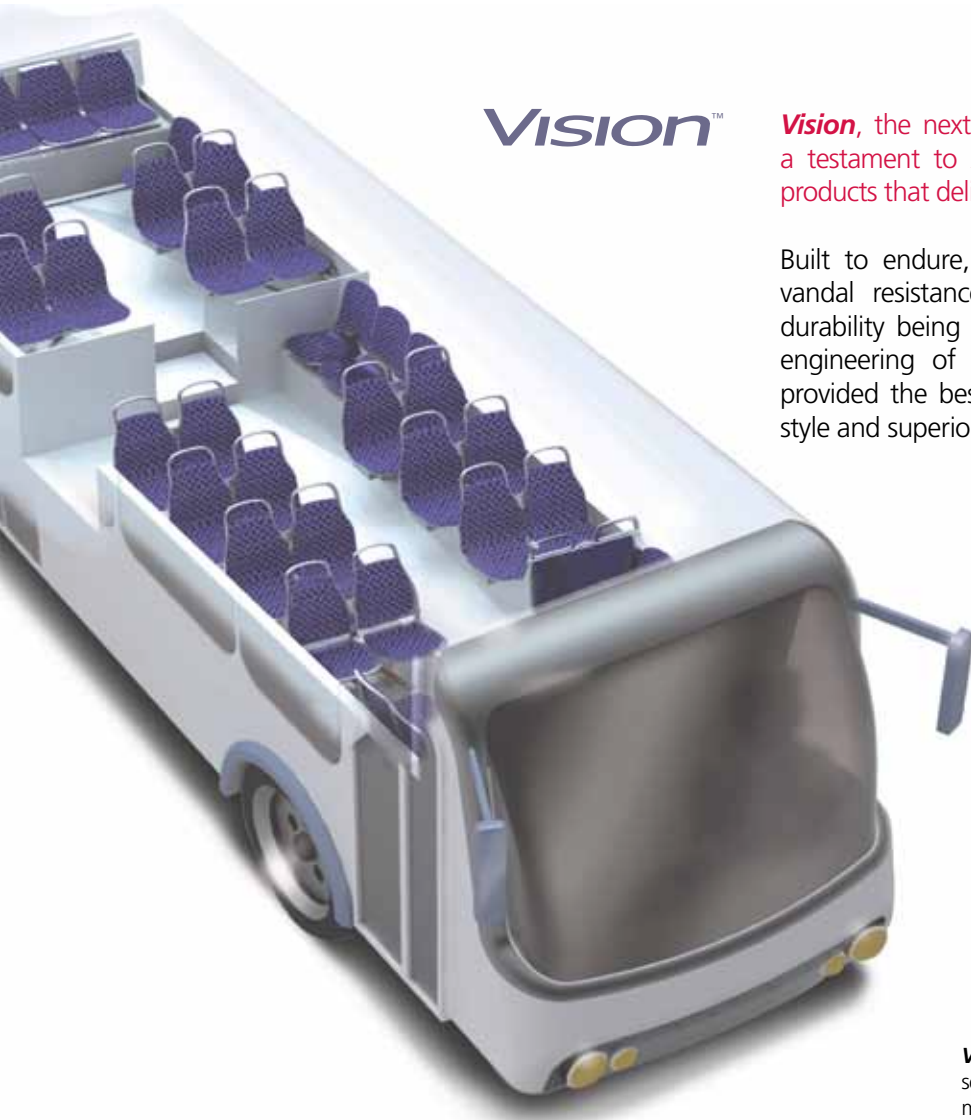



VISION™

Vision, the next generation in stainless seating, is a testament to American Seating's reputation for products that deliver a high return on investment.

Built to endure, **Vision** provides the ultimate in vandal resistance and durability. In addition to durability being a top priority for the design and engineering of the seat, American Seating has provided the best in advanced ergonomic design, style and superior comfort.



Vision's slim profile and seat contour creates more space for enhanced ingress and egress and superior comfort.



The **Vision** family of seats is designed and engineered to offer the following features and benefits:

Ultimate vandal resistance	Stainless steel construction and no visually exposed fasteners within easy reach of passengers provide the ultimate in vandal resistance. The seats can be fitted with vandal resistant VR-50® or cut resistant CR-50® cushion inserts.
Unsurpassed quality, craftsmanship and durability	One-piece continuous stainless steel modular frame results in improved consistency in fit and finish. Heavy-duty construction for long life, and backed by the industry's strongest warranty. Designed to meet or exceed White Book standards.
Superior comfort	Innovative, ergonomic seat design features the largest personal seating area, a slim-line profile, increased back height, spaciousness in legroom, and seat and back cushions to meet specific customer needs.
Contemporary styling	The new aesthetic design has a seamless, polished stainless steel frame with a stamped polished stainless steel back panel. Individual seat modules feature an integral grab rail and no unsightly welds or exposed fasteners on the seat upper.
Easier installation & minimal maintenance	The modular design allows replacement of a single seat or major component if necessary. Cushion inserts are designed for quick-release for ease of maintenance, and the seat's design minimizes the number of dirt-collecting areas by eliminating spacers.
Improved accessibility	The slim-line contoured design allows for increased spaciousness and smooth transition between seats, while also enhancing ingress and egress.
Fully A.D.A. compliant	Compatible with American Seating's exclusive Advanced Restraint Module® (A.R.M.)® and Dual Auto-Lok® , both industry benchmarks in securement.

* Maintaining White Book aisle space.

American Seating has *VISION*™

Feature options:

Variety of quick-release cushion inserts	<ul style="list-style-type: none"> ■ Standard padded cushion (optional drain hole) ■ Plush padded cushion ■ VR-50® patented vandal-resistant cushion (optional drain hole) ■ CR-50® cut-resistant cushion; standard and plush pad
Docket 90A	Select foam, fabric and trim pieces
Thermoplastic grab rail	Available in 1471 Charcoal, 980 Grey, 989 Blue and 1981 Yellow. Custom colors also available



1-2 Passenger Transverse

- 18" seat width
- Polished stainless steel back panel
- Stainless steel or thermoplastic grab rail (available without grab rail)
- Standardized hardware
- No visually exposed fasteners on the seat upper within easy reach of passengers
- Optional die cast aluminum stanchion cup
- Wide array of mounting configurations customized to fit customer applications and seating layouts

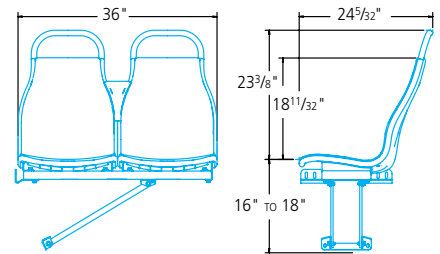

Stainless steel grab rail



Thermoplastic grab rail

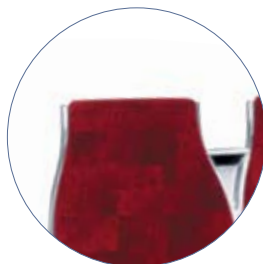

Without grab rail

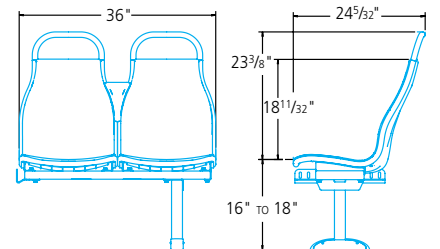

2 Passenger Transverse Flip-Up

- 18" seat width
- Polished stainless steel back panel
- Locking options: up and down position, up or down only position or no locking mechanism
- Stainless steel or thermoplastic grab rail
- Stainless steel and thermoplastic seat bottom closeouts
- Optional die cast aluminum stanchion cup
- Wide array of mounting configurations customized to fit customer applications and seating layouts
- Integrates with exclusive American Seating mobility aid securement products for A.D.A. compliance

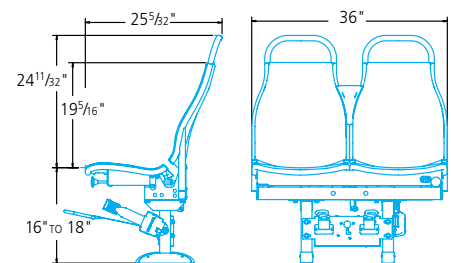

THE NEXT GENERATION IN STAINLESS SEATING



1-5 Passenger Longitudinal

- 17" seat width
- Armrest restraints:
 - Stainless steel tubular retaining arm with or without stainless steel panel insert
 - Closed vacuum-formed energy arm available in 980 Grey or 1471 Charcoal
- Standardized hardware
- No visually exposed fasteners on the seat upper or within easy reach of passengers (without arm restraint)
- Full length or partial thermoplastic back closeout
- Wide array of mounting configurations customized to fit customer applications and seating layouts

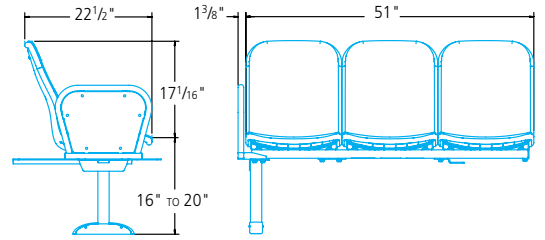

1-3 Passenger Longitudinal Flip-Up

- 17" seat width
- Locking options: up and down position, up or down only position or no locking mechanism
- Fixed stainless steel tubular arm restraint or fold-up armrest
- Partial thermoplastic back closeout
- Stainless steel and thermoplastic seat bottom closeouts
- Wide array of mounting configurations customized to fit vehicle construction and seating layouts
- Integrates with exclusive American Seating mobility aid securement products for A.D.A. compliance

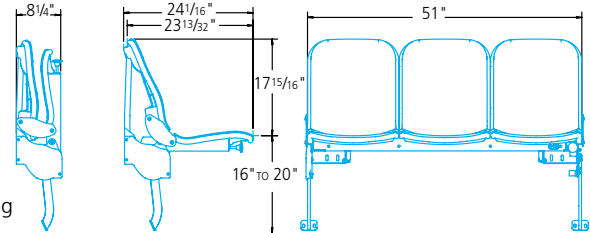

2-5 Passenger Rear Cross

- 18" seat width
- Standardized hardware
- Optional gas spring lift-assist
- Wide array of mounting configurations including various engine access options

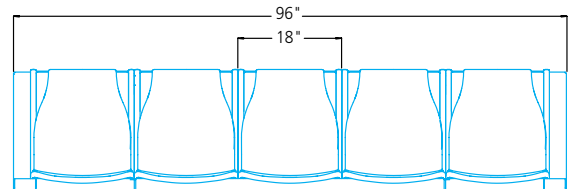



Barrier

- High-strength thermo resin panel
- Stainless steel or thermoplastic grab rail
- Standard panel colors are 980 Grey and 1471 Charcoal. Other current colors are available*
- Integrates with exclusive American Seating mobility aid securement products for A.D.A. compliance

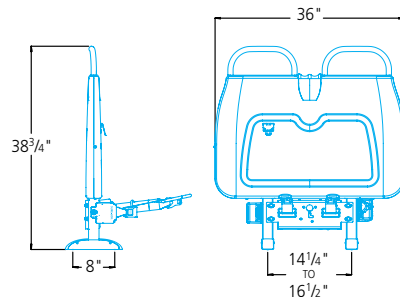

* InSight®, Metropolitan® and Model 6468 barrier colors

Mobility Aid Securement:



Dual Auto-Lok®

- Patent-pending system with built-in time delay mechanism allows free movement of belts for preset time and both hands to be free to secure the mobility aid, which minimizes awkward body movements and saves time
- Non-power maintenance-free system has no cables, wiring or components to adjust or replace
- Compact modular design integrates with barriers and forward facing flip-up seating; allows quick and easy replacement of components if needed and easily adapts to the majority of vehicle layouts for retrofit

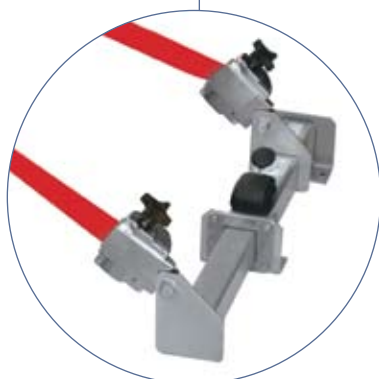
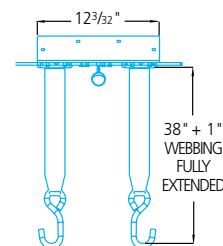
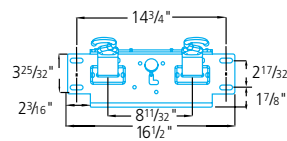

Advanced Restraint Module (A.R.M.)®

- Patented and exclusive positive-locking safety feature provides easiest, and safest securement
- Telescoping model features integrated quick-release mechanism
- Available for front, center or rear tie-down applications and in a pivoting model type
- Stores easily when not in use

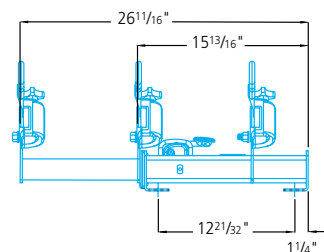
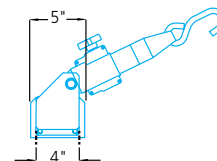

Since 1886, American Seating has set the standard for product design, durability and comfort. Today, we remain committed to exceeding the expectations of our customers. Our achievements serve as the platform for new and innovative products that continue to be the benchmark of our industry.



401 American Seating Center
Grand Rapids, MI 49504-4499
Phone 616-732-6600 800-748-0353
FAX 616-732-6401
americanseating.com

American Seating, Advanced Restraint Module, A.R.M., InSight, Metropolitan, VR-50 and CR-50 are registered trademarks of American Seating Company.
Vision is a trademark of American Seating Co.
Dual Auto-Lok is a registered trademark of Sure-Lok Inc.
Form No. T-VISION-09 ©2009 American Seating Company Litho in USA



American Seating is committed to lessening our impact on the planet through responsible stewardship of our environment.