



**Shock Mounted Marine  
Water Closet Bowl**  
*Vitreous China*

**FEATURES**

• **3M969 Seaway™**

**Bowl:** 3M969 Seaway™ vitreous china shock mounted water closet.

**Valve:**\* Naval chrome plated flushvalve with metal oscillating handle and inlet for silbrazing.

**Supply:** Chrome plated 1 1/2" elbow flush connection with flexible hose, hose clamps, chrome plated spud escutcheon, gasket and ring.

**Mounting:** Neoprene and steel support.

**Outlet:** 4" neoprene outlet, elbow with clamp.

**Seat:**\* Black plastic open front seat with self-sustaining check hinge.

**NOTES**

- For complete parts breakdown refer to applicable Bureau of Ships drawings.
- This closet can be furnished with non-magnetic trim when so specified.

This closet is produced in compliance with the Bureau of Ships drawings 810-1385832, Sheets 1 and 2; and 810-1385705, Sheet 1 of 1.

- 1 Pedestal
- 3 Mount, Shock
- 6 Bolt, 45 Degree Cone Point
- 7 Bolt
- 8 Washer
- 9 Washer
- 10 Lockwasher, 1/4"
- 11 Nut, Acorn
- 12 Elbow, Discharge
- 13 Yoke, Discharge
- 14 Stud, Cone Point
- 16 Washer
- 17 Hose Clamp
- 18 Hose Clamp, Discharge
- 19 Supply, Elbow
- 20 Ring, Escutcheon
- 21 Ring, Union
- 24 Strip, Cover
- 27 Hose, Supply
- 28 Nut, Acorn
- 29 Washer

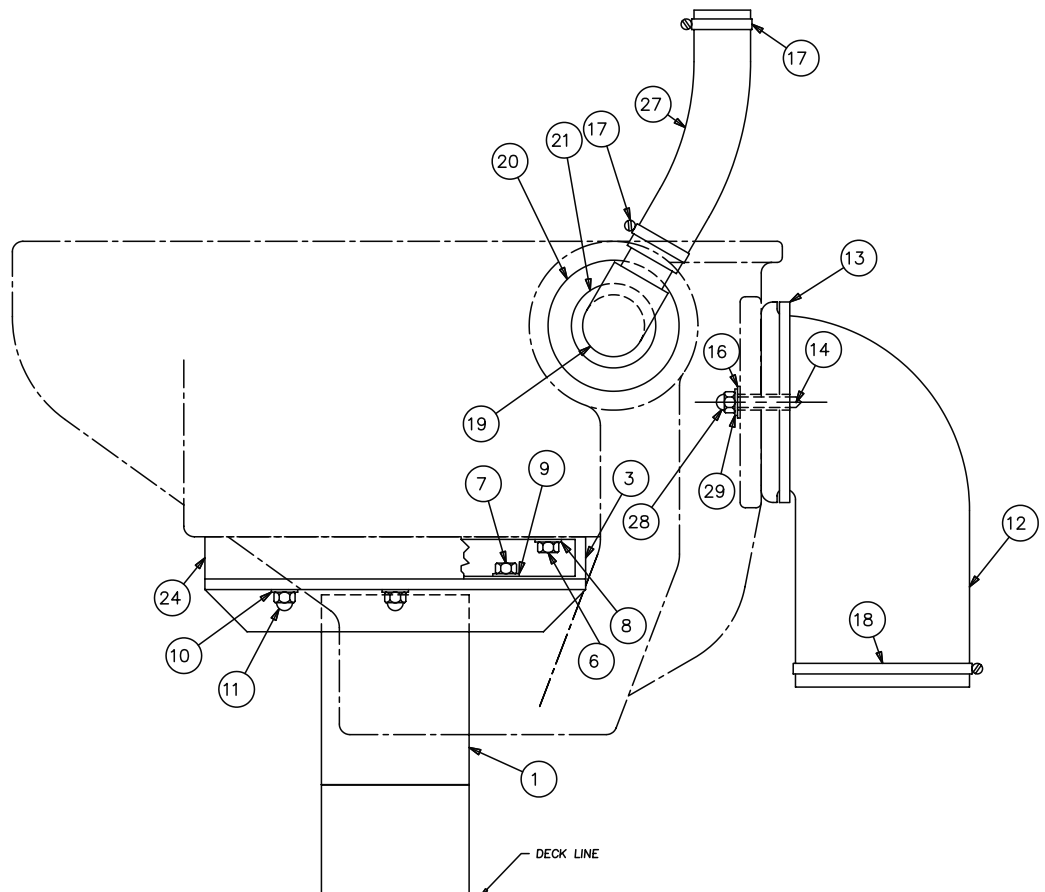

Numbers shown on drawing are item numbers per Bureau of Ships drawing. For complete parts breakdown refer to applicable Bureau of Ships drawings.