

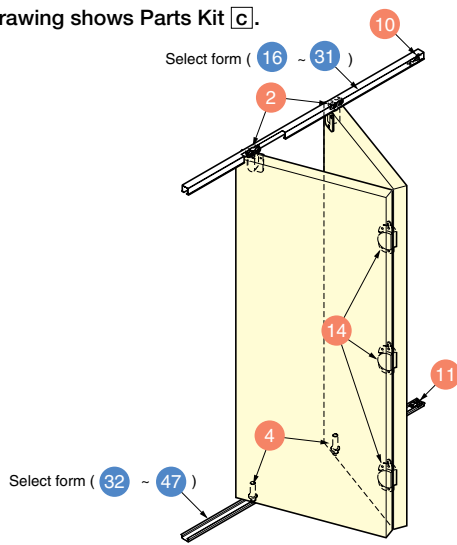

Door Thickness	Min. 30mm (1-3/16")
Door Weight	Max.15kg (33lbs) per door

- Thin profile allows flexible design on various application
- Folding door hardware series with various optional parts
- Height adjustable
- Closed position adjustable on center hinge
- Can be used on closet doors, partitions etc.
- \*Designed for interior use, not exterior.

■ Drawing shows Parts Kit .



■ Door Installation

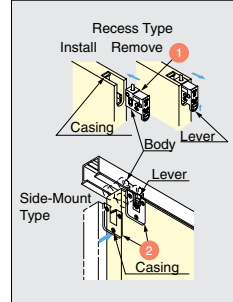

Insert Bracket 1 or 2 to hang door. To remove door, click the lever and pull out the Bracket.

■ Height Adjustment

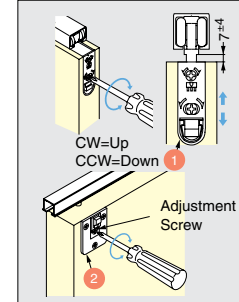

Simply turn the adjustment screw with a screw driver. ±4mm adjustable.

■ Magnetic Catch 12

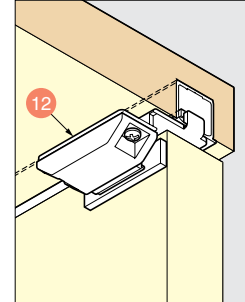

Slide in the strike bracket to track. Adjust strike position and fasten tightly. Screw on magnetic catch to top board.

■ Door Preparation

Roller (Recess Type) 1

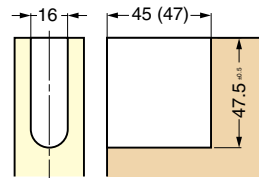

Dimension ( ) is when using End Cap 48.

Roller (Side-Mount) 2

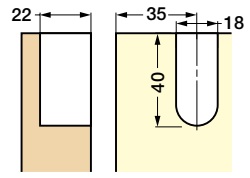

Center Hinge 14

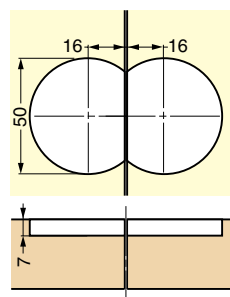

Center Hinge 15

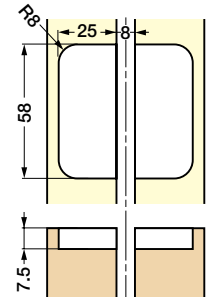

Bottom Pin 3  
Guide Pin 4

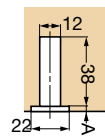

Item No.	A
FD30-FBP 3	5
FD30-FGR 4	3

Door / Wall Gap  
(When using Roller 2, Stopper 10, and 11)

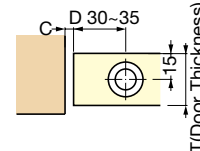

T	Gap C	
	D 30	D 35
30	5.0	3.6
35	6.6	5.8
40	9.6	8.5

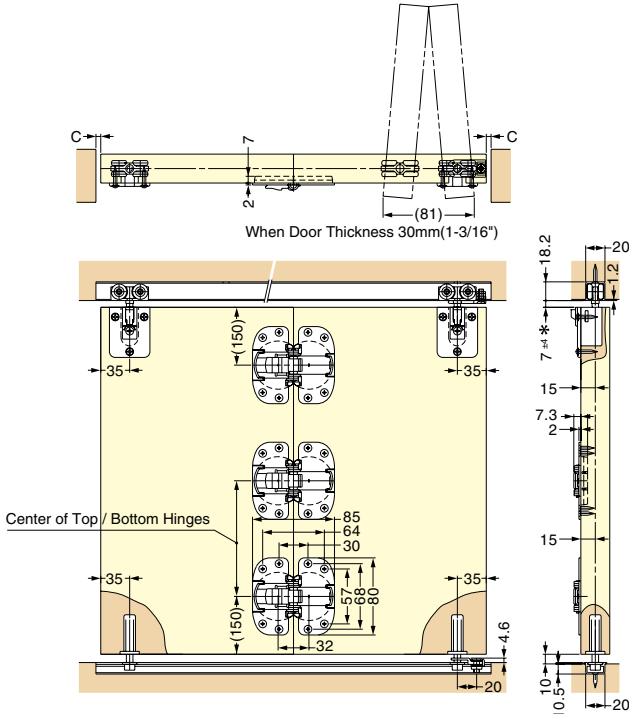

\*Door height adjustable ±4mm.

