

SIMPLEX®

CEILINGS

255 Montpelier, St. Laurent
(Montreal) QC, Canada H4N 2G3
Tel: (800) 638-5726 Fax (514) 744-2716
www.simplexceilings.com

Specifications

Wavegrid Series

- Panels:** Provide Simplex **Wavegrid** system manufactured from minimum 0.032" (0.81mm) thick aluminum, galvanized steel, and stainless steel. Panel is to be shipped flat and accept the curve of the grid. Panel dimensions will be as shown on drawings. Panels to be un-perforated or perforated with a un-perforated border, using pattern defined by the architect.
- Finish:** Select from Simplex Ceiling standards for panels. Custom colors available upon request.
- Suspension:** Suspension shall be 1" (25.4mm) extruded aluminum T-bar with standard curved mains and straight cross teed. Panels fixed to suspension with removable Hold Down Clips. All fasteners concealed..
- Perimeter:** Provide extruded aluminum angles as required in finish to match panels and grid. Corners fixed using Angle Coupler with concealed fasteners.
- Acoustical:** For perforated panels, provide a 0.008" (0.2mm) thick Simplex "T" non-woven acoustical textile to be bonded to the inside face of the panels. Can also be provided in 1-1/2" (38 mm) thick x 3/4 lb/cu.ft (12 kg/m³) density glass wool fiber completely sealed in an incombustible bag and installed with accordion pad spacers placed between the panel back and acoustical pad.

Standard Sizes: 24" x 24" 24" x 48" 24" x 72"

Metric Sizes (mm): 610 x 610 610 x 1219 610 x 1828

(Other custom sizes available upon request)

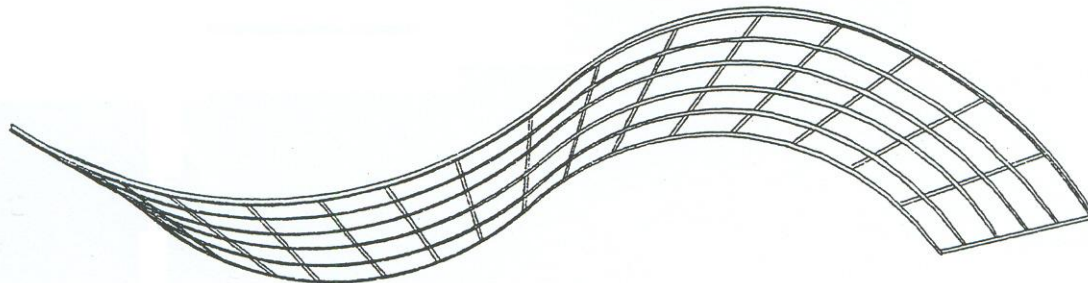

Hold Down Clip

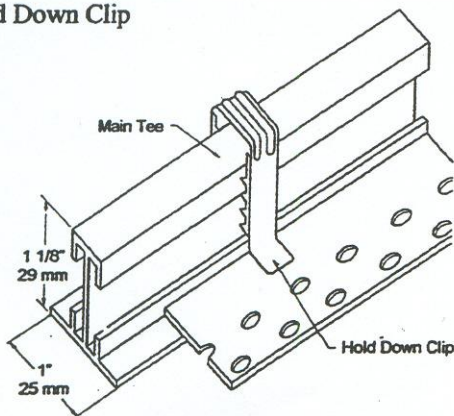

Not to Scale

Suspension Detail

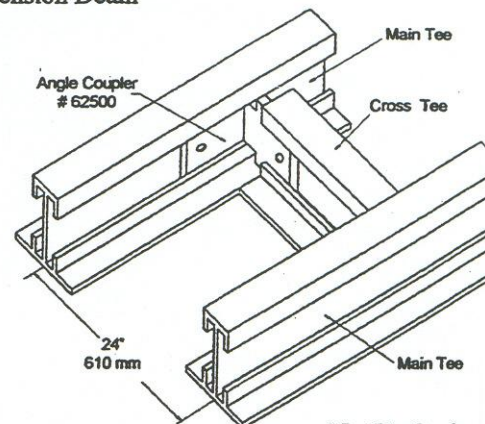

Not To Scale

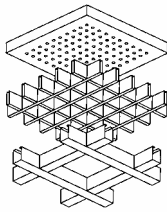

SIMPLEX®

CEILINGS

255 Montpelier, St. Laurent
(Montreal) QC, Canada H4N 2G3
Tel: (800) 638-5726 Fax (514) 744-2716
www.simplexceilings.com

Specifications

**Perimeter Angle
Floating Conditions**

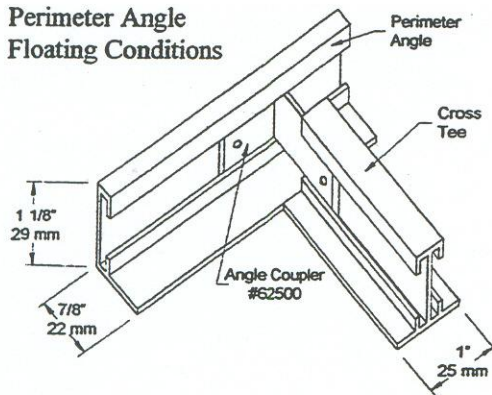

Not to Scale

**Outside Corner
Perimeter Angles**

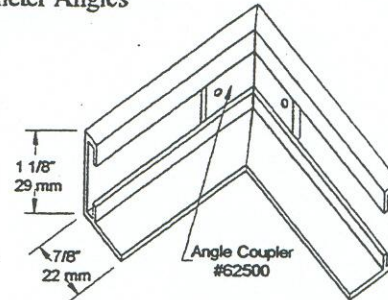

Not to Scale

Perimeter Angles
field mitered

For floating side, use the Aluminum Angle Extrusion

The minimum radius is:

For Vaults
R = 36" (915 mm)

For Valleys
R = 36" (915 mm)

Vaulted Main Tee

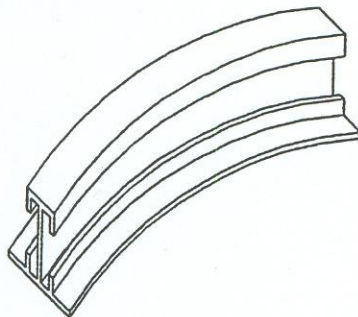

Not to Scale

Valleyed Main Tee

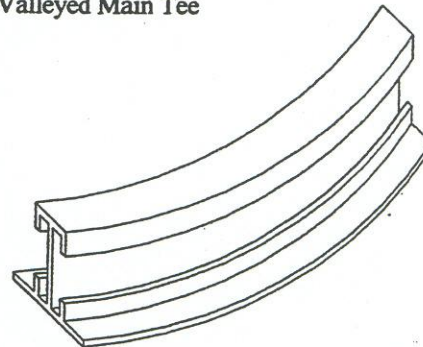

Not to Scale