

Quick Guide Cappuccinatore

To prevent accidents
and machine damage
read the instructions
provided with the machine.

en - US, CA

M.-Nr. 07 382 380

Cappuccinatore

Before using the cappuccinatore for the first time, wash it either in the dishwasher or with hot water and liquid dish soap.

Cold milk is best for creating froth.

Pre-warm the cups, before preparing a drink. Place a cup under the steam valve and press the lever down until steam is dispensed. Use caution. Steam is very hot.

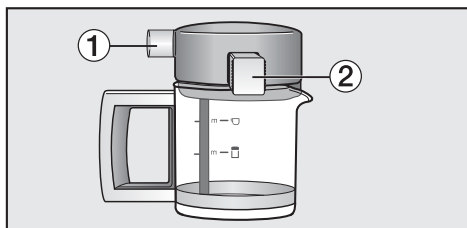

① Valve

② Cappuccinatore spout

Valve

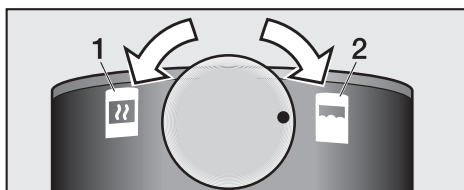

The steam is regulated by turning the valve:

1 Hot milk is prepared

2 Froth is prepared

Do **not** set the valve between these two positions: The milk will splatter!

Milk spout

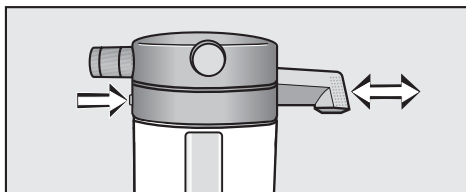

Pushed in: Milk is frothed into the cup

Pulled out: Milk is frothed into the cappuccinatore

Replace the nozzle on the steam valve

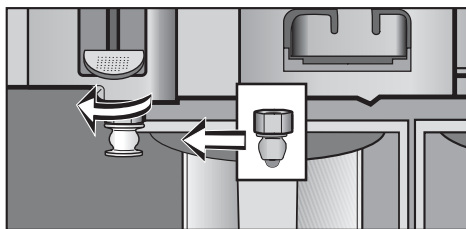

If your machine uses the steam valve nozzle shown in the illustration, replace it with the new nozzle supplied with the cappuccinatore.

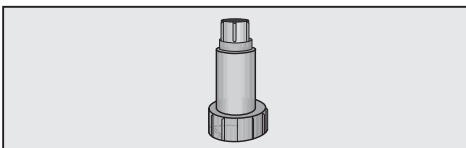

- Use the tool to remove the perforator, so the nozzle can be replaced.
- Open the appliance door. Press the steam lever down, screw off the nozzle and screw on the new one.
- Return the steam lever to the "up" position.

Frothing milk into a cup

- Push the cappuccinatore spout all the way into the lid.
- Turn the valve all the way to the right for frothing.

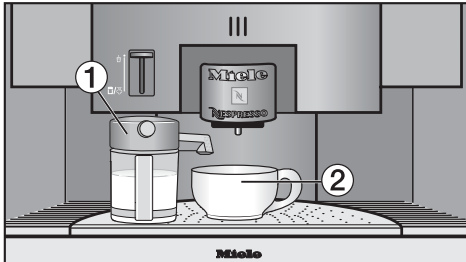

- Fill the cappuccinatore ① to the **upper** "max" mark with cold milk and cover with the lid.
- Place the cappuccinatore under the steam valve and a cup under the spout ②.
- Slowly press the steam lever down.

The steam lever must click into the down position - otherwise the valve is not properly connected to the cappuccinatore.

- Push the steam lever up when enough froth is prepared.

The steam supply is temporary. If the steam stops and there is not enough froth prepared, push the steam lever up then down again.

Frothing milk into the cappuccinatore

- Fill the pitcher to the **lower** "max" mark with cold milk and cover with the lid.
- Pull the milk spout out from the lid.
- Turn the valve all the way to the right for frothing.
- Place the cappuccinatore under the steam valve.

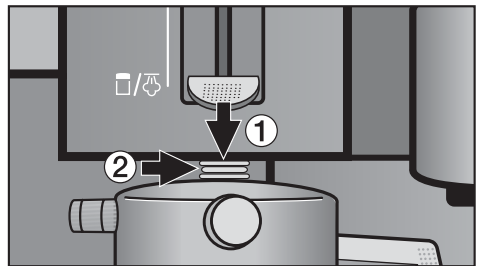

- Slowly press the steam lever down ①.

The steam lever must click into the down position - otherwise the valve is not properly connected to the cappuccinatore ②.

- Push the steam lever up when enough froth is prepared.

Cappuccinatore

Heating milk in the cappuccinatore

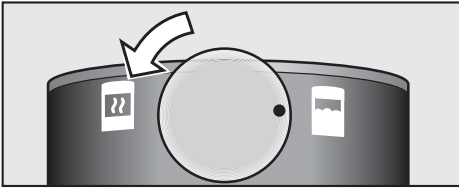

- Fill the cappuccinatore to the **upper** "Max" mark with cold milk, place the lid on, pull the spout out from the lid.
- Turn the valve all the way to the left for heating.
- Place the cappuccinatore under the steam valve.
- Slowly press the steam lever down and carefully "connect" the valve to the cappuccinatore.

Quick cleaning

For a quick cleaning between froths the cappuccinatore lid can be rinsed with the steam valve.

The rinsing **does not** replace the cleaning of the cappuccinatore in a dishwasher.

- Select "Maintenance" using < or >.
- Select "Rinse Cappuccinatore" and confirm with OK button.
- Push the cappuccinatore spout into the "in" position and place an empty cup underneath the cappuccinatore spout.
- Press the steam lever down.

The process will stop automatically when the lid is rinsed.

Complete Cleaning

Thorough cleaning is very important to prevent the cappuccinatore spout from becoming blocked and producing little or no froth. For best results, use a dishwasher - all parts are dishwasher-safe.

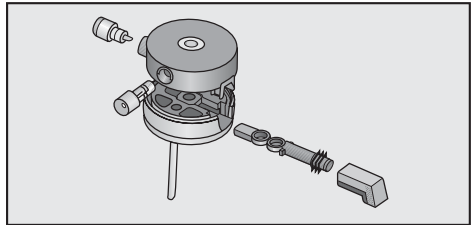

- Separate the lid, remove all parts and clean.
- Re-assemble the lid as shown in the illustration. For the valve to work properly, the dot on the valve must face the upper right.

Be sure that the parts are assembled properly.

**Please have the model and serial number
of your appliance available before
contacting Technical Service.**



**U.S.A.
Miele, Inc.**

National Headquarters

9 Independence Way
Princeton, NJ 08540
Phone: 800-843-7231
609-419-9898
Fax: 609-419-4298
www.miele.com

**Technical Service & Support
Nationwide**

Phone: 800-999-1360
Fax: 888-586-8056

TechnicalService@mieleusa.com

**Canada
Miele Limited**

Headquarters and Showroom

161 Four Valley Drive
Vaughan, ON L4K 4V8
Phone: 800-643-5381
905-660-9936
Fax: 905-532-2290
www.miele.ca
info@miele.ca (general enquiries)
professional@miele.ca (commercial
enquiries)

MieleCare National Service

Phone: 800-565-6435
905-532-2272
Fax: 905-532-2292
customercare@miele.ca (technical
enquiries)