



© 2000 Fire Farm, Inc.
Elkader, IA
Made in the USA

Assembly Instructions

DOUBLE TAO LAMP / SINGLE TAO LAMP

Item 9E-T1 and 9E-T2

Designed by Boris Jeanrenaud

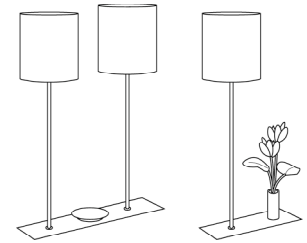

Parts Included: (pictures not to scale)

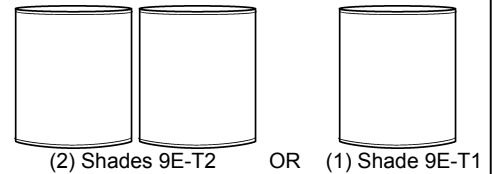
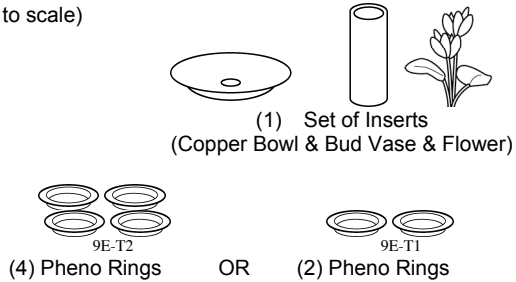
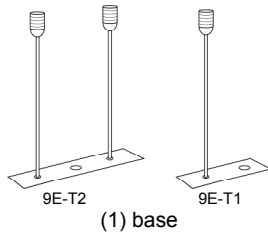

Assembly:

- (figure 1)** Screw a pheno ring down onto each socket. Place the center of the shade on top of the pheno ring. Secure the shade with the second pheno ring.
- (figure 2)** You have the choice of inserting the copper bowl or the bud vase into the hole in the base of the frame.
- Install Bulb, turn on, and enjoy!

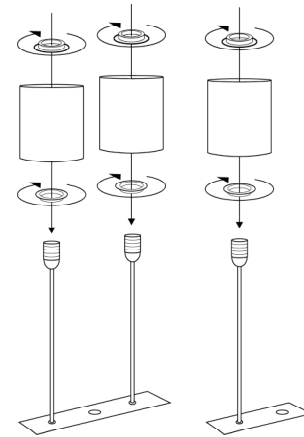

Figure 1

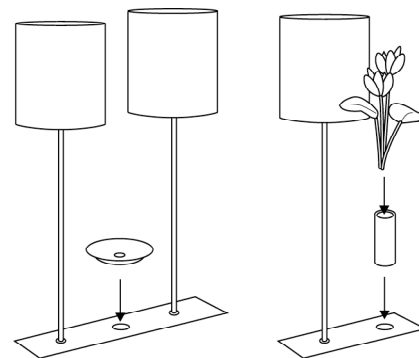

Figure 2

You may use a maximum 75-watt bulb in each socket

SAFETY INFORMATION

SAFETY

We have designed your lamp to meet the highest UL and CUL safety standards.

This portable lamp has a polarized plug (one blade is wider than the other) as a feature to reduce electric shock. This plug will fit in a polarized outlet only one way. If the plug does not fit fully in the outlet, reverse the plug. If it still does not fit, contact a qualified electrician. Never use with an extension cord unless plug can be fully inserted. Do not alter the plug.