Ainsley



Statement of Line **226**



Understanding

Wardrobe Cabinets	228
TV Cabinets	230
Dressers	232
Writing Desks	234
Bookcases	236
Bedside Tables	238
Headwall Wardrobe Cabinets and Headwall Columns	240
Headwall Upper Storage Cabinets	242
Headwall Center Panels	244
Headwall Bridge Units	245



Specifying

Wardrobe Cabinets	246
TV Cabinets	253
Dressers	254
Writing Desks	255
Bookcases	256
Bedside Tables	258
Headwall Wardrobe Cabinets	260
Headwall Columns	262
Headwall Upper Storage Cabinets	266
Headwall Center Panels	268
Headwall Bridge Units	269

Statement of Line

Ainsley

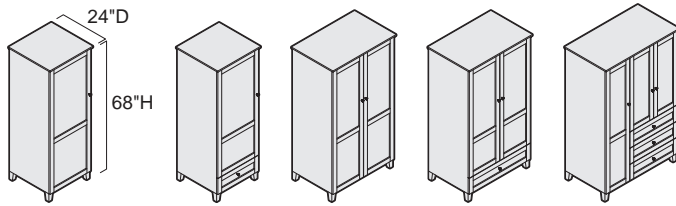

Understanding
 ▶ Page 228
 Specifying
 ▶ Page 246

Wardrobe Cabinets

	24\"/>		
Single-door wardrobe	●		
Single-door wardrobe with one drawer	●		
Double-door wardrobe		●	
Double-door wardrobe with one drawer		●	
Double-door cabinet with three drawers and 14\"/>			

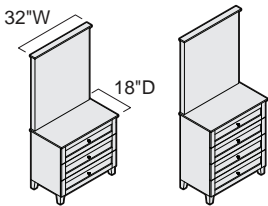

Understanding
 ▶ Page 230
 Specifying
 ▶ Page 253

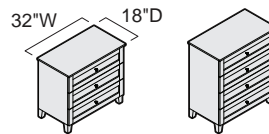

Understanding
 ▶ Page 232
 Specifying
 ▶ Page 254

TV Cabinets

	68\"/>	
With three drawers	●	
With four drawers		●

Dressers

	30\"/>	
With three drawers	●	
With four drawers		●

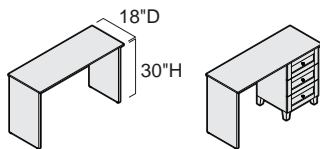

Understanding
 ▶ Page 234
 Specifying
 ▶ Page 255

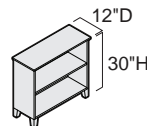

Understanding
 ▶ Page 236
 Specifying
 ▶ Page 256

Writing Desks

	48\"/>
Open	●
With full-height pedestal	●

Bookcase

	32\"/>
Bookcase	●

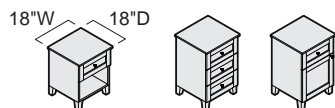

Understanding
 ▶ Page 238
 Specifying
 ▶ Page 258

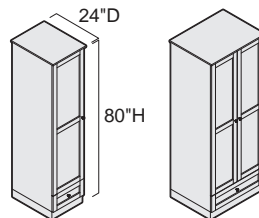

Understanding
 ▶ Page 240
 Specifying
 ▶ Page 260

Bedside Tables

	24\"/>	
Night table with one drawer and open shelf	●	
Bedside table with three drawers		●
Bedside table with one drawer and one door		●

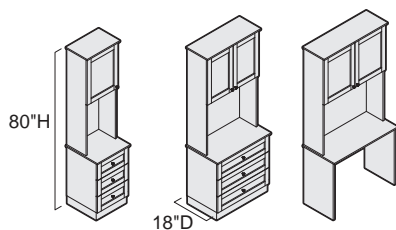

Understanding
 ▶ Page 240
 Specifying
 ▶ Page 262

Headwall Columns

	18\"/>			
With single-door overhead storage and three drawers	●			
With double-door overhead storage and three drawers		●	●	●
With double-door overhead storage and desk		●		●

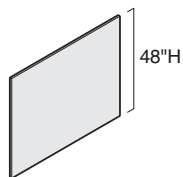

Understanding
 ▶ Page 244
 Specifying
 ▶ Page 268

Headwall Center Panels

	54\"/>	
Center panels	●	●

Headwall Wardrobe Cabinets

	18\"/>			
Single-door wardrobe cabinets with one drawer	●			
Double-door wardrobe cabinets with one drawer		●	●	●

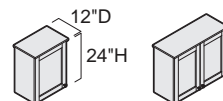

Understanding
 ▶ Page 242
 Specifying
 ▶ Page 266

Headwall Upper Storage Cabinets

	18\"/>			
With single door	●			
With double doors		●	●	●

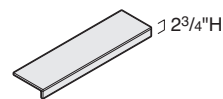

Understanding
 ▶ Page 245
 Specifying
 ▶ Page 269

Headwall Bridge Units

	54\"/>	
Bridge units	●	●

Ainsley Wardrobe Cabinets

Wardrobe cabinets are available in single-door and double-door versions and may be specified with drawers to meet diverse storage needs.

Top is laminate with wood edges and matches the cabinet.

Wardrobe cabinets are available in either a wood veneer case with solid wood frame fronts and veneer center panels or a melamine laminate case with solid wood frame fronts with veneer center panels.

Back is finished to match cabinet.

Base is wood to match cabinet.

Adjustable glides adjust for installation on uneven floors. Adjustability range is 1½".

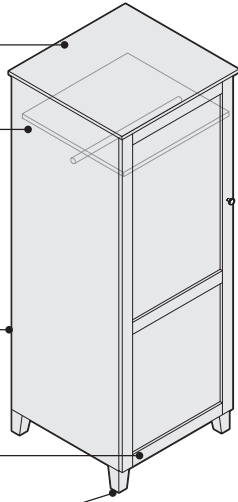

Fixed shelf provides an additional storage surface. Shelf is wood veneer on wood cabinets and melamine on melamine cabinets.

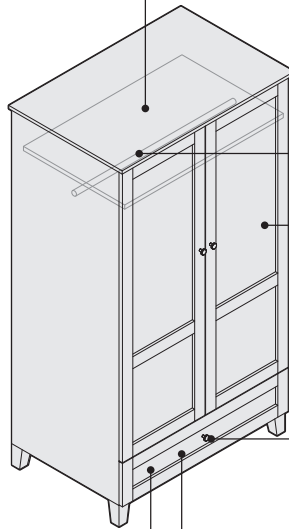

Hanger bar runs the width of each cabinet.

Doors have hinges and are solid wood frames with veneer center panels.

Round knob pulls on doors and drawers are standard in satin chrome.

Drawer fronts have solid wood frames with veneer center panels.

Drawers are wood core, miter-fold construction with full-extension, ½" ball-bearing sides.

Product Details

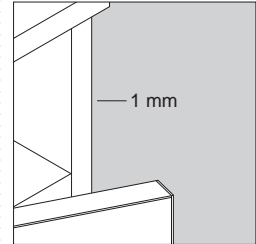

Edges on cabinet cases are matching 1 mm plastic trim on melamine cabinets and wood veneer on wood cabinets.

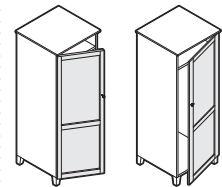

Single-door cabinets are hinged on the left or right side. A left-hand unit has the hinge on the left side of the door. A right-hand unit has the hinge on the right side of the door.



Double-door cabinets open from the center out.

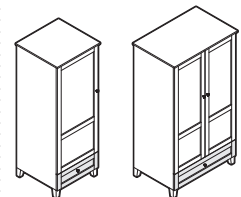

Bottom drawer is available on single- and double-door cabinets.

Actual Dimensions

Depth	24"
Width	24", 36", or 42"
Height	68"

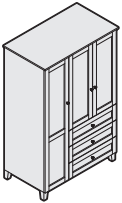

42"W wardrobe unit includes a double-door cabinet with three drawers below and a 14"W wardrobe on the left. 14"W wardrobe includes a fixed shelf and hanger bar that runs the width of the wardrobe cabinet. Double-door cabinet area includes two adjustable shelves.

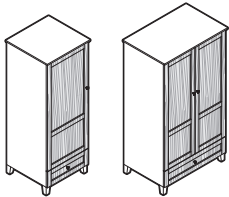

Grain direction matches vertically on all door combinations. Grain direction also matches vertically on all drawer sets.

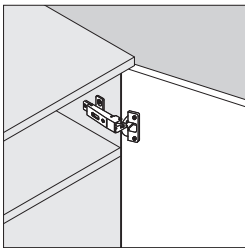

Euro hinge is standard on cabinet doors and allows the door to open a full 110° for easy access.

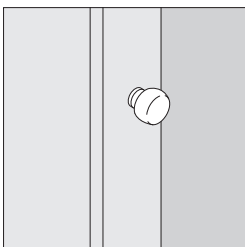

Round knob pulls are standard.

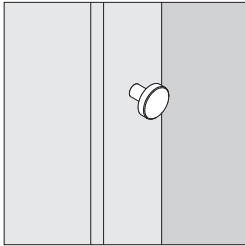

Additional door and drawer pull option is available. Optional pull includes:

- Flat knob

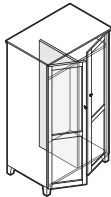

Center vertical divider is optional for use on 36"W double-door cabinets only. Divider matches the finish of the cabinet and is wood veneer for wood cabinets and melamine for melamine wardrobe cabinets. The center divider is shipped installed.

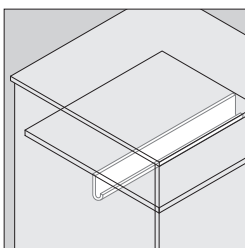

J-bar coatrod is available as an option on 24" and 36" wide wardrobes and attaches to the underside of the fixed shelf. This is the suggested option when patient safety is a concern.

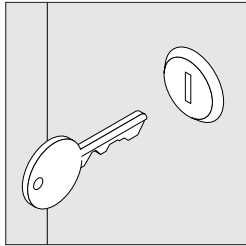

Lock is optional and factory- or field-installed on single-door and double-door wardrobe cabinets without drawers. Factory-installed locks are available keyed random only. Optional field-installed locks are available with consecutive, specific, or random keying options. Master-keyed locks are also available. Field-installed lock cylinders must be specified separately.

▶ Lock and Keying, Page 716

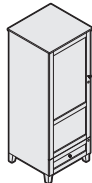

Single-door wardrobe with drawer has one lock in door and one lock in drawer. Locks are available field-installed only.

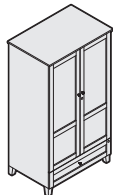

Double-door wardrobe with drawer has one lock for doors and one lock in drawer. Locks are available field-installed only.

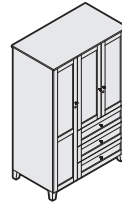

Double-door wardrobe with three drawers and a 14"W wardrobe has one lock for double doors, one lock for wardrobe door, and one lock for drawers. Locks are available field-installed only.

Connections

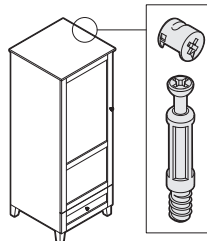

Cam-lock assembly hardware is used.

Wardrobe cabinets are freestanding and do not need to be ganged to other cabinets or bolted to the floor.

Surface Materials

Wardrobe cabinet and fixed shelf

- Melamine
- Wood veneer

Top

- Laminate with wood edge to match wardrobe cabinet finish

Drawer fronts

- Solid wood frame with veneer center panel

Door fronts

- Solid wood frame with veneer center panel

Door and drawer pulls

- Satin chrome on round knob pulls
- Matte stainless steel on flat knob pulls (option)

Hanger bar

- Black

Locks

- 9201 Polished Chrome only

Ainsley TV Cabinets

TV cabinets accommodate a flat-screen television up to 42"W and provide additional storage of three or four drawers.

TV cabinets are available in either a wood veneer case with solid wood frame fronts and veneer center panels, or a melamine case with solid wood frame fronts and veneer center panels.

TV panel is 3/4" melamine or wood veneer to match cabinet.

Back is 3/4" melamine or wood veneer to match cabinet.

Drawers are wood core, miter-fold construction with full-extension, 1/2" ball-bearing sides.

Top is High-Pressure Laminate with wood edges and matches the cabinet.

Drawer fronts are solid wood frames with veneer center panels.

Round knob pulls on drawers are standard in satin chrome.

Base is wood to match cabinet.

Adjustable glides adjust for installation on uneven floors. Adjustability range is 1 1/2".

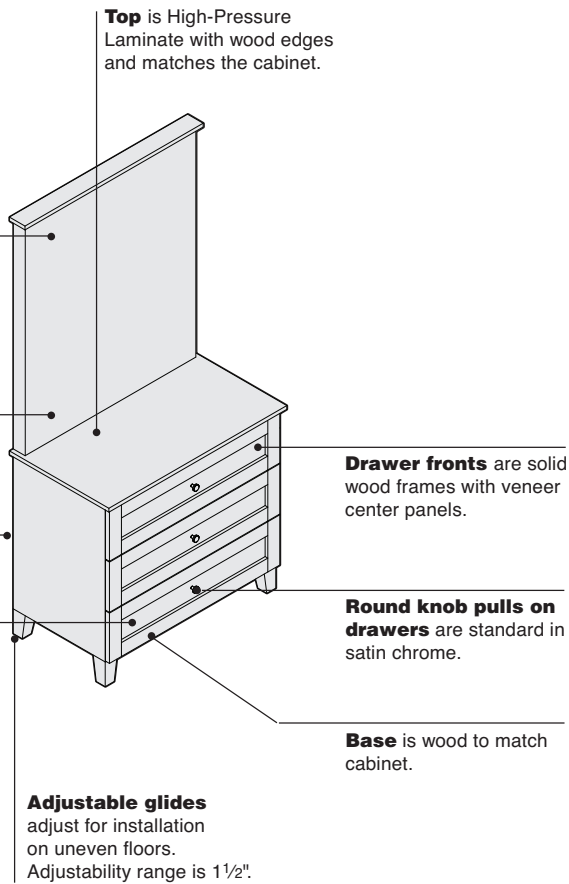

Actual Dimensions

Depth 18"

Width 32"

Height 68" or 76"

Product Details

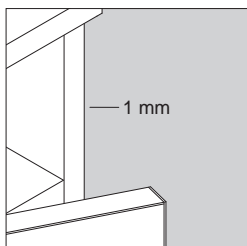

Edges on cabinet cases are matching 1 mm plastic trim on melamine cabinets and wood veneer on wood cabinets.

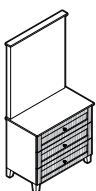

Grain direction matches vertically on all drawer sets in cabinet.

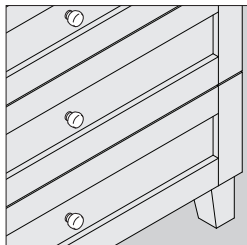

Round knob pulls are standard.

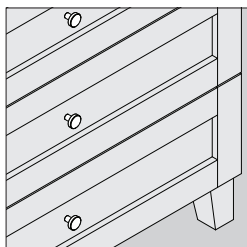

Additional drawer pull option is available. Optional pull includes:

- Flat knob

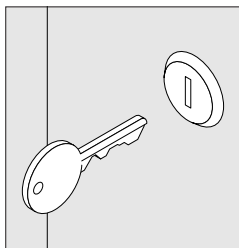

Lock is optional and factory- or field-installed to secure the top drawer of the cabinet. Factory-installed locks are available keyed random only. Optional field-installed locks are available with consecutive, specific, or random keying options. Master-keyed locks are also available. Field-installed lock cylinders must be specified separately.

► Lock and Keying, Page 716

Connections

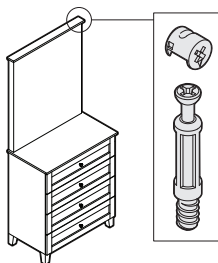

Cam-lock assembly hardware is used.

TV cabinets are free-standing and do not need to be ganged to other units or bolted to the floor.

Surface Materials

TV cabinet

- Melamine
- Wood veneer

Top

- High-Pressure Laminate with wood edges

Drawer fronts

- Solid wood frame with veneer center panel

Drawer pulls

- Satin chrome on round knob pulls
- Matte stainless steel on flat knob pulls (option)

Locks

- 9201 Polished Chrome only

Ainsley Dressers

Dressers are available with three- and four-drawer configurations for storage of clothing in patient rooms.

Dresser is available in either a wood veneer case with solid wood frame fronts and veneer center panels, or a melamine case with solid wood frame fronts and veneer center panels.

Back is 3/4" melamine or wood veneer to match dresser.

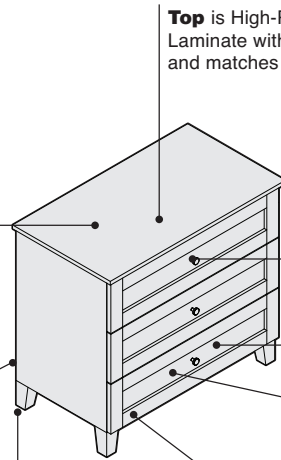

Top is High-Pressure Laminate with wood edges and matches the cabinet.

Round knob pulls on drawers are standard in satin chrome.

Drawers are wood core, miter-fold construction with full-extension, 1/2" ball-bearing sides.

Drawer fronts are solid wood frames with veneer center panels.

Base is wood to match dresser.

Adjustable glides adjust for installation on uneven floors. Adjustability range is 1 1/2".

Actual Dimensions

Depth	18"
Width	32"
Height	30" or 38"

Product Details

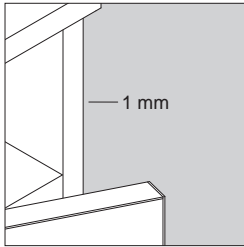

Edges on cabinet cases are matching 1 mm plastic trim on melamine cabinets and wood veneer on wood cabinets.

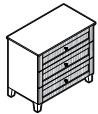

Grain direction matches vertically on all drawer sets in cabinet.

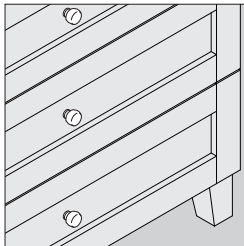

Round knob pulls are standard.

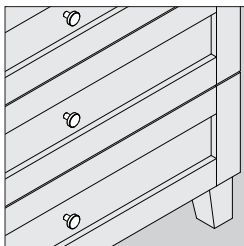

Additional drawer pull option is available. Optional pull includes:

- Flat knob

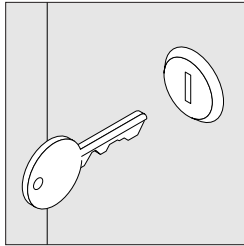

Lock is optional and factory- or field-installed to secure the top drawer of the cabinet. Factory-installed locks are available keyed random only. Optional field-installed locks are available with consecutive, specific, or random keying options. Master-keyed locks are also available. Field-installed lock cylinders must be specified separately.

▶ Lock and Keying, Page 716

Connections

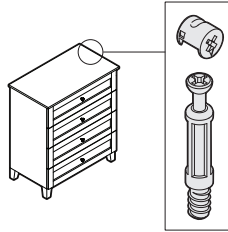

Cam-lock assembly hardware is used.

Dressers are freestanding and do not need to be ganged to other dressers or bolted to the floor.

Surface Materials

Dresser

- Melamine
- Wood veneer

Top

- High-Pressure Laminate with wood edges

Drawer fronts

- Solid wood frame with veneer center panel

Drawer pulls

- Satin chrome on round knob pulls
- Matte stainless steel on flat knob pulls (option)

Locks

- 9201 Polished Chrome only

Ainsley Writing Desks

Writing desks are available in two styles to accommodate various patient and care partner work needs. Writing desks are either wood veneer with solid wood frame fronts and veneer center panels, or melamine with solid wood frame fronts and veneer center panels.

Back is wood veneer panel on wood veneer cabinets and melamine panel on melamine cabinets.

Drawers are wood core, miter-fold construction with full-extension, 1/2" ball-bearing sides.

Top is High-Pressure Laminate with wood edges and matches the writing desk base.

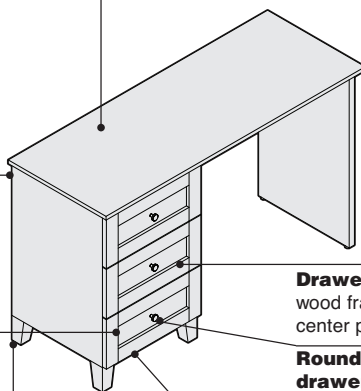

Drawer fronts are solid wood frames with veneer center panels.

Round knob pulls on drawers are standard in satin chrome.

Adjustable glides adjust for installation on uneven floors. Adjustability range is 1 1/2".

Base is wood to match writing desk.

Actual Dimensions

Depth	18"
Width	48"
Height	30"

Product Details

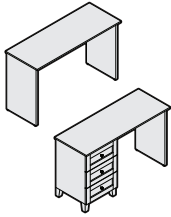

Writing desks are available open and with a full-height pedestal for maximum storage.

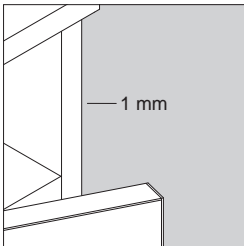

Edges on cabinet cases are matching 1 mm plastic trim on melamine cabinets and wood veneer on wood cabinets.

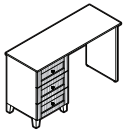

Grain direction matches vertically on all drawer sets in cabinet.

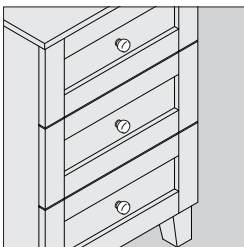

Round knob pulls are standard.

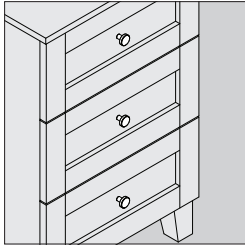

Additional drawer pull option is available. Optional pull includes:

- Flat knob

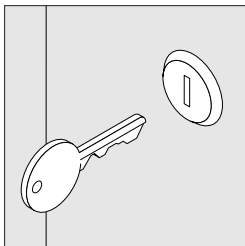

Lock is optional and factory- or field-installed to secure the top drawer of the cabinet. Factory-installed locks are available keyed random only. Optional field-installed locks are available with consecutive, specific, or random keying options. Master-keyed locks are also available. Field-installed lock cylinders must be specified separately.

- ▶ Lock and Keying, Page 716

Connections

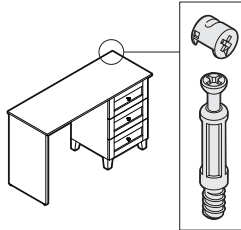

Cam-lock assembly hardware is used.

Writing desks are free-standing and do not need to be ganged to other furniture or bolted to the floor.

Surface Materials

Writing desks

- Melamine
- Wood veneer

Top

- High-Pressure Laminate with wood edge

Drawer fronts

- Solid wood frame with veneer center panel

Drawer pulls

- Satin chrome on round knob pulls
- Matte stainless steel on knob pulls (option)

Locks

- 9201 Polished Chrome only

Ainsley Bookcases

Bookcases are available for open storage of items in patient rooms.

Top is High-Pressure Laminate with wood edges and matches the bookcase.

Bookcases are available in wood veneer or melamine.

Back is 3/4" wood veneer or melamine to match bookcase.

Base is wood to match bookcase.

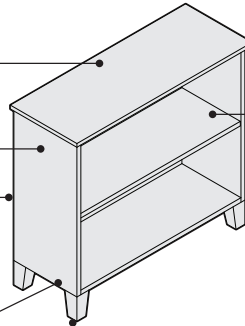

Fixed shelf is wood veneer for wood veneer bookcases and melamine laminate for melamine bookcases. The shelf matches the finish of the bookcase.

Adjustable glides adjust for installation on uneven floors. Adjustability range is 1 1/2".

Actual Dimensions

Depth	12"
Width	32"
Height	30"

Product Details

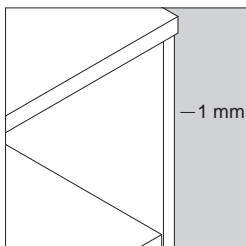

Edges on cabinet cases are matching 1 mm plastic trim on melamine cabinets and wood veneer on wood cabinets.

Connections

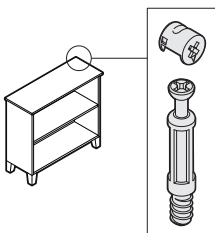

Cam-lock assembly hardware is used.

Bookcases are freestanding and do not need to be ganged to other furniture or bolted to the floor.

Surface Materials

Bookcases

- Melamine
- Wood veneer

Top

- High-Pressure Laminate with wood edge

Ainsley Bedside Tables

Bedside tables are available in three configurations to meet storage needs of the patient.

Drawers are wood core, miter-fold construction with full-extension, 1/2" ball-bearing sides.

Top is High-Pressure Laminate with wood edges and matches the table case.

Back is 3/4" wood or melamine to match cabinet.

Bedside table case is available in wood veneer with solid wood frame fronts and veneer center panels, or melamine with solid wood frame fronts and veneer center panels.

Drawer fronts are solid wood frames with veneer center panels.

Round knob pulls on doors and drawers are standard in satin chrome.

Doors have hinges and are solid wood frames with veneer center panels.

Open shelf area keeps overnight bags, other personal items, and equipment off the floor and out of traffic areas.

Glides are standard.

Actual Dimensions

Depth	18"
Width	18"
Height	24" or 30"

Product Details

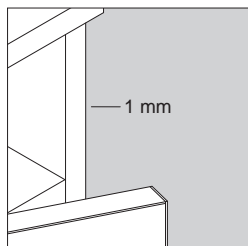

Edges on cabinet cases are matching 1 mm plastic trim on melamine cabinets and wood veneer on wood cabinets.



24"H night table includes one small drawer with an open shelf below.

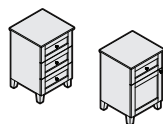

30"H bedside tables are available in two configurations: with three drawers, or with one small drawer and a door cabinet below. Door is available hinged on the left or right. A left-hand unit has hinge on left side of the door. A right-hand unit has hinge on right side of the door.

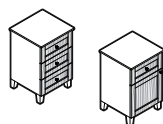

Grain direction matches vertically on all drawer and door sets in cabinet.

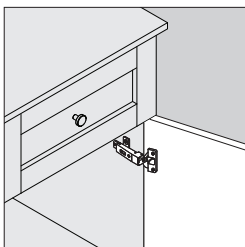

Euro hinge is standard on cabinet doors and allows the door to open a full 110° for easy access.

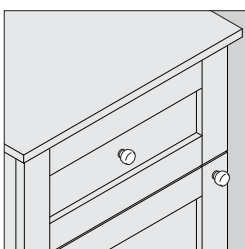

Round knob pulls are standard.

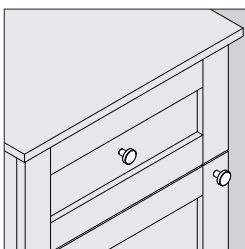

Additional door and drawer pull option is available. Optional pull includes:

- Flat knob

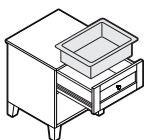

Plastic drawer liner is available to place in any drawer of bedside cabinet to allow for ease of cleaning and must be ordered separately.

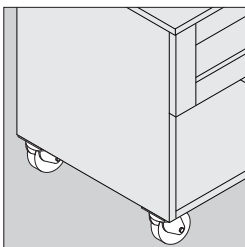

Casters are optional. They have a 4" diameter and are non-marring. The front casters swivel for steering and are lockable to hold the table in place when necessary. The back casters swivel and do not lock.

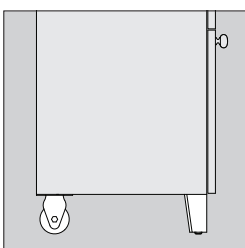

Rear rollers and front glides are optional to assist in moving the table. Rear rollers are non-directional and replace the rear legs.

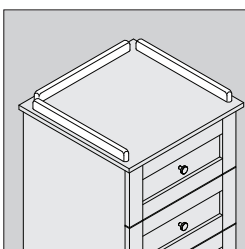

Gallery rails are available as an option. Rails are positioned on the back and sides of the top.

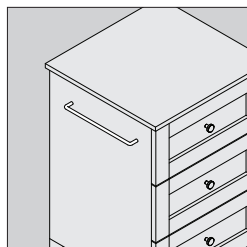

Towel bar is available and may be installed on the left or right side of the bedside table. Towel bar is field-installed. Towel bar must be specified separately. ▶ See *Accessories*, page 437.

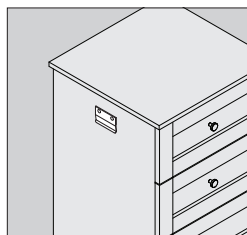

Litter bag holder is available to hold small paper bags. Litter bag holder is field-installed and may be positioned to the left or right side of the table. Must be specified separately. ▶ See *Accessories*, page 437.

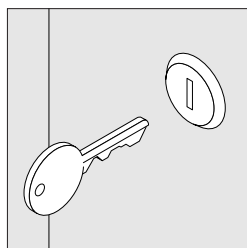

Lock is optional and factory- or field-installed to secure the doors or top drawer of the cabinet. Factory-installed locks are available keyed random only. Optional field-installed locks are available with consecutive, specific, or random keying options. Master-keyed locks are also available. Field-installed lock cylinders must be specified separately. ▶ Lock and Keying, Page 716

Connections

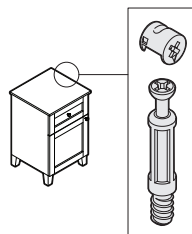

Cam-lock assembly hardware is used.

Bedside tables are free-standing and do not need to be ganged to other furniture or bolted to the floor.

Surface Materials

Bedside table

- Melamine
- Wood veneer

Top

- High-Pressure Laminate with wood edge

Door and drawer pulls

- Satin chrome on round knob pulls
- Matte stainless steel on flat knob pulls (option)

Drawer fronts

- Solid wood frame with veneer center panel

Door fronts

- Solid wood frame with veneer center panel

Locks

- 9201 Polished Chrome only

Ainsley Headwall Wardrobe Cabinets and Headwall Columns

Headwall wardrobe cabinets and headwall columns are available in a variety of styles and sizes to address storage needs in a clinical setting. Units with a wardrobe provide hanging storage. Other units provide overhead storage, display, and lower storage. A headwall column with a desk and overhead storage is also available.

Headwall wardrobe cabinets and headwall columns can stand alone or be joined with other headwall modular components to create a wall unit.

Headwall wardrobe cabinets and headwall columns are available in either a wood veneer case with solid wood frame fronts and veneer center panels or a melamine case with solid wood frame fronts with veneer center panels.

Back is finished to match case.

Enclosed base is black melamine.

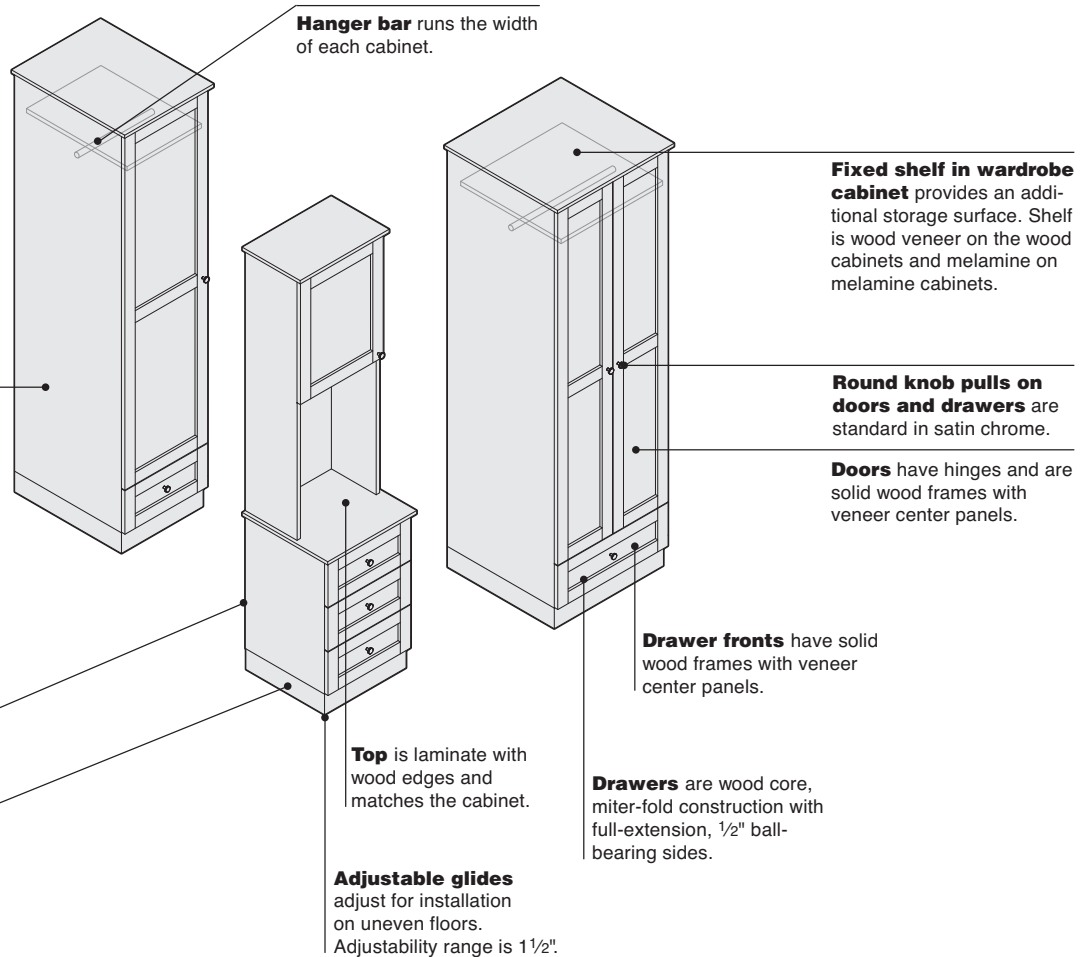

Actual Dimensions

Features	Overall Depth	Width	Height
Headwall Wardrobe Cabinets			
With single-door wardrobe and one drawer	24"	18"	80"
With double-door wardrobe and one drawer	24"	24", 30", or 36"	80"
Headwall Columns			
With single-door overhead storage and three drawers	18"	18"	80"
With double-door overhead storage and three drawers	18"	24", 30", or 36"	80"
With double-door overhead storage and one desk	18"	24" or 36"	80"

Product Details

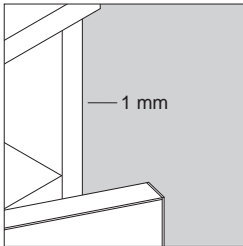

Edges on cabinet cases are matching 1 mm plastic trim on melamine cabinets and wood veneer on wood cabinets.

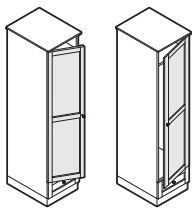

Single-door cabinets are hinged on the left or right side. A left-hand unit has the hinge on the left side of the door. A right-hand unit has the hinge on the right side of the door.

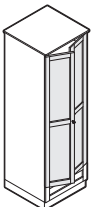

Double-door cabinets open from the center out.

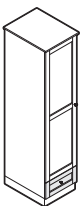

Bottom drawer is standard in headwall wardrobe cabinets.

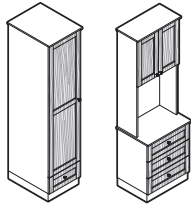

Grain direction matches vertically on all door combinations. Grain direction also matches vertically on all drawer sets.

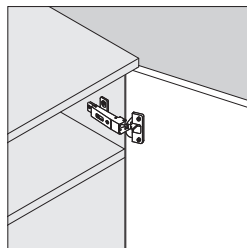

Euro hinge is standard on cabinet doors and allows the door to open a full 110° for easy access.

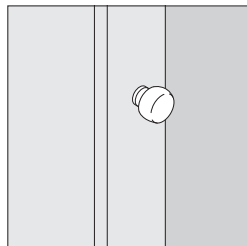

Round knob pulls are standard.

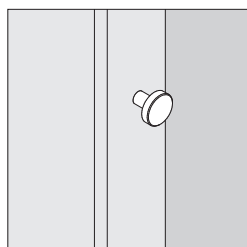

Additional door and drawer pull option is available. Optional pull includes:

- Flat knob

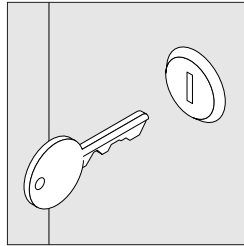

Lock is optional and factory- or field-installed on single-door and double-door headwall wardrobe cabinets and columns. Factory-installed locks are available keyed random only. Optional field-installed locks are available with consecutive, specific, or random keying options. Master-keyed locks are also available. Field-installed lock cylinders must be specified separately.

▶ Lock and Keying, Page 716



Headwall single-door wardrobe with drawer has one lock in door and one lock in drawer. Locks are available field-installed only.

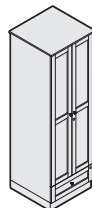

Headwall double-door wardrobe with drawer has one lock for doors and one lock in drawer. Locks are available field-installed only.

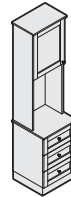

Headwall column has lock located in top drawer of lower storage cabinet. Upper storage cabinet does not lock.

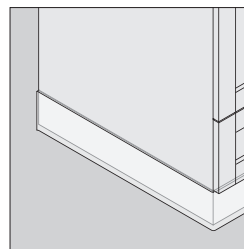

Cove molding must be field-installed on base of headwall wardrobe cabinets and headwall columns to complete installation. Cove molding must be supplied locally.

Connections

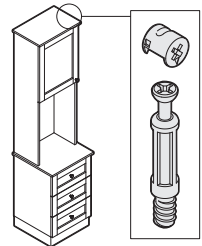

Cam-lock assembly hardware is used.

Headwall wardrobe cabinets and columns must be fastened to a wall. It is recommended headwall cabinets and columns be mounted to a wall stud.

Surface Materials

Headwall wardrobe cabinets and columns

- Melamine
- Wood veneer

Top

- Laminate with wood edge to match wardrobe cabinet finish

Wardrobe fixed shelf

- Melamine
- Wood veneer

Enclosed base

- Melamine black only

Drawer fronts

- Solid wood frame with veneer center panel

Door fronts

- Solid wood frame with veneer center panel

Door and drawer pulls

- Satin chrome on round knob pulls
- Matte stainless steel on flat knob pulls (option)

Hanger bar

- Black only

Locks

- 9201 Polished Chrome only

Ainsley Headwall Upper Storage Cabinets

Headwall upper storage cabinets are available in single- or double-door models. They can be used alone or be joined with other headwall modular components to create a wall unit.

Top is laminate with wood edges and matches the cabinet.

Back is finished to match cabinet.

Headwall upper storage cabinet cases are available in either a wood veneer case with solid wood frame fronts and veneer center panels or a melamine case with solid wood frame fronts with veneer center panels.

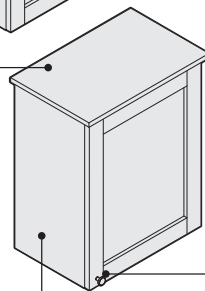
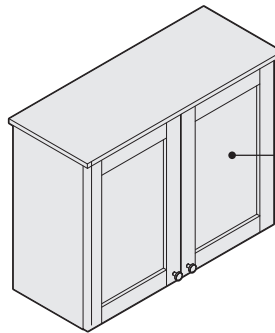
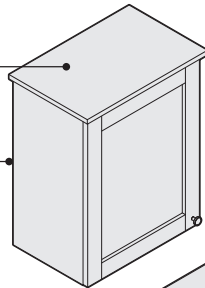

Doors have hinges and are solid wood frames with veneer center panels.

Round knob pulls on doors are standard in satin chrome.

Sides are finished so cabinet can be used alone or in right- or left-hand position in a multi-unit configuration.

Actual Dimensions

Features	Overall Depth	Width	Height
With single door	12"	18"	24"
With double doors	12"	24", 30", or 36"	24"

Product Details

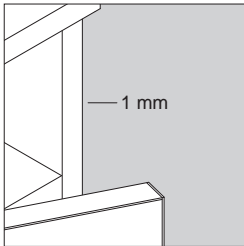

Edges on cabinet cases are matching 1 mm plastic trim on melamine cabinets and wood veneer on wood cabinets.

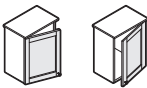

Single-door cabinets are hinged on the left or right side. A left-hand unit has the hinge on the left side of the door. A right-hand unit has the hinge on the right side of the door.



Double-door cabinets open from the center out.

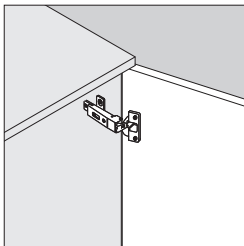

Euro hinge is standard on cabinet doors and allows the door to open a full 110° for easy access.

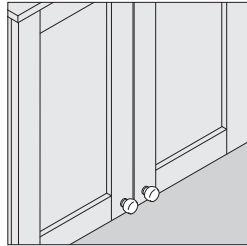

Round knob pulls are standard.

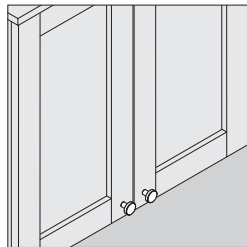

Additional door pull option is available.
Optional pull includes:
• Flat knob

Connections

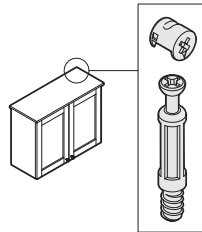

Cam-lock assembly hardware is used.

Headwall upper storage cabinets must be fastened to wall. It is recommended that headwall upper storage cabinets be mounted to a wall stud. Mounting cleats and attachment hardware are included with headwall upper storage cabinets.

Surface Materials

Upper storage cabinet

- Melamine
- Wood veneer

Top

- Laminate with wood edge to match wardrobe cabinet finish

Door fronts

- Solid wood frame with veneer center panel

Door pulls

- Satin chrome on round knob pulls
- Matte stainless steel on flat knob pulls (option)

Ainsley Headwall Center Panels

Center panels are used with other headwall wardrobe cabinets and columns to create a wall unit. The space that results from the panel can serve as a place for a bed or other equipment.

Back is melamine or wood veneer.

Front is melamine or wood veneer.

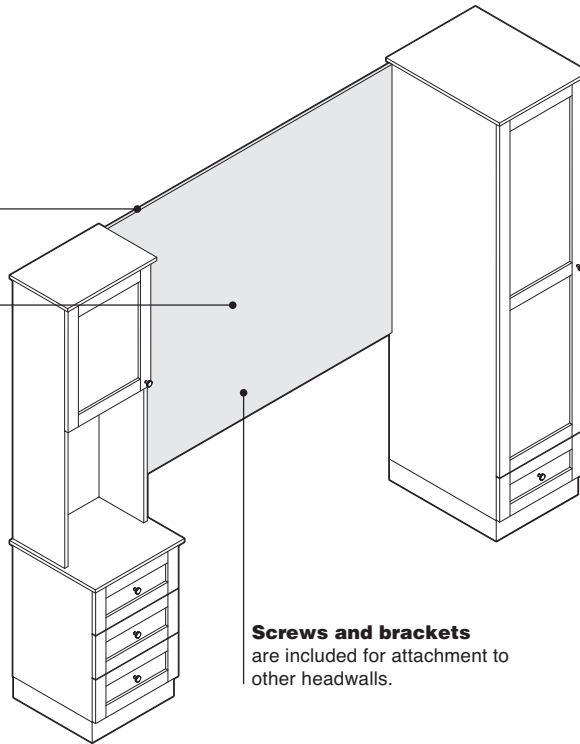

Screws and brackets are included for attachment to other headwalls.

Product Details

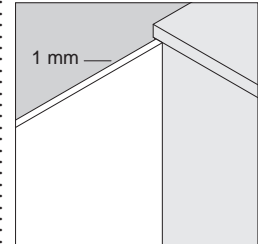

Edges are matching 1 mm plastic trim on melamine center panels and wood veneer on wood veneer center panels.

Connections

Screws are used to connect the center panel to adjacent units in a multi-unit configuration.

Wiring & Cabling

Cutouts can be specified to accommodate equipment or electrical outlets. A drawing that confirms the size and location of the cutout must accompany the order.
Tip: Cutouts must be ordered through Specials.

Grommets can be specified to allow cords and cables to pass through the center panel. A drawing that confirms the location of the grommet must accompany the order.
Tip: Grommets must be ordered through Specials.

Surface Materials

Center panel

- Melamine
- Wood veneer

Actual Dimensions

Depth 3/4"

Width 54" or 60"

Height 48"

Ainsley Headwall Bridge Units

Ainsley
Headwall Bridge Units

Headwall bridge unit is used as a decorative element between columns and may be used to mount low-profile light fixtures.

Bridge unit is melamine or wood veneer.

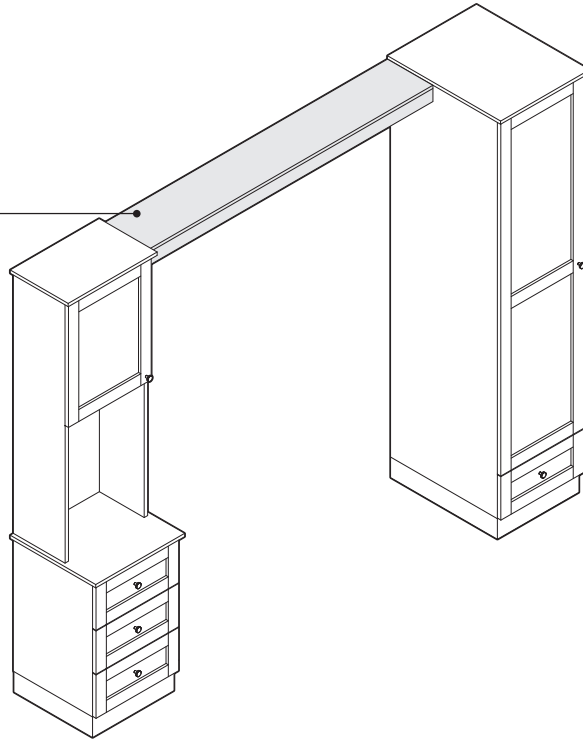

Product Details

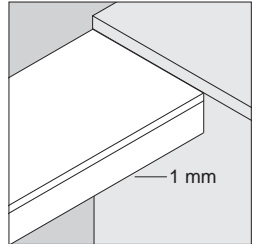

Edges are matching 1 mm plastic trim on melamine bridge units and wood veneer on wood veneer bridge units.

Connections

Screws are used to connect the bridge unit to the adjacent units in a multi-unit configuration. The bridge is inset from the front of the adjacent units.

Surface Materials

Bridge unit

- Melamine
- Wood veneer

Actual Dimensions

Depth	8"
Width	54" or 60"
Height	2 ³ / ₄ "

Ainsley Wardrobe Cabinets

Melamine Case with Wood Fronts

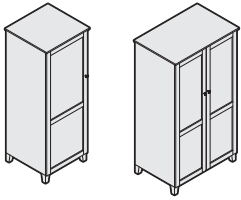

▶ Need help?
Product details,
page 228

Standard Includes

- Wardrobe case: melamine
- Door and drawer fronts: wood to match case
- Base: wood to match case
- Top: laminate with wood edge to match case
- Round knob pull on doors and drawers: satin chrome only
- Hanger bar: black only
- Adjustable glides
- Fixed shelf

Required to Specify

- 1 Style number
 - 2 Laminate color number for wardrobe cabinet
 - 3 Options, if selected (see below)
- ▶ See *Surface Materials*, page 681.

	Options	U.S. Price	Required to Specify
Door and Drawer Pulls	<ul style="list-style-type: none"> • Flat knob pull: matte stainless steel 	+\$ 10 per pull	Specify <i>with flat knob pulls</i> .
Center Vertical Divider	<ul style="list-style-type: none"> • For 36"W cabinets only 	+\$141	Specify <i>with center vertical divider</i> .
J-bar Coatrod	<ul style="list-style-type: none"> • For 24"W wardrobe cabinets • For 36"W wardrobe cabinets 	+\$ 73 +\$109	Specify <i>with J-bar</i> . Specify <i>with J-bar</i> .
Lock and Keying	<p>Lock with random key: 9201 Polished Chrome only</p> <ul style="list-style-type: none"> • Single-door wardrobe cabinets • Single-door with drawer or double-door wardrobe cabinets • Double-door cabinet with three drawers and 14"W wardrobe <p>Keying</p> <ul style="list-style-type: none"> • Factory- and field-installed keying 	+\$ 31 +\$ 62 +\$ 93	Specify <i>with lock</i> . Specify <i>with lock</i> . Specify <i>with lock</i> . ▶ Page 716
Related Products	<ul style="list-style-type: none"> • Accessories • Overbed tables • Headboards and footboards • Platform beds • Mirrors 		▶ Page 437 ▶ Page 427 ▶ Page 432 ▶ Page 434 ▶ Page 435

Tip: J-bar coatrod not available on 42"W wardrobe cabinets.

Tip: Wardrobe cabinets with a single lock are available with factory- or field-installed locks. Wardrobe cabinets with multiple locks are available field-installed only.



For Canadian Pricing
Multiply U.S. Price by the
Canadian price factor.
▶ See page 1 for details.

Specification Information

Dimensions			Style	U.S.
D	W	H	Number	Base Price

Single-Door Wardrobe Cabinets

Door Hinged on Left

24"	24"	68"	H2W124LL	\$1342
-----	-----	-----	-----------------	--------

Door Hinged on Right

24"	24"	68"	H2W124RL	\$1342
-----	-----	-----	-----------------	--------

Single-Door Wardrobe Cabinets with One Drawer

Door Hinged on Left

24"	24"	68"	H2W1C24LL	\$1477
-----	-----	-----	------------------	--------

Door Hinged on Right

24"	24"	68"	H2W1C24RL	\$1477
-----	-----	-----	------------------	--------

► **Specification Information, continued on next page**

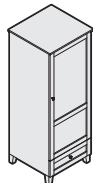
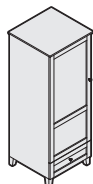
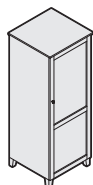
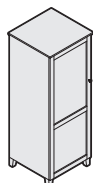

Tip: Single-door wardrobe cabinet with drawer has one lock in door and one lock in drawer. Locks are available field-installed only.



For Canadian Pricing

Multiply U.S. Price by the Canadian price factor.

► See page 1 for details.

► **Specification Information, continued from previous page**

Specification Information

• Dimensions			• Style	• U.S.
D	W	H	Number	Base Price

Double-Door Wardrobe Cabinet

24"	36"	68"	H2W236L	\$1716
-----	-----	-----	----------------	--------

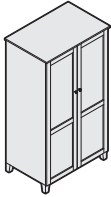

Double-Door Wardrobe Cabinet with One Drawer

24"	36"	68"	H2W2C36L	\$1851
-----	-----	-----	-----------------	--------

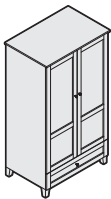

Tip: Double-door wardrobe cabinet with drawer has one lock for doors and one lock in drawer. Locks are available field-installed only.

Double-Door Cabinet with Three Drawers and 14"W Wardrobe on Left

24"	42"	68"	H2W3C42L	\$2558
-----	-----	-----	-----------------	--------

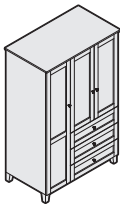

Tip: Double-door wardrobe cabinet with three drawers and 14"W wardrobe has one lock for double doors, one lock for wardrobe door and one lock in drawer. Locks are available field-installed only.



For Canadian Pricing

Multiply U.S. Price by the Canadian price factor.

► See page 1 for details.

Ainsley Wardrobe Cabinets

Wood Veneer Case with Wood Fronts

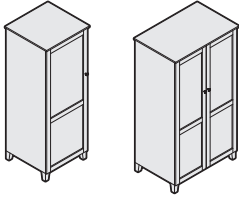

▶ Need help?
Product details,
page 228

Standard Includes

- Wardrobe case: wood veneer
- Door and drawer fronts: wood to match case
- Base: wood to match case
- Top: laminate with wood edge to match case
- Round knob pull on doors and drawers: satin chrome only
- Hanger bar: black only
- Adjustable glides
- Fixed shelf

Required to Specify

- 1 Style number
 - 2 Wood color number for wardrobe cabinet
 - 3 Options, if selected (see below)
- ▶ See *Surface Materials*, page 681.

	Options	U.S. Price	Required to Specify
Door and Drawer Pulls	<ul style="list-style-type: none"> • Flat knob pull: matte stainless steel 	+\$ 10 per pull	Specify with flat knob pulls.
Center Vertical Divider	<ul style="list-style-type: none"> • Available on 36"W cabinets only 	+\$141	Specify with center vertical divider.
J-bar Coatrod	<ul style="list-style-type: none"> • For 24"W wardrobe cabinets • For 36"W wardrobe cabinets 	+\$ 73 +\$109	Specify with J-bar. Specify with J-bar.
Lock and Keying	<p>Lock with random key: 9201 Polished Chrome only</p> <ul style="list-style-type: none"> • Single-door wardrobe cabinets • Single-door with drawer or double-door wardrobe cabinets • Double-door cabinet with three drawers and 14"W wardrobe <p>Keying</p> <ul style="list-style-type: none"> • Factory- and field-installed keying 	+\$ 31 +\$ 62 +\$ 93	Specify with lock. Specify with lock. Specify with lock. ▶ Page 716
Related Products	<ul style="list-style-type: none"> • Accessories • Overbed tables • Headboards and footboards • Platform beds • Mirrors 		▶ Page 437 ▶ Page 427 ▶ Page 432 ▶ Page 434 ▶ Page 435

Tip: J-bar coatrod not available on 42"W wardrobe cabinets.

Tip: Wardrobe cabinets with a single lock are available with factory- or field-installed locks. Wardrobe cabinets with multiple locks are available field-installed only.



For Canadian Pricing

Multiply U.S. Price by the Canadian price factor.

▶ See page 1 for details.

Specification Information

Dimensions			Style	U.S.
D	W	H	Number	Base Price

Single-Door Wardrobe Cabinets

Door Hinged on Left

24"	24"	68"	H2W124LW	\$1872
-----	-----	-----	-----------------	--------

Door Hinged on Right

24"	24"	68"	H2W124RW	\$1872
-----	-----	-----	-----------------	--------

Single-Door Wardrobe Cabinets with One Drawer

Door Hinged on Left

24"	24"	68"	H2W1C24LW	\$2059
-----	-----	-----	------------------	--------

Door Hinged on Right

24"	24"	68"	H2W1C24RW	\$2059
-----	-----	-----	------------------	--------

► **Specification Information, continued on next page**

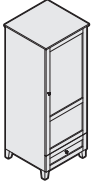
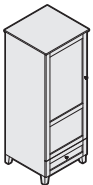
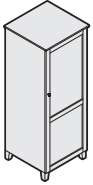
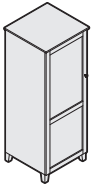

Tip: Single-door wardrobe cabinet with drawer has one lock in door and one lock in drawer. Locks are available field-installed only.



For Canadian Pricing

Multiply U.S. Price by the Canadian price factor.

► See page 1 for details.

► **Specification Information, continued from previous page**

Specification Information

• Dimensions			• Style	• U.S.
D	W	H	Number	Base Price

Double-Door Wardrobe Cabinets

24"	36"	68"	H2W236W	\$2392
-----	-----	-----	----------------	--------

Double-Door Wardrobe Cabinets with One Drawer

24"	36"	68"	H2W2C36W	\$2590
-----	-----	-----	-----------------	--------

Double-Door Cabinet with Three Drawers and 14"W Wardrobe on Left

24"	42"	68"	H2W3C42W	\$3567
-----	-----	-----	-----------------	--------

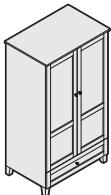
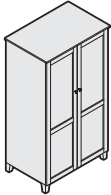

Tip: Double-door wardrobe cabinet with drawer has one lock for doors and one lock in drawer. Locks are available field-installed only.

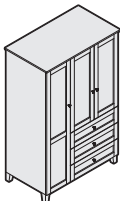

Tip: Double-door wardrobe cabinet with three drawers and 14"W wardrobe has one lock for double doors, one lock for wardrobe door and one lock in drawer. Locks are available field-installed only.



For Canadian Pricing

Multiply U.S. Price by the Canadian price factor.

► See page 1 for details.

Standard Includes		Required to Specify
<ul style="list-style-type: none"> ▶ Need help? Product details, page 230 	<ul style="list-style-type: none"> • TV cabinet case: melamine or wood veneer • Drawer fronts: wood to match case • Base: wood to match case • Top: laminate with wood edge to match case • Round knob pull on doors and drawers: satin chrome only • Adjustable glides 	<ol style="list-style-type: none"> 1 Style number 2 Laminate or wood color number for TV cabinet 3 Options, if selected (see below) <ul style="list-style-type: none"> ▶ See <i>Surface Materials</i>, page 681.

Options	U.S. Price	Required to Specify
Drawer Pulls <ul style="list-style-type: none"> • Flat knob pull: matte stainless steel 	+\$10 per pull	Specify <i>with flat knob pulls</i> .
Lock and Keying <ul style="list-style-type: none"> • Lock with random key <ul style="list-style-type: none"> • 9201 Polished Chrome only • Keying <ul style="list-style-type: none"> • Factory- and field-installed keying 	+\$31	Specify <i>with lock</i> . ▶ Page 716
Related Products <ul style="list-style-type: none"> • Accessories • Overbed tables • Headboards and footboards • Platform beds • Mirrors 		<ul style="list-style-type: none"> ▶ Page 437 ▶ Page 427 ▶ Page 432 ▶ Page 434 ▶ Page 435

Specification Information				
Dimensions			Style	U.S.
D	W	H	Number	Base Price

TV Cabinets with Melamine Case and Wood Fronts

With Three Drawers

18"	32"	68"	H2T332L	\$1564
-----	-----	-----	----------------	--------

With Four Drawers

18"	32"	76"	H2T432L	\$1841
-----	-----	-----	----------------	--------

TV Cabinets with Wood Case and Wood Fronts

With Three Drawers

18"	32"	68"	H2T332W	\$2205
-----	-----	-----	----------------	--------

With Four Drawers

18"	32"	76"	H2T432W	\$2598
-----	-----	-----	----------------	--------

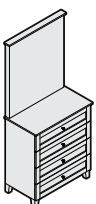
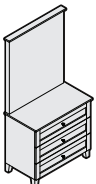
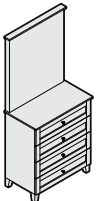
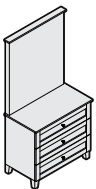

Ainsley Dressers

Standard Includes		Required to Specify
<ul style="list-style-type: none"> ▶ Need help? Product details, page 232 	<ul style="list-style-type: none"> • Dresser: melamine or wood veneer • Drawer fronts: wood to match case • Base: wood to match case • Top: laminate with wood edge to match case • Round knob pull on drawers: satin chrome only • Adjustable glides 	<ul style="list-style-type: none"> 1 Style number 2 Laminate or wood color number for dresser 3 Options, if selected (see below) ▶ See <i>Surface Materials</i>, page 681.

Options	U.S. Price	Required to Specify
Drawer Pulls <ul style="list-style-type: none"> • Flat knob pull: matte stainless steel 	+\$10 per pull	Specify <i>with flat knob pulls</i> .
Lock and Keying <ul style="list-style-type: none"> • Lock with random key • 9201 Polished Chrome only 	+\$31	Specify <i>with lock</i> .
		<ul style="list-style-type: none"> • Keying • Factory- and field-installed keying
Related Products <ul style="list-style-type: none"> • Accessories • Overbed tables • Headboards and footboards • Platform beds • Mirrors 		<ul style="list-style-type: none"> ▶ Page 437 ▶ Page 427 ▶ Page 432 ▶ Page 434 ▶ Page 435

Specification Information		
Dimensions	Style	U.S.
D W H	Number	Base Price

Dressers with Melamine Case and Wood Fronts

With Three Drawers

18"	32"	30"	H2D330L	\$1117
-----	-----	-----	----------------	--------

With Four Drawers

18"	32"	38"	H2D438L	\$1315
-----	-----	-----	----------------	--------

Dressers with Wood Case and Wood Fronts

With Three Drawers

18"	32"	30"	H2D330W	\$1570
-----	-----	-----	----------------	--------

With Four Drawers

18"	32"	38"	H2D438W	\$1855
-----	-----	-----	----------------	--------



For Canadian Pricing
 Multiply U.S. Price by the Canadian price factor.
 ▶ See page 1 for details.

	Standard Includes	Required to Specify
▶ Need help? Product details, page 234	<ul style="list-style-type: none"> Writing desk, end panels, and back panel: melamine or wood veneer Drawer fronts, if selected: wood to match writing desk, end panels, and back panel Base: wood to match writing desk, end panels, and back panel Top: laminate with wood edge to match writing desk, end panel, and back panel Round knob pull on doors and drawers, if selected: satin chrome only Adjustable glides 	<ol style="list-style-type: none"> Style number Laminate or wood color number for writing desk Options, if selected (see below) ▶ See <i>Surface Materials</i> , page 681.

	Options	U.S. Price	Required to Specify
Drawer Pulls	<ul style="list-style-type: none"> Flat knob pull: matte stainless steel 	+\$10 per pull	Specify <i>with flat knob pulls</i> .
Lock and Keying	<p>Lock with random key</p> <ul style="list-style-type: none"> 9201 Polished Chrome only <p>Keying</p> <ul style="list-style-type: none"> Factory- and field-installed keying 	+\$31	Specify <i>with lock</i> . ▶ Page 716
Related Products	<ul style="list-style-type: none"> Accessories Overbed tables Headboards and footboards Platform beds Mirrors 		<ul style="list-style-type: none"> ▶ Page 437 ▶ Page 427 ▶ Page 432 ▶ Page 434 ▶ Page 435

Specification Information				
Dimensions			Style	U.S.
D	W	H	Number	Base Price

Open Writing Desks

Melamine				
18"	48"	30"	H2KP48L	\$ 647
Wood				
18"	48"	30"	H2KP48W	\$ 847

Writing Desks with Melamine Case and Wood Fronts

With Full-Height Pedestal on Left				
18"	48"	30"	H2KM48LL	\$1148
With Full-Height Pedestal on Right				
18"	48"	30"	H2KM48RL	\$1148

Writing Desks with Wood Case and Wood Fronts

With Full-Height Pedestal on Left				
18"	48"	30"	H2KM48LW	\$1588
With Full-Height Pedestal on Right				
18"	48"	30"	H2KM48RW	\$1588

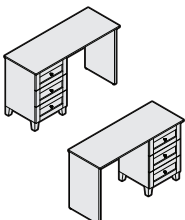
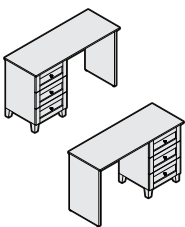
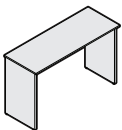

Ainsley Bookcases



Standard Includes	Required to Specify
<ul style="list-style-type: none"> ▶ Need help? Product details, page 236 • Bookcase and shelf: melamine or wood veneer • Base: wood to match case • Top: laminate with wood edge to match case • Adjustable glides 	<ul style="list-style-type: none"> 1 Style number 2 Melamine or wood color number for bookcase ▶ See <i>Surface Materials</i>, page 681.

Related Products	
<ul style="list-style-type: none"> • Accessories • Overbed tables • Headboards and footboards • Platform beds • Mirrors 	<ul style="list-style-type: none"> ▶ Page 437 ▶ Page 427 ▶ Page 432 ▶ Page 434 ▶ Page 435

Specification Information				
Dimensions			Style	U.S.
D	W	H	Number	Price

Bookcases

Melamine

12"	32"	30"	H2C13230L	\$515
-----	-----	-----	------------------	-------

Wood

12"	32"	30"	H2C13230W	\$606
-----	-----	-----	------------------	-------



For Canadian Pricing

Multiply U.S. Price by the Canadian price factor.

▶ See page 1 for details.

Ainsley Bedside Tables

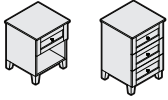

Tip: 18" deep bedside tables have a 15⁵/₈" deep drawer and the slide has 14" of travel. 24" deep bedside tables have a 19⁵/₈" deep drawer and a slide 21" of travel.

Standard Includes		Required to Specify	
<ul style="list-style-type: none"> ▶ Need help? Product details, page 238 	<ul style="list-style-type: none"> • Bedside table case: melamine or wood veneer • Door or drawer fronts: wood to match case • Base: wood to match case • Top: laminate with wood edge to match case • Round knob pull on doors and drawers: satin chrome only • Adjustable glides: black only 	<ol style="list-style-type: none"> 1 Style number 2 Laminate or wood color number for bedside table 3 Options, if selected (see below) <ul style="list-style-type: none"> ▶ See <i>Surface Materials</i>, page 681. 	
Options		U.S. Price	Required to Specify
Door and Drawer Pulls	<ul style="list-style-type: none"> • Flat knob pull: matte stainless steel 	+\$10 per pull	Specify <i>with flat knob pulls</i> .
Gallery Rails	<ul style="list-style-type: none"> • Gallery rails (set of three) 	+\$89	Specify <i>with gallery rails</i> .
Casters	<ul style="list-style-type: none"> • Casters (set of four) • Rear roller casters with front glides 	+\$21 +\$46	Specify <i>with casters</i> . Specify <i>with rear roller casters</i> .
Lock and Keying	<p>Lock with random key</p> <ul style="list-style-type: none"> • 9201 Polished Chrome only <p>Keying</p> <ul style="list-style-type: none"> • Factory- and field-installed keying 	+\$31	Specify <i>with lock</i> . ▶ Page 716
Related Products	<ul style="list-style-type: none"> • Accessories • Overbed tables • Headboards and footboards • Platform beds • Mirrors 		<ul style="list-style-type: none"> ▶ Page 437 ▶ Page 427 ▶ Page 432 ▶ Page 434 ▶ Page 435



For Canadian Pricing
Multiply U.S. Price by the Canadian price factor.
▶ See page 1 for details.

Specification Information

Dimensions			Style	U.S.
D	W	H	Number	Base Price

Bedside Tables with Melamine Case and Wood Fronts

Night Table with One Drawer and Open Shelf

18"	18"	24"	H2NE24L	\$ 615
-----	-----	-----	----------------	--------

Bedside Table with Three Drawers

18"	18"	30"	H2BM30L	\$ 967
-----	-----	-----	----------------	--------

Bedside Tables with Wood Case and Wood Fronts

Night Table with One Drawer and Open Shelf

18"	18"	24"	H2NE24W	\$ 894
-----	-----	-----	----------------	--------

Bedside Table with Three Drawers

18"	18"	30"	H2BM30W	\$1298
-----	-----	-----	----------------	--------

Melamine Bedside Tables with One Drawer and One Door

Door Hinged on Left

18"	18"	30"	H2BG30LL	\$ 788
-----	-----	-----	-----------------	--------

Door Hinged on Right

18"	18"	30"	H2BG30RL	\$ 788
-----	-----	-----	-----------------	--------

Wood Bedside Tables with One Drawer and One Door

Door Hinged on Left

18"	18"	30"	H2BG30LW	\$1055
-----	-----	-----	-----------------	--------

Door Hinged on Right

18"	18"	30"	H2BG30RW	\$1055
-----	-----	-----	-----------------	--------



For Canadian Pricing
Multiply U.S. Price by the
Canadian price factor.
▶ See page 1 for details.

Ainsley Headwall Wardrobe Cabinets

Melamine Case with Wood Fronts

Standard Includes		Required to Specify
<ul style="list-style-type: none"> ▶ Need help? Product details, page 240 	<ul style="list-style-type: none"> • Headwall wardrobe case: melamine • Door and drawer fronts: wood to match case • Enclosed base: black melamine only • Top: laminate with wood edge to match case • Round knob pull on doors and drawers: satin chrome only • Hanger bar: black only • Adjustable glides • Fixed shelf 	<ul style="list-style-type: none"> 1 Style number 2 Laminate color number for headwall wardrobe cabinet 3 Options, if selected (see below) ▶ See <i>Surface Materials</i>, page 681.

Options	U.S. Price	Required to Specify
Door and Drawer Pulls <ul style="list-style-type: none"> • Flat knob pull: matte stainless steel 	+\$10 per pull	Specify with flat knob pulls.
Lock and Keying <ul style="list-style-type: none"> • Lock with random key • 9201 Polished Chrome only • Keying • Factory- and field-installed keying 	+\$62	Specify with lock. ▶ Page 716
Related Products <ul style="list-style-type: none"> • Accessories • Overbed tables • Headboards and footboards • Platform beds • Mirrors 		<ul style="list-style-type: none"> ▶ Page 437 ▶ Page 427 ▶ Page 432 ▶ Page 434 ▶ Page 435

Tip: Single-door wardrobe cabinet with drawer has one lock in door and one lock in drawer. Locks are available field-installed only.

Tip: Double-door wardrobe cabinet with drawer has one lock for doors and one lock in drawer. Locks are available field-installed only.

Tip: Cabinets must be attached to the wall.

Specification Information					
Dimensions			Style	U.S.	
D	W	H	Number	Base	Price
:	:	:	:	:	:

Single-Door Wardrobe Cabinets with One Drawer

Door Hinged on Left

24"	18"	80"	H2HW1C18LL	\$2075
-----	-----	-----	-------------------	--------

Door Hinged on Right

24"	18"	80"	H2HW1C18RL	\$2075
-----	-----	-----	-------------------	--------

Double-Door Wardrobe Cabinets with One Drawer

24"	24"	80"	H2HW2C24L	\$2148
-----	-----	-----	------------------	--------

24"	30"	80"	H2HW2C30L	\$2290
-----	-----	-----	------------------	--------

24"	36"	80"	H2HW2C36L	\$2417
-----	-----	-----	------------------	--------

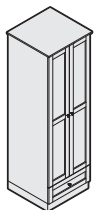
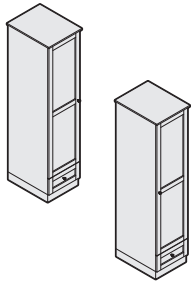

 **For Canadian Pricing**
Multiply U.S. Price by the Canadian price factor.
▶ See page 1 for details.

Ainsley Headwall Wardrobe Cabinets

Wood Veneer Case with Wood Fronts

Ainsley
Headwall Wardrobe
Cabinets

Standard Includes		Required to Specify
▶ Need help? Product details, page 240	<ul style="list-style-type: none"> Headwall wardrobe case: wood veneer Door and drawer fronts: wood to match case Enclosed base: black melamine only Top: laminate with wood edge to match case Round knob pull on doors and drawers: satin chrome only Hanger bar: black only Adjustable glides Fixed shelf 	1 Style number 2 Wood color number for headwall wardrobe cabinet 3 Options, if selected (see below) ▶ See <i>Surface Materials</i> , page 681.

Options	U.S. Price	Required to Specify
Door and Drawer Pulls	<ul style="list-style-type: none"> Flat knob pull: matte stainless steel +\$10 per pull	Specify with flat knob pulls.
Lock and Keying	Lock with random key <ul style="list-style-type: none"> 9201 Polished Chrome only +\$62	Specify with lock.
	Keying	▶ Page 716
Related Products	<ul style="list-style-type: none"> Accessories Overbed tables Headboards and footboards Platform beds Mirrors 	▶ Page 437 ▶ Page 427 ▶ Page 432 ▶ Page 434 ▶ Page 435

Tip: Single-door wardrobe cabinet with drawer has one lock in door and one lock in drawer. Locks are available field-installed only.

Tip: Double-door wardrobe cabinet with drawer has one lock for doors and one lock in drawer. Locks are available field-installed only.

Tip: Cabinets must be attached to the wall.

Specification Information				
Dimensions			Style	U.S.
D	W	H	Number	Base Price
:	:	:	:	:
:	:	:	:	:

Single-Door Wardrobe Cabinets with One Drawer

Door Hinged on Left

24"	18"	80"	H2HW1C18LW	\$2490
-----	-----	-----	-------------------	--------

Door Hinged on Right

24"	18"	80"	H2HW1C18RW	\$2490
-----	-----	-----	-------------------	--------

Double-Door Wardrobe Cabinets with One Drawer

24"	24"	80"	H2HW2C24W	\$2567
-----	-----	-----	------------------	--------

24"	30"	80"	H2HW2C30W	\$2748
-----	-----	-----	------------------	--------

24"	36"	80"	H2HW2C36W	\$2901
-----	-----	-----	------------------	--------

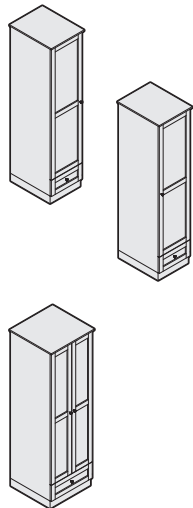

 **For Canadian Pricing**
 Multiply U.S. Price by the Canadian price factor.
 ▶ See page 1 for details.

Ainsley Headwall Columns

Melamine Case with Wood Fronts

	Standard Includes	Required to Specify
▶ Need help? Product details, page 240	<ul style="list-style-type: none"> • Headwall column case: melamine • Door and drawer fronts: wood to match case • Enclosed base: black melamine only • Top: laminate with wood edge to match case • Round knob pull on doors and drawers: satin chrome only • Hanger bar: black only • Adjustable glides 	1 Style number 2 Laminate color number for headwall column 3 Options, if selected (see below) ▶ See <i>Surface Materials</i> , page 681.

	Options	U.S. Price	Required to Specify
Door and Drawer Pulls	<ul style="list-style-type: none"> • Flat knob pull: matte stainless steel 	+\$10 per pull	Specify with flat knob pulls.
Lock and Keying	<ul style="list-style-type: none"> • Lock with random key • 9201 Polished Chrome only 	+\$31 per lock	Specify with lock.
	<ul style="list-style-type: none"> • Keying • Factory- and field-installed keying 		▶ Page 716
Related Products	<ul style="list-style-type: none"> • Accessories • Overbed tables • Headboards and footboards • Platform beds • Mirrors 		▶ Page 437 ▶ Page 427 ▶ Page 432 ▶ Page 434 ▶ Page 435

Tip: Headwall column lock is located in top drawer of lower storage cabinet. Upper storage cabinet does not lock.

Tip: Headwall column must be attached to the wall.

Specification Information				
Dimensions			Style	U.S.
D	W	H	Number	Base Price
:	:	:	:	:
:	:	:	:	:

With Single-Door Overhead Storage and Three Drawers

Door Hinged on Left

18"	18"	80"	H2HC1880LL	\$2481
-----	-----	-----	-------------------	--------

Door Hinged on Right

18"	18"	80"	H2HC1880RL	\$2481
-----	-----	-----	-------------------	--------

▶ Specification Information, continued on next page

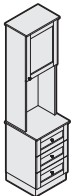
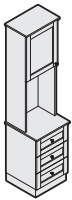

For Canadian Pricing

Multiply U.S. Price by the Canadian price factor.

▶ See page 1 for details.

► **Specification Information, continued from previous page**

Specification Information

Dimensions			Style	U.S.
D	W	H	Number	Base Price

With Double-Door Overhead Storage and Three Drawers

18"	24"	80"	H2HC2480LL	\$2534
18"	30"	80"	H2HC3080LL	\$2722
18"	36"	80"	H2HC3680LL	\$2876

With Double-Door Overhead Storage and Desk

18"	24"	80"	H2HCK2480L	\$2137
18"	36"	80"	H2HCK3680L	\$2343

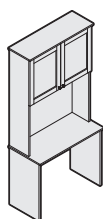
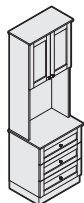

For Canadian Pricing

Multiply U.S. Price by the Canadian price factor.

► See page 1 for details.

Ainsley Headwall Columns

Wood Veneer Case with Wood Fronts

	Standard Includes	Required to Specify
▶ Need help? Product details, page 240	<ul style="list-style-type: none"> • Headwall column case: wood veneer • Door and drawer fronts: wood to match case • Enclosed base: black melamine only • Top: laminate with wood edge to match case • Round knob pull on doors and drawers: satin chrome only • Hanger bar: black only • Adjustable glides 	<ul style="list-style-type: none"> 1 Style number 2 Wood color number for headwall column 3 Options, if selected (see below) ▶ See <i>Surface Materials</i>, page 681.

	Options	U.S. Price	Required to Specify
Door and Drawer Pulls	<ul style="list-style-type: none"> • Flat knob pull: matte stainless steel 	+\$10 per pull	Specify with <i>flat knob pulls</i> .
Lock and Keying	<ul style="list-style-type: none"> • Lock with random key • 9201 Polished Chrome only 	+\$31 per lock	Specify with <i>lock</i> .
	<ul style="list-style-type: none"> • Keying • Factory- and field-installed keying 		▶ Page 716
Related Products	<ul style="list-style-type: none"> • Accessories • Overbed tables • Headboards and footboards • Platform beds • Mirrors 		<ul style="list-style-type: none"> ▶ Page 437 ▶ Page 427 ▶ Page 432 ▶ Page 434 ▶ Page 435

Tip: Headwall column lock is located in top drawer of lower storage cabinet. Upper storage cabinet does not lock.

Tip: Headwall column must be attached to the wall.

Specification Information				
Dimensions			Style	U.S.
D	W	H	Number	Base Price

With Single-Door Overhead Storage and Three Drawers

Door Hinged on Left

18"	18"	80"	H2HC1880LW	\$2978
-----	-----	-----	-------------------	--------

Door Hinged on Right

18"	18"	80"	H2HC1880RW	\$2978
-----	-----	-----	-------------------	--------

▶ **Specification Information, continued on next page**

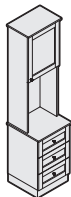
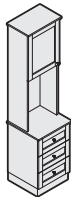

For Canadian Pricing

Multiply U.S. Price by the Canadian price factor.

▶ See page 1 for details.

► **Specification Information, continued from previous page**

Specification Information

Dimensions			Style	U.S.
D	W	H	Number	Base Price

With Double-Door Overhead Storage and Three Drawers

18"	24"	80"	H2HC2480LW	\$3041
18"	30"	80"	H2HC3080LW	\$3266
18"	36"	80"	H2HC3680LW	\$3451

With Double-Door Overhead Storage and Desk

18"	24"	80"	H2HCK2480W	\$2564
18"	36"	80"	H2HCK3680W	\$2802

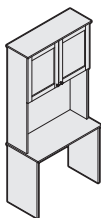
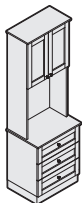

For Canadian Pricing

Multiply U.S. Price by the Canadian price factor.

► See page 1 for details.

Ainsley Headwall Upper Storage Cabinets

Melamine Case with Wood Fronts

Standard Includes		Required to Specify
<ul style="list-style-type: none"> ▶ Need help? Product details, page 242 	<ul style="list-style-type: none"> • Headwall upper storage case: melamine • Door fronts: wood to match case • Round knob pull on doors and drawers: satin chrome only • Attachment hardware 	<ul style="list-style-type: none"> 1 Style number 2 Laminate color number for headwall upper storage 3 Options, if selected (see below) ▶ See <i>Surface Materials</i>, page 681.

Options	U.S. Price	Required to Specify
Door Pulls <ul style="list-style-type: none"> • Flat knob pull: matte stainless steel 	+\$10 per pull	Specify <i>with flat knob pulls</i> .

Related Products		
<ul style="list-style-type: none"> • Accessories • Overbed tables • Headboards and footboards • Platform beds • Mirrors 		<ul style="list-style-type: none"> ▶ Page 437 ▶ Page 427 ▶ Page 432 ▶ Page 434 ▶ Page 435

Tip: Cabinets must be attached to the wall.

Specification Information				
Dimensions			Style	U.S.
D	W	H	Number	Base Price
:	:	:	:	:
:	:	:	:	:

With Single Door

Door Hinged on Left

12"	18"	24"	H2HUD1824LL	\$ 815
-----	-----	-----	--------------------	--------

Door Hinged on Right

12"	18"	24"	H2HUD1824RL	\$ 815
-----	-----	-----	--------------------	--------

With Double Doors

12"	24"	24"	H2HUD2424L	\$ 885
-----	-----	-----	-------------------	--------

12"	30"	24"	H2HUD3024L	\$ 971
-----	-----	-----	-------------------	--------

12"	36"	24"	H2HUD3624L	\$1067
-----	-----	-----	-------------------	--------



For Canadian Pricing

Multiply U.S. Price by the Canadian price factor.

▶ See page 1 for details.

Ainsley Headwall Upper Storage Cabinets

Wood Veneer Case with Wood Fronts

Ainsley
Headwall Upper Storage
Cabinets

Standard Includes		Required to Specify
▶ Need help? Product details, page 242	<ul style="list-style-type: none"> Headwall upper storage case: wood veneer Door fronts: wood to match case Round knob pull on doors and drawers: satin chrome only Attachment hardware 	1 Style number 2 Wood color number for headwall upper storage 3 Options, if selected (see below) ▶ See <i>Surface Materials</i> , page 681.

Options	U.S. Price	Required to Specify
Door Pulls	+\$10 per pull	Specify <i>with flat knob pulls</i> .

Related Products	<ul style="list-style-type: none"> Accessories Overbed tables Headboards and footboards Platform beds Mirrors 	▶ Page 437 ▶ Page 427 ▶ Page 432 ▶ Page 434 ▶ Page 435
-------------------------	--	--

Specification Information				
Dimensions			Style	U.S.
D	W	H	Number	Base Price
:	:	:	:	:
:	:	:	:	:

With Single Door

Door Hinged on Left

12"	18"	24"	H2HUD1824LW	\$ 979
-----	-----	-----	--------------------	--------

Door Hinged on Right

12"	18"	24"	H2HUD1824RW	\$ 979
-----	-----	-----	--------------------	--------

With Double Doors

12"	24"	24"	H2HUD2424W	\$1062
-----	-----	-----	-------------------	--------

12"	30"	24"	H2HUD3024W	\$1166
-----	-----	-----	-------------------	--------

12"	36"	24"	H2HUD3624W	\$1280
-----	-----	-----	-------------------	--------



 **For Canadian Pricing**
 Multiply U.S. Price by the
 Canadian price factor.
 ▶ See page 1 for details.

Ainsley Headwall Center Panels

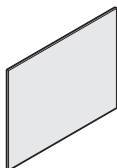

Standard Includes		Required to Specify
<ul style="list-style-type: none"> ▶ Need help? Product details, page 244 	<ul style="list-style-type: none"> • Headwall center panel: melamine or wood • Attachment hardware 	<ul style="list-style-type: none"> 1 Style number 2 Laminate or wood color number for headwall center panel ▶ See <i>Surface Materials</i>, page 681.

Related Products	
<ul style="list-style-type: none"> • Accessories • Overbed tables • Headboards and footboards • Platform beds • Mirrors 	<ul style="list-style-type: none"> ▶ Page 437 ▶ Page 427 ▶ Page 432 ▶ Page 434 ▶ Page 435

Specification Information

Dimensions			Style	U.S.
D	W	H	Number	Price

Headwall Center Panels For Melamine Headwall Columns

3/4"	54"	48"	HHP54L	\$454
3/4"	60"	48"	HHP60L	\$474

Headwall Center Panels For Wood Headwall Columns

3/4"	54"	48"	HHP54W	\$545
3/4"	60"	48"	HHP60W	\$569



For Canadian Pricing
Multiply U.S. Price by the
Canadian price factor.
▶ See page 1 for details.

Ainsley Headwall Bridge Units

Ainsley
Headwall Bridge Units

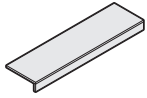

Standard Includes		Required to Specify
▶ Need help? Product details, page 245	<ul style="list-style-type: none"> • Headwall bridge units: melamine or wood • Attachment hardware 	1 Style number 2 Laminate or wood color number for headwall bridge units ▶ See <i>Surface Materials</i> , page 681.

Related Products	
<ul style="list-style-type: none"> • Accessories • Overbed tables • Headboards and footboards • Platform beds • Mirrors 	<ul style="list-style-type: none"> ▶ Page 437 ▶ Page 427 ▶ Page 432 ▶ Page 434 ▶ Page 435

Specification Information

Dimensions			Style	U.S.
D	W	H	Number	Price

Headwall Bridges For Melamine Headwall Columns

8"	54"	2 ³ / ₄ "	HHG54L	\$339
8"	60"	2 ³ / ₄ "	HHG60L	\$359

Headwall Bridges For Wood Headwall Columns

8"	54"	2 ³ / ₄ "	HHG54W	\$407
8"	60"	2 ³ / ₄ "	HHG60W	\$431

Ainsley



For Canadian Pricing
 Multiply U.S. Price by the
 Canadian price factor.
 ▶ See page 1 for details.

Surface Materials

Nurture Surface Materials	682
Color Availability Matrix for Nurture Casegoods	684
Color Availability Matrix for Nurture Seating and Tables	686
Recommended Worksurface Edge Finishes	690
Steelcase Seating Surface Materials	691
Steelcase Wood Seating Surface Materials	692
Turnstone Seating Surface Materials	693
Visual Worktools Surface Materials	694
Upholstery and Color Numbers	696
Nurture Graded-In Programs	
Acrylic Panel	698
Solid Surface	698
Upholstery	699
Fabric Application Direction Guidelines	702

Nurture Surface Materials

This listing includes all the surface material choices that are available for the Nurture products in this specification guide.

Resources

For more information about Nurture surface materials or to get surface material samples, contact Nurture at 1.800.342.8562.

Materials and colors are not available on every product. Refer to the Color Availability Matrices before specifying.

Plastisol/Urethane

6059 Sterling Dark
6161 Graphite
6162 Taupe
6205 Black

Paint

4750 Champagne Metallic
4798 Sterling
4799 Platinum Metallic
4851 Wheat
4853 Cream
4854 Graphite
4855 Silver
7207 Black
7225 Sand
7237 Slate
7238 Fieldstone
7239 Midnight
7241 Arctic White
7243 Seagull

Metal

Polished Chrome
Brushed Stainless Steel
Nickel Steel

Wood

Veneer

3402 Clear Cherry
3412 Natural Cherry **E**
3416 Light Cherry (W-15)
3422 Medium Cherry
3456 Clear on Ash
3457 Almond on Ash
3458 Samba on Ash
3459 Cognac on Ash
3460 Dark Rum on Ash
3461 Shiraz on Ash
3462 Flamenco on Ash
3522 Clear Maple
3572 Amber Maple
3575 Sugarloaf Maple
3576 Almond Cherry
3577 Samba Cherry
3578 Cognac Cherry
3579 Dark Rum Cherry
3580 Shiraz Cherry
3581 Flamenco Cherry
3592 Blonde on Maple
3602 Desert Oak
3620 English Oak (W-20)
3730 Mahogany (W-45)
3772 Medium Mahogany on Walnut
3970 Ebony (W-60)

Laminate

Laminate

2570 Sugarloaf Maple
2571 Almond Cherry
2572 Samba Cherry
2573 Cognac Cherry
2574 Dark Rum Cherry
2575 Shiraz Cherry
2576 Flamenco Cherry

Steelcase High-Pressure Laminate

Applies to:

- Cura Tables
- Exchange Tables
- Folio Worksurfaces
- Malibu Tables
- Neighbor Tables
- Progeny Tables
- Rave Tables
- Sieste Tables
- Sine Tables
- Sonata Tops
- Sync

Fiber Laminate

2850 Vanadium Fiber
2851 Rhyme Fiber
2852 Tungsten Fiber
2854 Vellum Fiber
2859 Novell Fiber
2860 Granite Fiber
2861 Coconut Fiber
2862 Stucco Fiber

Micro Laminate

2920 Marl Micro
2921 Gypsum Micro
2922 Clay Micro
2923 Shadow Micro

Patina Laminate

2870 Blonde Bronze Patina
2871 Blackened Bronze Patina
2873 Instant Iron Patina

Solid Laminate

2722 Cream **E**
2730 Arctic White
2746 Black
2759 Warm White **E**
2766 Warm Brown V1
2782 Grey V1
2811 Mist **E**
2883 Seagull
2884 Milk
2885 Dune

Speckle Laminate

2820 Coffee Speckle
2822 Woodrose Speckle
2823 Driftwood Speckle
2824 Smoke Speckle
2825 Vanadium Speckle

Woodgrain Laminate

2409 Clear Maple
2410 Graphite Walnut
2412 Natural Cherry
2422 Medium Cherry
2511 Winter on Maple
2538 Clear Walnut
2539 Warm Oak
2592 Blonde on Maple
2714 Natural Walnut
2772 Medium Mahogany on Walnut **E**

Turnstone Laminate Collection

A selection of laminates and edge bands in this collection are available on Steelcase brand products. This collection is available with standard leadtimes and supported like standard laminates to help make ordering easy. Please see the Turnstone section of in2.steelcase.com for swatching information.

2535 Virginia Walnut
2536 Blackwood
2612 Marbled Maple
2614 Chocolate Walnut
2615 Marbled Cherry

Open Line Laminate (OLL)

Open Line laminates are available at an additional \$64 (U.S.) per surface, plus the cost of the laminate.

Example:

4' x 8' sheet = 32 square feet
32 square feet x \$1.10 = \$35.20 (U.S.) per sheet
Laminate costs vary by supplier. The cost of the laminate will be added to your invoice as a separate line on the acknowledgement.

Applies to:

- Exchange tables
- Folio Laminate worksurfaces
- Opus
- Sonata
- Jenny
- Sync

This service allows you to order non-standard laminate at an additional fee per unit. See the specification pages for upcharge information.

When processing orders for Open Line Laminate on Opus or Sonata, specify 2902 in the laminate finish field and enter the OLL manufacturer information.

Edge bands must also be specified and will incur an \$83 upcharge.

6131 White
6132 Grey
6133 Folkstone
6134 Northsea
6135 Shadow
6136 Nubian Brown
6137 Black

When processing orders for Open Line Laminate

on Jenny, Exchange tables, Folio Laminate Worksurfaces, and Sync, specify 2900 in the laminate finish field and enter the OLL manufacturer information.

Edge bands must also be specified using the plastic edge band offering.

Thermoform

2030 Arctic White
2031 Seagull
2032 Dune
2065 Sugarloaf Maple
2066 Almond Cherry
2068 Cognac Cherry
2069 Dark Rum Cherry
2070 Shiraz Cherry
2071 Flamenco Cherry
2072 Samba Cherry
6775 Sand

Solid Surface

Applies to:

- Folio Worksurfaces
- Leela
- Senza
- Sonata
- Sync
- Tava

Price Group A

2975 Bisque

Price Group B

2973 Linen

Price Group C

2972 Antarctica
2974 Canvas

E = Established

Plastic Edge Band

- 6013 Sugarloaf Maple
- 6014 Almond Cherry
- 6021 Samba Cherry
- 6022 Cognac Cherry
- 6023 Dark Rum Cherry
- 6024 Shiraz Cherry
- 6025 Flamenco Cherry

Applies to:

- Cura tables
- Exchange tables
- Folio Worksurfaces
- Sync

- 6000 Black
- 6001 Coffee
- 6034 Natural Cherry
- 6036 Medium Cherry
- 6037 Winter on Maple
- 6038 Blonde on Maple
- 6041 Natural Walnut
- 6052 Milk
- 6053 Seagull
- 6231 Graphite Walnut
- 6237 Clear Maple
- 6242 Virginia Walnut
- 6243 Blackwood
- 6245 Clear Walnut
- 6246 Warm Oak
- 6249 Platinum Solid
- 6615 Grey Value 5
- 6619 Ice **E**
- 6631 Cream
- 6635 Dawn **E**
- 6636 Mist
- 6654 Sand
- 6655 Warm White
- 6676 Marbled Maple
- 6677 Chocolate Walnut
- 6678 Marbled Cherry
- 6694 Slate
- 6695 Midnight
- 6697 Fog

Fusion

Applies to:

- Sonata island modules

Price Group 1

- 6526 Mulberry Tissue

Price Group 3

- 6523 Desert Stalk

Price Group 4

- 6525 Sheer Leaf Medium

Soft Pulls

- 6000 Black

E = Established

Markerboard

Applies to:

- Opus wardrobe cabinet with sliding door only
- White

Urethane

Applies to:

- Verge seat
- 6688 Non metallic steel

CuraNet

Applies to:

- Cura
- 5081 Ash (Silver Grey)
5083 Lily Pad (Moss)
5085 Ebony (Black)
5086 Camel
5087 Cocoa
5088 Aquamarine

Promessa

Applies to:

- Cura
- UL81 Ash
UL83 Lily Pad
UL85 Ebony
UL86 Camel
UL87 Cocoa
UL88 Aquamarine

Upholstery

▶ See page 696 for a complete listing of upholstery colors and numbers

California 133 Option

Nurture offers Fire Code Seating Modifications (FCS) on nearly all seating models. The most rigorous fire codes in the nation have been developed in California, and the Steelcase FCS modification is designed to meet those codes. Fire Code Seating (FCS) indicates that a product is constructed to meet the strict fire code requirements of high public occupancy areas such as hospitals, theaters, meeting rooms, and lobbies. The FCS standards will meet both the State of California Home Furnishings Technical Bulletin 133 (CAL TB 133) and Boston Fire Code (BFC). Boston adopted the California Home Furnishing Technical Bulletin CAL TB 133 test standard in 1992.

CAL 133 is specified using an "F" suffix. When an "F" suffix is available, it means that these models have been tested and certified using approved fabrics. A complete list of approved fabrics are listed on the COM website at www.Steelcase.com

If a specific chair/fabric combination has not been tested, an actual burn test can be performed on the product in the specified fabric. The cost of the test is \$700 (net). Please allow a minimum of six weeks for the production of the chair and the completion of the test.

Color Availability Matrix for Nurture Casegoods

Legend

- = Not available
- = Available
- = Available with exceptions
- ▶ See specification pages for details.

		Veneer							Laminate								Solid Surface					
		3575	3576	3577	3578	3579	3580	3581	2570	2571	2572	2573	2574	2575	2576	2730	2883	2885	2972	2973	2974	2975
		Sugarloaf Maple	Almond Cherry	Samba Cherry	Cognac Cherry	Dark Rum Cherry	Shiraz Cherry	Flamenco Cherry	Sugarloaf Maple	Almond Cherry	Samba Cherry	Cognac Cherry	Dark Rum Cherry	Shiraz Cherry	Flamenco Cherry	Arctic White	Seagull	Dune	Antarctica	Linen	Canvas	Bisque
Ainsley		■	■	■	■	■	■	■	■	■	■	■	■	■	■	■	■	■	■	■	■	■
Davenport		•	•	•	•	•	•	•	■	■	■	■	■	■	■	■	■	■	■	■	■	■
Exchange Table	Base	•	•	•	•	•	•	•	•	•	•	•	•	•	•	•	•	•	•	•	•	•
	Table Top*	•	•	•	•	•	•	•	■	■	■	■	■	■	■	■	■	■	■	■	■	■
Folio	Cabinets	•	•	•	•	•	•	•	■	■	■	■	■	■	■	■	■	■	■	■	■	■
	Laminate Worksurfaces*	•	•	•	•	•	•	•	■	■	■	■	■	■	■	■	■	■	■	■	■	■
	Solid Surface Worksurfaces	•	•	•	•	•	•	•	•	•	•	•	•	•	•	•	•	•	■	■	■	■
Opus	Cabinets	•	•	•	•	•	•	•	■	■	■	■	■	■	■	■	■	■	■	■	■	■
	Door pulls, table rails, and coat hooks	•	•	•	•	•	•	•	•	•	•	•	•	•	•	•	•	•	•	•	•	•
Park		•	•	•	•	•	•	•	■	■	■	■	■	■	■	■	■	■	■	■	■	■
Senza		■	■	■	■	■	■	■	■	■	■	■	■	■	■	■	■	■	■	■	■	■
Sonata*	Cabinets	•	•	•	•	•	•	•	■	■	■	■	■	■	■	■	■	■	■	■	■	■
	Rails, drawer/door pulls, and coat hooks	•	•	•	•	•	•	•	•	•	•	•	•	•	•	•	•	•	•	•	•	•
Sync*		•	•	•	•	•	•	•	■	■	■	■	■	■	■	■	■	■	■	■	■	■
Viridian		•	•	•	•	•	•	•	•	•	•	•	•	•	•	•	•	•	•	•	•	•
Waldorf		■	■	■	■	■	■	■	•	•	•	•	•	•	•	•	•	•	•	•	•	•
Overbed Tables		•	•	•	•	•	•	•	■	■	■	■	■	■	■	■	■	■	■	■	■	■
Headboards/Footboards		■	■	■	■	■	■	■	■	■	■	■	■	■	■	■	■	■	■	■	■	■

*Exchange table tops, Folio worksurfaces, Sonata tops, and Sync table tops are available in all Steelcase laminates.

▶ See page 691

Thermoform	
2030	Arctic White
2031	Seagull
2032	Dune
2065	Sugarloaf Maple
2066	Almond Cherry
2068	Cognac Cherry
2069	Dark Rum Cherry
2070	Shiraz Cherry
2071	Flamenco Cherry
2072	Samba Cherry
Fusion	
6523	Desert Stalk
6525	Sheer Leaf Medium
6526	Creamsicle
Paint	
4750	Champagne
4798	Sterling
4799	Platinum
7207	Black

Color Availability Matrix for Nurture Seating and Tables

Legend

- = Not available
- = Available
- = Available with exceptions
- ▶ See specification pages for details.

		Veneer																										
		3402	3412	3416	3422	3456	3457	3458	3459	3460	3461	3462	3522	3572	3575	3576	3577	3578	3579	3580	3581	3592	3602	3620	3730	3772	3970	
		Clear Cherry	Natural Cherry ^E	Light Cherry (W-15)	Medium Cherry	Clear on Ash	Almond on Ash	Samba on Ash	Cognac on Ash	Dark Rum on Ash	Shiraz on Ash	Flamenco on Ash	Clear Maple	Amber Maple	Sugarloaf Maple	Almond Cherry	Samba Cherry	Cognac Cherry	Dark Rum Cherry	Shiraz Cherry	Flamenco Cherry	Blonde on Maple	Desert Oak	English Oak (W-20)	Mahogany (W-45)	Medium Mahogany on Walnut	Ebony (W-60)	
Amaris	Legs	•	•	•	•	•	•	•	•	•	•	•	•	•	•	•	•	•	•	•	•	•	•	•	•	•	•	
	Arm Caps	•	•	•	•	•	•	•	•	•	•	•	•	•	•	•	•	•	•	•	•	•	•	•	•	•	•	•
Asana		•	•	•	•	•	•	•	•	•	•	•	•	•	•	•	•	•	•	•	•	•	•	•	•	•	•	•
Aspekt	Seating Frame	•	•	•	•	•	•	•	•	•	•	•	•	•	•	•	•	•	•	•	•	•	•	•	•	•	•	•
	Arm Caps	•	•	•	•	•	•	•	•	•	•	•	•	•	•	•	•	•	•	•	•	•	•	•	•	•	•	•
	Table Legs	•	•	•	•	•	•	•	•	•	•	•	•	•	•	•	•	•	•	•	•	•	•	•	•	•	•	•
	Table Top	•	•	•	•	•	•	•	•	•	•	•	•	•	•	•	•	•	•	•	•	•	•	•	•	•	•	•
Cura	Arm Caps	•	•	•	•	•	•	•	•	•	•	•	•	•	•	•	•	•	•	•	•	•	•	•	•	•	•	•
	Frame	•	•	•	•	•	•	•	•	•	•	•	•	•	•	•	•	•	•	•	•	•	•	•	•	•	•	•
	Table Top*	•	•	•	•	•	•	•	•	•	•	•	•	•	•	•	•	•	•	•	•	•	•	•	•	•	•	•
Cypress		•	•	•	•	•	•	•	•	•	•	•	•	•	•	•	•	•	•	•	•	•	•	•	•	•	•	•
Empress	Lounge Frame	•	•	•	•	•	•	•	•	•	•	•	•	•	•	•	•	•	•	•	•	•	•	•	•	•	•	•
	Lounge Arm Caps	•	•	•	•	•	•	•	•	•	•	•	•	•	•	•	•	•	•	•	•	•	•	•	•	•	•	•
Flex Back		•	•	•	•	•	•	•	•	•	•	•	•	•	•	•	•	•	•	•	•	•	•	•	•	•	•	•
Flute		•	•	•	•	•	•	•	•	•	•	•	•	•	•	•	•	•	•	•	•	•	•	•	•	•	•	•
Hawthorne	Seating	•	•	•	•	•	•	•	•	•	•	•	•	•	•	•	•	•	•	•	•	•	•	•	•	•	•	•
Jarrah	Side Trim Panel	•	•	•	•	•	•	•	•	•	•	•	•	•	•	•	•	•	•	•	•	•	•	•	•	•	•	•
	Seating Legs	•	•	•	•	•	•	•	•	•	•	•	•	•	•	•	•	•	•	•	•	•	•	•	•	•	•	•
	Arm Caps	•	•	•	•	•	•	•	•	•	•	•	•	•	•	•	•	•	•	•	•	•	•	•	•	•	•	•
Leela	Arm Caps	•	•	•	•	•	•	•	•	•	•	•	•	•	•	•	•	•	•	•	•	•	•	•	•	•	•	•
	Legs	•	•	•	•	•	•	•	•	•	•	•	•	•	•	•	•	•	•	•	•	•	•	•	•	•	•	•
	Table Top	•	•	•	•	•	•	•	•	•	•	•	•	•	•	•	•	•	•	•	•	•	•	•	•	•	•	•
Linden	Seating Base	•	•	•	•	•	•	•	•	•	•	•	•	•	•	•	•	•	•	•	•	•	•	•	•	•	•	•
	Arm Caps	•	•	•	•	•	•	•	•	•	•	•	•	•	•	•	•	•	•	•	•	•	•	•	•	•	•	•
Loria		•	•	•	•	•	•	•	•	•	•	•	•	•	•	•	•	•	•	•	•	•	•	•	•	•	•	•
Kami		•	•	•	•	•	•	•	•	•	•	•	•	•	•	•	•	•	•	•	•	•	•	•	•	•	•	•
Malibu	Seating	■	■	■	■	•	•	•	•	•	•	•	•	•	•	•	•	•	•	•	•	•	•	•	•	•	•	•
	Tables*	■	■	■	■	•	•	•	•	•	•	•	•	•	•	•	•	•	•	•	•	•	•	•	•	•	•	•
Malibu Too		■	■	■	■	•	•	•	•	•	•	•	•	•	•	•	•	•	•	•	•	•	•	•	•	•	•	•
Mineral	Arm Caps	•	•	•	•	•	•	•	•	•	•	•	•	•	•	•	•	•	•	•	•	•	•	•	•	•	•	•
Mitra	Seating Frame	•	•	•	•	•	•	•	•	•	•	•	•	•	•	•	•	•	•	•	•	•	•	•	•	•	•	•
	Arm Caps	•	•	•	•	•	•	•	•	•	•	•	•	•	•	•	•	•	•	•	•	•	•	•	•	•	•	•
	Table Legs and Bases	•	•	•	•	•	•	•	•	•	•	•	•	•	•	•	•	•	•	•	•	•	•	•	•	•	•	•
	Table Top	•	•	•	•	•	•	•	•	•	•	•	•	•	•	•	•	•	•	•	•	•	•	•	•	•	•	•

^E = Established

* Also available in Steelcase Laminates.

▶ See page 691

Color Availability Matrix for Nurture Seating and Tables, continued

Legend

- = Not available
- = Available
- = Available with exceptions
- ▶ See specification pages for details.

		Veneer																									
		3402	3412	3416	3422	3456	3457	3458	3459	3460	3461	3462	3522	3572	3575	3576	3577	3578	3579	3580	3581	3592	3602	3620	3730	3772	3970
		Clear Cherry	Natural Cherry ^E	Light Cherry (W-15)	Medium Cherry	Clear on Ash	Almond on Ash	Samba on Ash	Cognac on Ash	Dark Rum on Ash	Shiraz on Ash	Flamenco on Ash	Clear Maple	Amber Maple	Sugarloaf Maple	Almond Cherry	Samba Cherry	Cognac Cherry	Dark Rum Cherry	Shiraz Cherry	Flamenco Cherry	Blonde on Maple	Desert Oak	English Oak (W-20)	Mahogany (W-45)	Medium Mahogany on Walnut	Ebony (W-60)
Neighbor	Frames	•	•	•	•	•	•	•	•	•	•	•	•	•	•	•	•	•	•	•	•	•	•	•	•	•	•
	Arm Cap	■	■	■	■	•	•	•	•	•	•	•	■	■	■	■	■	■	■	■	■	■	■	■	■	■	■
	Table Top*	■	■	■	■	•	•	•	•	•	•	•	■	■	■	■	■	■	■	■	■	■	■	■	■	■	■
Nikko	Seating Frame	•	•	•	•	•	•	•	•	•	•	•	•	•	■	■	■	■	■	■	■	•	•	•	•	•	•
	Arm Caps	•	•	•	•	•	•	•	•	•	•	•	•	•	■	■	■	■	■	■	■	•	•	•	•	•	•
Orchid		•	•	•	•	•	•	•	•	•	•	•	•	•	■	■	■	■	■	■	■	•	•	•	•	•	•
Progeny	Frame	■	■	■	■	•	•	•	•	•	•	•	■	■	■	■	■	■	■	■	■	■	■	■	■	■	■
	Arm Cap	■	■	■	■	•	•	•	•	•	•	•	■	■	■	■	■	■	■	■	■	■	■	■	■	■	■
	Table Top*	■	■	■	■	•	•	•	•	•	•	•	■	■	■	■	■	■	■	■	■	■	■	■	■	■	■
Rave	Arm Caps and Frame	■	■	■	■	•	•	•	•	•	•	•	■	■	■	■	■	■	■	■	■	■	■	■	■	■	■
	Tables*	■	■	■	■	•	•	•	•	•	•	•	■	■	■	■	■	■	■	■	■	■	■	■	■	■	■
Sequoia	Seating Frame	•	•	•	•	•	•	•	•	•	•	•	•	•	■	■	■	■	■	■	■	•	•	•	•	•	•
	Arm Caps	•	•	•	•	•	•	•	•	•	•	•	•	•	■	■	■	■	■	■	■	•	•	•	•	•	•
	Table Tops	•	•	•	•	•	•	•	•	•	•	•	•	•	•	•	•	•	•	•	•	•	•	•	•	•	•
Sieste	Arm Caps	■	■	■	■	•	•	•	•	•	•	•	■	■	■	■	■	■	■	■	■	■	■	■	■	■	■
	Legs	■	■	■	■	•	•	•	•	•	•	•	■	■	■	■	■	■	■	■	■	■	■	■	■	■	■
	Table Top*	■	■	■	■	•	•	•	•	•	•	•	■	■	■	■	■	■	■	■	■	■	■	■	■	■	■
Sieste Sleeper		■	■	■	■	•	•	•	•	•	•	•	■	■	■	■	■	■	■	■	■	■	■	■	■	■	■
Sine	Seating and Table Frame	•	•	•	•	•	•	•	•	•	•	•	•	•	•	•	•	•	•	•	•	•	•	•	•	•	•
	Table Top*	•	•	•	•	•	•	•	•	•	•	•	•	•	•	•	•	•	•	•	•	•	•	•	•	•	•
Slumber Day Bed		•	•	•	•	•	•	•	•	•	•	•	•	•	•	•	•	•	•	•	•	•	•	•	•	•	•
Sorrel	Seating Frame and Arm Caps	•	•	•	•	•	•	•	•	•	•	•	•	•	•	•	•	•	•	•	•	•	•	•	•	•	•
	Seating Backs	•	•	•	•	•	•	•	•	•	•	•	•	•	■	■	■	■	■	■	■	•	•	•	•	•	•
	Table Legs	•	•	•	•	•	•	•	•	•	•	•	•	•	•	•	•	•	•	•	•	•	•	•	•	•	•
	Table Tops	•	•	•	•	•	•	•	•	•	•	•	•	•	•	•	•	•	•	•	•	•	•	•	•	•	•
Tava	Arm and Legs	•	•	•	•	■	■	■	■	■	■	■	•	•	•	•	•	•	•	•	•	•	•	•	•	•	•
	Bench Body and Table Tops	•	•	•	•	•	•	•	•	•	•	•	•	•	•	•	•	•	•	•	•	•	•	•	•	•	•
Traditional Lounge		•	•	•	•	•	•	•	•	•	•	•	•	•	■	■	■	■	■	■	■	•	•	•	•	•	•
X-tenz Sleeper	Arm Caps	•	•	•	•	•	•	•	•	•	•	•	•	•	■	■	■	■	■	■	■	•	•	•	•	•	•
	Frame	•	•	•	•	•	•	•	•	•	•	•	•	•	•	•	•	•	•	•	•	•	•	•	•	•	•
Verge		•	•	•	•	•	•	•	•	•	•	•	•	•	•	•	•	•	•	•	•	•	•	•	•	•	•
Freestanding and Interconnecting Tables																											
	Table Top	•	•	•	•	•	•	•	•	•	•	•	•	•	•	•	•	•	•	•	•	•	•	•	•	•	•
	Metal Legs	•	•	•	•	•	•	•	•	•	•	•	•	•	•	•	•	•	•	•	•	•	•	•	•	•	•
	Wood Legs	•	•	•	•	•	•	•	•	•	•	•	•	•	■	■	■	■	■	■	■	•	•	•	•	•	•

^E = Established
 * Also available in Steelcase Laminates.
 ▶ See page 691

Recommended Worksurface Edge Finishes

Recommended Edge Colors

Edges

The recommended edge color will complement the laminate color you specify. Edge color is specified separately.

Steelcase Laminate Color	Recommended 3 mm Edge Color
Fiber	
2850 Vanadium Fiber	6654 Sand
2851 Rhyme Fiber	6631 Cream
2852 Tungsten Fiber	6636 Mist
2854 Vellum Fiber	6655 Warm White
2859 Novell Fiber	6001 Coffee
2860 Granite Fiber	6000 Black
2861 Coconut Fiber	6654 Sand
2862 Stucco Fiber	6053 Seagull
Micro	
2920 Marl Micro	6053 Seagull
2921 Gypsum Micro	6654 Sand
2922 Clay Micro	6654 Sand
2923 Shadow Micro	6249 Platinum Solid
Patina	
2870 Blonde Bronze Patina	6654 Sand
2871 Blackened Bronze Patina	6615 Grey Value 5
2873 Instant Iron Patina	6615 Grey Value 5
Solid	
2722 Cream E	6631 Cream
2730 Arctic White	6697 Fog
2746 Black	6000 Black
2759 Warm White E	6655 Warm White
2811 Mist E	6636 Mist
2883 Seagull	6053 Seagull
2884 Milk	6052 Milk
2885 Dune	6654 Sand
Speckle	
2820 Coffee Speckle	6631 Cream
2822 Woodrose Speckle	6635 Dawn E
2823 Driftwood Speckle	6631 Cream
2824 Smoke Speckle	6636 Mist
2825 Vanadium Speckle	6619 Ice E
Woodgrain	
2409 Clear Maple	6237 Clear Maple
2410 Graphite Walnut	6231 Graphite Walnut
2412 Natural Cherry	6034 Natural Cherry
2422 Medium Cherry	6036 Medium Cherry
2511 Winter on Maple	6037 Winter on Maple
2538 Clear Walnut	6245 Clear Walnut
2539 Warm Oak	6246 Warm Oak
2592 Blonde on Maple	6038 Blonde on Maple
2714 Natural Walnut	6041 Natural Walnut
2772 Medium Mahogany on Walnut E	6045 Medium Mahogany on Walnut E

Nurture Laminate Color	Recommended 3 mm Edge Color
Fiber	
2570 Sugarloaf Maple	6013 Sugarloaf Maple
2571 Almond Cherry	6014 Almond Cherry
2572 Samba Cherry	6021 Samba Cherry
2573 Cognac Cherry	6022 Cognac Cherry
2574 Dark Rum Cherry	6023 Dark Rum Cherry
2575 Shiraz Cherry	6024 Shiraz Cherry
2576 Flamenco Cherry	6025 Flamenco Cherry

E = Established

This listing includes all the surface material choices that are available for the products in this specification guide.

Resources

For more information about surface materials, refer to the following resources:

Additional surface materials specification tools are available to assist you in the specification process—the Surface Materials Binders.

Surface Materials Binders

- Surface Materials Reference Manual
- A complete set of swatch cards for hard surfaces, vertical surface fabrics, and seating upholstery

Materials and colors are not available on every product. Refer to the Color Availability and Upholstery Matrices before specifying.

Plastic

- 6009 Arctic White
- 6059 Sterling Dark Solid
- 6205 Black
- 6206 Burgundy
- 6249 Platinum Solid
- 6250 Coffee
- 6256 Graphite
- 6259 Midnight
- 6268 Navy
- 6296 Sterling
- 6301 Aegean
- 6302 Baltic
- 6303 Pomegranate
- 6332 Citron
- 6333 Picasso
- 6334 Flash
- 6335 Wasabi
- 6336 Jazz
- 6337 Element
- 6338 Chili

Seating Coating

- 7000 Black
- 7005 Coffee
- 7011 Graphite

Paint

- 0835 Black
- 4799 Platinum Metallic
- 7239 Midnight

E = Established

Metal

- 8046 Polished Aluminum
- 9201 Polished Chrome

Laminate

- 2406 Clear Cherry
- 2409 Clear Maple
- 2410 Graphite Walnut
- 2412 Natural Cherry
- 2422 Medium Cherry
- 2511 Winter on Maple
- 2538 Clear Walnut
- 2539 Warm Oak
- 2714 Natural Walnut
- 2722 Cream
- 2730 Arctic White
- 2746 Black
- 2759 Warm White
- 2772 Medium Mahogany on Walnut **E**
- 2811 Mist
- 2883 Seagull
- 2884 Milk
- 2885 Dune

Elmosoft Leather

- L110 Maritime Blue
- L111 Midnight Blue
- L112 Ebony
- L113 Gunmetal
- L114 Mica
- L115 Dove Grey
- L116 Plum Pleasure
- L122 Truffle
- L128 Red Birch
- L132 Violet
- L133 Espresso
- L134 Ruby
- L135 Scarlet
- L136 Claret
- L137 Cabernet
- L138 Bourbon
- L139 Cinder
- L140 Garnet
- L143 Pecan
- L144 Chamois
- L145 Palomino
- L146 Russet
- L147 Saddle
- L148 Goldstone
- L150 Ivory
- L151 White
- L709 Sugar
- L710 Lava
- L711 Parchment
- L712 Buff
- L713 Sand
- L714 Maize
- L715 Camel
- L716 Khaki
- L717 Cameo
- L718 Mushroom
- L719 Taupe
- L720 Fawn
- L721 Rock
- L722 Desert
- L723 Storm
- L724 Mist
- L725 Teal
- L726 Celadon
- L727 Egyptian Blue
- L728 Bright Blue
- L729 Aquarium
- L730 Hunter
- L731 Fern
- L732 Edamame
- L733 Moss
- L734 Key Lime
- L735 Creamsicle
- L736 Lemon
- L737 Sunshine
- L738 Drama
- L739 Byzantium
- L740 Dazzle
- L741 Fuchsia
- L742 Flamingo

3D Knit

- 5064 Licorice
- 5065 Coconut
- 5066 Malt
- 5067 Root Beer
- 5090 Wasabi
- 5091 Maya Blue
- 5092 Graphite
- 5093 Nickel
- 5094 Tangerine
- 5095 Scarlet
- 5096 Turmeric
- 5097 Concord
- 5098 Blue Jay
- 5099 Basil

Upholstery

▶ See page 696 for a complete listing of upholstery colors and numbers.

▶ Check the COM database for specific product and fabric approvals.

Steelcase Wood Seating Surface Materials

This listing includes all the surface material choices that are available for the Steelcase Wood Seating products in this specification guide.

Resources

For more information about surface materials, refer to the following resources:

Additional surface materials specification tools are available to assist you in the specification process—the Surface Materials Binders.

Surface Materials Binders

- include:
- Surface Materials Reference Manual
 - A complete set of swatch cards for hard surfaces, vertical surface fabrics, and seating upholstery

Metal

- 4798 Sterling Metallic
- 7026 Nickel
- 7207 Black
- 8046 Polished Aluminum
- 9201 Polished Chrome

Paint

- 0835 Black
- 4799 Platinum Metallic
- 7207 Black

Wood

▶ See *Color Availability Matrix for Wood Seating in Surface Materials Reference Manual for color availability by product line.*

Tip: The wood used in the construction of chairs is either maple or European beech. Wood finishes applied to maple or beech will match the color of stains applied to oak, walnut, or cherry, but will not have the same natural grain.

- 3062 Graphite Walnut
- 3402 Clear Cherry
- 3412 Natural Cherry **E**
- 3422 Medium Cherry
- 3522 Clear Maple*
- 3572 Amber on Maple
- 3592 Blonde on Maple
- 3602 Desert Oak
- 3612 Warm Oak
- 3692 Espresso Oak
- 3702 Clear Walnut
- 3712 Natural Walnut
- 3722 Dark Mahogany on Walnut
- 3752 Medium Walnut
- 3762 Dark Walnut
- 3772 Medium Mahogany on Walnut

**To ensure an understanding of the color ranges and characteristic variations of natural veneer, a sign-off sheet is required prior to orders being accepted for this clear-coat finish. The sign-off sheet is available through Steelcase advertising stock. Form number 05-0001370.*

Customiz stain is a service that allows you to create your own stain color. Minimum order quantities, per unit up-charges, and a one-time customer processing fee apply.

▶ See the *Surface Materials Reference Manual* for more information.

Upholstery

▶ See page 696 for a complete listing of upholstery colors and numbers.

▶ Check the COM database for specific product and fabric approvals.

E = Established

► For Surface Materials matrices for all Turnstone product lines, see *Surface Materials Reference Manual*.

Paint

Applies to:

- Scoop
- 4799 Platinum Metallic
- 7207 Black

Applies to:

- Jenny tablet arm
- 7207 Black

Plastic

Applies to:

- Jenny tablet arm
- Jenny end table
- Jenny coffee table

6205 Black

Applies to:

- Scoop
- 6618 White
- 6682 Cobblestone

Applies to:

- Jenny end table edge band
- Jenny coffee table edge band

6000 Black
6009 Arctic White
6034 Natural Cherry **E**
6037 Winter on Maple
6053 Seagull
6234 Clear Cherry
6242 Virginia Walnut
6243 Blackwood
6245 Clear Walnut
6246 Warm Oak
6636 Mist
6654 Sand
6676 Marbled Maple
6677 Chocolate Walnut
6678 Marbled Cherry
6689 Brushed Silver

Laminate

Low-Pressure Laminate

Applies to:

- Jenny tablet arm
- Jenny end table
- Jenny coffee table

247L Black Version 2 LPL
25L1 Winter on Maple LPL
25L5 Virginia Walnut LPL
25L6 Blackwood LPL
25L8 Clear Walnut LPL
25L9 Warm Oak LPL
262L Marbled Maple LPL
264L Chocolate Walnut LPL
267L Marbled Cherry Version 2 LPL
26L1 Natural Cherry Version 2 LPL
2L03 Brushed Silver LPL
2L30 Arctic White LPL
2L50 Vanadium Fiber LPL
2L52 Tungsten Fiber LPL
2L83 Seagull LPL
2L85 Dune LPL

High-Pressure Laminate

Applies to:

- Jenny tablet arm
- Jenny end table
- Jenny coffee table

2406 Clear Cherry
2412 Natural Cherry Version 2 HPL
2503 Brushed Silver HPL
2511 Winter on Maple HPL
2535 Virginia Walnut HPL
2536 Blackwood HPL
2538 Clear Walnut HPL
2539 Warm Oak HPL
2612 Marbled Maple HPL
2614 Chocolate Walnut HPL
2615 Marbled Cherry Version 2 HPL
2730 Arctic White HPL
2746 Black HPL
2850 Vanadium Fiber HPL
2852 Tungsten Fiber HPL
2883 Seagull HPL
2885 Dune HPL

Note: Some wood veneer finishes and woodgrain laminates share the same name. Because of the difference in materials, veneers and laminates of the same name are not an exact match but do coordinate with each other.

Wood

Applies to:

- Jenny wood legs
- Jenny wood arm

3412 Natural Cherry **E**
3522 Clear Maple
3762 Dark Walnut

Tip: Due to natural variations in wood, finished products may vary in color, texture and grain.

Turnstone Leather

T802 Black
T803 Port
L305 Brown Leather

Upholstery

► See *Surface Materials Reference Manual* for a complete listing of upholstery colors and numbers.

► Check the COM database for specific product and fabric approvals.

E = Established

Visual Worktools Surface Materials

This listing includes all surface material and/or finish choices applicable to Premium Whiteboards and Tackboards, and Contractor Series. Not all surface material and/or finish choices are available on all products. Please refer to the Finish Matrices.

► For surface materials matrices, see the *Visual Worktools Specification Guide*.

Paint

Price Group 2

- 0835 Black **E**
- 4750 Champagne Metallic
- 4798 Sterling Metallic
- 4799 Platinum Metallic

Metal Paint

Price Group 2

- 8043 Clear Anodized Aluminum
- 8044 Black Anodized Aluminum

Wood

Wood Trim Finishes

The wood finish is an open pore, high gloss finish on maple, cherry, or walnut. Colors match current Steelcase wood finishes in color only and do not match the Steelcase finish in sheen.

- 3412 FC/OP Natural Cherry **E**
- 3422 FC/OP Medium Cherry
- 3572 FC/OP Amber on Maple
- 3592 FC/OP Blonde on Maple
- 3712 FC/OP Natural Walnut on Walnut
- 3772 FC/OP Medium Mahogany on Walnut

Markerboard Surface

Markerboards are standard in white high-gloss 7655 e³ environmental ceramicsteel. Optional screenprint patterns are available to provide a guide for writing or drawing. See below for patterns.

Standard:

- 7655 High Gloss White

Optional Screenprint on e³ environmental ceramicsteel:

- 7656 2" Circular Dot Pattern
- 7657 2" Grid Pattern
- 7658 Music Staff Lines

Vertical Surface Fabric

Fabric Tackboard Surfaces

Tackboard surfaces are available in select Steelcase and Designtex fabrics; pricing for Designtex and Steelcase fabrics is determined by a grading program. All fabrics are applied railroaded, i.e. salvages parallel to floor.

Price Group 1

Abacus **E**

- P122 Entasis
- P123 Portico
- P124 Opus
- P125 Cusp
- P126 Artifact
- P129 Atlas

Bariolage

- G220 Etude
- G221 Andante
- G226 Cantata
- G227 Adagio
- G233 Melody
- G234 Ballata
- G235 Sonata

Designtex Graded-In Program

For additional information and fabric samples, contact your local Designtex sales representative at 1.800.221.1540.

The following fabrics are part of the program formerly known as Designtex Graded-In. These patterns can be ordered through the Select Surfaces order fulfill model.

► See *Surface Materials Reference Manual* for complete Select Surfaces ordering information.

Price Group 2

- Brunswick - 6307
- Solara - 4101

Price Group 3

- Foxtrot - 6375
- Sumo - 6499

Price Group 4

- Rivergrass - 2690

Price Group COM (Customer's Own Material)

Fabric Approval and Yardage

To confirm whether a particular COM material has already been tested for use on a specific Steelcase product or to determine actual yardage requirements:

- Visit www.steelcase.com

For additional information regarding Customer's Own Material, call

1.888.STEELCASE (1.888.783.3522) or send an e-mail to lineone@steelcase.com.

E = Established

Upholstery and Color Numbers

Upholstery

Not all fabrics are available on all products. See the COM database for specific product and fabric availability.

Price Group 1

Buzz2

- 5F01 Camel **E**
- 5F03 Tomato
- 5F04 Red **E**
- 5F05 Burgundy
- 5F06 Sky **E**
- 5F07 Blue
- 5F08 Navy
- 5F10 Grape **E**
- 5F11 Eggplant **E**
- 5F15 Stone
- 5F16 Grey
- 5F17 Black
- 5G50 Dunegrass
- 5G51 Sable
- 5G52 Barley
- 5G53 Sunrise
- 5G54 Carrot
- 5G55 Pumpkin
- 5G56 Timber
- 5G57 Rouge
- 5G58 Chocolate
- 5G59 Meadow
- 5G60 Ivy
- 5G61 Cyan
- 5G62 Atlantic
- 5G63 Crocus
- 5G64 Alpine
- 5G65 Tornado

Jacks

- 5B61 Taupe
- 5B63 Camel
- 5B64 Pewter
- 5B66 Plum
- 5B70 Midnight

Link

- 5A20 Burgundy
- 5A21 Rust
- 5A23 Green
- 5A24 Blue
- 5A25 Navy
- 5A26 Purple
- 5A27 Black
- 5A28 Ocean
- 5A29 Lichen
- 5A30 Chamois

Playground

- 5F28 Claret
- 5F29 Chile
- 5F30 Amber
- 5F31 Nut
- 5F32 Blade
- 5F33 Stone
- 5F34 Sky
- 5F35 Navy
- 5F36 Huckleberry
- 5F37 Charcoal

Seating Vinyl

- 5801 Topaz
- 5805 Foggy Night
- 5809 Black
- 5810 Forest
- 5812 Navy
- 5813 Currant
- 5814 Leaf
- 5815 Seaside
- 5817 Pebble
- 5818 Spice
- 5819 Thistle
- 5820 Coffee
- 5822 Iris

Price Group 2

Cogent: Connect

- 5S15 Coconut
- 5S16 Turmeric
- 5S17 Tangerine
- 5S18 Scarlet
- 5S19 Concord
- 5S20 Maya Blue
- 5S21 Blue Jay
- 5S22 Basil
- 5S23 Wasabi
- 5S24 Nickel
- 5S25 Graphite
- 5S26 Licorice
- 5S27 Malt
- 5S28 Root Beer
- 5S93 Blueprint
- 5S94 Lizard
- 5S95 Sailor
- 5S96 Quicksilver
- 5S97 Nugget
- 5S98 Canary
- 5S99 Lipstick

Cogent: Geode Seating

- 5S46 Bark
- 5S47 Coal
- 5S48 Smoke
- 5S49 Cobalt
- 5S50 Ink
- 5S51 Shamrock
- 5S52 Pear
- 5S53 Berry
- 5S54 Mandarin
- 5S55 Sunset
- 5S56 Citrus
- 5S57 Thunder

Cogent: Geode Vertical

- 5S31 Pebble
- 5S32 Canyon
- 5S33 Honey
- 5S34 Ice
- 5S35 Slate
- 5S36 Cement
- 5S37 Rock
- 5S38 Oyster
- 5S39 Buff
- 5S40 Toast
- 5S41 Sesame
- 5S42 Ecru
- 5S43 Dove

Cogent: Trails

- 5S29 Bronzite
- 5S30 Amethyst
- 5S84 Jasper
- 5S85 Agate
- 5S86 Lapis
- 5S87 Malachite
- 5S88 Quartz
- 5S89 Carnelian
- 5S90 Tiger Eye
- 5S91 Travertine
- 5S92 Topaz

Cricket

- 5A84 Plum
- 5A85 Camel
- 5A86 Charcoal
- 5A87 Black
- 5A90 Currant
- 5A91 Spearmint
- 5A92 Sky
- 5A93 Midnight
- 5A95 Ocean
- 5A96 Forest

Crosswalk

- 5F48 Beech
- 5F49 Moon
- 5F50 Berry
- 5F51 Admiral Blue
- 5F52 Moss
- 5F53 Persimmon
- 5F54 Bittersweet
- 5F55 Midnight
- 5F56 Poppy

Nitelights

- 5F58 Hazelnut
- 5F59 Burgundy
- 5F60 Cherry
- 5F61 Earth
- 5F62 Shore
- 5F63 Moss
- 5F64 Sea
- 5F65 Regal Blue
- 5F66 Stone
- 5F67 Moon

Regis2

- 5F18 Black
- 5F24 Pacific
- 5F26 Cherry
- 5F27 Navy

Spyder

- 5B00 Orchid **E**
- 5B01 Foggy Night **E**
- 5B04 Peri **E**
- 5B05 Merlot **E**
- 5B06 Dove **E**
- 5B07 Sage **E**
- 5B09 Topaz **E**
- 5B11 Currant **E**
- 5B12 Lichen **E**

Zoe2

- 5C90 Eggplant
- 5C91 Aloe
- 5C92 Fiddle
- 5C93 Patina
- 5C94 Peacock
- 5C95 Rain
- 5C96 Grey Flannel
- 5C97 Pebble
- 5C98 Cymbal
- 5C99 Fiesta

Price Group 3

Cogent: Tides

- 5S71 Butter
- 5S72 Snow
- 5S73 Celery
- 5S74 Wicker
- 5S75 Pool
- 5S76 Cloud
- 5S77 Grass
- 5S78 Clay
- 5S79 Hyacinth
- 5S80 Jet
- 5S81 Doe
- 5S82 Boysenberry
- 5S83 Night

Hampstead

- B351 Blue Green V4 **E**
- B359 Blue Blue
Green V5 **E**
- B366 Blue Blue Violet
V4 **E**
- B369 Blue Blue Violet
V5 **E**
- B377 Violet V5
(Low Intensity) **E**
- B389 Red Red
Violet V5 **E**
- B395 Grey V5 **E**
- B399 Black
- B406 Windflower **E**
- B413 Shale **E**
- B423 Clementine
- B424 Butter Cream
- B425 Iris
- B426 Sapphire
- B427 Turquoise
- B428 Navy
- B429 Charcoal
- B430 Spa
- B431 Plum
- B432 Cocoa
- B433 Cork
- B434 Stone
- B435 Metal
- B436 Peridot
- B437 Cactus
- B438 Sycamore
- B439 Candy Apple

Price Group 5

Bo Peep

- 5G66 Pita
- 5G67 Bone
- 5G68 Safari
- 5G69 Brown Sugar
- 5G70 Chocolate Chip
- 5G71 Candlelight
- 5G72 Honey Mustard
- 5G73 Marmalade
- 5G74 Picnic
- 5G75 Pinot
- 5G76 Bloom
- 5G77 Grapevine
- 5G78 Firefly
- 5G79 Artichoke
- 5G80 Serpent
- 5G81 Carolina
- 5G82 Blue Bonnet
- 5G83 Nautical
- 5G84 Gravel
- 5G85 Sharkskin
- 5G86 Kohl

Price Group 6

Brisa

- BR01 Black Onyx
- BR04 Truffle
- BR06 Ash
- BR07 Sage
- BR08 Celery
- BR09 Sterling Blue
- BR10 Night Navy
- BR11 Cambridge Blue
- BR12 Abyss
- BR13 Canyon
- BR14 Pompeian Red
- BR15 Salsa
- BR16 Cinnabar
- BR17 Aztec
- BR18 New Sand
- BR19 Cream
- BR20 White
- BR21 Moccasin
- BR22 Buckskin
- BR23 Prairie

Leather Price Group

- L107 Black
- L202 Dusk
- L203 Bottle
- L207 Mahogany
- L220 Soapstone
- L221 Rocky
- L224 Plum
- L500 Camel
- L503 Navy
- L507 Vineyard

E = Established

**Select Surfaces
Designtex**

For additional information and fabric samples, contact your local Designtex sales representative at 1.800.221.1540.

The following fabrics are part of the program formerly known as Designtex Graded-In. These patterns can be ordered through the Select Surfaces order fulfillment model. These materials are available on Steelcase and Nurture brand products.
▶ See *Surface Materials Reference Manual* for complete Select Surfaces ordering information.

**Price Group 2 -
Finish Code 59DB**

Bee - 4975
Ludington - 3285
Sandpiper - 3313

**Price Group 3 -
Finish Code 59DC**

Boyne - 3280
Crossroads - 2895
Great Lakes - 3282
Lagoon - 4977
Prairie - 2552
Rocket - 2693

**Price Group 4 -
Finish Code 59DD**

Astrid - 2747
At Ease - 3309
Bolzano - 3412
Bunta - 3360
Candor - 3306
Closed Loop - 2550
Easy Going - 3305
Free & Easy - 3316
Glen Arbor - 3283
Gujarat - 3357
Introvert - 2879
Kalanga - 3359
Leland - 3281
Matter of Fact - 3356
Metta - 2681
No Frills - 3318
Nonchalant - 3307
Omar Seating - 2865
Sari - 3361
Sarong - 3358
Saugatuck - 3284
To The Point - 3308
Topiary - 2897
Well Rounded - 3317

**Price Group 5 -
Finish Code 59DE**

Abex - 2072
Appleseed - 2682
Brooch - 2762
Café - 2789
Caillou - 2778
Cascadia - 2733
Crossover - 2683
Fonte - 2796
Halos - 2899
Kabuki - 2794
Metaphor - 2877
Protect - 2852
Salon - 2797
Surface - 2787
Sustain - 2851
Synchronize - 2876
Tailored Stripe - 2763
Terrasse - 2795
V - 2957

**Price Group 6 -
Finish Code 59DF**

Acacia - 2843
Agave - 2847
Alistair - 2992
Allure - 2756
Amaranth w/o Crypton - 2855u
Amuse - 2767
Arlington - 2724
Banda - 3227
Barnsbury - 2726
Bottle Bank - 2869
Cassava - 2838
Chicory - 2993
Circolo - 3229
Converge - 2873
Copa - 2641
Coupe - H245
Dahlia - 2995
Décor - H244
Dot to Dot - 2691
Downtown - 2029
Epiphany - 2734
Faconne - 2764
Friendly Faux w/Knit Backing - 2008
Griglia - 3231
Hula Hoop - 3297
Kenaf - 2859
Kenaf w/o Crypton - 2859u
Klange - 2741
Knockabout - 3326
Laureate - 2774
Palace - H254
Pivot - 3374
Pueblo - 2844
Quintessence - 3347
React - 2861
Rice - 2858
Rough & Ready - 2016
Salvage - 2867
Seed - 2839
Senna - 2848
Sequence - 2742
Sock Hop - 3298
Soda Pop - 2868
Square - 2788
Swing Set - 2421
Tangent - 2875
Tartan - 2994
Teddy - H236
Terrain - 2846
Transpose - 2874
Tumbleweed - 2845

**Price Group 7 -
Finish Code 59DG**

Amaranth - 2855
Baratto - 3266
Battista - 2718
Beam - 2785
Bon Bon - 2749
Calm - 2768
Cestino - 3270
Chakin - 7146
Coperta - 3228
Drive-In - 3299
Dwell - 2850
Faux Sure w/Knit Backing - 3351
Flux - 3239
Fuse w/Knit Backing - 3362
Garden Key - 3252
Inertia - 3235
Juxtaposition - 2744
Kaleidoscope - 2863
Lorien - H201
Minuet - 2656
Oscillate - 3238
Point - 2783
Razor Stripe - 2857
Samba - 2654
Samba Otra Vez - 2885
Spiro - 3237
Sundance - 3278
Uptown - 2024
Yoruba - 3333
Ziggurat - 2827

**Price Group 8 -
Finish Code 59DH**

Biba - H216
Chandelier - 7354
Circumference - 2884
Facets - 7350
Honor Plus - 2547
Hue - 2710
Maglia - 3233
Nexus - 3236
Polygon - 2883
Thumbnail Sketch - 2841
Titanium - 2842
Torsade - 7358
Valanka - 3279
Wire - 2743

**Price Group 9 -
Finish Code 59DJ**

Bangles - 7352
Belvedere - 3275
Gotham - 2390
Gramercy - 2599
Hofburg - 3276
Yorkshire - 2771

**Price Group 10 -
Finish Code 59DK**

Chalet - 3290
Kanthas - H238
Links - 7353
Lolland - 3263
Metamorphosis w/Knit Backing - 3367
Migration w/Knit Backing - 3373
Shimmering Tide w/Knit Backing - 3369
Tumble Stones w/Knit Backing - 3371
Wood Work w/Knit Backing - 3372

**Price Group
COM/COL
(Customer's Own
Material/Leather)**

**Fabric Approval and
Yardage**

To confirm whether a particular COM material has already been tested for use on a specific Steelcase or Nurture product or to determine actual yardage requirements:
• Visit www.steelcase.com

For additional information regarding Customer's Own Material, call 1.888.STEELCASE (1.888.783.3522) or send an e-mail to lineone@steelcase.com.

For Nurture products, call 1.800.342.8562.

Nurture Graded-In Programs

Nurture Graded-In Program: Acrylic Panel

A collection of acrylic panels are available as part of a Graded-In Program. The collection is from the Designtex Fusion offering.

These acrylic panels are Graded-In for the Sonata product only. The collection on these pages is not Graded-In for other Steel-case brands or product lines.

To order these acrylic panels, enter the finish code which corresponds with the acrylic panel price group.

Price Group	Finish Code
1	65DA
2	65DB
3	65DC
4	65DD

Then enter the acrylic panel information in the Special Acrylic Panel Information pop up window. If prompted, enter the finish code DSGNTX0002 based on the acrylic panel supplier.

Designtex

Fusion Offering

Price Group 1

Blueberry
Bluestone
Bubblegum
Canary
Candy Apple
Etch
Grape
Key Lime
Lemon
Periwinkle
Plum
Red
Sea
Searchlight
Slate
Tangerine
White
White Dot
White Rain
White Ribbon

Price Group 2

Berry Grid
Bone Linen
Cloud Grid
Espresso Sketch
Flame Sketch
Flannel Linen
Granny Smith Grid
Grapefruit Grid
Halo
Honey Sketch
Ice Sketch
Noir Linen
Orange Grid
Pistachio Sketch
Reef Linen
Scarlet Sketch
Sky Grid
Tiki Stalk
Windowbox

Price Group 3

Kenya Rush
Ogee
Prairie Stalk
Savannah Rush
Straws

Price Group 4

Coil
Convection
Desert Stalk 50% More
Drink Tray
Fingerprints
Grassland
Green Sheer Leaf
Illumination
Large Sheer Leaf
Maroon Sheer Leaf
Plain
Rock Candy
Sapphire Rock Candy
Small Sheer Leaf
Toffee Sheer Leaf
Underwood

Nurture Graded-In Program: Solid Surface

A collection of solid surfaces are available as part of a Graded-In Program. The collection is from the Corian solid surface offering.

These solid surfaces are Graded-In for the Folio, Sonata, Sync, Senza, Tava, and Leela products only. The collection on these pages is not Graded-In for other Steelcase brands or product lines.

To order these solid surfaces, enter the finish code which corresponds with the solid surface price group.

Price Group	Finish Code
A	29DA
B	29DB
C	29DC
D	29DD
E	29DE

Then enter the solid surface information in the Special Solid Surface Information pop up window. If prompted, enter the finish code CORIAN0001 based on the solid surface supplier.

Corian

Solid Surface Offering

Price Group A

Glacier White

Price Group B

Abalone
Aurora
Cameo White
Canyon
Cobalt
Flint
Maui
Mojave
Moss
Platinum
Sahara
Sand
Sandstone
Savannah
Silt
Tarragon
Vanilla

Price Group C

Acorn
Adobe
Bethany
Blue Crush
Blue Pebble
Canyon Trail
Cocoa Brown
Cottage Lane
Doeskin
Fossil
Granola
Gray Fieldstone
Gray Pebble
Mardi Gras
Matterhorn
Medea
Mosaic
Night Sky
Oat
Pine
Riviera
Sage Graystone
Shale
Silver Birch
Stone Harbor
Suede
Willow

Price Group D

Anthracite
Azurite
Bronze Patina
Bronzite
Concrete
Copperite
Designer White
Dove
Fawn
Graphic Blue
Green Tea
Hot
Lilac
Mandarin
Nocturne
Olivite
Pompeii Red
Raffia
Rice Paper
Serene Sage
Silverite
Sun
Tranquil
Venaro White
Whisper
White Jasmine

Price Group E

Aqualite
Arctic Blueberry
Arctic Ice
Arctic Lime
Arctic Mint
Arctic Strawberry
Aztec Gold
Blueberry Ice
Burled Beach
Chamois
Cinnabar
Cirrus White
Clam Shell
Earth
Ecu
Elderberry
Glacier Ice
Graylite
Jasmine
Juniper
Lava Rock
Lime Ice
Mint Ice
Natural Gray
Rain Cloud
Rosemary
Saffron
Sagebrush
Sandalwood
Slate
Sonora
Sorrel
Strawberry Ice
Thyme
Tumbleweed
Verde
Witch Hazel

Nurture Graded-In Program: Upholstery

A collection of textiles are available as part of a Graded-In Program. The collection from the leading suppliers in the market consists of high-performance textiles that meet the demands of healthcare environments. Note that not all fabrics can be applied to all seating products. Refer to the Steelcase COM database for the most current application information.

To order these fabrics, enter the finish code which corresponds with the fabric price group.

Price Group	Finish Code
2	59DB
3	59DC
4	59DD
5	59DE
6	59DF
7	59DG
8	59DH
9	59DJ
10	59DK

Then enter the fabric information in the Special Fabric Information pop up window. Enter the appropriate finish code from the list below, based on the fabric supplier.

Supplier	Finish Code
Architex	ARCHTX0001
ArcCom	ARCCOM0001
CF Stinson	CFSTIN0001
DesignTex	DSGNTX0001
Maharam	MAHARA0001
Momentum	MOMENT0001
Ultrafabrics	ULTRAF0001

Fabric application direction must be specified.

► See page 702 for *Fabric Application Direction Guidelines* to ensure fabric is specified in the correct direction.

Architex

Price Group 5

- Daytona
- Linen

Price Group 6

- Ellipse
- Joy
- Matrix
- Radius

Price Group 7

- Animal
- Authentec
- Daybreak
- Hyde
- Patent
- Sprig
- Tegan
- Tibet
- Vanish
- Voila

Price Group 8

- Bonnie
- Delight
- Easton
- Fish Out Of Water
- Kenga
- Mabel
- Pick Up Sticks
- Ruth
- Sarah
- Spellbound
- Thrive
- Your Bird Can Sing

Price Group 9

- Bamboo Mate
- Brook
- Burst
- Follow Me
- Morin
- Nili
- Ripples

Price Group 10

- Pelle

Arc-Com

Arc-Com graded-in fabrics can only be used on Nurture brand products.

Price Group 4

- Duchess
- Illusion
- Lancaster

Price Group 5

- Alamo
- Cassio
- Durango
- Frontier
- Gatsby
- Pebble Beach
- Shimmer
- Silver Birch
- Tegan
- Strata
- Terra

Price Group 6

- Allegra
- Bravo
- Checkmate
- Chit-Chat
- Etch
- Fireflies
- Gem
- Grand Central
- Grassland
- Hopscotch
- Jing
- Leonardo
- Lotus
- Matrix
- Palatine
- Panache
- Pinpoint
- Sierra
- Silverado
- South Street
- Suede Sensation
- Sylvan
- Tribeca
- Vibrato
- Willow

Price Group 7

- Abacus
- Aline
- Aruba
- Ashanti
- Bauble
- Beat Box
- Bourbon Street
- Broadway
- Bronco
- Cadence
- Carnival
- Dorset
- Eclipse
- Élan
- Grammercy Park
- Hemisphere
- Hydro
- Iguana
- Intaglio
- Iron Gate
- Link
- Mirage
- Moon Beam
- Mystique
- Notting Hill
- Pinball
- Pong
- Quadrant
- Rhythm
- Savannah
- Stonehenge
- Sublime
- Symphony
- Trio
- Vibe
- Whirlwind
- Wonderland

Price Group 8

- Bounce
- Bubbly
- Circuit
- Diamond Derby
- Esprit
- Flora
- Forsythia
- Gamble
- Heirloom
- Jardin
- Kalahari
- Kendo
- Kensington
- Lily Pond
- Masquerade
- Nikko
- Oasis
- Piazza
- Posh
- Radiant
- Riviera
- Royal Garden
- Salsa
- Seagrass
- Sherwood
- Spotlight
- Spring
- Strand-It
- Tango
- Tatami
- Tuscany
- Victoria
- Volley
- Yoyo

Price Group 9

- Francesca Wool
- Francesca Wool II
- Groovy
- Juliet
- Sagrada
- Uptown
- Wind Chime

Price Group 10

- Fantasia
- Far Out

CF Stinson

Price Group 3

Laredo
Rally

Price Group 4

Avant
Bistro
Checkmate
Cumulus
Moccasin
Naugasoft
Oxford
Rialto
Shantung
Simplicity
Symphony Classic
Whisper
Ziggy

Price Group 5

Chroma
Cirque
Dash
Geomet
Liquid
Matrix
Napa
Raffia
Southampton
Tendrill
Tessuto
Whitney

Price Group 6

Persuasion
In The Round w/Stakleen
Script
Snuggle
Sundance w/Stakleen

Price Group 7

Adirondack
Aspen
Banyan
Bali
Bari
Beeline
Block Party
Bower
Capreni
Carat
Catwalk
Couplet
Cozy
Crush
Dodgeball
Eli
Equinox
Folio
Hands On
Martini
Match Point
Mingle
Olympus
Over Under (By Patty Madden)
Petals
Pinstripe
Raquette
Rivera
Silverado W/Agion
Spandrel
Sterling W/Agion
Straight And Narrow
Tweed
Twist
Vibe
Wink W/Agion
Ybor

Price Group 8

Balance Beam
Cinnamon Blossom
Colden
Courtyard
Eclipse
Flutter
Geodesic
Hoopla
Labyrinth
Lucky Charm
Panache
Skyline
Sumatran Palm
Sunburst
Vintage
Wired

Price Group 9

Chi w/Agion
Daddy-O w/Agion
Good Fortune w/Agion
Haiku w/Agion
Jam Session w/Agion
Jump w/Agion
Now & Zen w/Agion
Tatami w/Agion
True Path w/Agion
Tuscan Lattice
Umbrian Stripe
Up Tempo w/Agion
Zen Garden w/Agion

Price Group 10

Double Time w/Agion
Glisten
In The Groove w/Agion
Mesa
Tuscan Garden
Tuscan Hills
Umbrian Landscape
Umbrian Rain
Umbrian Village
Verve w/Agion
Volterra-Hc

Designtex

Price Group 4

Bolzano
Kalanga
Metta
Parga
Rondine
Sorano
Spandau
Tarascon

Price Group 5

Alcazar
Annex
Avenza
Breena
Figure Eight
Florin
Inside Edge
Leafette
Lino
Pianta
Prism
Rumeli
Skylark

Price Group 6

Acacia
Agave
Alistair
Amuse
Anello
Arlington
Banda
Barnsbury
Bounce
Cassava
Chicory
Circolo
Copa
Dahlia
Dot To Dot
Downtown
Drawing Straws
Friendly Faux
Griglia
Gujarat
Hula Hoop
Kenaf
Lindos
Pueblo
Quintessence
Rice
Seed
Senna
Swing Set
Tartan
Terrain
Tumbleweed
Vinca

Price Group 7

Alemany
Alkai
Amaranth
Basket Weaver
Bon Bon
Bossa Nova
Calm
Clovis
Coperta
Details
Dodge Ball
Dodge Ball Too
Faux Sure
Flux
Four Square
Inertia
Jungle Gym
Line Item
Mena
Minuet
Oscillate
Pasa Doble
Pattino
Prana
Samba
Samba Otra Vez
See Saw
Spiro
Sprocket
Tinos
Tupi
Uptown
Widget

Price Group 8

Boreas
Honor Plus
Maglia
Nexus
Southside

Price Group 10

Journey

Maharam

Maharam graded-in fabrics can only be used on Nurture brand products.

Price Group 5

Article
Ledger

Price Group 6

Candid
Chime
Flicker
Lariat
Petal
Quick
Reverie

Price Group 7

Align
Alloy
Assemblage
Beside
Bop
Chance
Corner
Crush
Current
Double Check
Kernel
Scuba
Trait
Wafer

Price Group 8

Akimbo
Box
Comment
Dart
Decode
Floret
Intertwine
Scout
Venn
Verse

Price Group 10

Chenille Cord

Momentum

Momentum graded-in fabrics can only be used on Nurture brand products.

Price Group 3

Cashmere

Price Group 4

Array
Crete
Fleck
Sublime
Tatami

Price Group 5

Bravo
Crypton Suede
Echo
Evoke
Foray
Jolt
Max
Smart Suede
Tact

Price Group 6

Brea
Clue
Crux
Icon
Kinetic
Lumiere
Paragon
Query
Radiate
Rio
Topanga
Tweed
Viva
Zoom

Price Group 7

Amenity
Bandwidth
Delmonico
Feliz
Frolic
Huntington
Hyphen
Jax
Jest
Locale
Maxim
Narration
Premise
Schmooze
Sway
Telegram

Price Group 8

Ardour
Calabasas
Catalogue
Charade
Inhabit
Pomona
Recollection
Soma

Price Group 9

Effloresce
Emanate

Ultrafabrics

Price Group 6

Ultraleather

Price Group 7

Promessa

Fabric Application Direction Guidelines

What is the issue?

Some textiles are simple and look the same regardless of how you apply them to a product. Other fabrics are patterned, textured, or have luster that will have a distinctly different appearance applied in a different direction on a chair. Because of these differences, and the fact that there are limits to how some fabrics can be applied to Nurture products, it is important to understand fabric application direction when ordering a product to avoid being disappointed.

Talking about direction

Fabrics come on rolls. The long yarns that run down the length of the roll are called the “warp” yarns. These yarns are used to define the direction you are viewing the fabric as it is applied to a chair. Fabric directionality is determined by how the fabric comes off the roll.

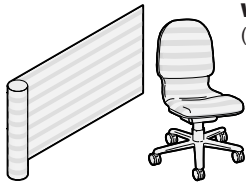

Warp Horizontal
(Railroaded)

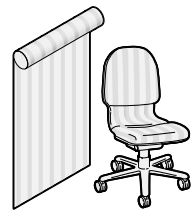

Warp Vertical
(Woven Way)

It is NOT determined by the way the pattern looks on the product. For example, the image below shows the fabric applied warped horizontal although the stripes appear vertical.

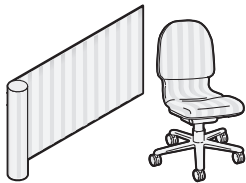

Terminology

Steelcase uses the terms warped horizontal and warped vertical. There are other terms within the industry that are used that have the same meaning:

- Warped horizontal is also referred to as:
 - railroaded or across roll
- Warped vertical is also referred to as:
 - woven way, down roll, or top out

Why is it important?

Dealers must specify fabric application direction when ordering COMs and Nurture Graded-In fabrics. We require the dealer to specify the direction because we do not know which way customers want to see a pattern on the furniture. Therefore, it is critical to know how the pattern is run on the roll to ensure that Nurture builds and ships each order to the customer’s expectation each and every time.



Incorrect?



Correct?



Incorrect?



Correct?



Incorrect?



Correct?



Incorrect?



Correct?

How do I know which way the fabric comes off the roll?

Most textile companies will swatch their fabrics in a warp vertical (woven way, down roll) direction. Some exceptions might be made to address patterns especially with stripes. Typically, when a fabric is swatched in a warp horizontal (railroad or across roll) direction, the direction is noted on the swatch card or fabric sample. If in doubt of a fabric direction, we encourage you to contact the textile vendor for clarification.

Vinyl

Vinyl generally only passes on Nurture product in a horizontal or across roll direction. This is due to physical properties of the material. If a vinyl is applied in the opposite direction, too much stretch in the material can compromise the overall aesthetics of the final upholstery. If a patterned vinyl is being specified and the vinyl must be run in a vertical direction, pre-approval must be arranged through Nurture. Nurture will consider the request and a decision will be made based on the specific vinyl and product combination. Contact Nurture’s Customer Care line.

Required Action Steps before Specifying

1. Verify by using Steelcase’s COM website that the fabric is approved on the product.
2. Verify the direction that the fabric can be applied. Occasionally a fabric is only approved in one direction.
3. Confirm with the customer how they want the fabric to look on the furniture.
4. Confirm using the swatch card or vendor’s website the direction the sample is shown.
5. Now you’re ready to place the order.