

FEATURES

- 25 Watt Flourescent Lights
- 3 Glass Shelves
- Wall-Mount Installation
- Mirrored on inside and behind shelves

CODES/STANDARDS APPLICABLE

Specified Model Meets or Exceeds the Following:

- UL Listed

P74116

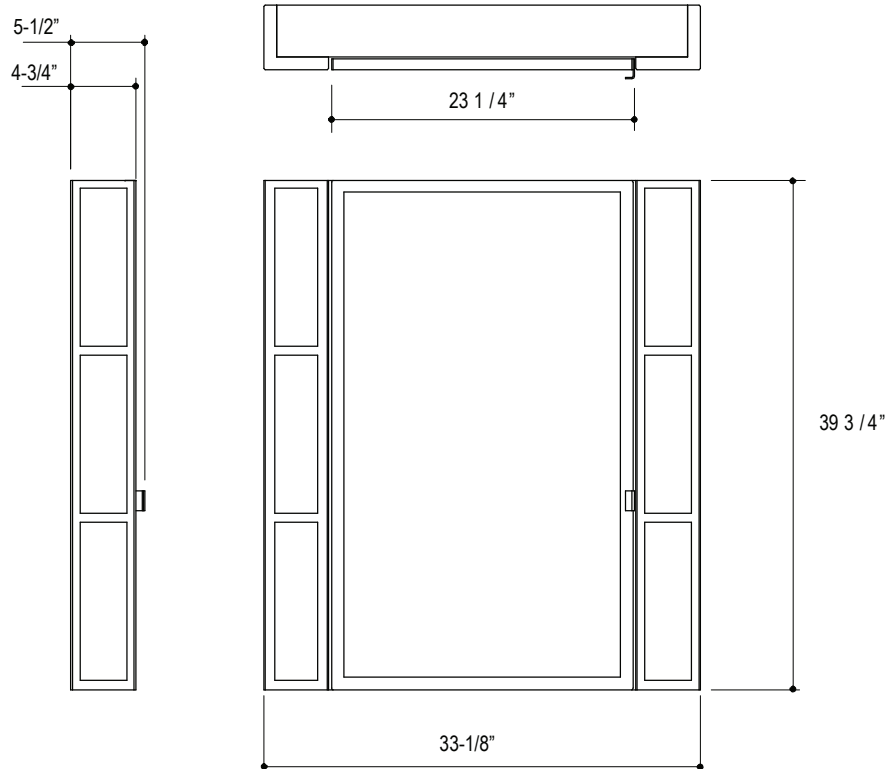

| SPECIFIED MODEL | | | |
|-----------------|-----------------------|---|--|
| Model | Description | Finishes | |
| P74116-00 | Loft Medicine Cabinet | <input type="checkbox"/> AD Nickel Silver | <input type="checkbox"/> AG Brushed Nickel |

We reserve the right to make revisions without notice in the design of products or in packaging unless this right has specifically been waived at the time the order is accepted.