

Acousti-Mat® II with Radiant Floor Heating Wall Isolation Detail

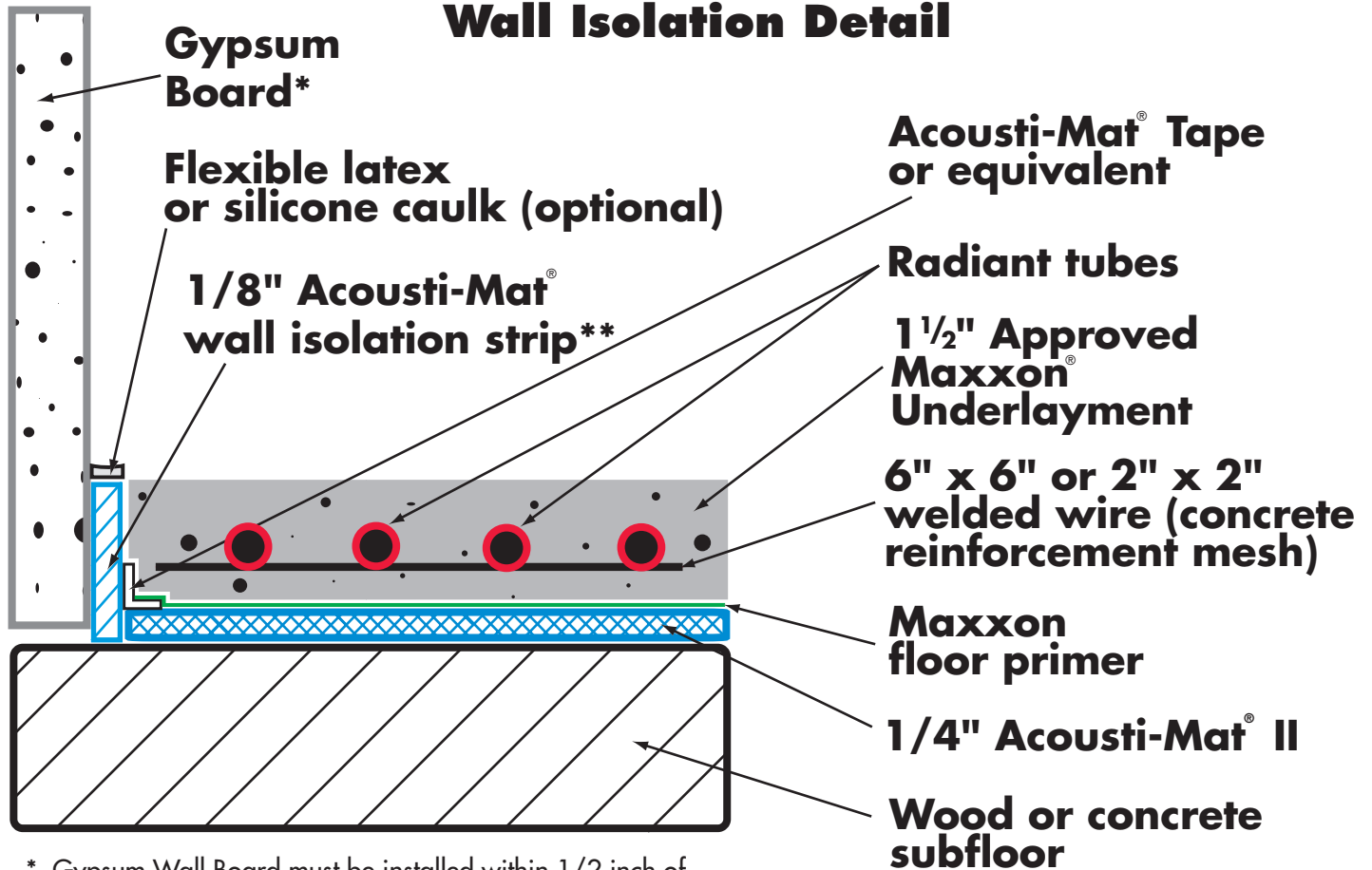

* Gypsum Wall Board must be installed within 1/2 inch of subfloor.

** Acousti-Mat® Wall Isolation is installed around the perimeter of the entire room to receive Acousti-Mat II, and around any floor penetrations such as toilet collars, electrical, plumbing, etc.