

DESCRIPTION

Low brightness 4-1/2" aperture open wall wash downlight for use with 18W or 26W compact fluorescent lamps for below ceiling installation. The Geometric reflector maximizes flux toward the wall and is spectrally neutral leaving the color temperature and color rendering unchanged. Available in single, double and corner wall wash versions. The one piece design eliminates light leaks at the ceiling. Standard features include low iridescent finish on all reflectors and venting to ensure maximum lamp life and lumen output. Optics offer unparalleled performance with uniform illuminance on wall, no flashback, and glare-free downlighting. Open downlight, lens, and open wall wash trims are interchangeable within the same housing.

SPECIFICATION FEATURES

Reflector

Injection molded Geometric Reflector for Uniform Vertical Illumination is vacuum metallized with polysiloxane hardcoat finish. One piece spun macrofocal parabolic downlight reflector, .050 thick aluminum, available in a variety of Alzak® finishes. Positive reflector mounting pulls trim tight to ceiling.

Trim Ring Options

Self flanged or white trim ring. Rimless or metal trim ring available.

Socket Connector

One piece vented and finned die cast aluminum cap for maximum thermal performance.

Housing Construction

Galvanized steel plaster ring accommodates up to 1" ceiling thickness.

Conduit Fittings

Die cast screw tight connectors.

Socket

4-pin 18W GX24q2 or 26W GX24q3 base with fatigue free stainless steel lamp spring ensures positive

lamp retention.

Electronic Ballast

Electronic ballast provides full light output and rated lamp life. Provides flicker free and noise free operation and starting. End of lamp life protection is standard.

Labels

cULus listed, standard damp label, IBEW union made.



C4RV or C4IV

4010/4011

18W or 26W TTT
Compact Fluorescent

4-Inch
Remodel/International
Vertical Open Wall Wash

Energy Data

Sound Rating: Class A standards	
18W Triple 4-pin	
Ballast: Electronic	
Min. Starting Temperature: -10°C (15°F)	
120V Input Watts: 29	Line Amps: 0.25
277V Input Watts: 26	Line Amps: 0.09
Power Factor: >0.99 THD: <90%	
26W Triple 4-pin	
Ballast: Electronic	
Min. Starting Temperature: -10°C (15°F)	
120V Input Watts: 29	Line Amps: 0.25
277V Input Watts: 26	Line Amps: 0.09
Power Factor: >0.99 THD: <90%	

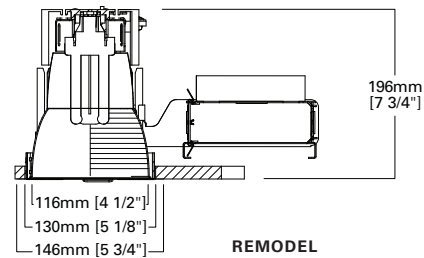

REMODEL

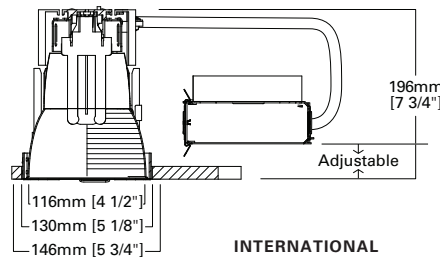

INTERNATIONAL

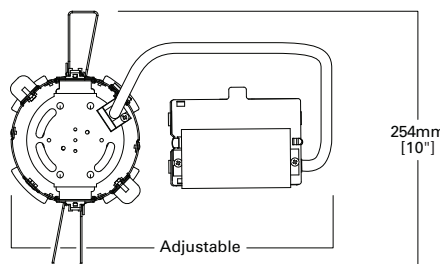
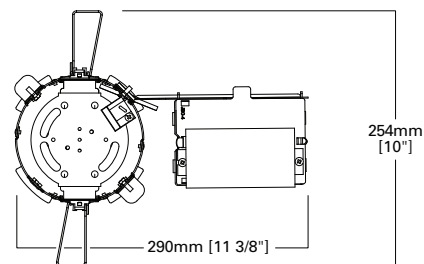

Example:

C4RV018ECP 4011LI WF = 4" CFL Vertical Remodel Single Wall Wash, 18 Watt Triple Tube 120/277 Volt, Chicago Plenum, Self Flanged with Specular Clear Finish

Housing	Wattage	Ballast	Options	Reflector	Finish	Option	Accessories
C4RV0 = 4" CFL Vertical Remodel C4IV0 = 4" CFL Vertical International	18 = 18W TTT 26 = 26W TTT	E = 120/277V 50/60 Hz Electronic 3E = 347V 50/60 Hz Electronic D = 120-277V Dimming, Lutron EcoSystem	CP = Chicago Plenum EM = Emergency Module with Remote Test Switch	4011 = Single Wall Wash, Self Flanged 4010 = Single Wall Wash, Polymer Trim Ring 4021 = Double Wall Wash, Self Flanged 4020 = Double Wall Wash, Polymer Trim Ring 4031 = Corner Wall Wash, Self Flanged 4030 = Corner Wall Wash, Polymer Trim Ring	LI = Specular Clear H = Semi-Specular Clear WMH = Warm Haze G = Specular Gold WH = Wheat WHH = Wheat Haze GP = Graphite GPH = Graphite Haze CC = Chocolate CCH = Chocolate Haze K = Cognac KH = Cognac Haze B = Specular Black W = Gloss White	WF = White painted flange (self flanged only)	TRM4 = Metal Trim Ring, Specify Finish¹ TRR4 = Rimless Trim Ring¹ FK5 = 5 Amp Field Installable Fuse Kit 300V Max

Notes: 1 Order trim with polymer trim ring (Consult specification sheet for ordering information and options).

PHOTOMETRICS

Candlepower Distribution Curve

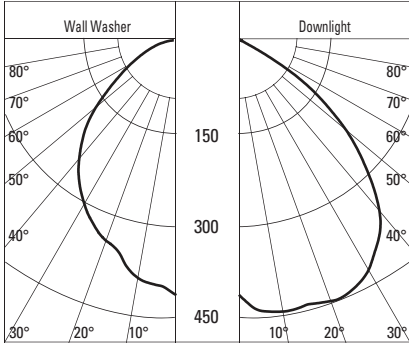

C4RV 4010LI
Test No. H21332
Efficiency = 49.0%
Lamp = 26W TTT

Single Unit Footcandles

Multiple Unit Footcandles

DD	2'6" from wall <i>(distance from fixture along wall)</i>							2' from wall <i>(spacing between fixtures)</i>					2'6" from wall <i>(spacing between fixtures)</i>						
	1'	2'	3'	4'	5'	6'		2'	3'				3'	4'					
1	7	5	3	1	0	0	0	20	19	20	15	11	15	6	6	6	5	4	5
2	12	9	5	2	1	0	0	31	29	31	22	18	22	11	10	11	9	7	9
3	10	8	5	3	2	1	0	26	26	26	19	18	19	14	13	14	11	9	11
4	7	6	5	3	2	1	1	19	19	19	14	14	14	13	12	13	10	10	10
5	4	4	4	3	2	1	1	13	13	13	10	10	10	11	11	11	8	8	8
6	3	3	3	2	2	1	1	9	9	9	7	8	7	8	8	8	7	7	7
7	2	2	2	2	1	1	1	6	6	6	5	6	5	6	7	6	5	6	5
8	1	1	1	1	1	1	1	5	5	5	4	4	4	5	5	5	4	5	4
9	1	1	1	1	1	1	1	3	3	3	3	3	3	4	4	4	3	4	3
10	1	1	1	1	1	1	1	3	3	3	2	2	2	3	3	3	3	3	3

Notes:

- Illuminance values for multiple fixtures are based upon the center two units of a four unit array. Footcandle values are centerline of fixtures and centered between fixtures.
- Illuminance values are cosine corrected initial values with no contribution from inter reflections from other room surfaces. Total illumination may increase from contributions from other surfaces.
- Changing fixture spacing will affect illuminance level.

$$\text{New Fc} = \frac{\text{Existing Spacing}}{\text{New Spacing}} \times \text{Average Table Fc Level}$$

- When selecting colored cones option, only downlight cone is colored; the wall wash reflector is specular clear. This allows the color (CRI, °K) of the light source to be unaffected and maximizes lumen output.

