

DESCRIPTION

Low brightness 4-1/2" aperture open wall wash reflector for use with 18W and 26W compact fluorescent lamps for below ceiling installation. Available in single, double and corner wall wash versions. Standard features include low iridescent finish on all reflectors and venting to ensure maximum lamp life and lumen output. Optics offer unparalleled performance with uniform illuminance on wall, no flashback, and glare-free downlighting. Open downlight, lens, and open wall wash trims are interchangeable within the same housing.

Catalog #		Type
Project		
Comments		Date
Prepared by		

SPECIFICATION FEATURES

Reflector

Full spinning Gradient Kicker provides high levels of vertical illumination, protects reflector integrity and achieves superior sealed design. Airflow travels through downlight cone neck for optimum lamp cooling. One piece spun Quiet Cone downlight reflector of .050 thick aluminum, available in a variety of Alzak® finishes. Positive reflector mounting pulls self-flanged trim tight to ceiling.

Trim Ring Options

Self flanged reflector is standard. Painted white flange (WF) option is available.

Socket Connector

One piece vented and finned die cast aluminum cap for maximum thermal performance.

Housing Construction

Galvanized steel plaster ring accommodates up to 1" ceiling thickness.

Conduit Fittings

Die cast screw tight connectors.

Socket

26W lamps: 4-pin G24q3.
18W lamps: 4-pin G24q2 base. with fatigue free stainless steel lamp spring ensures positive lamp retention.

Electronic Ballast

Electronic ballast provides full light output and rated lamp life. Provides flicker free and noise free operation and starting. End of lamp life protection is standard.

Labels

cULus listed, standard damp label, IBEW union made.



C4RV or C4IV

40110/40111

18W or 26W TTT

Compact Fluorescent

4-Inch
Remodel/International
Vertical Open Wall Wash

Energy Data

Sound Rating: Class A standards	
18W Triple 4-pin	
Ballast: Electronic	
Min. Starting Temperature: -10°C (15°F)	
120V Input Watts: 29	Line Amps: 0.25
277V Input Watts: 26	Line Amps: 0.09
Power Factor: >0.99	THD: <90%
26W Triple 4-pin	
Ballast: Electronic	
Min. Starting Temperature: -10°C (15°F)	
120V Input Watts: 29	Line Amps: 0.25
277V Input Watts: 26	Line Amps: 0.09
Power Factor: >0.99	THD: <90%

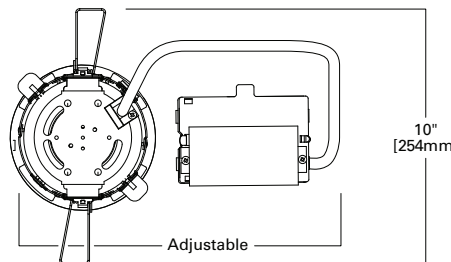
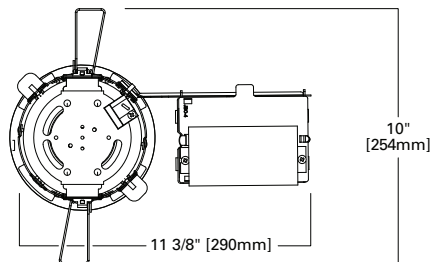
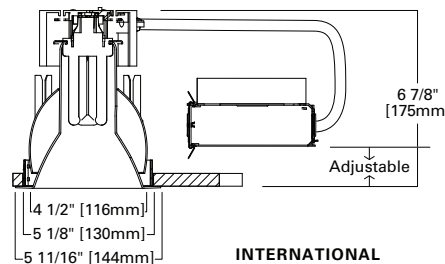
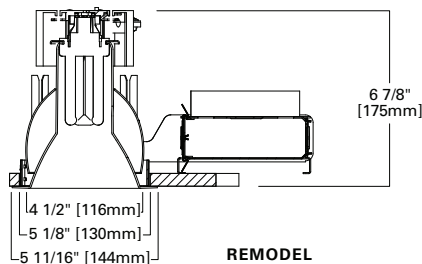

Example:

C4RV018ECP 40111LI WF = 4" CFL Vertical Remodel Single Wall Wash with Gradient Kicker, 18 Watt Triple Tube 120/277 Volt, Chicago Plenum, Self Flanged with Specular Clear Finish

Housing	Wattage	Ballast	Options	Reflector	Finish	Option	Accessories
C4RV0 = 4" CFL Vertical Remodel C4IV0 = 4" CFL Vertical International	18 = 18W TTT 26 = 26W TTT	E = 120/277V 50/60 Hz Electronic 3E = 347V 50/60 Hz Electronic D = 120-277V Dimming, Lutron EcoSystem	CP = Chicago Plenum EM = Emergency Module with Remote Test Switch	40111 = Single Wall Wash, Self Flanged 40110 = Single Wall Wash, Polymer Trim Ring 40121 = Double Wall Wash, Self Flanged 40120 = Double Wall Wash, Polymer Trim Ring 40131 = Corner Wall Wash, Self Flanged 40130 = Corner Wall Wash, Polymer Trim Ring	LI = Specular Clear H = Semi-Specular Clear WMH = Warm Haze G = Specular Gold W = Wheat WHH = Wheat Haze GP = Graphite GPH = Graphite Haze CC = Chocolate CCH = Chocolate Haze K = Cognac KH = Cognac Haze B = Specular Black W = Gloss White	WF = White painted flange (self flanged only)	TRM4 = Metal Trim Ring, Specify Finish ¹ TRR4 = Rimless Trim Ring ¹ FK5 = 5 Amp Field Installable Fuse Kit 300V Max

Notes: 1 Order trim with polymer trim ring (Consult specification sheet for ordering information and options).

PHOTOMETRICS

Candlepower Distribution Curve

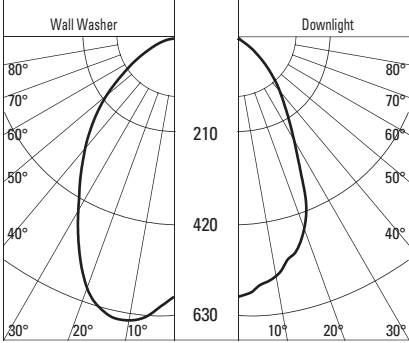

CRV4026 40111LI

Test No. H21331
Efficiency = 42.3%
Lamp = 26W TTT

Single Unit Footcandles

Multiple Unit Footcandles

DD	2'6" from wall <i>(distance from fixture along wall)</i>							2' from wall <i>(spacing between fixtures)</i>						2'6" from wall <i>(spacing between fixtures)</i>					
	■	1'	2'	3'	4'	5'	6'	■	2'	■	3'	■	■	3'	■	4'	■		
1	6	5	2	1	0	0	0	19	18	19	14	11	14	7	7	7	5	5	5
2	13	10	5	2	1	0	0	35	33	35	24	21	24	16	16	16	12	11	12
3	13	10	6	3	1	1	0	30	30	30	21	20	21	21	21	21	15	14	15
4	9	8	5	3	2	1	0	23	23	23	16	16	16	19	20	19	15	14	15
5	7	6	4	3	2	1	1	17	17	17	12	12	12	16	16	16	13	12	13
6	5	4	3	2	2	1	1	12	12	12	9	9	9	13	13	13	10	10	10
7	3	3	3	2	1	1	1	9	9	9	7	7	7	10	10	10	8	8	8
8	3	2	2	2	1	1	1	7	7	7	5	6	5	8	8	8	7	7	7
9	2	2	2	1	1	1	1	5	5	5	4	4	4	6	7	6	5	6	5
10	1	1	1	1	1	1	0	4	4	4	3	3	3	5	5	5	4	5	4

Notes:

- Illuminance values for multiple fixtures are based upon the center two units of a four unit array. Footcandle values are centerline of fixtures and centered between fixtures.
- Illuminance values are cosine corrected initial values with no contribution from inter reflections from other room surfaces. Total illumination may increase from contributions from other surfaces.
- Changing fixture spacing will affect illuminance level.

$$\text{New Fc} = \frac{\text{Existing Spacing}}{\text{New Spacing}} \times \text{Average Table Fc Level}$$

- When selecting colored cones option, only downlight cone is colored; the wall wash reflector is specular clear. This allows the color (CRI, °K) of the light source to be unaffected and maximizes lumen output.

