

DESCRIPTION

Low brightness 4-1/2" aperture reflector for use with 18W and 26W compact fluorescent lamps for below ceiling installation. The precisely formed non-imaging reflector ensures 55° cutoff to lamp and lamp image and the one piece design eliminates light leaks at the ceiling. Standard features include low iridescent finish on all reflector colors to eliminate "rainbowing" and venting to ensure maximum lamp life and lumen output. The fixture optics offer unparalleled performance in glare free lighting providing a smooth beam devoid of hot spots. Open downlight, lens, and open wall wash trims are interchangeable within the same housing.

Catalog #		Type
Project		
Comments		Date
Prepared by		

SPECIFICATION FEATURES

Reflector

.050 thick aluminum in a one piece spun macrofocal parabolic contour. Available in a variety of Alzak® finishes. Positive reflector mounting pulls trim tight to ceiling.

Trim Ring Options

Self flanged or molded white trim ring. Rimless or metal trim ring accessories available.

Socket Connector

One piece vented and finned die cast aluminum cap for maximum thermal performance.

Housing Construction

Galvanized steel plaster ring accommodates up to 1" ceiling thickness.

Conduit Fittings

Die cast screw tight connectors.

Socket

4-pin 18W GX24q2 or 26W GX24q3 base with fatigue free stainless steel lamp spring ensures positive lamp retention.

Electronic Ballast

Electronic ballast provides full light output and rated lamp life. Provides flicker free and noise free operation and starting. End of lamp life protection is standard.

Labels

cULus listed, standard damp label, IBEW union made.



C4RV or C4IV

4050/4051

18W or 26W TTT
Compact Fluorescent

4-Inch
Remodel/International
Vertical Open Downlight

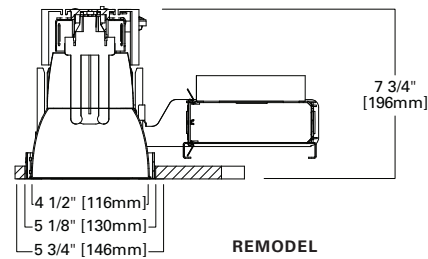

REMODEL

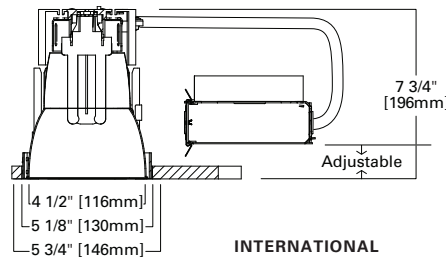

INTERNATIONAL

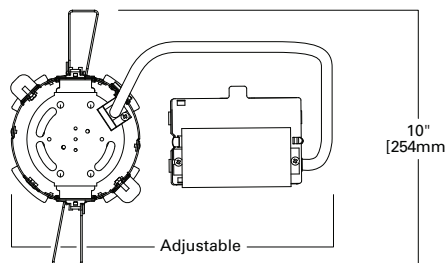
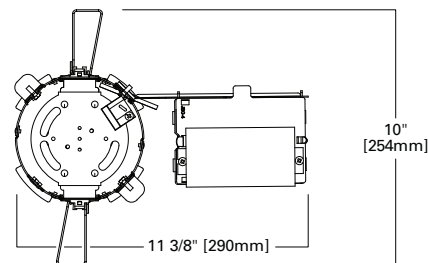

Example:

C4RV018ECP 4051LI WF = 4" CFL Vertical Remodel Downlight, 18 Watt Triple Tube 120/277 Volt, Chicago Plenum, Self Flanged with Specular Clear Finish

Housing	Wattage	Ballast	Options	Reflector	Finish	Option	Accessories
C4RV0 = 4" CFL Vertical Remodel C4IV0 = 4" CFL Vertical International	18 = 18W TTT 26 = 26W TTT	E = 120/277V 50/60 Hz Electronic 3E = 347V 50/60 Hz Electronic D = 120-277V Dimming, Lutron EcoSystem	CP = Chicago Plenum EM = Emergency Module with Remote Test Switch ¹	4051 = Downlight Reflector, Self Flanged 4050 = Downlight Reflector, Polymer Trim Ring	LI = Specular Clear H = Semi-Specular Clear WMH = Warm Haze G = Specular Gold WH = Wheat WHH = Wheat Haze GP = Graphite GPH = Graphite Haze CC = Chocolate CCH = Chocolate Haze K = Cognac KH = Cognac Haze B = Specular Black W = Gloss White	WF = White painted flange (self flanged only)	TRM4 = Metal Trim Ring, Specify Finish ¹ TRR4 = Rimless Trim Ring ¹ FK5 = 5 Amp Field Installable Fuse Kit 300V Max

Notes: 1 Order trim with polymer trim ring (Consult specification sheet for ordering information and options).

Energy Data	
Sound Rating: Class A standards	
18W Triple 4-pin	
Ballast: Electronic	
Min. Starting Temperature: -10°C (15°F)	
120V Input Watts: 29	Line Amps: 0.25
277V Input Watts: 26	Line Amps: 0.09
Power Factor: >0.99	THD: <90%
26W Triple 4-pin	
Ballast: Electronic	
Min. Starting Temperature: -10°C (15°F)	
120V Input Watts: 29	Line Amps: 0.25
277V Input Watts: 26	Line Amps: 0.09
Power Factor: >0.99	THD: <90%

PHOTOMETRICS

Candlepower Distribution Curve

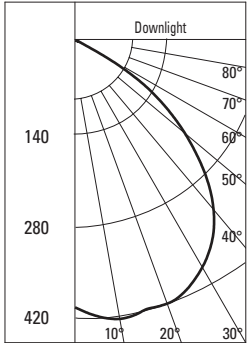

Test No. H21333
 C4026 4050LI
 Lamp = 26W TTT
 Spacing Criterion = 1.4
 Efficiency = 50.6%

Cone of Light

Distance Fixture to Lighted Plane	Initial Footcandles at Nadir	Beam Diameter
4'0"	25	5'6"
6'0"	11	8'0"
7'6"	7	10'0"
8'0"	6	11'0"
10'0"	4	13'6"