

## DESCRIPTION

Low brightness 6" aperture reflector for use with 26W, 32W, or 42W Triple Tube 4-pin compact fluorescent lamps for below ceiling installation. The precisely formed non-imaging optical reflector ensures 55° cutoff to lamp and lamp image and the one piece design eliminates light leaks at the ceiling. Standard features include low iridescent finish on all reflector colors to eliminate "rainbowing" and one electronic ballast to operate all 26W, 32W and 42W triple lamps. Venting ensures maximum lamp life and lumen output. Optics offer unparalleled performance in glare free lighting with a smooth beam devoid of hot spots. Open downlight, lens, and open wall wash reflectors are interchangeable within the same housing.

<b>Catalog #</b>		<b>Type</b>
<b>Project</b>		
<b>Comments</b>		<b>Date</b>
<b>Prepared by</b>		

## SPECIFICATION FEATURES

### Reflector

.050 thick aluminum, in a one piece spun parabolic contour. Available in a variety of Alzak® finishes. Also available with white or black baffle. Positive reflector mounting, without tools, pulls trim tight to ceiling.

### Trim Ring Options

Self flanged or molded white trim ring. Rimless or metal trim ring accessories available.

### Socket Connector

One piece die cast aluminum connection allows venting for maximum thermal performance.

### Housing Construction

Galvanized steel plaster ring accommodates up to 1" ceiling thickness.

### Conduit Fittings

Die cast screw tight connectors.

### Rotary Lock Socket

4 pin GX24q3/4 base with fatigue free stainless steel lamp spring ensures positive lamp retention.

### Electronic Ballast

Electronic ballast provides full light output and rated lamp life. Provides flicker free and noise free operation and starting. End of lamp life protection is standard.

### Labels

cULus listed, C.S.A. certified, standard damp label, IBEW union made.



## C6RH142 C6IH142 6150/6151

Compact Fluorescent

6-Inch  
Remodel/International  
Horizontal Open Downlight

### Energy Data

Sound Rating: Class A standards	
<b>26W Triple 4-pin</b>	
Ballast: Electronic	
Min. Starting Temperature: -10°C (15°F)	
120V Input Watts: 29	Line Amps: 0.25
277V Input Watts: 26	Line Amps: 0.09
Power Factor: >0.99	THD: <90%
<b>32W Triple 4-pin</b>	
Ballast: Electronic	
Min. Starting Temperature: -10°C (15°F)	
120V Input Watts: 34.5	Line Amps: 0.30
277V Input Watts: 34.5	Line Amps: 0.13
Power Factor: >0.99	THD: <90%
<b>32W Triple 4-pin</b>	
Ballast: Dimming	
Min. Starting Temperature: 10°C (50°F)	
120V Input Watts: 39	Line Amps: 0.33
277V Input Watts: 37	Line Amps: 0.13
Power Factor: >0.95	THD: <20%

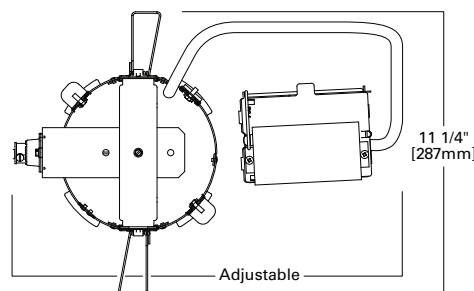
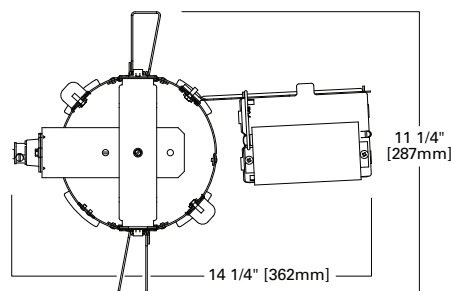
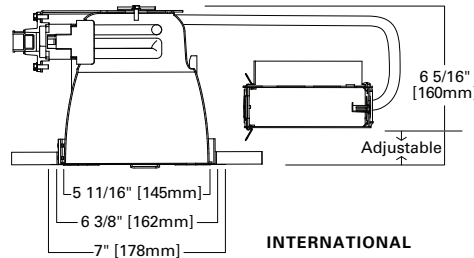
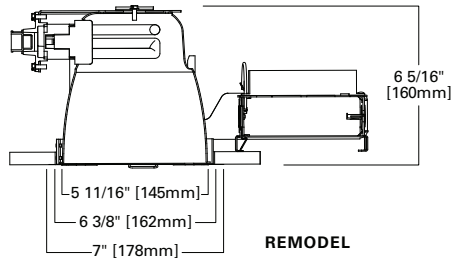

Example:

**C6RH142ECP 6151LI WF** = 6" CFL Horizontal Remodel Downlight, 42 Watt Triple Tube 120/277 Volt, Chicago Plenum, Self Flanged with Specular Clear Finish

Housing	Wattage	Ballast	Options	Reflector	Finish	Option	Accessories
<b>C6RH</b> = 6" CFL Horizontal Remodel <b>C6IH</b> = 6" CFL Horizontal International	<b>142</b> = 26/32/42W TTT	<b>E</b> = 120/277V 50/60 Hz Electronic <b>3E</b> = 347V 50/60 Hz Electronic <b>D26/32</b> = 26Wor 32W 120-277V Dimming, Lutron EcoSystem <b>D42</b> = 42W 120-277V Dimming, Lutron EcoSystem <b>EDR26</b> = DeRated Wattage Label, 26W <b>EDR32</b> = DeRated Wattage Label, 32W	<b>CP</b> = Chicago Plenum <b>EM</b> = Emergency Module with Remote Test Switch <b>IEM</b> = Emergency Module with Integral Test Switch	<b>6151</b> = Downlight Reflector, Self Flanged <b>6150</b> = Downlight Reflector, Polymer Trim Ring <b>6151E</b> = Downlight Reflector, Self Flanged, use with IEM <b>6150E</b> = Downlight Reflector, Polymer Trim Ring use with IEM	<b>LI</b> = Specular Clear <b>H</b> = Semi-Specular Clear <b>WMH</b> = Warm Haze <b>G</b> = Specular Gold <b>WH</b> = Wheat <b>WHH</b> = Wheat Haze <b>GP</b> = Graphite <b>GPH</b> = Graphite Haze <b>CC</b> = Chocolate <b>CCH</b> = Chocolate Haze <b>K</b> = Cognac <b>KH</b> = Cognac Haze <b>B</b> = Specular Black <b>W</b> = Gloss White <b>BB</b> = Black Baffle (6150 only) <b>WB</b> = White Baffle (6150 only)	<b>WF</b> = White painted flange (self flanged only)	<b>TRM6</b> = Metal Trim Ring, Specify Finish <sup>1</sup> <b>TRR6</b> = Rimless Trim Ring <sup>1</sup> <b>FK5</b> = 5 Amp Field Installable Fuse Kit 300V Max <b>DT6</b> = Deco trim <sup>1</sup> <b>ABR6P</b> = Remodel Adaptor Ring for 7" OD <b>ABR7P</b> = Remodel Adaptor Ring for 8" OD <b>ABR8P</b> = Remodel Adaptor Ring for 9" OD

Notes: 1 Order trim with polymer trim ring (Consult specification sheet for ordering information and options).

**PHOTOMETRICS**

**Candlepower Distribution Curve**

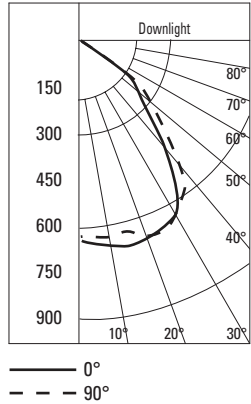

Test No. H22212  
 C6RH132-6150  
 Lamp = 32W TTT  
 Lumens = 2400  
 Spacing Criteria: 0° = 1.3, 90° = 1.4  
 Efficiency = 54.5%

**Cone of Light**

Distance Fixture to Lighted Plane	Initial Footcandles at Nadir	Beam Diameter
5'6"	21	7'6"
6'6"	15	9'0"
8'0"	10	11'0"
10'0"	6	14'0"
12'0"	4	16'6"
14'0"	3	19'6"

**Zonal Lumen Summary**

Zone	Lumens	%Fixture
0-30	559	42.7
0-40	906	69.2
0-60	1301	99.4
0-90	1308	100.0
90-180	0	0.0
0-180	1308	100.0

**Luminance**

Degrees	CD/SQ M	
	0°	90°
45	24603	29368
55	22161	21884
65	750	880
75	0	0
85	0	0

**Candela Distribution**

Degrees Vertical	0°		90°	
	0	647	647	
5	660	643		
15	680	659		
25	655	657		
35	507	574		
45	286	341		
55	209	206		
65	5	0		
75	0	0		
85	0	0		
90	0	0		

Beam diameter is to 50% of maximum footcandles, rounded to the nearest half-foot.

Footcandle values are initial, apply appropriate light loss factors where necessary.

**Reflector Multiplier:** Haze = .95  
 Straw = .90  
 Wheat = .90

**EM Multiplier (in emergency mode):** EM = .52

**PHOTOMETRICS**

**Candlepower Distribution Curve**

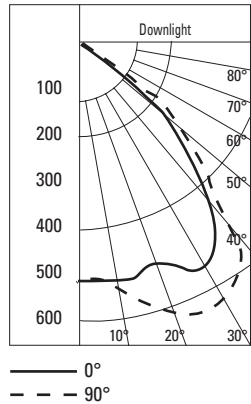

Test No. H22214  
 C6RH132-6150  
 Lamp = 32W PLT  
 Lumens = 2400  
 Spacing Criteria: 0° = 1.4, 90° = 1.6  
 Efficiency = 55.9%

**Cone of Light**

Distance Fixture to Lighted Plane	Initial Footcandles at Nadir	Beam Diameter
5'6"	18	8'6"
5'6"	13	10'0"
8'0"	9	12'6"
10'0"	6	15'6"
12'0"	4	18'6"
14'0"	3	22'0"

**Zonal Lumen Summary**

Zone	Lumens	%Fixture
0-30	529	39.4
0-40	889	66.3
0-60	1333	99.4
0-90	1340	100.0
90-180	0	0.0
0-180	1340	100.0

**Luminance**

Degrees	CD/SQ M	
	0°	90°
45	28885	33582
55	20280	22320
65	779	952
75	0	0
85	0	0

**Candela Distribution**

Degrees Vertical	0°		90°	
	0	556	356	
5	555	572		
15	544	664		
25	593	690		
35	519	632		
45	335	390		
55	191	210		
65	5	7		
75	0	0		
85	0	0		
90	0	0		

Beam diameter is to 50% of maximum footcandles, rounded to the nearest half-foot.

Footcandle values are initial, apply appropriate light loss factors where necessary.

**Reflector Multiplier:** Haze = .95  
 Straw = .90  
 Wheat = .90

**EM Multiplier (in emergency mode):** EM = .52