

DESCRIPTION

Low brightness 6" aperture downlight for use with 26W, 32W or 42W Triple Tube 4-pin compact fluorescent lamp for below ceiling installation. The lensed reflector provides superior shielding. Reflector trim eliminates brightness at higher angles. Standard features include low iridescent finish on all reflectors. Venting ensures maximum lamp life and lumen output. Open downlight, lens, and open wall wash trims are interchangeable within the same housing.

Catalog #		Type
Project		
Comments		Date
Prepared by		

SPECIFICATION FEATURES

Reflector

Clear upper Alzak® reflector for maximum light output. Positive reflector mounting, without tools, pulls trim tight to ceiling. Lower spun parabolic reflector, .050 thick aluminum available in a variety of Alzak® finishes.

Lens

Choice of tempered fresnel, prismatic, diffuse, or clear glass lenses or molded prismatic acrylic, opal diffuser or clear UV stabilized acrylic. Lens is fixed to lower reflector.

Socket Connector

One piece die cast aluminum connection allows venting for maximum thermal performance.

Housing Construction

Galvanized steel plaster ring accommodates up to 1" ceiling thickness.

Electronic Ballast

Electronic ballast provides full light output and rated lamp life. Provides flicker free and noise free operation and starting. End of lamp life protection is standard.

Labels

cULus listed, wet label, IBEW union made.

Conduit Fittings

Die cast screw tight connectors.

Rotary Lock Socket

4 pin GX24q3/4 base with fatigue free stainless steel lamp spring ensures positive lamp retention.

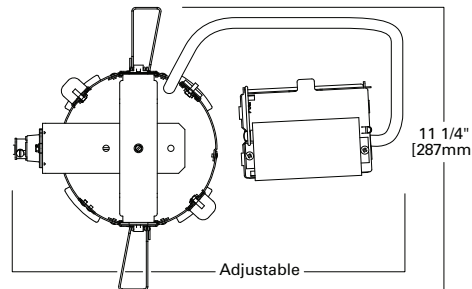
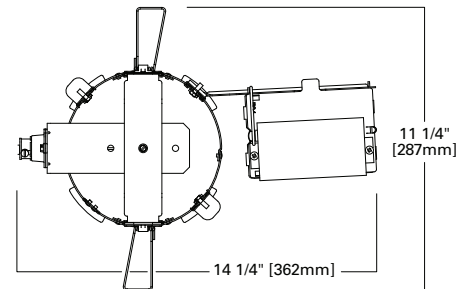
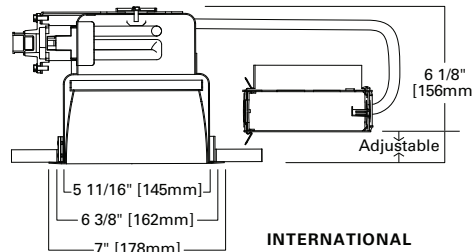
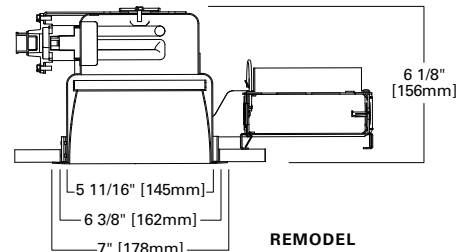

Example:

C6RH142ECP 6181LI WF = 6" CFL Horizontal Remodel Lensed Downlight, 42 Watt Triple Tube 120/277 Volt, Chicago Plenum, Self Flanged with Specular Clear Finish

Housing	Wattage	Ballast	Options	Reflector	Lens	Finish	Option	Accessories
C6RH = 6" CFL Horizontal C6IH = 6" CFL Horizontal International	142 = 26/32/42W TTT	E = 120/277V 50/60 Hz Electronic 3E = 347V 50/60 Hz Electronic D26/32 = 26Wor 32W 120-277V Dimming, Lutron EcoSystem D42 = 42W 120-277V Dimming, Lutron EcoSystem EDR26 = DeRated Wattage Label, 26W EDR32 = DeRated Wattage Label, 32W	CP = Chicago Plenum EM = Emergency Module with Remote Test Switch IEM = Emergency Module with Integral Test Switch	6181 = Downlight Lensed Reflector, Self Flanged 6180 = Downlight Lensed Reflector, Polymer Trim Ring	LI = Specular Clear H = Semi-Specular Clear WMH = Warm Haze G = Specular Gold WH = Wheat WHH = Wheat Haze GP = Graphite GPH = Graphite Haze CC = Chocolate CCH = Chocolate Haze K = Cognac KH = Cognac Haze B = Specular Black W = Gloss White BB = Black Baffle (6180 only) WB = White Baffle (6180 only)	1 = Prismatic Lens 2 = Diffuse Lens 3 = Clear Lens 1G = Prismatic Glass 2G = Diffuse Glass 3G = Clear Glass 4G = Fresnel Glass	WF = White painted flange (self flanged only)	TRM6 = Metal Trim Ring, Specify Finish ¹ TRR6 = Rimless Trim Ring ¹ FK5 = 5 Amp Field Installable Fuse Kit 300V Max DT6 = Deco trim ¹ ABR6P = Remodel Adaptor Ring for 7" OD ABR7P = Remodel Adaptor Ring for 8" OD ABR8P = Remodel Adaptor Ring for 9" OD

Notes: 1 Order trim with polymer trim ring (Consult specification sheet for ordering information and options).

Energy Data	
Sound Rating: Class A standards	
26W Triple 4-pin	
Ballast: Electronic	
Min. Starting Temperature: -10°C (15°F)	
120V Input Watts: 29	Line Amps: 0.25
277V Input Watts: 29	Line Amps: 0.10
Power Factor: >0.99	THD: <10%
32W Triple 4-pin	
Ballast: Electronic	
Min. Starting Temperature: -10°C (15°F)	
120V Input Watts: 36	Line Amps: 0.32
277V Input Watts: 36	Line Amps: 0.13
Power Factor: >0.99	THD: <10%
32W Triple 4-pin	
Ballast: Dimming	
Min. Starting Temperature: 10°C (50°F)	
120V Input Watts: 38	Line Amps: 0.31
277V Input Watts: 37	Line Amps: 0.13
Power Factor: >0.95	THD: <20%

PHOTOMETRICS

Candlepower Distribution Curve

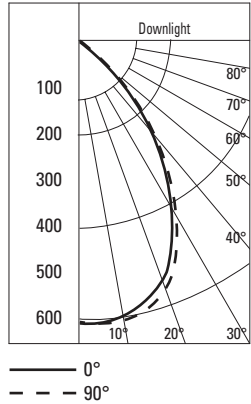

Test No. H22211
 C6RH132 6180LI1
 Lamp = 32W TTT
 Lumens = 2400
 Spacing Criteria: 0° = 1.1, 90° = 1.1
 Efficiency = 38.0%

Cone of Light

Distance Fixture to Lighted Plane	Initial Footcandles at Nadir	Beam Diameter
5'6"	20	6'0"
6'6"	15	7'6"
8'0"	10	9'0"
10'0"	6	11'6"
12'0"	4	13'6"
14'0"	3	16'0"

Zonal Lumen Summary

Zone	Lumens	%Fixture
0-30	463	50.7
0-40	674	73.9
0-60	876	96.0
0-90	912	100.0
90-180	0	0.0
0-180	912	100.0

Luminance

Degrees	CD/SQ M	
	0°	90°
45	13615	15813
55	7766	8318
65	4340	3691
75	0	0
85	0	0

Candela Distribution

Degrees Vertical	0°	90°
	0	613
5	621	625
15	608	619
25	516	539
35	336	354
45	158	184
55	73	78
65	30	26
75	0	0
85	0	0
90	0	0

Beam diameter is to 50% of maximum footcandles, rounded to the nearest half-foot.

Footcandle values are initial, apply appropriate light loss factors where necessary.

Lamp Multiplier
 26W TTT = .79

Reflector Multiplier:
 Haze = .95
 Straw = .90
 Wheat = .90

EM Multiplier (in emergency mode):
 EM = .27

PHOTOMETRICS

Candlepower Distribution Curve

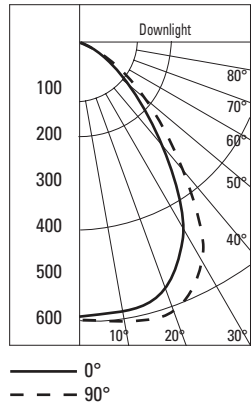

Test No. H22215
 C6RH132 6180LI1
 Lamp = 32W PLT
 Lumens = 2400
 Spacing Criteria: 0° = 1.1, 90° = 1.2
 Efficiency = 39.8%

Cone of Light

Distance Fixture to Lighted Plane	Initial Footcandles at Nadir	Beam Diameter
5'6"	20	6'6"
6'6"	14	8'0"
8'0"	9	9'6"
10'0"	6	12'0"
12'0"	4	14'6"
14'0"	3	17'0"

Zonal Lumen Summary

Zone	Lumens	%Fixture
0-30	468	49.0
0-40	699	73.2
0-60	917	96.1
0-90	955	100.0
90-180	0	0.0
0-180	955	100.0

Luminance

Degrees	CD/SQ M	
	0°	90°
45	14115	17243
55	8042	8796
65	4628	4196
75	0	0
85	0	0

Candela Distribution

Degrees Vertical	0°	90°
	0	594
5	591	596
15	588	609
25	506	559
35	344	394
45	164	200
55	76	83
65	32	29
75	0	0
85	0	0
90	0	0

Beam diameter is to 50% of maximum footcandles, rounded to the nearest half-foot.

Footcandle values are initial, apply appropriate light loss factors where necessary.

Lamp Multiplier
 26W TTT = .70

Reflector Multiplier:
 Haze = .95
 Straw = .90
 Wheat = .90

EM Multiplier (in emergency mode):
 EM = .27