

Plastic Plug Kit (JK050)
(7 Per Frame @ 18" O.C.)

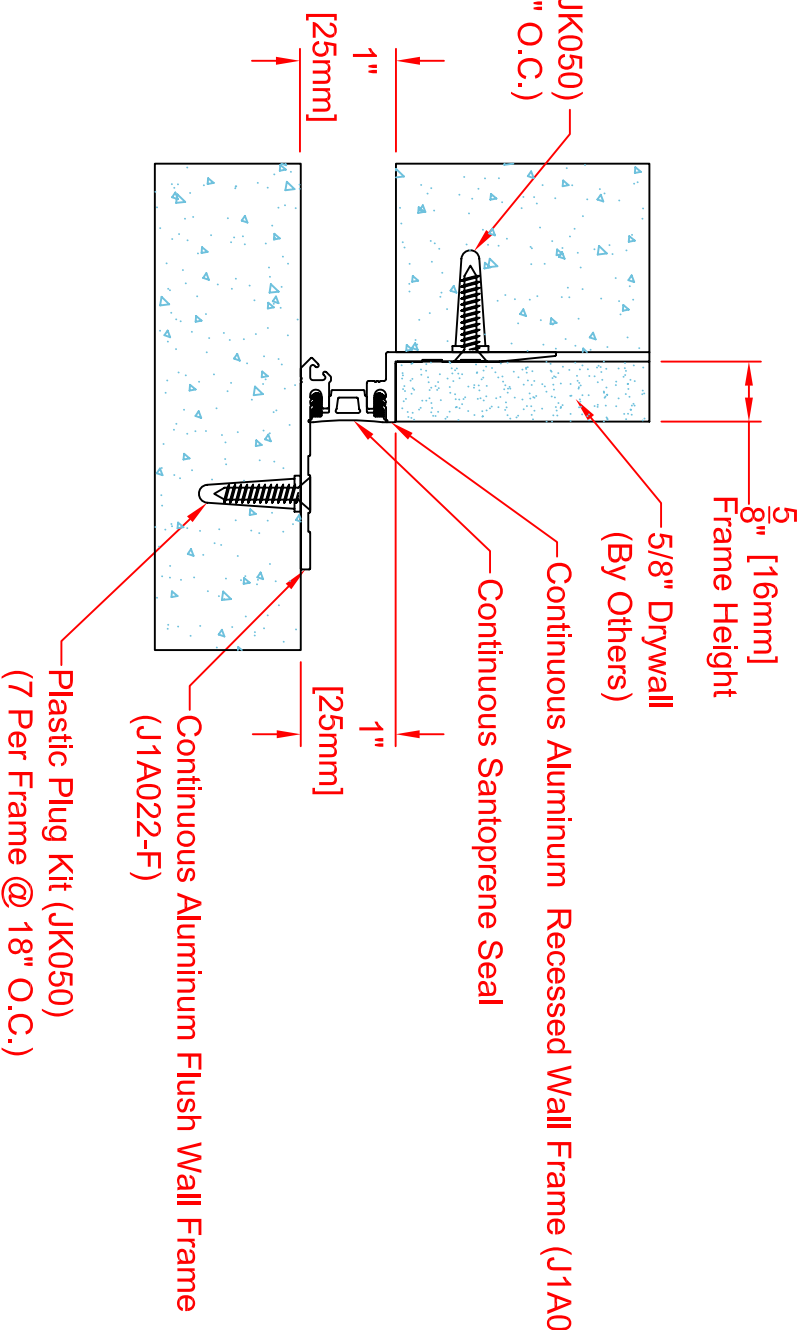

SPECIFY SEAL COLOR	
Black	(J1D001)
Beige	(J1D002)
Gray	(J1D003)
Off White	(J1D004)
Bright White	(J1D005)

Aluminum Finish-204-R1 Clear Anodized

101-A09-025 SYSTEM

Joint Width	Movement ±	
	Horizontal	Vertical
US mm	US mm	US mm
1" 25	1/4" 6	1/4" 6

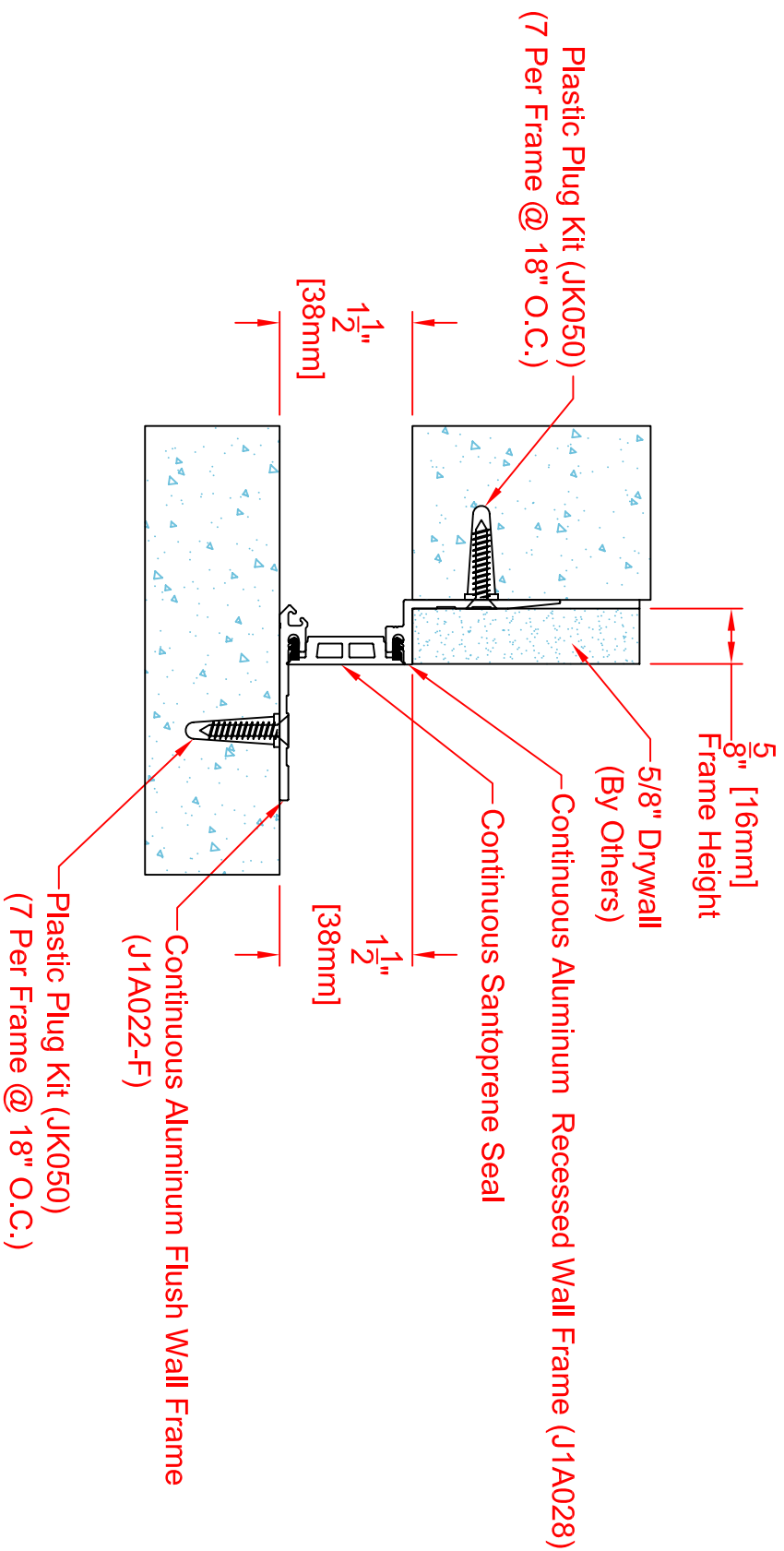

SPECIFY SEAL COLOR	
Black (J1D006)	
Beige (J1D007)	
Gray (J1D008)	
Off White (J1D009)	
Bright White (J1D010)	

Aluminum Finish-204-R1 Clear Anodized

101-A09-038 SYSTEM

Joint Width	Movement ±				
	Horizontal		Vertical		
US	mm	US	mm	US	mm
1-1/2"	38	3/8"	10	3/8"	10

APPLICATION-

FLUSH MOUNT WALL/CORNER - WALL/CEILING CONDITION
FOR 5/8" FINISH

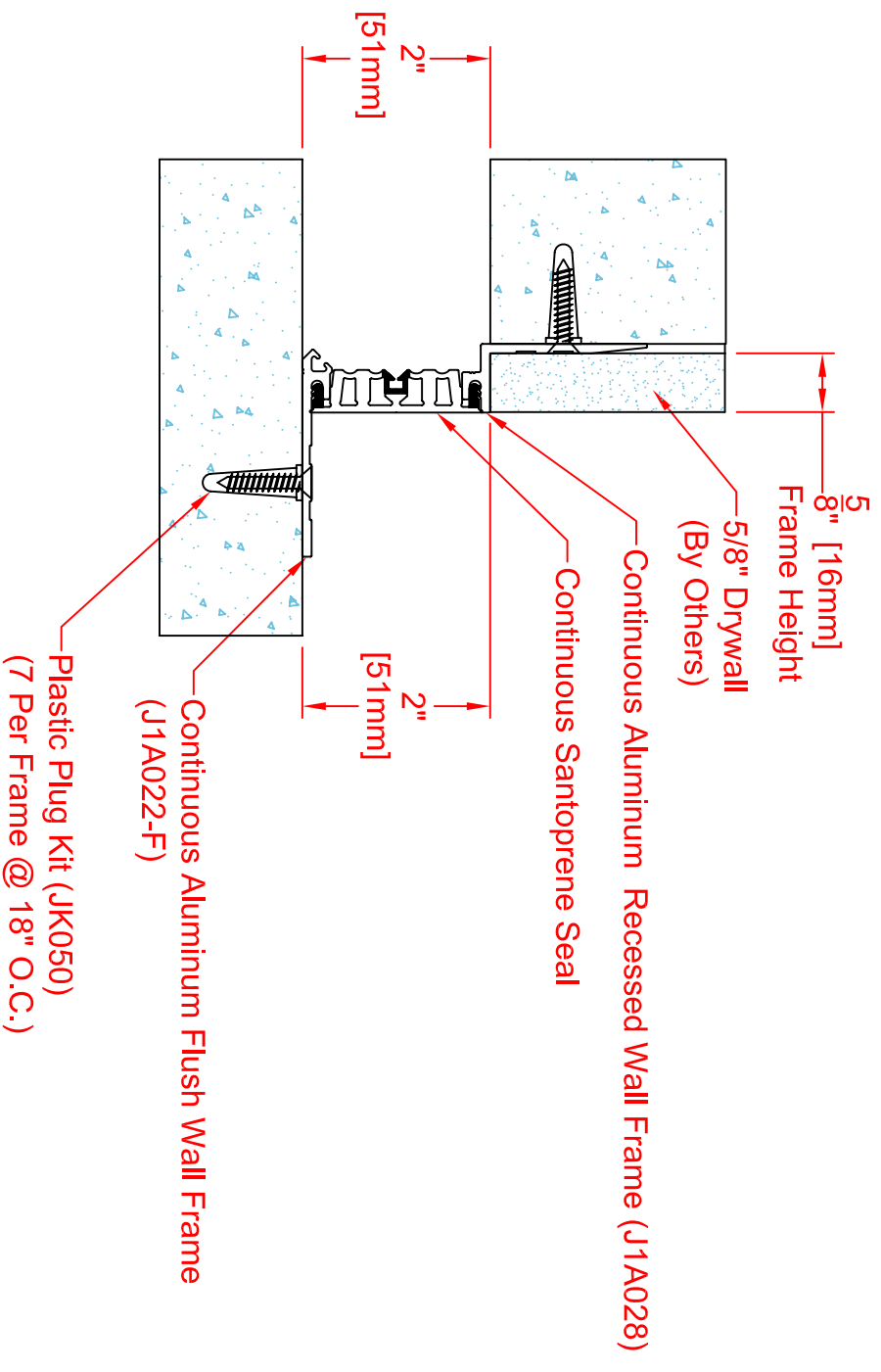

SPECIFY SEAL COLOR	
Black (J1D011)	
Beige (J1D012)	
Gray (J1D013)	
Off White (J1D014)	
Bright White (J1D015)	

Aluminum Finish-204-R1 Clear Anodized

101-A09-050 SYSTEM

Joint Width	Movement ±	
	Horizontal	Vertical
US mm	US mm	US mm
2" 51	1/2" 13	1/2" 13

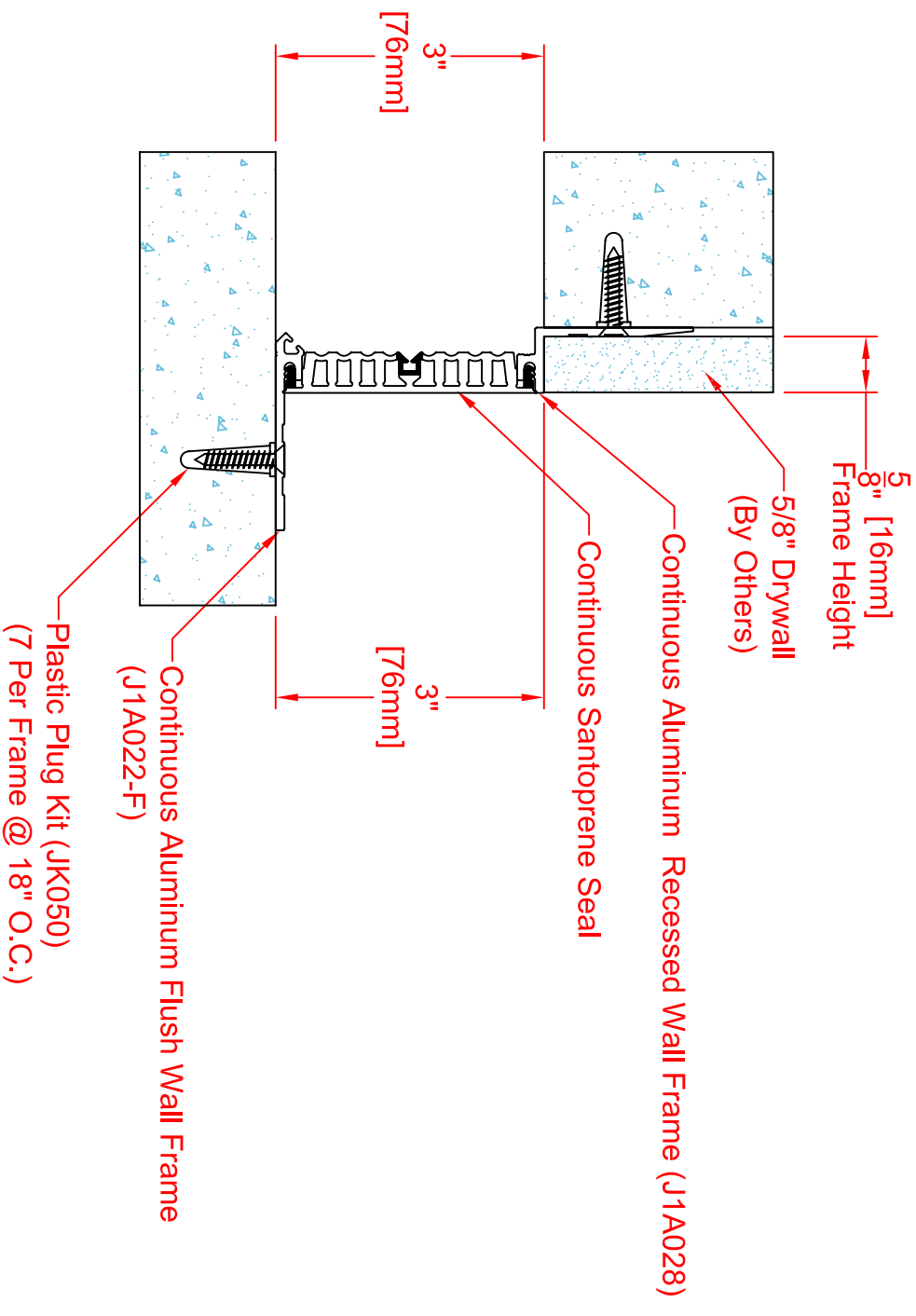

SPECIFY SEAL COLOR	
Black (J1D021)	
Beige (J1D022)	
Gray (J1D023)	
Off White (J1D024)	
Bright White (J1D025)	

Aluminum Finish-204-R1 Clear Anodized

101-A09-075 SYSTEM

Joint Width	Movement ±	
	Horizontal	Vertical
US	mm	mm
3"	76	3/4"
		19
		3/4"
		19

APPLICATION-

FLUSH MOUNT WALL/CORNER - WALL/CEILING CONDITION
FOR 5/8" FINISH