

SPECIFY SEAL COLOR	
Black (J1D001)	
Beige (J1D002)	
Gray (J1D003)	
Off White (J1D004)	
Bright White (J1D005)	

Aluminum Finish-Mill

101-A02-02538 SYSTEM

Joint Width	Movement ±		Load
	Horizontal	Vertical	
US 25 mm	US 1/4" mm	US 1/4" mm	US 2.8 Ton KN
1"	6 mm	6 mm	25 KN

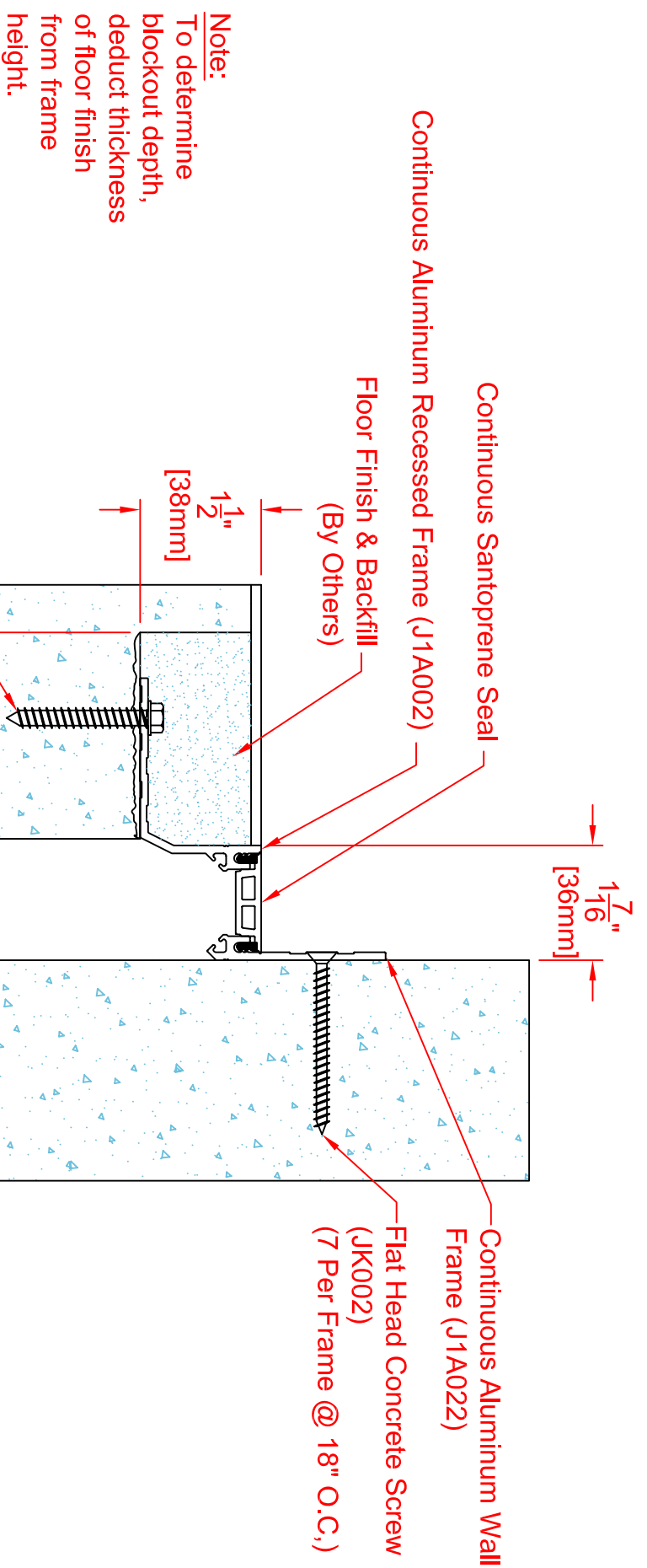

SPECIFY SEAL COLOR	
Black (J1D006)	
Beige (J1D007)	
Gray (J1D008)	
Off White (J1D009)	
Bright White (J1D010)	

Aluminum Finish-Mill

101-A02-03838 SYSTEM

Joint Width	Movement ±		Load
	Horizontal	Vertical	
US 38	US 3/8"	US 3/8"	US Ton 1.7
mm 38	mm 10	mm 10	KN 15

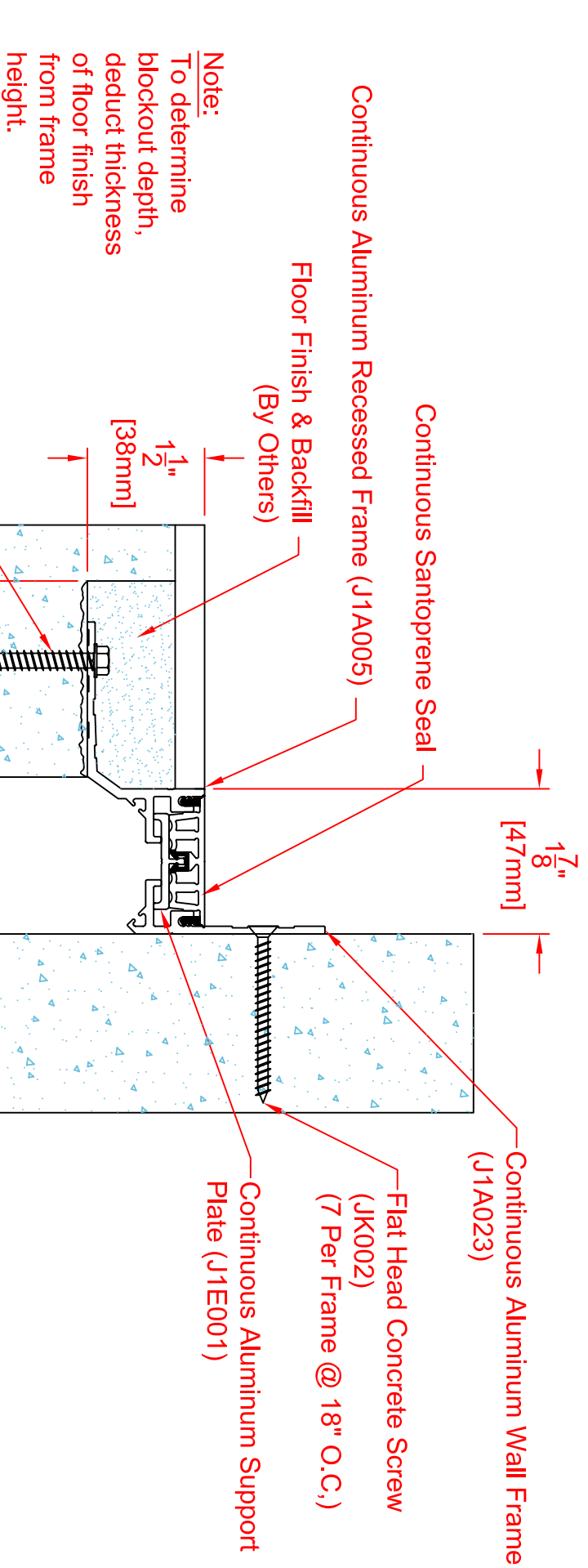

SPECIFY SEAL COLOR	
Black (J1D011)	
Beige (J1D012)	
Gray (J1D013)	
Off White (J1D014)	
Bright White (J1D015)	

Aluminum Finish-Mill

101-A02-05038 SYSTEM

Joint Width	Movement ±		Load
	Horizontal	Vertical	
US mm	US mm	US mm	US Ton
2"	51	1/2"	13
		1/2"	13
			1.7
			15

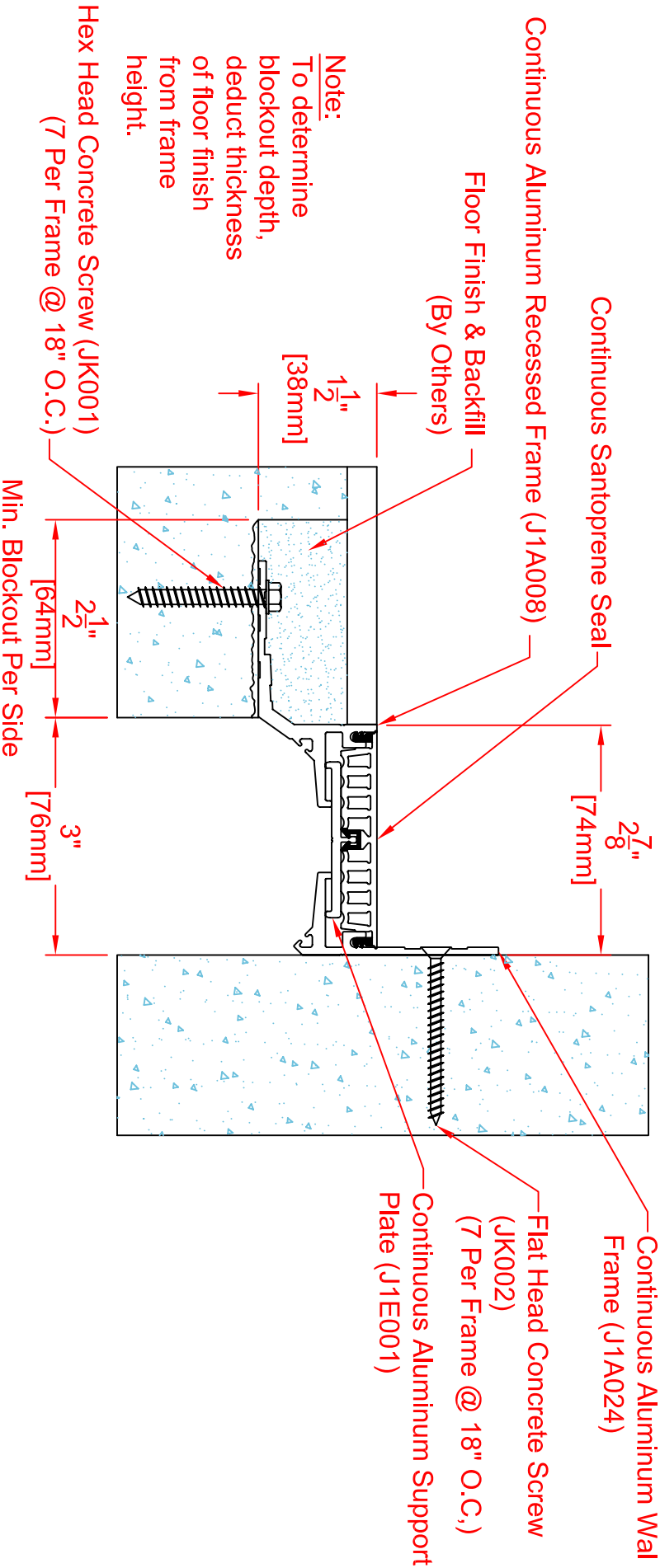

Note:
To determine blockout depth, deduct thickness of floor finish from frame height.

Hex Head Concrete Screw (JK001)
(7 Per Frame @ 18" O.C.)

SPECIFY SEAL COLOR	
Black (J1D021)	
Beige (J1D022)	
Gray (J1D023)	
Off White (J1D024)	
Bright White (J1D025)	

Aluminum Finish-Mill

101-A02-07538 SYSTEM

Joint Width	Movement ±		Load
	Horizontal	Vertical	
US mm	US mm	US mm	US Ton
3"	76	3/4"	19
			1.7
			15