

Prism® & Illusion™ Solid Surface Wall Cladding

FIG.1

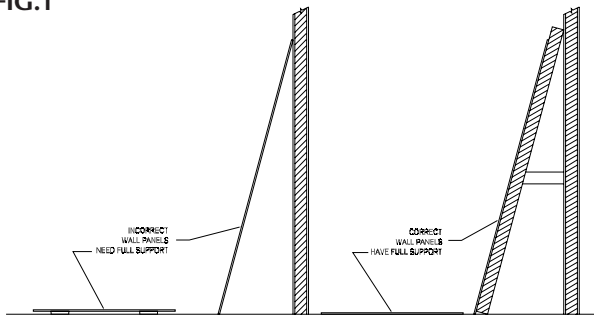

FIG.2

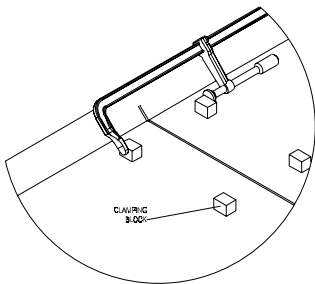

FIG.3

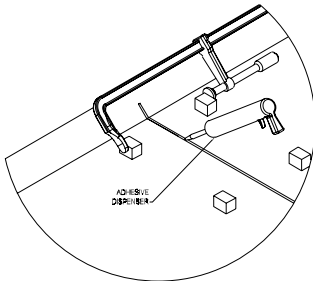
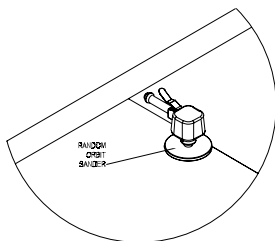

FIG.4



Prism Solid Surface Tools and Materials Required

Belt sander with #24 or 36 grit sandpaper, saber saw, router (1³/₄" HP, 22,000 rpm), random orbit sander with #100, 60, and 30 micron sandpaper, electric drill with carbide or high speed steel bits, circular/trim saw with carborundum or carbide tipped blade, tape measure, grease pencil, buffer with polishing compounds and scotch brite pads, flat file, clamps, denatured alcohol, safety goggles, paper towels, caulking gun, dust masks, masking tape, level/straight edge, solid surface adhesive, clear silicone sealant, hot melt, epoxy and color matched silicone sealant. See Figure 1.

1. In advance determine where hard seams, soft seams, batten strips, corner moldings and perimeter trim will occur. Soft seams must occur at inside and outside corners. Cut 1/4" solid surface material to the required size.
2. Hard seaming: Hard seaming is the joining of two or more panels with two-part adhesives to form inconspicuous seams. Make hard seams on a flat work surface. Cut edges straight and square. See Figure 2. When seaming Illusion™ Solid Surface panels, use a "wiggle" template to make the seam. Apply clamping blocks made from solid surface material to the surface of the wall panel with clear hot melt glue. Blocks should be 3" from each edge and every 6" over the length of the seam. Tighten clamps so the gap at the seam is 1/8". See Figure 3. Apply two-part adhesive to the seam and tighten the clamps until the adhesive squeezes out. Allow adhesive to cure. Remove clamps and clamping blocks. See Figure 4. Prism® Solid Surface: sand off excess adhesive, starting with 100 micron grit sandpaper, 60 micron grit sandpaper followed by Scotch-Brite® pad (#7447 maroon, very fine) for matte/solid colors or a Scotch-Brite® pad (#7448 gray, ultra fine) for semi-gloss/granite colors. Start sanding 6" on either side of the seam and conclude the sanding by going as wide as 12" on either side of the seam.

Illusion Solid Surface: For matte finish, sand off excess adhesive, starting with 60 micron grit sandpaper, 40 micron grit sandpaper and followed by a Scotch-Brite® pad, (#7447 Maroon, Very Fine). For semi/gloss, sand off excess starting with 60 micron grit sandpaper, 40 micron grit sandpaper 30 micron paper a Scotch-Brite® pad, (#7448 Gray, Ultra Fine). Sand 6" on either side of the seam and conclude the sanding by going as wide as 12" on either side of the seam.



Installation Questions?

Contact our Installation Hotline 866.EZINPRO
For Sales & Customer Service call 800.222.5556

Prism® & Illusion Solid Surface Wall Cladding

FIG.5

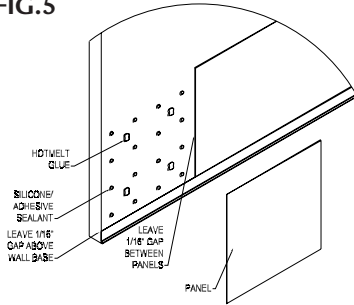

FIG.6

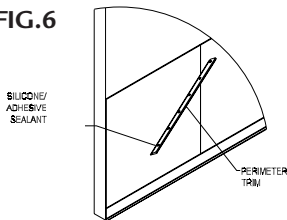

FIG.7

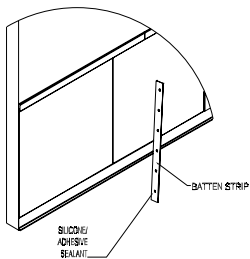
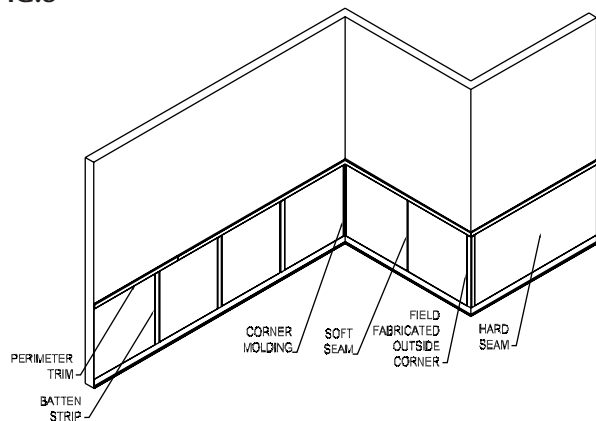
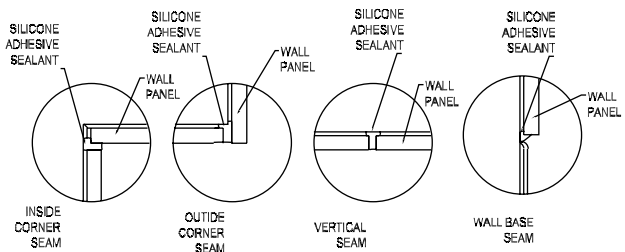

FIG.8



3. Apply 1"-1 1/2" diameter portions of adhesive on the wall spaced 4" from the edges and 8" to 10" over the rest of the field. Before applying the panel to the wall, apply hot melt adhesive on the wall every 16". This is to hold the panel in place until the silicone adhesive cures. Right after applying the hot melt, position the panel on the wall and press it into place. If installing above wall base allow 1/8" gap. If you are using batten strips and corner molding leave 1/8" gaps between panels where these trim items will be used. See Figure 5.
4. After all panels are adhered to the wall, fill all gaps between panels, wall base and corner conditions with clear silicone sealant. Mask off either side of the seam. Fill in the gap with clear silicone sealant, smooth it out and remove the masking tape. Clean-up any excess sealant with denatured alcohol. See Figure 9.
5. Perimeter trim - Cut perimeter trim to the desired length allowing 1/8" gaps at corners and between pieces. Adhere it to the wall with dabs of clear silicone sealant 2" from the ends and spaced every 8" over the length of the trim. Apply clear silicone on the back part of the trim that mates with the wall. Clean-up any excess sealant with denatured alcohol. See Figure 6.
6. Corner Moldings and Batten Strips - Cut Corner Molding and Batten Strips to the required length. Apply small dabs of clear silicone sealant on the back of the trim. Position and press trim pieces into place. Tape if needed until sealant cures. Clean-up any excess sealant with denatured alcohol. See Figure 7.
7. Outside corner pieces - Produce field fabricated outside corner by gluing and clamping solid surface material together with two-part adhesive. Sand and finish corner to match panels.

FIG.9



Installation Questions?

Contact our Installation Hotline 866.EZINPRO
For Sales & Customer Service call 800.222.5556