

Prism® Wall Panels & Cladding

PRISM®
Solid Surface

- ▶ Easy to clean surface to maintain a sanitary environment
- ▶ Protects walls from cart, wheelchair and pedestrian traffic
- ▶ Provide a continual appearance with available accessories
- ▶ Add a decorative element by adding shapes or logos in the wall panels
- ▶ Surface is non-porous and does not promote the growth of mold, mildew or bacteria
- ▶ Surface is solid throughout making it easy to renew and repair
- ▶ Tested and certified per ANSI standards to ensure product longevity
- ▶ Meets the emission level requirements of Greenguard Certification
- ▶ Meets National Sanitation Foundation standard for food and splash zones
- ▶ 1/4" thick panels are available in 36" and 48" widths and 96", 120" and 144" lengths
- ▶ Coordinate interiors with 70 colors

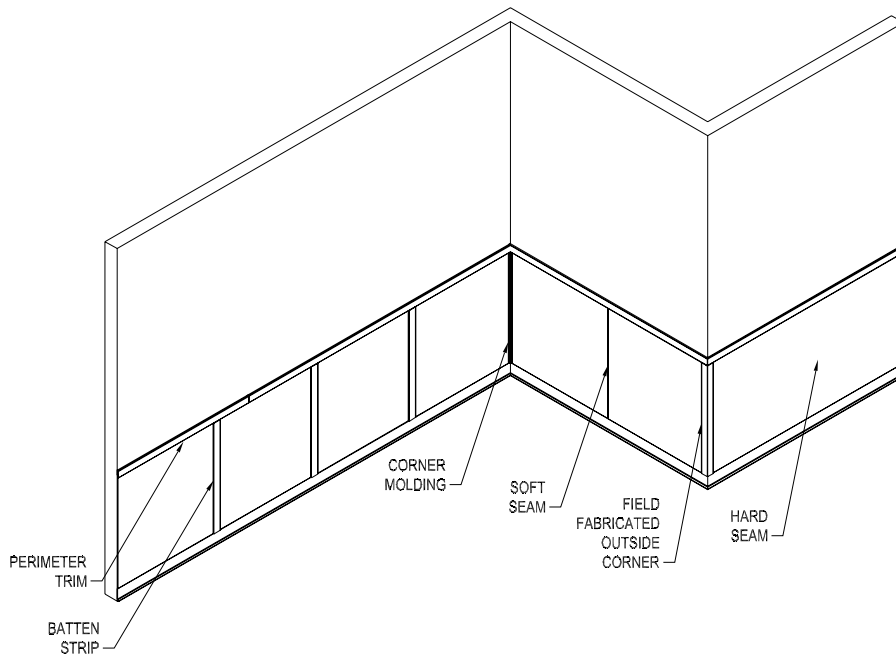

IPC.717/REV.3



P.O. Box 406 · Muskego, Wisconsin 53150 USA
inprocorp.com
Nationwide 800.222.5556/Fax 888.715.8407
International Sales 262.679.5521/Fax 262.679.5524

INPRO
IPC Interior Protection Products
and Decorative Surfaces

Prism® Wall Panels & Cladding

Suggested Specifications

PART 1 – GENERAL

1.01 SUMMARY

A. Wall Cladding from Prism Solid Surface Material

1.02 SECTION INCLUDES

A. Wall cladding/wainscoting

1.03 REFERENCES

A. American National Standards Institute (ANSI)

B. International Cast Polymer Alliance (ICPA)

C. National Fire Protection Association (NFPA)

1.04 SYSTEM DESCRIPTION

A. Provide wall cladding that conform to the following requirements of regulatory agencies and the quality control of InPro Decorative Surfaces.

1. Provide solid surface material that conforms to ANSI/ICPA SS-1 for workmanship and finish, structural integrity and material characteristics.

2. Fungal and Bacterial Resistance: Provide Prism Solid Surface Inconspicuous Hygienic Wall System that does not support fungal or bacterial growth as tested in accordance with ASTM G-21 and ASTM G-22.

3. Fire Performance Characteristics: Provide Prism Solid Surface Wall Cladding conforming with the NFPA class A fire rating as determined by ASTM E-84.

1.05 SUBMITTALS

A. Product Data: Manufacturer's printed product data for each type of wall cladding specified.

B. Samples: Color samples a minimum of 2" x 2" indicating color and pattern.

C. Manufacturer's Installation Instructions: Printed installation instructions for each type of wall cladding specified.

1.06 DELIVERY STORAGE AND HANDLING

A. Deliver materials in unopened factory packaging to the jobsite.

B. Inspect materials at delivery to assure that specified products have been received.

C. Store in original packaging in an interior climate controlled location away from direct sunlight.

1.07 PROJECT CONDITIONS

A. Environmental Requirements: Products must be installed in an interior climate controlled environment.

1.08 WARRANTY

A. Standard PRISM® Solid Surface Limited 10 Year Warranty against material and manufacturing defects.

PART 2 – PRODUCTS

2.01 MANUFACTURER

A. Acceptable Manufacturer: InPro Decorative Surfaces, InPro Corporation, PO Box 406 Muskego, WI 53150 USA; Telephone: 800-222-5556, Fax: 888-715-8407, www.inprocorp.com

B. Substitutions: Not permitted

C. Provide all Solid Surface Fabrications from a single source.

2.02 SOLID SURFACE FABRICATIONS

A. Wall cladding/wainscoting: Provide wall cladding/wainscoting from 1/4", panels of Prism Solid Surface. Panels shall have butt joints or 1/16" joints sealed with color matched silicone sealant. Panels are to be adhered with adhesive.

2.03 ACCESSORIES

2.03 ACCESSORIES

A. Prism Corner Molding, 3/4" x 3/4" x 1/4" x 96"

B. Prism Batten Strip, 2 1/4" x 1/4" x 96"

C. Prism Perimeter Trim, 2 1/4" x 1/4" x 96"

D. Solid Surface Bonding Adhesive

E. Adhesive Cartridge Dispenser

F. Adhesive Mixing Tips

G. Silicone Sealant

2.04 MATERIALS

A. Solid Surface: Prism Solid Surface material shall be manufactured from polyester/acrylic blended resins with natural filler material.

2.05 FINISHES

A. Color and pattern of solid surface material to be selected by the architect from the Prism Solid Surface finish selection. Surface shall have a matte, semi-gloss or high-gloss finish.

2.06 FABRICATION

A. Fabricator should be familiar with the cutting, machining, sanding polishing and seaming of solid surface materials. Prism solid surface material cannot be thermoformed.

B. Produce joints connecting components using manufacturer's joint adhesive. Joints shall be inconspicuous in appearance.

C. Finish: Finish all surfaces uniformly.

PART 3 – EXECUTION

3.01 EXAMINATION

A. Examine areas and conditions in which wall cladding will be installed.

3.02 PREPARATION

A. General: Prior to installation, clean area to remove dust, debris and loose particles.

3.03 INSTALLATION

A. General: Install components plumb and level, scribe adjacent finishes, in accordance with approved shop drawings and recommended installation instructions.

3.04 CLEANING

A. At completion of the installation, clean surfaces in accordance with the InPro Decorative Surfaces clean-up and maintenance instructions.

