

**MIDBACK**  
(SHOWN WITH CUSHION)

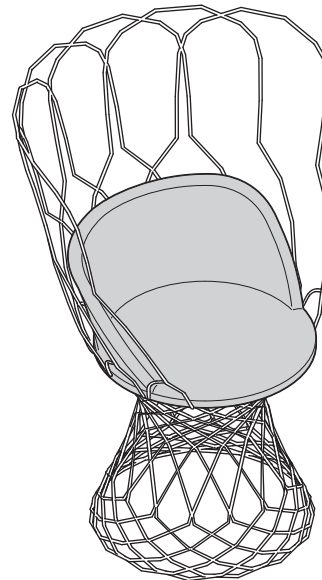

**HIGHBACK**  
(SHOWN WITH CUSHION & BACK)

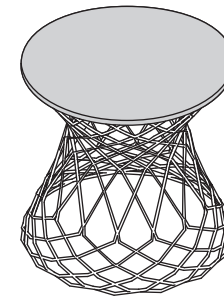

**POUF**

If you have a problem, question, or request, call  
your local dealer, or Coalesse at 1.800.627.6770  
Or visit our website: [www.coalesse.com](http://www.coalesse.com)

© 2009 Coalesse  
San Francisco, California U.S.A.  
Printed in U.S.A.

## Installing the Seat Cushion Only

**1.** Place seat cushion onto chair. Locate the ball and string to the right and left hand sides of the chair.

**2.** Press button on ball inward (2a) and slide ball off string (2b).

**3.** Slide string through chair webbing.

**4.** Place each ball back onto string and slide upward (4a) so it fits snugly under chair webbing (4b).

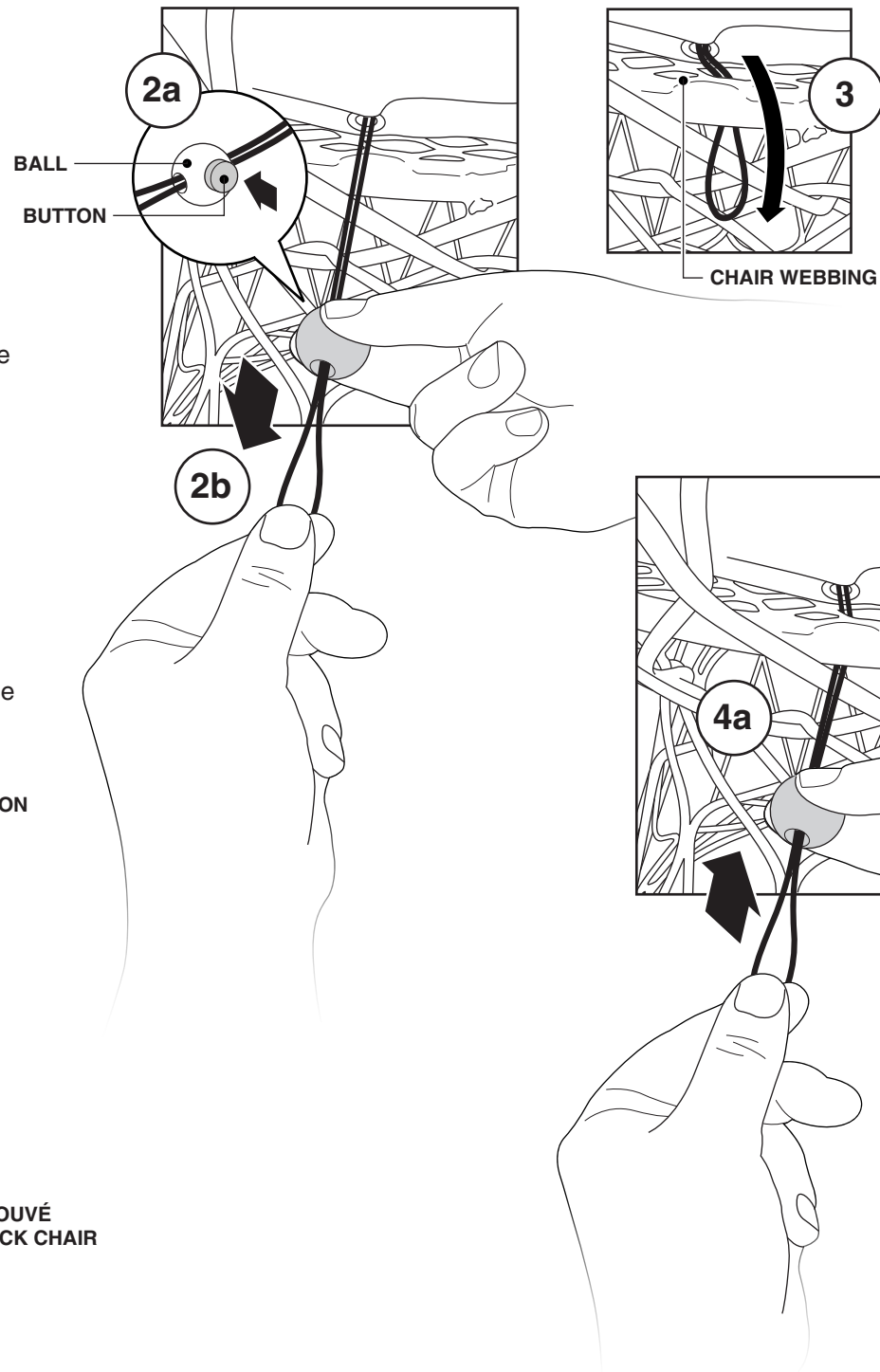
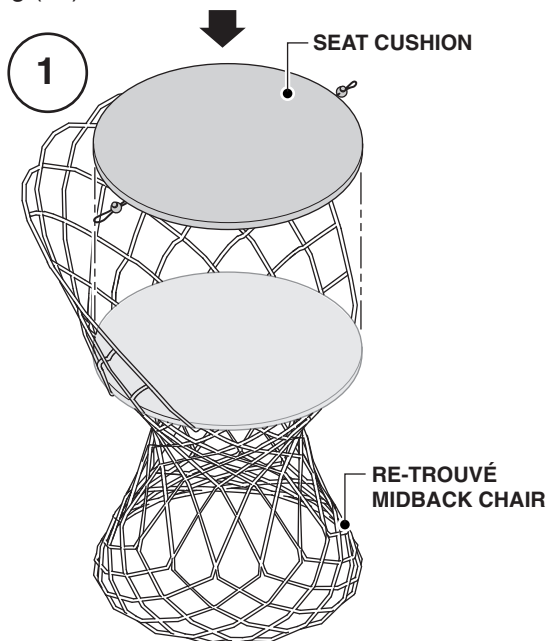

## Installing the Seat Cushion and Back Cushion

**1.** On the back cushion, locate each ball and string. There are five (5) total. Press button on ball inward (1a) and slide ball off string (1b).

**2.** Lower back cushion onto seat cushion (2a) and carefully thread all five (5) strings through each eyelet (2b).

**3.** Place back cushion onto chair.

**4.** Perform steps 3 and 4 on page 2 to complete the installation.

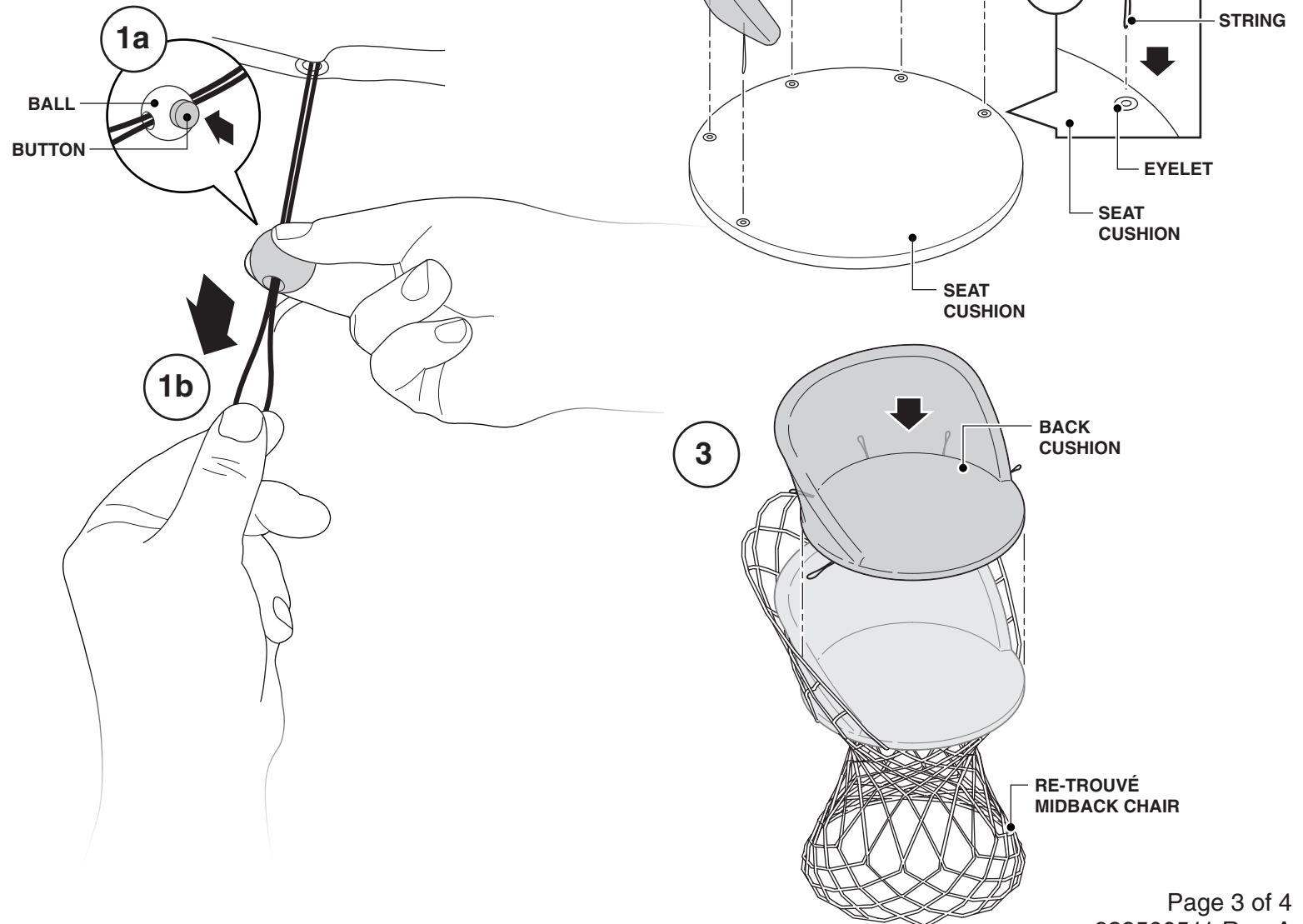

## Installing the Seat Cushion onto a Pouf

- 1.** Press button on ball inward (1a) and slide ball off string (1b).
- 2.** Lower seat cushion onto the pouf.
- 3.** Slide each string through pouf webbing.
- 4.** Perform step 4 on page 2 to complete the installation.

