

Dual Lens for Cool Operation

Pedestrian Areas

Flagpole Lighting

Building Accent

Wall Wash

Sign Lighting

Landscape Areas



Specifications



Certifications

ETL and CETL listed for wet location, direct burial, and concrete pour. Also listed for indoor usage and meets IP67 standard.

Lamp/Ballast Housing

Compression molded Rhinolite™ composite material, structurally reinforced with glass fibers. Superior resistance to ultra violet degradation and corrosion resistant in harsh environments.

Splice Compartment

Supplied with two 3/4" NPT conduit entrances. Connection to ballast compartment by way of anti-wicking device. Sealed with gasketed die cast aluminum cover plate. Suitable for through wiring.

Dual Lens

External lens standard 3/8" clear tempered flat borosilicate glass (F) or ADA walkover clear tempered flat borosilicate glass (ADA). Flat lenses will withstand loads up to 5000 lbs. Sealed to housing with high temperature injection molded silicone gasket. Optional linear spread lens also available. Internal lens is 1/4" clear tempered flat soda-lime glass.

Lens Frame

Heavy duty die cast bronze lens frame is supplied as standard. Fastened to housing with six captive 10-24 stainless steel Allen cap screws.

Reflectors

Spun aluminum highly specular Alzak™ finish for either NEMA type 1 or 2 spot (SPT) or NEMA type 3 flood (FLD) distributions. Field adjustable up to 25° tilt and 360° horizontal rotation. NOTE: Tilt adjustment varies by lamp type. A segmented fluorescent reflector is available for up to 42W lamps.

Lamp Holder

Porcelain 4kv pulse rated medium base for HID and Incandescent lamp sources.

Options

Cast aluminum Convex Rock Guard (CR), and Directional Shield (DS). Consult factory for cast bronze options. Internal Glare Shield (IGS), Internal Hex cell Louver (HL), Glass Color Filter (GF), Trim Ring (TR), Grout Mask (GM), Debris Cover (DC).

Finish

Housing Black (BK). Options can be painted in standard or custom colors.

Safety

Caution: Care should be taken when specifying fixtures for use in pedestrian walkways to avoid problems that may be caused by high lens temperatures. Consult factory for more information.

Warning

Caution: Care should be taken not to install in-ground fixtures in areas where water can stand for prolonged periods of time. Sufficient drainage must be provided to avoid problems. Consult factory for more information.

PROJECT
FIXTURE TYPE
CATALOG#

2930 South Fairview Street
 Santa Ana, CA 92704
 Phone: 714 668 3660
 Fax: 714 668 1107
 sales@allscape.net
 http://www.allighting.com

SL-23HPBB

Product Order Guide

Series	Max Watts	Lamp Type	Voltage ²	Optics	Options Lens	Options	Finish ^{1,6}	Options
SL-23-HPBB								
Metal Halide								
20MH		BT5	120	SPT Spot	F	Clear Flat	BK ¹ Black	CR Convex Rockguard ^{3,4}
39MH		Par20 ⁵	208	FLD Flood	ADA	ADA Walkover	BZ ¹ Bronze	DS Directional Shield ^{3,4}
70MH		T6 or T4	240		LS	Linear Spread	WH ¹ White	HL Hex Cell Louver
			277				GR ¹ Green	GF Glass Color Filter
Incandescent/Halogen/Low Voltage								
100INC		T4mini	120				NA ¹ Natural Alum	TR* Trim Ring
50INC		Par20 ⁵	120				GY ¹ Gray	GM Grout Mask
75INC		MR16 ⁵	120/277/12				CC ¹ Custom Color	DC Debris Cover
								LFSS Stainless Steel Lens Frame
								STA Square Top Adaptor ^{3,4}
								AHOT AIM-HOT
								ASET AIM-SET
LED								
1X1WLED	MR16 ^{5,6}	120/277	2,4,10,16,25,50,80,2x70,10x60					Color Red, Blue, Green, Amber, White (5000°K)
3X1WLED	MR16 ^{5,6}							
1X5WLED	CUS ^{5,6}	120	10,30,45					Color Red, Blue, Green, Amber, White (5500°K)

¹ Baked enamel paint standard, powder coat optional

² Consult factory for other voltages and finishes.

³ Consult factory for cast bronze options.

⁴ These options are supplied in heavy wall cast aluminum with baked enamel painted finish.

⁵ Does not require internal optics

⁶ The LED MR16 units used are supplied by Optiled. The CUS version uses a 5W BL4000 from Lamina

* TR REQUIRED FOR CONCRETE POUR

CF=single biax, CFQ = double biax, CFT = triple biax

Note: E-17 Lamps 175 W and below are medium base

Example: SL-23-HPBB-70MH-T6-277-SPT-F

Luminaire Lens Temperatures

Luminaire	Center		Off-Center	
	°C	°F	°C	°F
SL-23-HPBB-70MH-T6-FLD	86°	187°	76°	177°
SL-23-HPBB-39MH-T6-FLD	64°	147°	61°	142°
SL-23-HPBB-20MH-BT5-FLD	52°	126°	50°	122°
SL-23-42CFT-FLD-GF ¹	63°	145°	60°	140°
SL-23-3X1WLED-MR16 ²	33°	91°	32°	90°

Note: All temperatures are maximum relative to 25° C ambient.

¹ 42CFT tested with clear filter only, no HPBB option

² 3X1WLED tested with no filter or HPBB options

Consult factory for details of the temperature test and a copy of the test report.

Luminaire Dimensions

Luminaire	A		B		C		D		E		Weight	
	Inch	mm	Inch	mm	Inch	mm	Inch	mm	Inch	mm	lbs.	kg
SL-23-HPBB-F	6.95	177	0.75	19	14.10	358	8.50	216	n/a	n/a	20	9.1
SL-23-HPBB-CR	6.95	177	0.75	19	14.10	358	8.50	216	1.00	25	20.5	9.3
SL-23-HPBB-DS	6.95	177	0.75	19	14.10	358	8.50	216	3.85	98	21	9.5

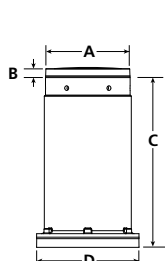
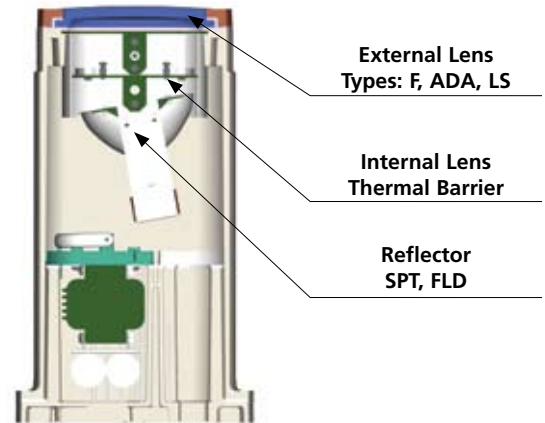

SL-23-HPBB-F

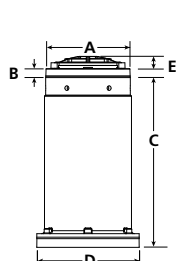

SL-23-HPBB-CR

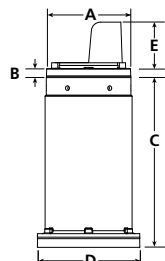

SL-23-HPBB-DS