

**CAUTION:** Before moving this product, make sure to disconnect at storage unit. Failure to do so may cause personal injury or property damage.

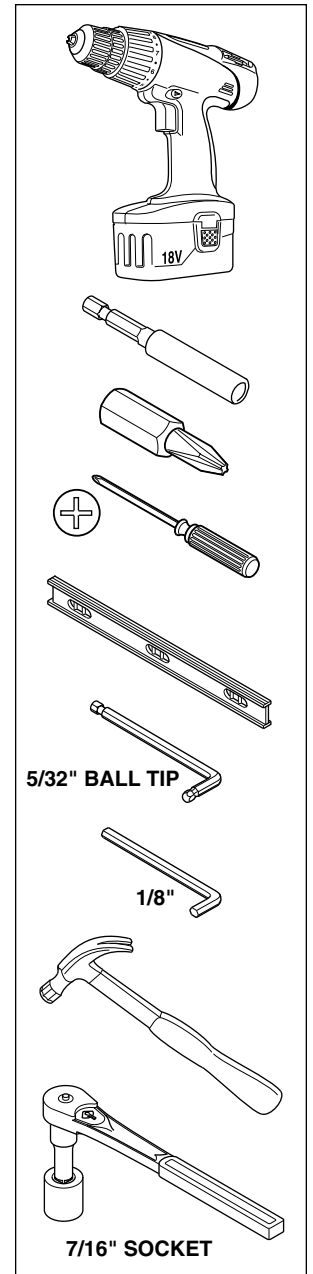
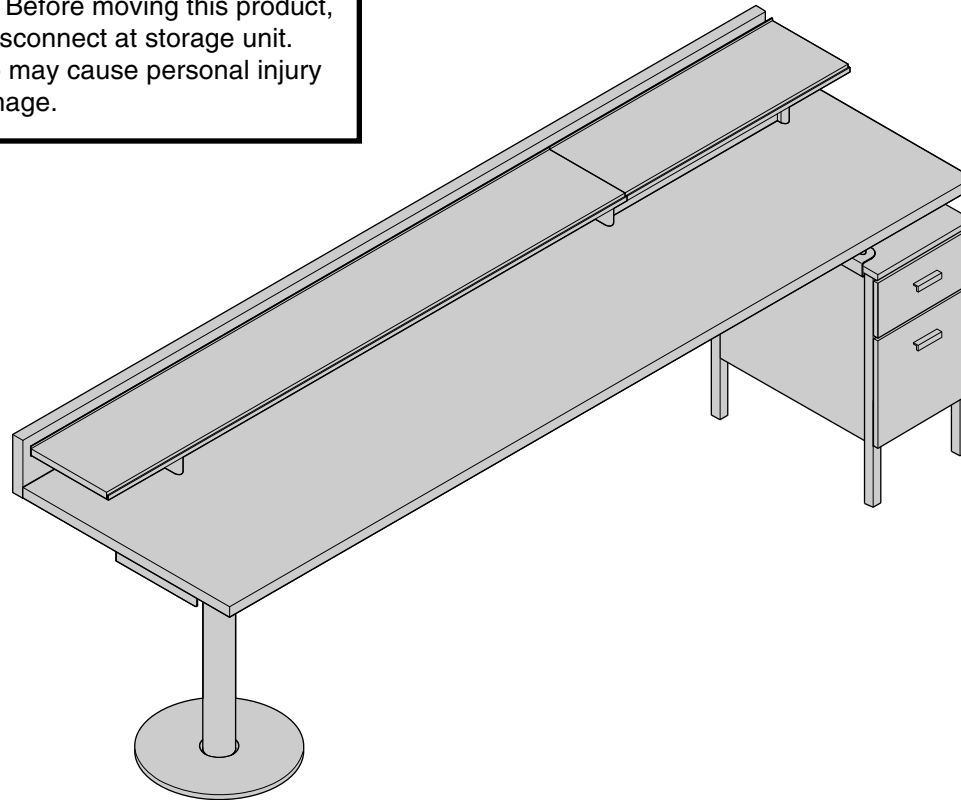

If you have a problem, question, or request, call your local dealer, or Coalesse at 1.800.627.6770 Or visit our website: [www.coalesse.com](http://www.coalesse.com)

© 2010 Coalesse  
San Francisco, California U.S.A.

Printed in U.S.A.

**1.** Pull drawer forward from the pedestal (1a). Push tab on each side of the drawer rail (1b). Remove file drawer completely then remove box drawer. Push slide rails back into pedestal.

**2.** Remove inner screws and loosen outer screws on trim piece (2a) then remove trim piece from pedestal (2b) and save screws.

**NOTE:** Depending on your installation, you will need to clarify which trim piece to remove (left or right hand).

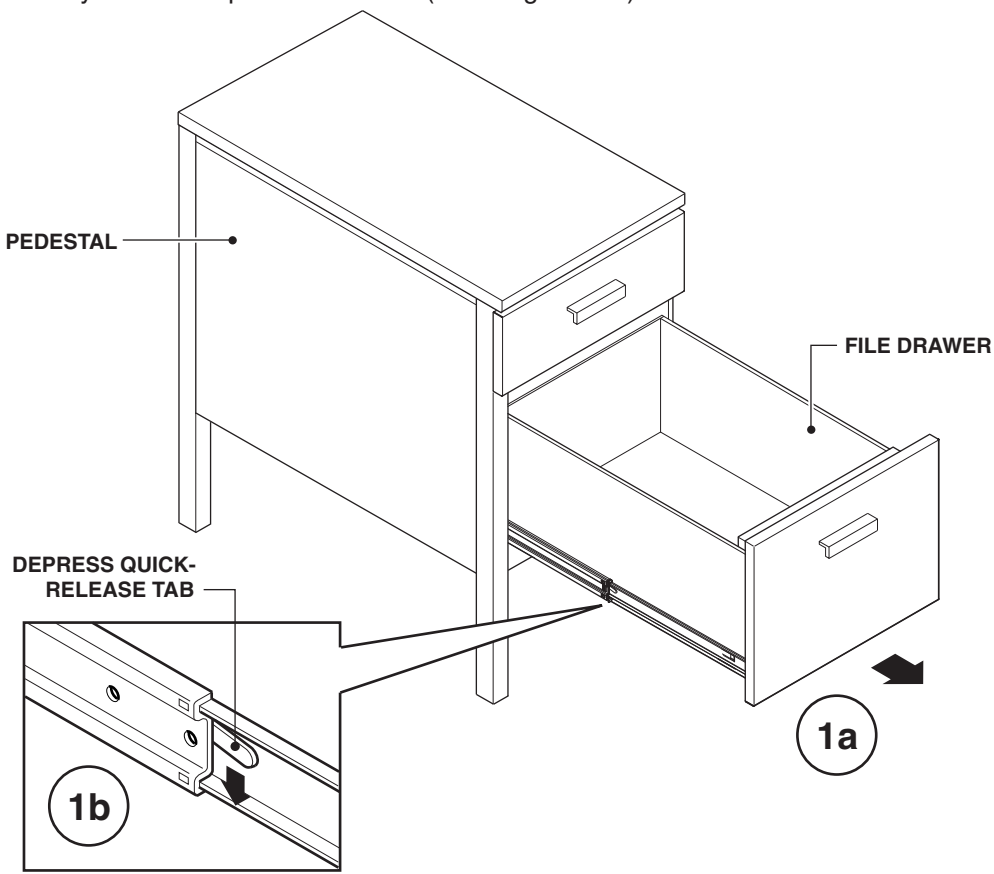
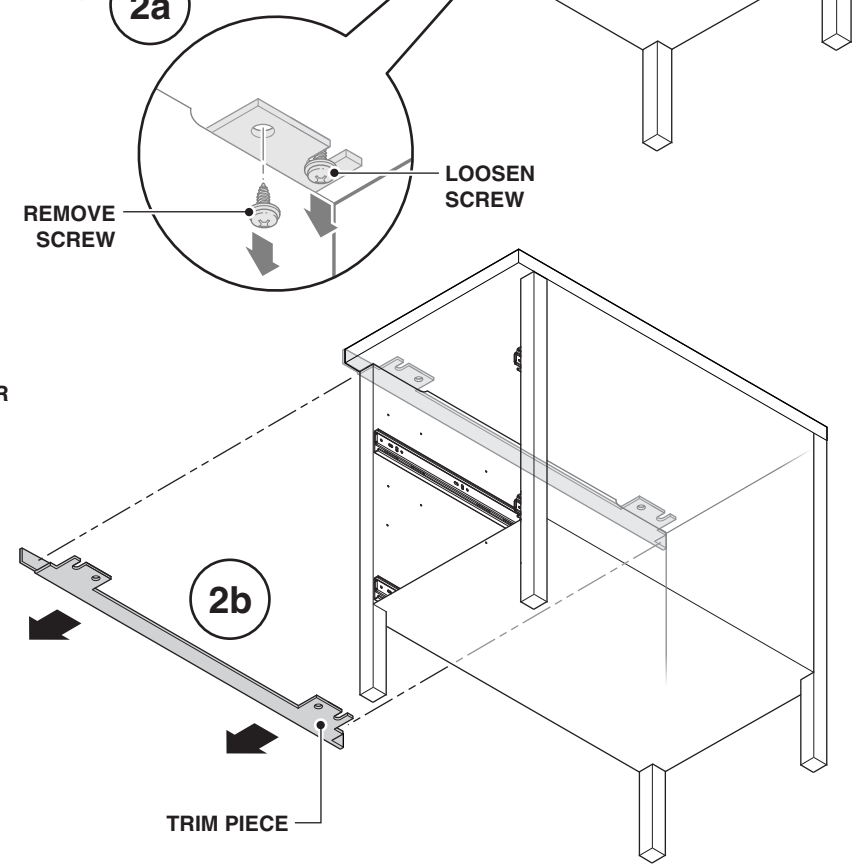
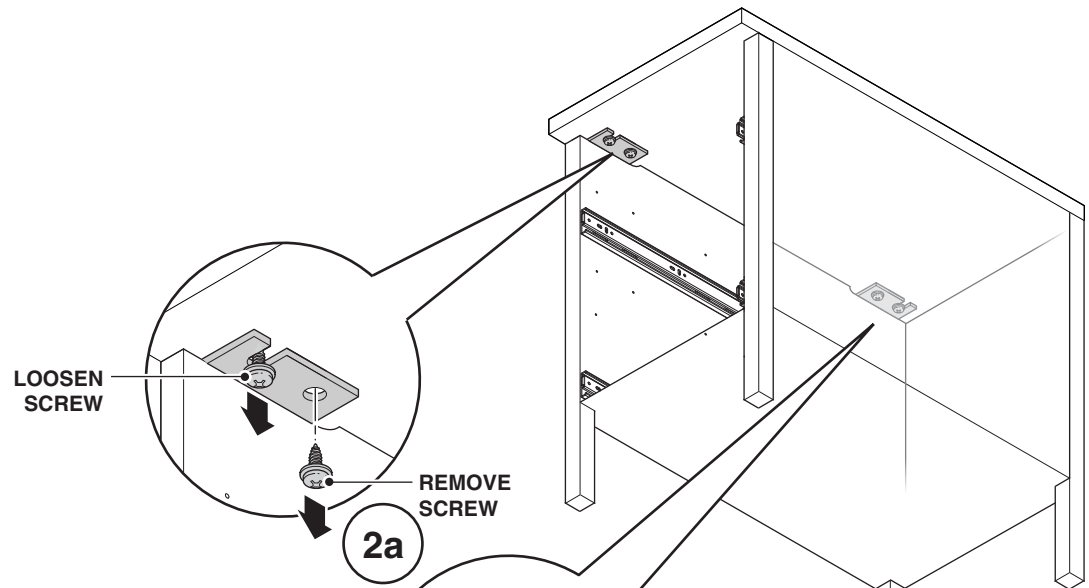

**3.** Insert the pedestal attachment bracket where the trim piece was (3a). Use the same screws that held the trim piece to secure the new pedestal attachment bracket (3b). Place drawers back into pedestal.

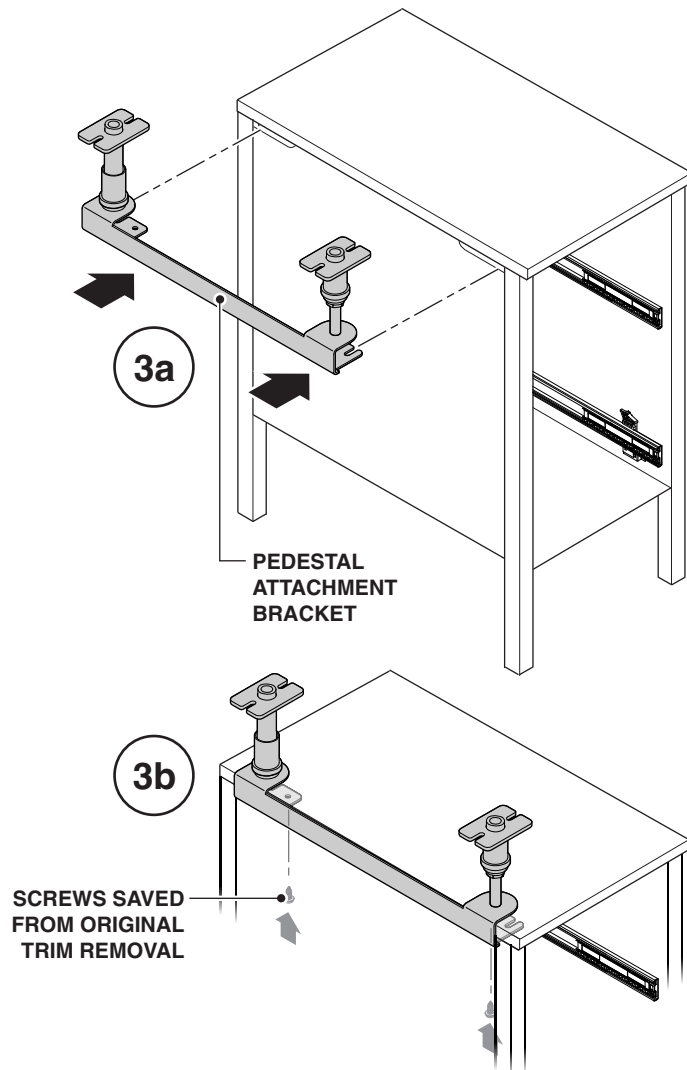

**4.** Turn the work surface upside down.

**TIP:** Place the notched end of the work surface near the pedestal as shown.

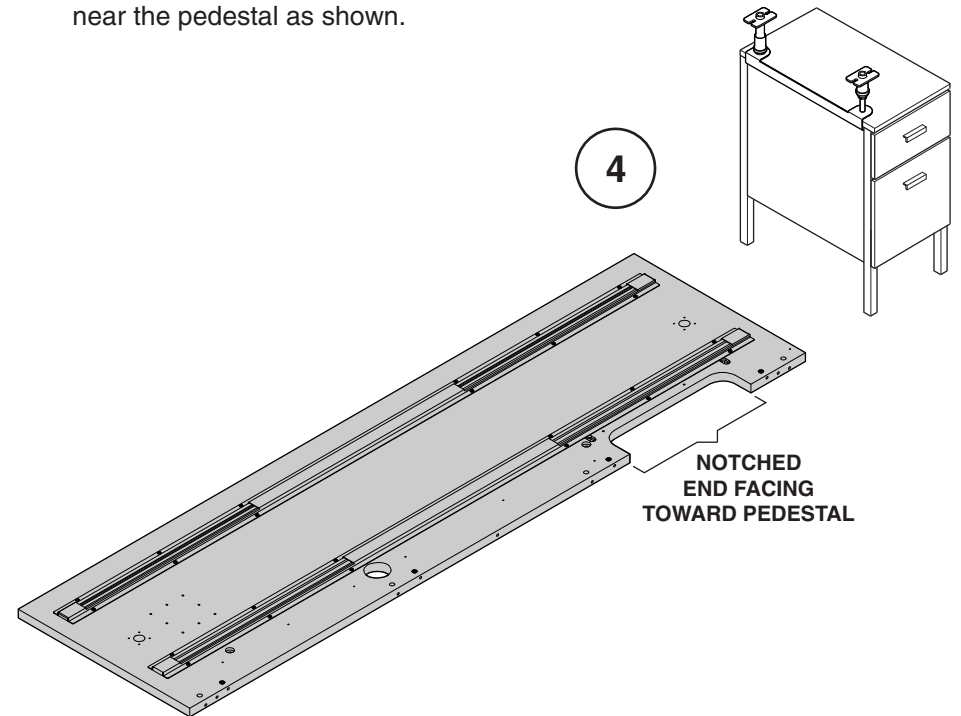

**5.** Attach the base (5a) and hyperglide (5b). Install cams to the correct depth by pushing the cam to the bottom of the hole (there are two different depths) and in the correct orientation (with arrow pointing in the direction of the corresponding hole) (5c). Attach modesty panel (if you have one) (5d) and the PVD box (5e). You will not be able to use the fasteners that attach to the backsplash at this point.

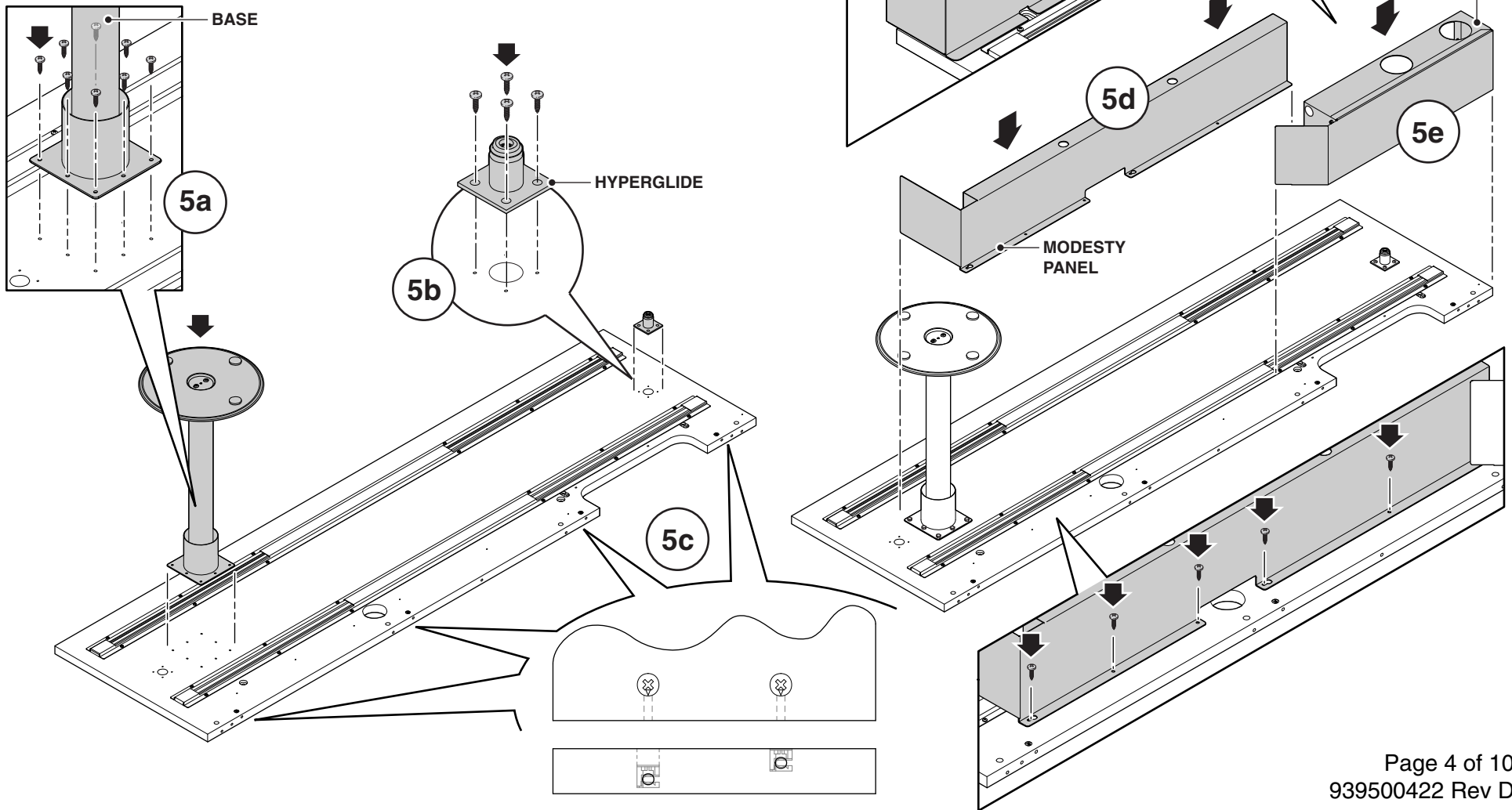

**NOTE:** Adjust hyperglide to contact the top of the storage unit.

**6.** Place the t-nuts onto the pedestal attachment bracket loosely and orient as shown (6a). Flip workstation onto pedestal attachment bracket (6b). The tube ends of the clamp and t-nuts should fit into the slots in the rails: A to A and B to B (6c). Slide pedestal along rails to desired location. Lift and turn t-nuts 90° then tighten.

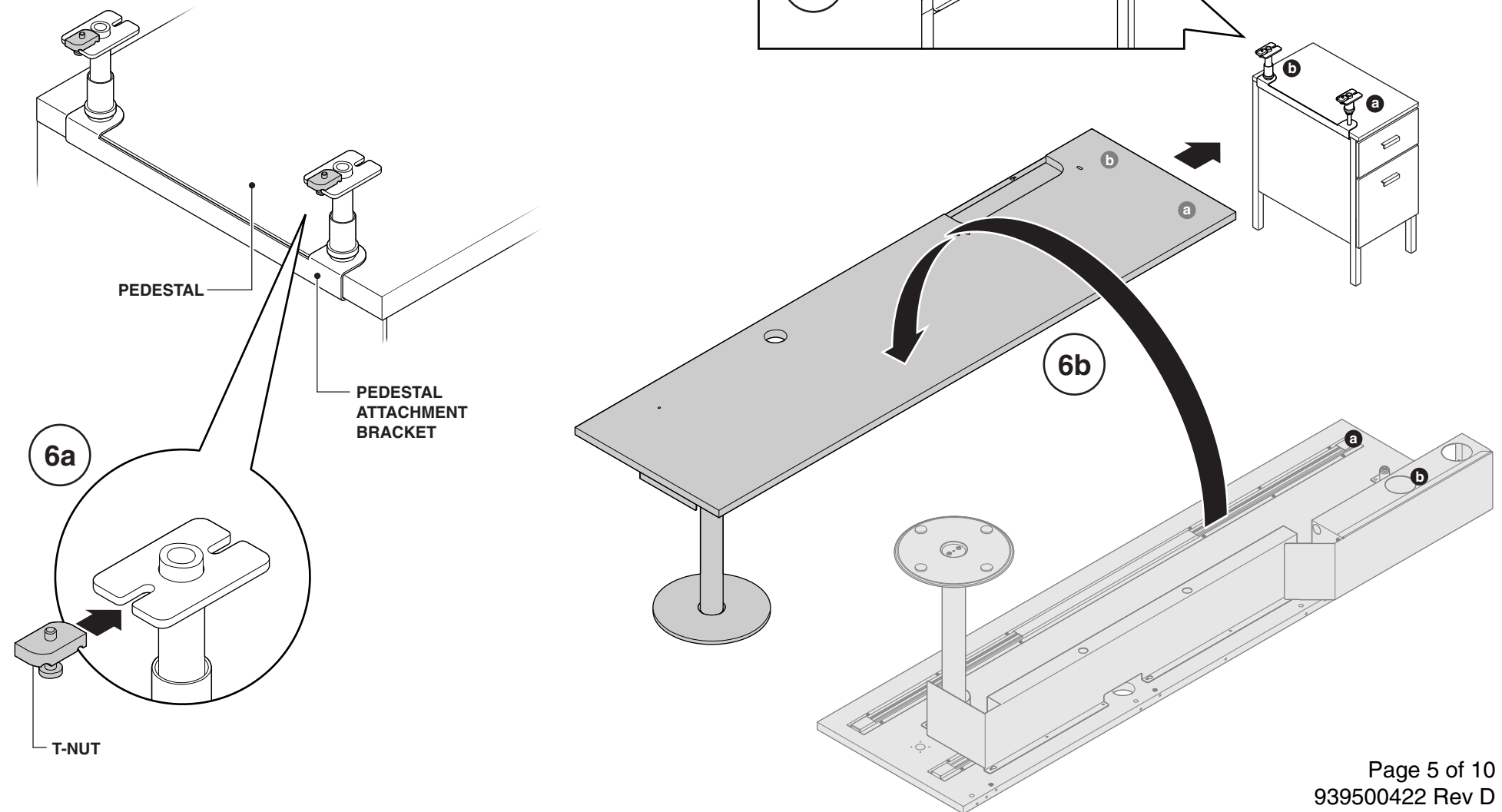

**NOTE:** If a power strip has been ordered, install per the installation instructions with the power strip before step 7.

**7.** Insert dowels (lightly hammer into place) and pins into holes on backsplash (7a). Align the backsplash with rear of worksurface (7b). Locate cams underneath back of worksurface and turn each about a 1/2 turn clockwise to secure backsplash to worksurface (7c).

**8.** Drive remaining screw for PVD box into backsplash.

**TIP:** Remaining screw may require the use of a hand phillips screwdriver to tighten.

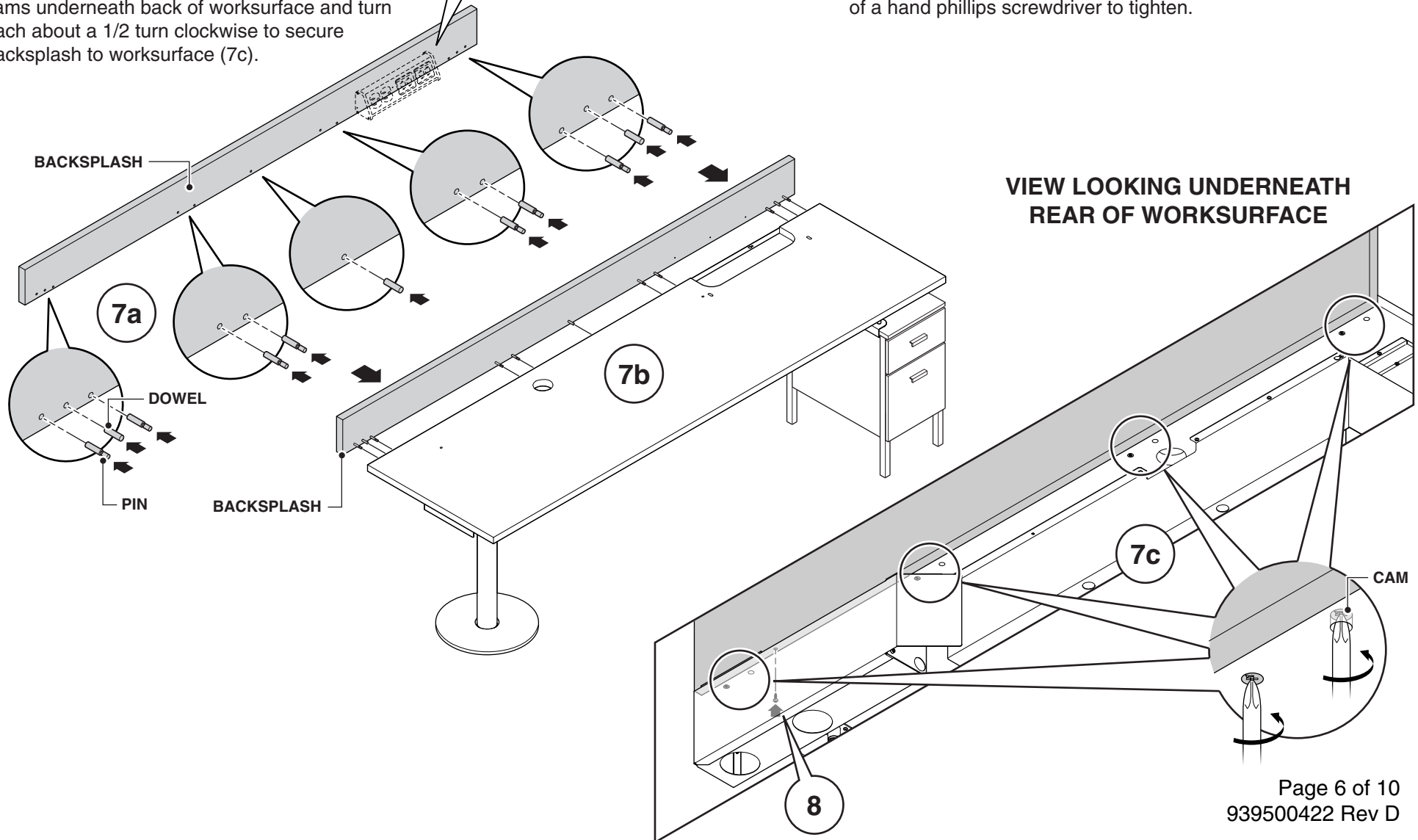

**9.** Slide PVD shelf into fixed shelf assembly (9a). Align entire shelf assembly with worksurface and feed bolts through (9b). Check height of PVD shelf relative to the fixed shelf. If uneven, loosen bolts on bushings, make appropriate adjustments to the height and retighten bolts (9c). Secure bolts to the fixed shelf assembly from underneath worksurface using two (2) hex flange nuts (9d). Locate PVD shelf relative to fixed shelf by aligning front (9e) and secure remaining bolts to the PVD shelf from underneath worksurface using two (2) hex flange nuts (9f). Do not over tighten. Reach under PVD top and place provided bumpers on PVD shelf bracket as shown (9g).

**NOTE:** You may need to adjust workstation to its longest length in order to access the hex flange nuts.

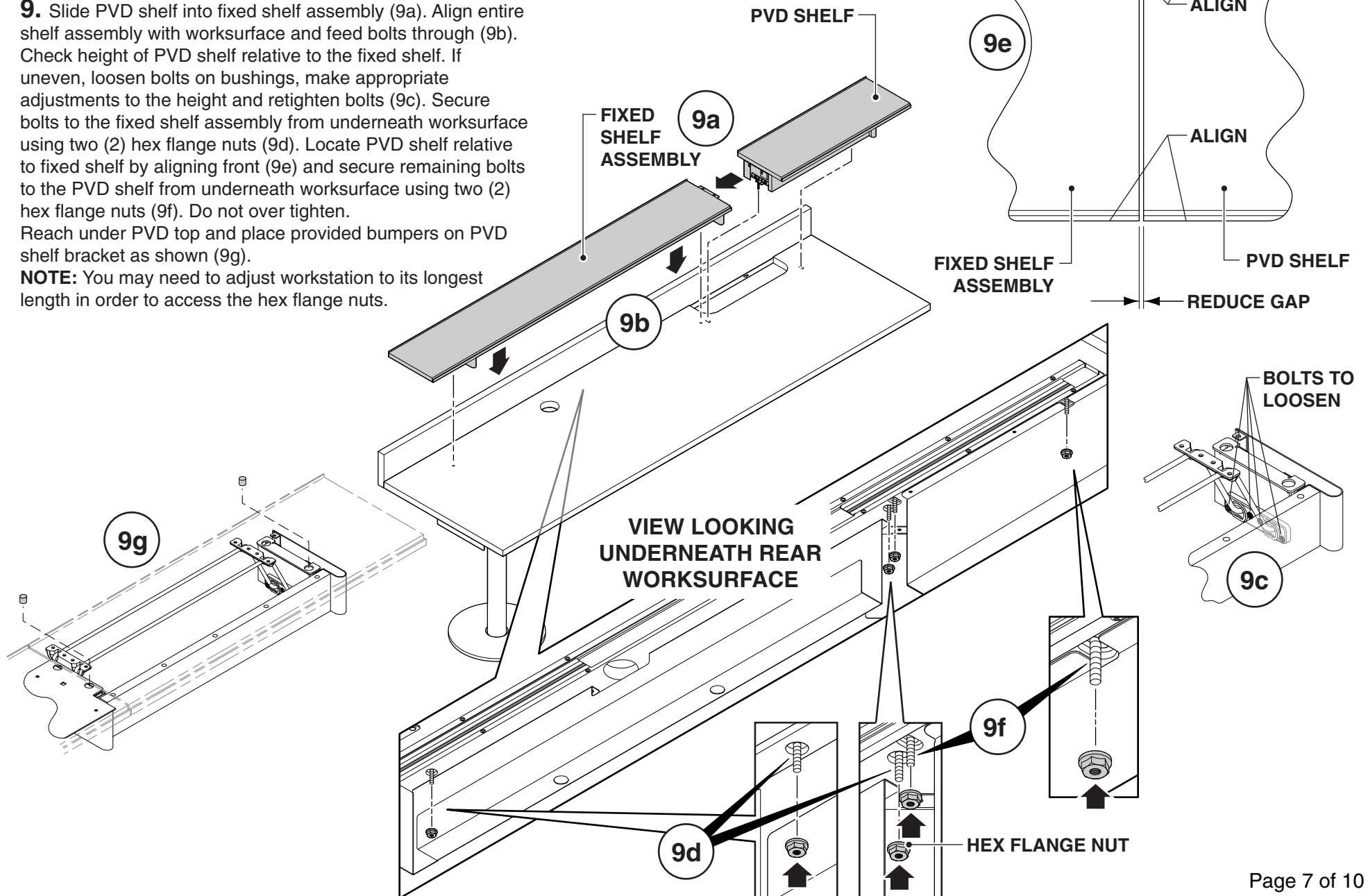

**10.** Adjust table to desired height by locating each clamp on the pedestal attachment bracket and performing steps 10a through 10d. Place level onto worksurface (10e). Lift table and spin leg clockwise to extend or counter-clockwise to retract. Repeat on extension.

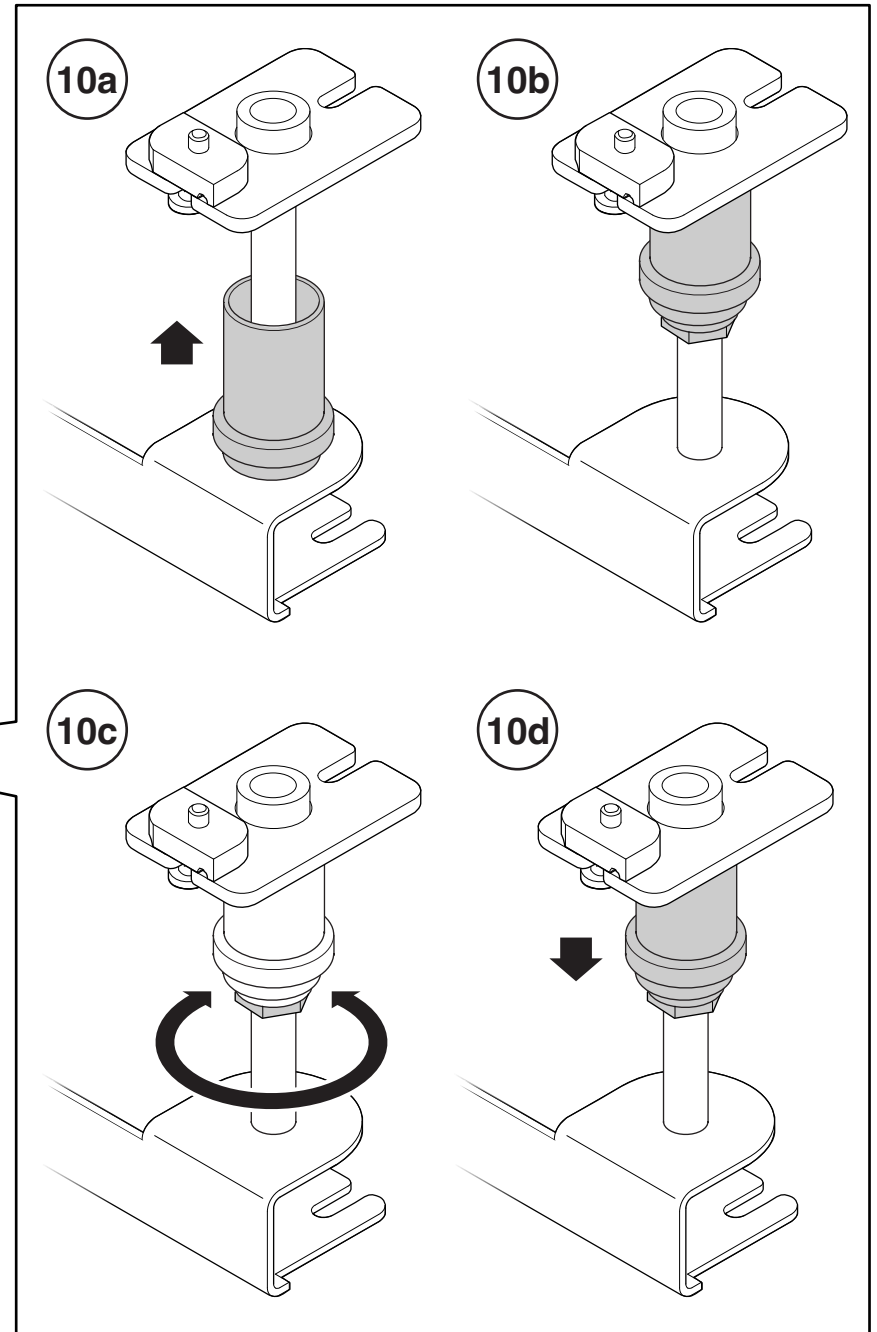
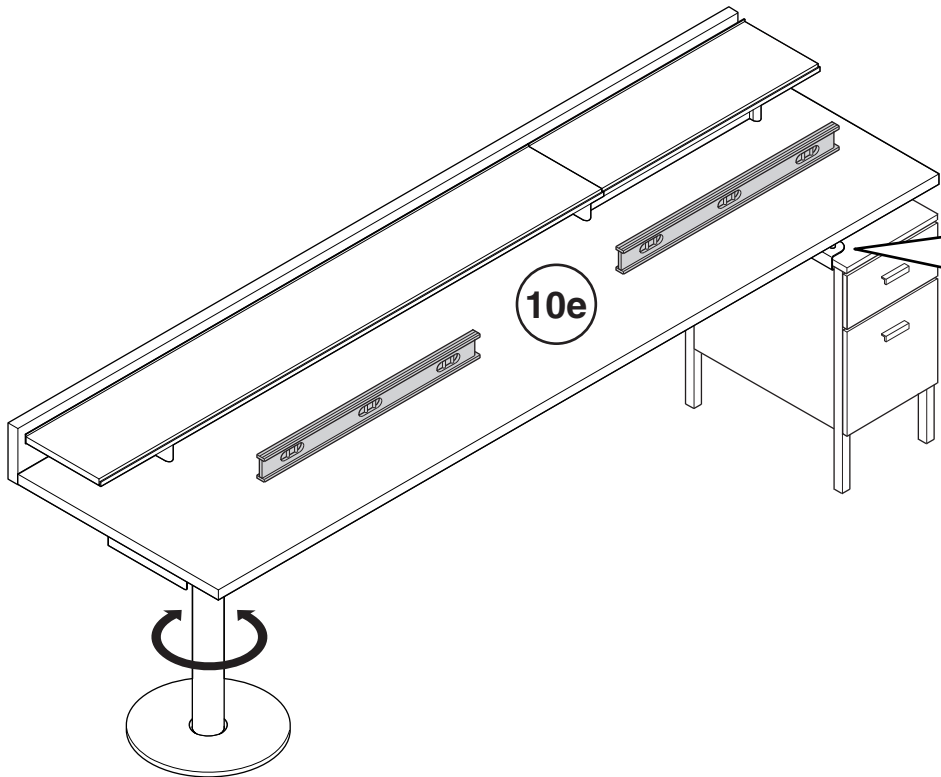

## Attaching the Worksurface Extension

1. Turn the extension worksurface upside down.

**TIP:** Place the extension worksurface near the base with the counterbored holes towards the worksurface as shown.

2. Attach the base.

3. Attach the mounting bracket to the underside of the workstation as shown.

4. Turn the extension worksurface assembly upright and install the tite-joint fasteners per the hardware manufacturer's instructions.

5. Attach the extension worksurface into position by inserting two (2) screws through the mounting bracket and into the pilot holes on the underside of the extension worksurface.

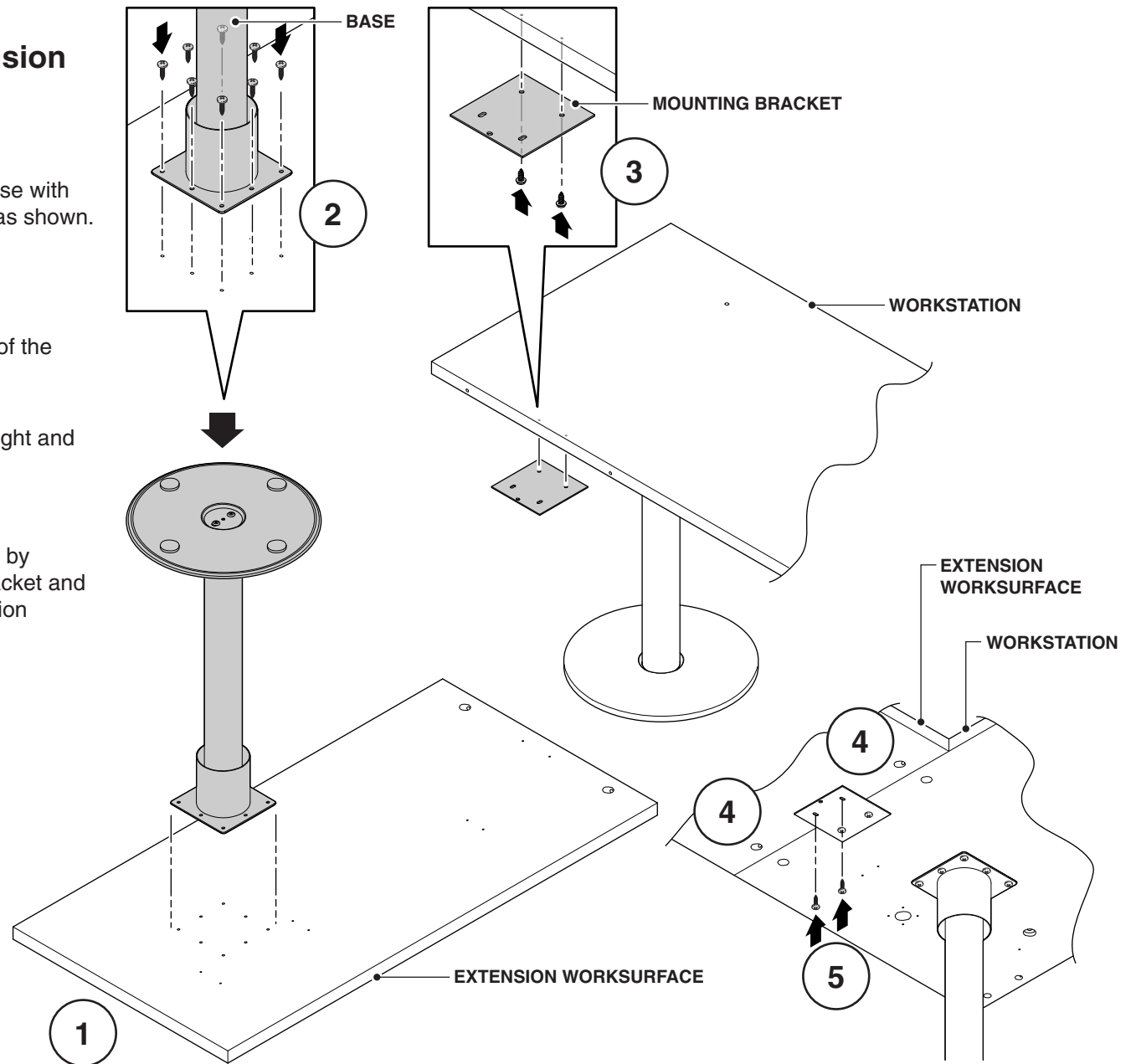

## Attaching the Storage Extension Worksurface

**1.** Turn the storage extension worksurface upside down.

**TIP:** Place the storage extension worksurface near the base with the counterbored holes towards the worksurface as shown.

**2.** Attach the mounting bracket to the underside of the workstation as shown.

**3.** Turn the storage extension worksurface assembly upright and install the tite-joint fasteners per the hardware manufacturer's instructions.

**4.** Attach the storage extension worksurface into position by inserting two (2) screws through the mounting bracket and into the pilot holes on the underside of the storage extension worksurface.

