



PRODUCT SHEET

AMMA 6060

60 x 60 x 21

Redefined massage. Ideal comfort.



© BAINULTRA®

FEATURES

Installation type	- Drop-in - Corner
No. of bathers	2
Raised seats	2
Heated backrests (Independently controlled)	2
Heated headrests	2
Inverted V	2
Armrests	2
Grab bar (color match)	1
Control	MiaPlus
ThermoMasseur® bath	\$
Soaker bath	N/A

THERAPIES

Chromatherapy 3-LED	\$
Sound Therapy (Euphonia™ System)	\$

COLORS

Standards



Optionals



WARRANTY

Controls*	5 years
Bath & turbine*	20 years

*Some restrictions apply | www.bainultra.com/warranty



IMPORTANT: KEEP THE ORIGINAL. PLEASE MAKE COPIES.

AMMA®: AMMA 6030, AMMA 6032, AMMA 6036, AMMA 6636, AMMA OVAL 6638, **AMMA 6060**, AMMA 7048, AMMA 7236, AMMA 7242, AMMA OVAL 7242, AMMA OVAL 7242 FREESTANDING

 **BainUltra®**

The quest for your wellness™
www.bainultra.com

AMMA 6060 60 x 60 x 21

ACCESSORIES - OPTIONAL

Skirt	SJ-3 CR AMMA 6060	\$
Clear acrylic grab bars	With Chrome, Brass or Brushed nickel inserts	\$
Drain & overflow	D-11 (22" - 27")	
	- Chrome	\$
	- White, Biscuit, Bone	\$
	- Brass	\$
	- Brushed nickel, Polished nickel, Oil-rubbed bronze	\$

Control	MiaMulti	\$
Cutting template	# 90000040	
Other	Optional tile flange. (specify right or left)	\$

TOTAL PRICE \$

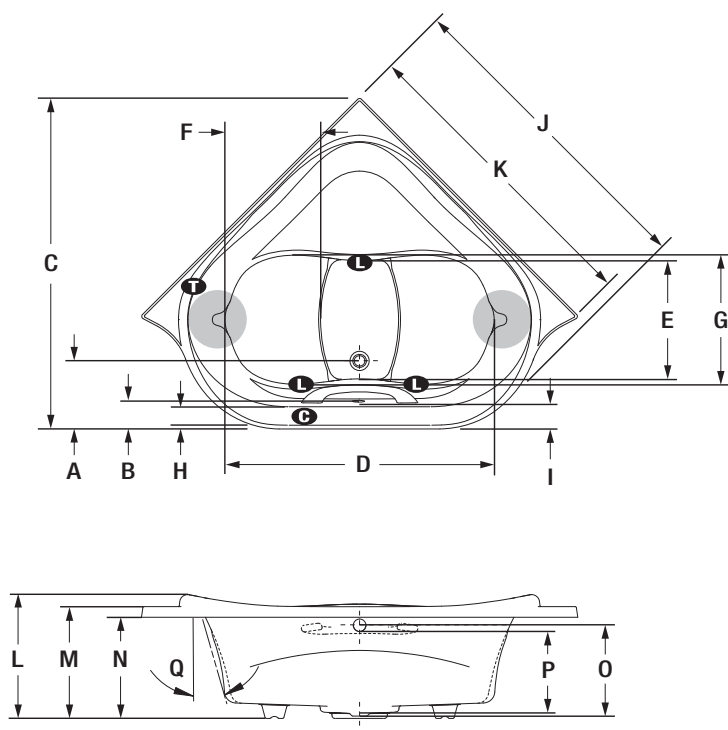

LETTER	DESCRIPTION	MEASURE
A	Outside edge to center drain	12 3/4"
B	Outside edge to overflow	4 7/8"
C	Total length	61 3/4"
D	Bathing well length	50 3/4"
E	Bathing well width at foot area	22"
F	Raised seat length	18"
G	Raised seat width	24"
H	Flat surface width	3 1/4"
I	Deck width	4 5/8"
J	Length from sidewall to front curve	59 1/2"
K	Sidewall length	58"
L	Total height to headrest	23 1/2"
M	Height from bottom of tub to top deck	21 1/4"
N	Height from bottom of tub to bottom of lip	19 1/4"
O	Height from drain to center of overflow	17"
P	Maximum water level	15 3/8"
Q	Slope of backrest	18°

T Indicates turbine position
● Indicates heated backrest
L Indicates LED light position
C Indicates control position when factory-installed

AMMA 6060 TECHNICAL SPECIFICATIONS

Jets	55	Hot water supply required	Should be 70% of water capacity of tub or greater.
US gallons	64		
Imp. gallons	54		
Approx. shipping weight	210 lbs	Turbine access	Must be at least 18" X 22" to access the pump. Must be connected to a 20 A, 120 V, 60 Hz, protected by a ground-fault circuit interrupter (GFCI) on a dedicated line.
Turbine power	755 W		
Air heater	1000 W	Standards	All BainUltra products meet and/or exceed the highest quality and certification standards. For further details about BainUltra's product standards, please go to the following link: (www.bainultra.com/standards).
			Our products must be installed by certified professionals only and according to our Owner's Manual as well as federal, provincial/state and local building codes and regulations (www.bainultra.com/documentation).

1 800 463.2187 | From 8 a.m. to 8 p.m. Monday to Thursday (EST) . From 8 a.m. to 5 p.m. on Friday (EST)

The specifications shown indicate the outer edge dimension and the inside bathing capacity dimension measured at air jets' height. The manufacturer accepts a 1/4" [0.64 cm] variance. There are variations on each product and specifications are subject to change as we improve upon our product as required. The dimensions needed for site preparation and structure building will differ. BainUltra® assumes no responsibility for preparatory work done prior to the product being on site.