



PRODUCT SHEET

PRO-MERIDIAN 55

66 x 34 x 20

Versatile by design.



© BAINULTRA®

FEATURES

Installation type	<ul style="list-style-type: none"> - Drop-in - Alcove (3 walls) - Undermount
No. of bathers	1
Heated backrest	1
Control	MiaPlus
ThermoMasseur® bath	\$
Soaker bath	\$

THERAPIES

Chromatherapy 2-LED	\$
Sound Therapy (Euphonia™ System)	\$

COLORS

Standards



Optionals



WARRANTY

Controls*	5 years
Bath & turbine*	20 years
*Some restrictions apply www.bainultra.com/warranty	



IMPORTANT: KEEP THE ORIGINAL. PLEASE MAKE COPIES.

MERIDIAN™: ELLIPSE 6036, ELLIPSE 7240, ELLIPSE 7842, MERIDIAN 50, MERIDIAN 55, MERIDIAN 60, PRO-MERIDIAN 55, PRO-MERIDIAN 60

 **BainUltra®**

The quest for your wellness™
www.bainultra.com

PRO-MERIDIAN 55 66 x 34 x 20

ACCESSORIES - OPTIONAL

Skirts	Littora \$	Elegance \$
Drain & overflow	D-10 (17" - 22") - Chrome - White, Biscuit, Bone - Brass - Brushed nickel, Polished nickel, Oil-rubbed bronze	 \$ \$ \$ \$

Control	MiaMulti \$
Cutting template	# 90000012
Others	- Optional tile flange. \$ (specify right or left) - If ordered with an installed tile flange, the control will be shipped separately.

TOTAL PRICE

\$

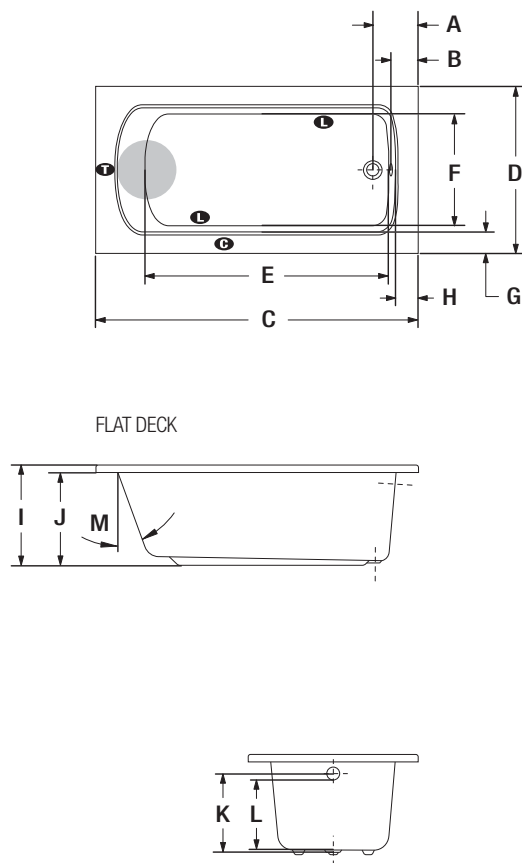

LETTER	DESCRIPTION	MEASURE
A	Outside edge to center drain	9 1/4"
B	Outside edge to overflow	5"
C	Total length	65 3/4"
D	Total width	34"
E	Bathing well length	49 3/4"
F	Bathing well width	22 1/2"
G	Deck width	3 7/8"
H	Deck width	4 1/4"
I	Height from bottom of tub to top deck	20"
J	Height from bottom of tub to bottom of lip	18 1/2"
K	Height from drain to center of overflow	15 7/8"
L	Maximum water level	14 1/4"
M	Slope of backrest	22°

T Indicates turbine position
● Indicates heated backrest

L Indicates LED light position
C Indicates control position when factory-installed

PRO-MERIDIAN 55 TECHNICAL SPECIFICATIONS

Jets	44	Hot water supply required	Should be 70% of water capacity of tub or greater.
US gallons	55	Turbine access	Must be at least 18" X 22" to access the pump. Must be connected to a 15 A. 120 V, 60 Hz, protected by a ground-fault circuit interrupter (GFCI) on a dedicated line.
Imp. gallons	46	Standards	All BainUltra products meet and/or exceed the highest quality and certification standards. For further details about BainUltra's product standards, please go to the following link: (www.bainultra.com/standards).
Approx. shipping weight	131 lbs	Our products must be installed by certified professionals only and according to our Owner's Manual as well as federal, provincial/state and local building codes and regulations (www.bainultra.com/documentation).	
Turbine power	755 W		
Air heater	700 W		

1 800 463.2187 | From 8 a.m. to 8 p.m. Monday to Thursday (EST) . From 8 a.m. to 5 p.m. on Friday (EST)

The specifications shown indicate the outer edge dimension and the inside bathing capacity dimension measured at air jets' height. The manufacturer accepts a 1/4" [0.64 cm] variance. There are variations on each product and specifications are subject to change as we improve upon our product as required. The dimensions needed for site preparation and structure building will differ. BainUltra® assumes no responsibility for preparatory work done prior to the product being on site.