

PRODUCT SHEET



THALASSA 55

66 x 33 x 19

Convenience comes standard.



© BAINULTRA®

FEATURES

Installation type	- Drop-in - Alcove (3 walls)
No. of bathers	1
Heated backrest	1
Armrests	2
Grab bars (color match)	2
Control	Mia
ThermoMasseur® bath	\$
Soaker bath	\$

THERAPIES

Chromatherapy 2-LED⁺	\$
Sound Therapy⁺ (Euphonia™ System)	\$

COLORS

Standards

White	Bone	Biscuit	Almond

Optionals

Black	Mexican sand	Innocent blush	Cashmere	Sandbar	Grey

WARRANTY

Controls*	5 years
Bath & turbine*	20 years

*Some restrictions apply | www.bainultra.com/warranty



IMPORTANT: KEEP THE ORIGINAL. PLEASE MAKE COPIES.

THALASSA: SENSATION, THALASSA 50, THALASSA 55, THALASSA 60

BainUltra®

The quest for your wellness™
www.bainultra.com

THALASSA 55 66 x 33 x 19

ACCESSORIES - OPTIONAL

Skirts	Littora \$	Elegance \$
Clear acrylic grab bars	With Chrome, Brass or Brushed nickel inserts \$	
Drain & overflow	D-10 (17" - 22")	
	- Chrome	\$
	- White, Biscuit, Bone	\$
	- Brass	\$
	- Brushed nickel, Polished nickel, Oil-rubbed bronze	\$

Control	MiaPlus \$ * Included when purchasing these options
Other	Optional tile flange. \$ (specify right or left)

TOTAL PRICE \$

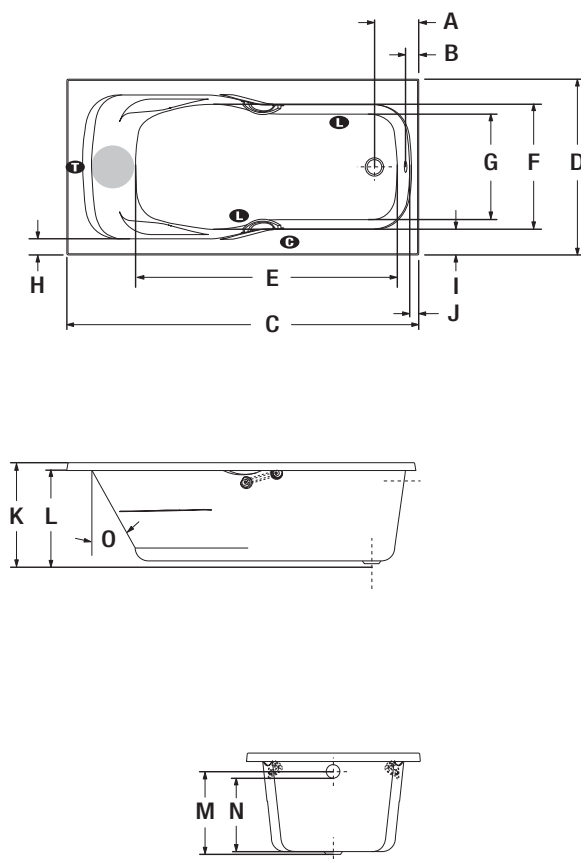

LETTER	DESCRIPTION	MEASURE
A	Outside edge to center drain	8"
B	Outside edge to overflow	2 1/4"
C	Total length	65 3/4"
D	Total width	32 7/8"
E	Bathing well length	49"
F	Bathing well width at seat area	23 1/8"
G	Bathing well width at foot area	19 7/8"
H	Deck width (narrowest point)	3 1/4"
I	Deck width (widest point)	5"
J	Deck width	2 1/8"
K	Height from bottom of tub to top deck	19 1/2"
L	Height from bottom of tub to bottom of lip	18"
M	Height from drain to center of overflow	15 5/8"
N	Maximum water level	13 3/4"
O	Slope of backrest	29°

T Indicates turbine position
L Indicates LED light position
C Indicates control position when factory-installed

THALASSA 55 TECHNICAL SPECIFICATIONS

Jets	40	Hot water supply required	Should be 70% of water capacity of tub or greater.
US gallons	50	Turbine access	Must be at least 18" X 22" to access the pump. Must be connected to a 15 A. 120 V, 60 Hz, protected by a ground-fault circuit interrupter (GFCI) on a dedicated line.
Imp. gallons	41	Standards	All BainUltra products meet and/or exceed the highest quality and certification standards. For further details about BainUltra's product standards, please go to the following link: (www.bainultra.com/standards).
Approx. shipping weight	126 lbs	Our products must be installed by certified professionals only and according to our Owner's Manual as well as federal, provincial/state and local building codes and regulations (www.bainultra.com/documentation).	
Turbine power	755 W		
Air heater	700 W		

1 800 463.2187 | From 8 a.m. to 8 p.m. Monday to Thursday (EST) . From 8 a.m. to 5 p.m. on Friday (EST)

The specifications shown indicate the outer edge dimension and the inside bathing capacity dimension measured at air jets' height. The manufacturer accepts a 1/4" [0.64 cm] variance. There are variations on each product and specifications are subject to change as we improve upon our product as required. The dimensions needed for site preparation and structure building will differ. BainUltra® assumes no responsibility for preparatory work done prior to the product being on site.