

PRODUCT SHEET

**TMU 6060**

60 x 60 x 21

*An advanced bath. A better massage.*



© BAINULTRA®

## FEATURES

Installation type	- Drop-in - Corner
No. of bathers	2
Raised seats	2
Heated backrest	1
Heated headrest	1
Inverted V	2
Armrests	2
Grab bars (color match)	2
Wood seat - shelf	Included
Control	MiaPlus
ThermoMasseur® bath	\$
Soaker bath	N/A

## THERAPIES

Chromatherapy 3-LED	\$
Sound Therapy (Euphonia™ System)	\$

## COLORS

### Standards

White	Bone	Biscuit	Almond

### Optionals

Black	Mexican sand	Innocent blush	Cashmere	Sandbar	Grey

## WARRANTY

Controls*	5 years
Bath & turbine*	20 years
*Some restrictions apply   <a href="http://www.bainultra.com/warranty">www.bainultra.com/warranty</a>	



**IMPORTANT: KEEP THE ORIGINAL. PLEASE MAKE COPIES.**

TMU: TMU 2500, TMU 2550, TMU 2600, TMU 2602, TMU 2650, TMU 2702, TMU 5454, **TMU 6060**

**BainUltra®**

The quest for your wellness™  
[www.bainultra.com](http://www.bainultra.com)

# TMU 6060 60 x 60 x 21

## ACCESSORIES - OPTIONAL

Skirt	(Step with wood insert)	(Without step)
	SJ-3 TMU 6060 \$	\$
Step (alone)	With wood insert	\$
Clear acrylic grab bars	With Chrome, Brass or Brushed nickel inserts	\$
Drain & overflow	D-10 (17" - 22") - Chrome - White, Biscuit, Bone - Brass - Brushed nickel, Polished nickel, Oil-rubbed bronze	\$ \$ \$ \$ \$

<b>Control</b>	MiaMulti	\$
<b>Cutting template</b>	# 90000027	
<b>Others</b>	- Optional tile flange. \$ (specify right or left) - Overall dimensions are 62 7/8" x 62 7/8" (see drawing for details).	

**TOTAL PRICE** \$

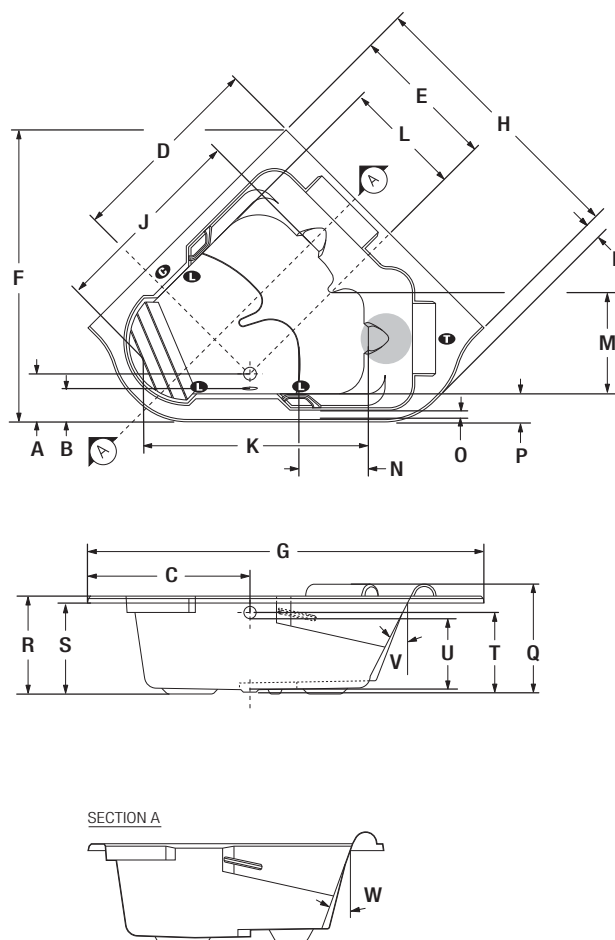

LETTER	DESCRIPTION	MEASURE
<b>A</b>	Outside edge to center drain	12 3/8"
<b>B</b>	Outside edge to overflow	6 1/2"
<b>C</b>	Sidewall to center drain	34 3/4"
<b>D</b>	Sidewall to center drain	41"
<b>E</b>	Sidewall to center drain	29 7/8"
<b>F</b>	Total length	62"
<b>G</b>	Total width	83 3/4"
<b>H</b>	Sidewall length	59 3/4"
<b>I</b>	Length from sidecorner to front curve	3 1/8"
<b>J</b>	Bathing well length	44"
<b>K</b>	Bathing well length	50"
<b>L</b>	Bathing well width	21 3/4"
<b>M</b>	Bathing well width	19 1/4"
<b>N</b>	Raised seat length	18 1/2"
<b>O</b>	Deck width (narrowest point)	1 5/8"
<b>P</b>	Deck width (widest point)	6"
<b>Q</b>	Total height to headrest	23 5/8"
<b>R</b>	Height from bottom of tub to top deck	21"
<b>S</b>	Height from bottom of tub to bottom of lip	19 1/2"
<b>T</b>	Height from drain to center of overflow	16 7/8"
<b>U</b>	Maximum water level	15 1/8"
<b>V</b>	Slope of backrest	30°
<b>W</b>	Slope of backrest	23°

**T** Indicates turbine position  
**●** Indicates heated backrest

**L** Indicates LED light position  
**C** Indicates control position when factory-installed

## TMU 6060 TECHNICAL SPECIFICATIONS

<b>Jets</b>	58
<b>US gallons</b>	67
<b>Imp. gallons</b>	56
<b>Approx. shipping weight</b>	191 lbs
<b>Turbine power</b>	755 W
<b>Air heater</b>	700 W

### Hot water supply required

Should be 70% of water capacity of tub or greater.

### Turbine access

Must be at least 18" X 22" to access the pump. Must be connected to a 15 A. 120 V, 60 Hz, protected by a ground-fault circuit interrupter (GFCI) on a dedicated line.

### Standards

All BainUltra products meet and/or exceed the highest quality and certification standards. For further details about BainUltra's product standards, please go to the following link: ([www.bainultra.com/standards](http://www.bainultra.com/standards)).

Our products must be installed by certified professionals only and according to our Owner's Manual as well as federal, provincial/state and local building codes and regulations ([www.bainultra.com/documentation](http://www.bainultra.com/documentation)).

1 800 463.2187 | From 8 a.m. to 8 p.m. Monday to Thursday (EST) . From 8 a.m. to 5 p.m. on Friday (EST)

The specifications shown indicate the outer edge dimension and the inside bathing capacity dimension measured at air jets' height. The manufacturer accepts a 1/4" [0.64 cm] variance. There are variations on each product and specifications are subject to change as we improve upon our product as required. The dimensions needed for site preparation and structure building will differ. BainUltra® assumes no responsibility for preparatory work done prior to the product being on site.