

bridges | connect
share
achieve



INSTALLATION GUIDE

Effective March, 2013

Structure and Worksurfaces P.01

- Supporting Structure **02**
- Legs and Beams **02**
- Beam Applications **03**
- Telescopic Beam **04**
- 120° **05**
- Storage Table Beam **06**
- Sliding Return **07**
- Round Table Supports **08**
- Pivoting Table Supports **08**

Power, Data and Cable Management P.09

- Power Delivery/Cable Management **09**
- Wire Basket **10**
- Below Worksurface Power Trough **10**
- Below Worksurface Power Trough Installation **10**
- Power Trough Supporting Structure **11**
- Power Trough 120° Installation **11**
- Power Trough Electric Components **12**
- Above Worksurface Power Trough **15**
- Ceiling Feed **16**
- Power Distribution Storage **17**

Accessories P.18

Dividers

- Back-to-Back **17**
- Side-to-Side **19**
- Parallel with modesty panel **19**
- Perpendicular end of run **20**
- Modesty panel **20**
- Leg Gable **21**

Storage P.22

- Shelves **22**
- Elevated **22**
- Storage Spine **23**

Bridges II

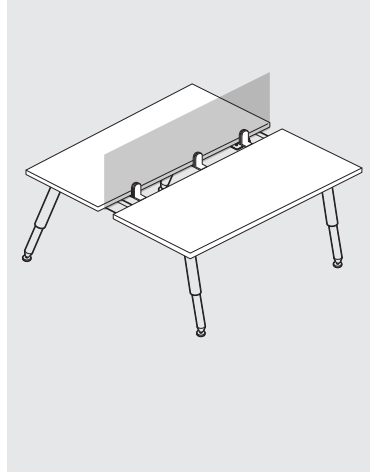

Required Tools

Safety Glasses



Wrench



Allen Key

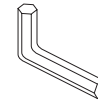

Flathead Screwdriver

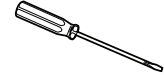

Phillips Screwdriver



Bridges II Installation Sequence

NOTE: Although some illustrations depict round legs and some rectangular legs, the leg-to-beam and leg-to-worksurface assembly is the same.

STEP 1: LAYOUT ORIENTATION

Orient the layout plan within the installation area, determine the location of table assemblies, power source and main storage components; establish the highest point on the floor.

STEP 2: SUPPORTING STRUCTURE - legs, supporting beams

Identify type and size of required components and position them in accordance with layout plans. Proceed with connecting legs and structural beams (see the following pages for detailed instructions). Make sure that all rails are leveled and securely connected before proceeding with installation of worksurfaces.

STEP 3: WORKSURFACES

STEP 4: ACCESSORIES - task and paper organizers

Determine type and location of accessories as specified in floor plans. Proceed with installation of accessories.

STEP 5: STORAGE

STEP 6: ELECTRICS and DATA / COMMUNICATION - cable routing; cable management

Connect power feed harness to building power supply; check circuit assignments and functionality of power delivery at each duplex receptacle.

STEP 7: WALK THROUGH / INSTALLATION INSPECTION

Please contact your Global Customer Service Representative at 800-220-1900 for any questions or concerns.

NOTE: Any alterations to listed components will void the manufacturer's warranty. The manufacturer will not be responsible for any damage or bodily harm caused by alterations in accordance with national or local electrical codes and manufacturer's

specifications. In accordance with the manufacturer's policy of continual product improvement, the product presented in this document is subject to change without notice or obligation.

Supporting Structure Round Leg Height Adjustment

Set the legs to desired height.

The inner leg has two threaded holes.

STEP 1: The top threaded hole is typically used to secure legs with levelers.

STEP 2: The lower threaded hole is used for securing legs with casters.

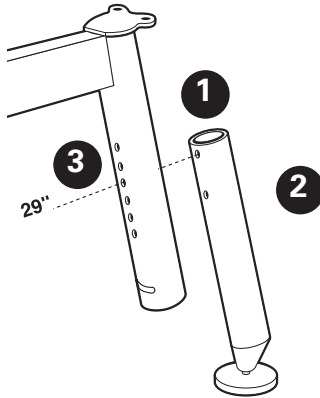

STEP 3: If the desired top surface height is 29" from the floor, for instance, and the table structure is to be on levelers, align top threaded hole in the inner leg (1) with the fourth hole in the table leg (3) as illustrated. When installing legs on casters, align the lower (2) threaded hole in the inner leg with the same fourth hole (3) in the table leg and secure with provided screws.

STEP 4: The height adjustment screws must be only used with the provided, translucent cup/washer.

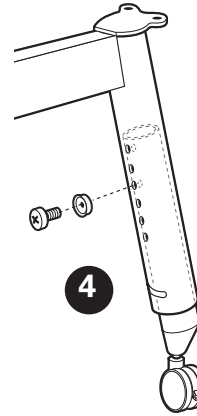

Supporting Legs And Beams

To connect a beam to a leg, identify the correct type (Single, End of run and Interconnect Beam) first - in accordance with your desired table configuration.

STEP 1: Position beam's end bracket over leg's horizontal, rectangular tube.

STEP 2: Secure top and bottom bracket ends with two supplied screws.

Level the whole assembly.

STEP 3: Place worksurfaces on top of table structure, align them and interconnect them using flat brackets.

STEP 4: Align this worksurface assembly with legs and secure with screws. Proceed from one corner to the opposite one.

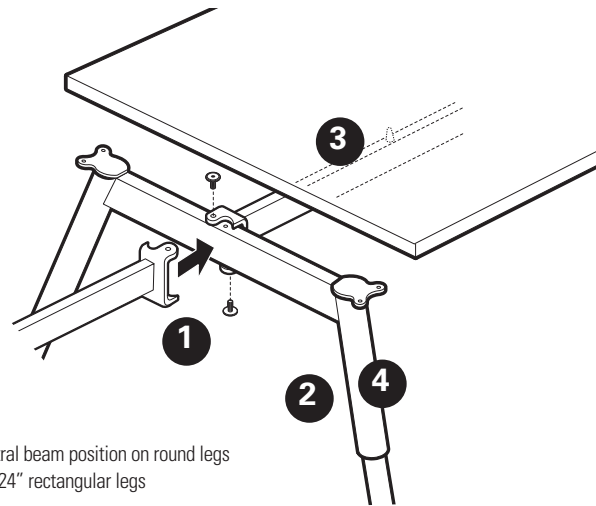

Central beam position on round legs and 24" rectangular legs

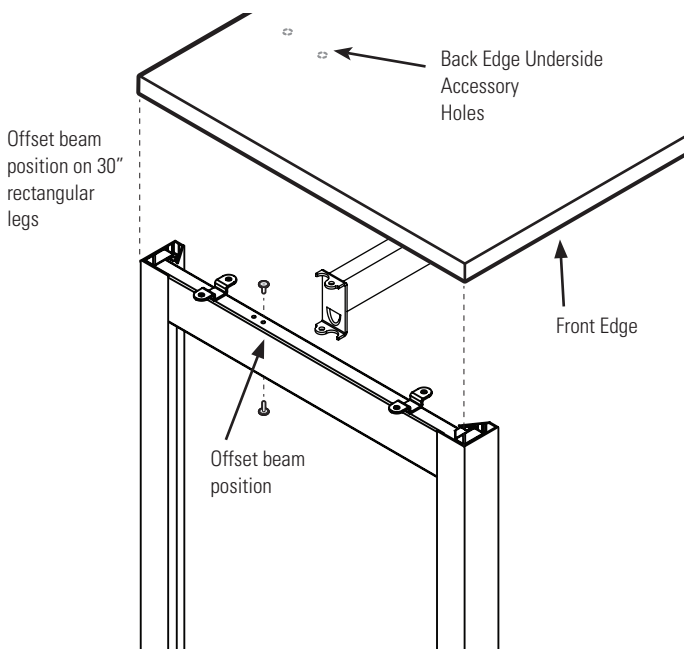

Offset beam position on 30" rectangular legs

Beam Applications

Table supporting structures - BEAMS Legs are connected with supporting beams. There is one beam for a single line of tables while two beams connect back-to-back table structures. There are three types of beams whose application principles are common to building support for single-line and back-to-back table assemblies:

Single table beam Designed to bridge two legs to form support for a single table, or for two back-to-back worksurfaces.

End of run table beam Supports table leg assemblies at the end of a table run, with legs on one side tucked under the worksurface. Longer by 2" than the Single Table Beam, thereby positioning one leg assembly so that it supports two adjoining worksurfaces.

Interconnecting table beam A typical, multiple surface run begins with an End of run beam, continues with Interconnecting beam(s) and finishes with another End of run beam. Also applies to multiple back-to-back Assemblies. Interconnecting beam is designed to bridge space between two table assemblies. Because the interconnecting beam is 4" longer than the standard beam, it spreads supporting legs apart so that both could be shared by adjacent worksurfaces.

Telescopic table beam Supports a return connected perpendicularly to a 24" or 30" deep primary worksurface. The Telescopic beam is connected to a single or back-to-back leg on one side and to any worksurface-supporting beam on the opposite side.

Storage table beam The Storage beam is connected to a single or back-to-back leg on one side and to the worksurface on the opposite side - thus saving one leg assembly (worksurface is connected to storage units with included storage brackets). Storage table beam's flexibility allows for a single table application (with the table leg tucked in under the worksurface) as well as for a double table installation (two adjacent tables supported by a shared leg in the middle and two storage cabinets at the opposite ends).

Storage table beam adapter Connects to Storage table beam. This assembly allows a worksurface to be supported by a leg on one side and a spine (formed by interconnected storage cabinets) on the opposite side.



Telescopic Beam

Designed to provide support for worksurfaces perpendicularly connected to a primary table run. The telescopic beam is connected to the leg's horizontal, rectangular tube on one side, while the opposite side is secured off module to the perpendicular, central beam and can be adjusted to accommodate 24" and 30" deep primary worksurfaces.

STEP 1: Position beam's end bracket over leg's horizontal, rectangular tube.

STEP 2: Secure top and bottom bracket ends with two supplied screws.

STEP 3: Adjust the length of the telescopic beam in accordance with the depth of primary worksurface. Completely contracted beam will support perpendicular side table connected to 24" deep primary worksurface on Round and Rectangular legs. Middle position is intended to support perpendicular side table connected to 30" deep primary worksurface on Round legs. Fully extended telescopic beams supports perpendicular side table connected to 30" deep primary worksurface on Rectangular legs.

STEP 4: Position end bracket of the telescopic beam over the primary, perpendicular beam. Level the whole assembly.

STEP 5: Install primary worksurface.

STEP 6: Secure the secondary worksurface to legs first.

STEP 7: Adjust the secondary worksurface/telescopic beam position.

STEP 8: Secure the worksurfaces with flat brackets.

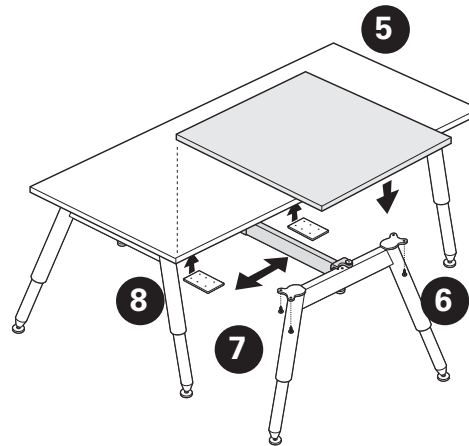
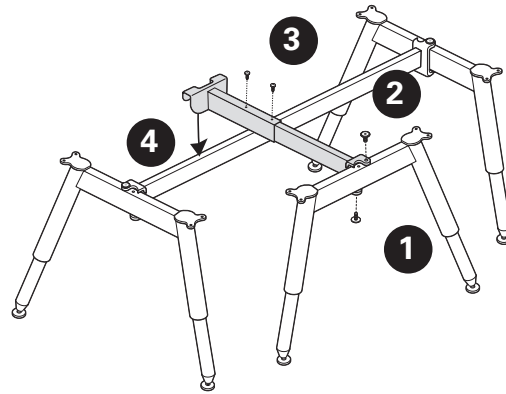

120° Leg

The integrated 120° beam bracket allows for the beam to be mounted in two positions:
 A) end of run leg placement
 B) shared leg placement

Identify the desired leg position (A or B)

STEP 1: Align two mounting holes in beam with two holes in the integrated 120° beam bracket. Position beam's end bracket over leg's horizontal, rectangular tube.

STEP 2: Secure both beams to the integrated 120° beam bracket with four supplied screws.

STEP 3: Position beam's end bracket over leg's horizontal rectangular tube.

STEP 4: Secure top and bottom bracket ends with two supplied screws.

STEP 5: Level the whole assembly.

STEP 6: Install worksurfaces and secure with supplied screws by proceeding from the central, 120° leg to the outside of the assembly in both directions.

NOTE: 24" deep worksurfaces are mounted centrally on top of the table structure. 30" deep worksurfaces are mounted off center, with a longer overhang facing the user.

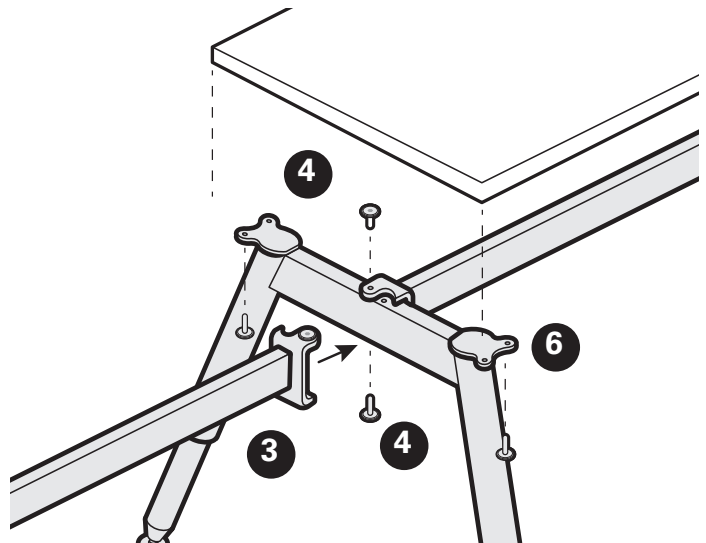
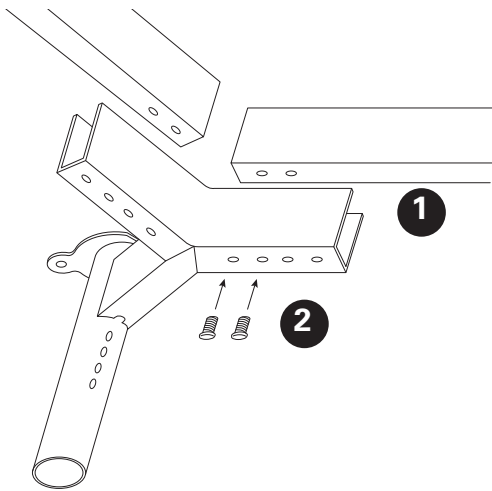
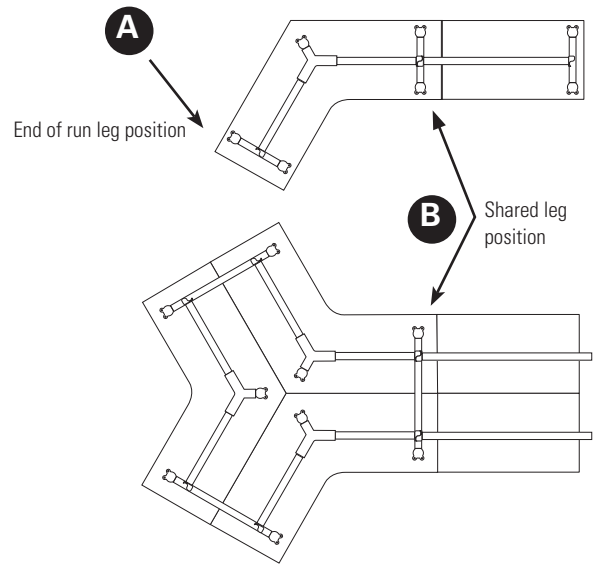

Storage Table Beam

Storage table beam's flexibility allows for a single table application (with the table leg tucked in under the worksurface) as well as for a double table installation (two adjacent tables supported by a shared leg in the middle (A) and two storage cabinets at the opposite ends).

STEP 1: Position beam's end bracket over leg's horizontal, rectangular tube. Use Allen keys to secure top and bottom bracket ends with two supplied screws. Level the whole assembly.

STEP 2: Turn the worksurface upside down on a smooth surface and secure it to the leg/beam subassembly with supplied screws.

STEP 3: Mount two L brackets to the side of Storage tower. Drive two supplied machine screws through the brackets into threaded inserts embedded in the storage tower side panel.

STEP 4: Place the Storage tower in its final location and position the leg/beam/worksurface assembly so that the worksurface rests on the installed L brackets. Ensure that the worksurface and the tower are aligned. Secure the worksurface to the L brackets with supplied screws.

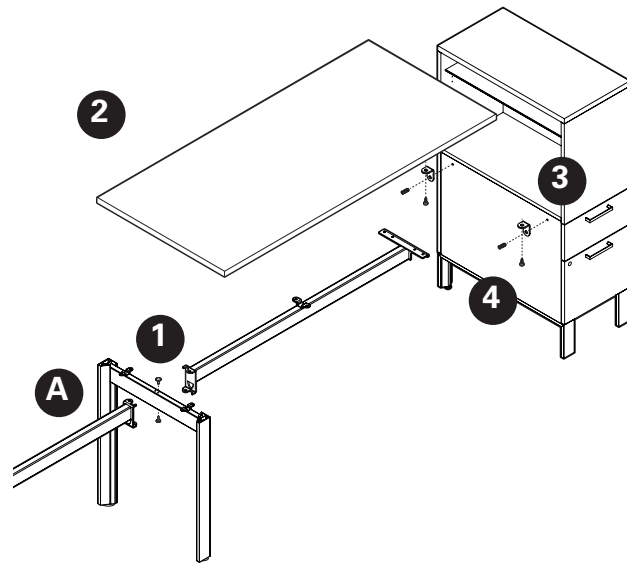

Spine / Storage Table Beam Adapter

Storage table beam adapter allows a worksurface to be supported by a leg on one side and a spine storage cabinet on the opposite side. A typical Storage spine is formed by series of interconnected 21" or 25" high storage cabinets of corresponding depth.

The Storage beam is connected to a single or back-to-back leg on one side and to the worksurface on the opposite side - thus saving one leg assembly.

The 21" or 25" adapters provide structural support - acting as supports between top of the storage cabinet spine and the bottom of perpendicular worksurfaces.

The flexible leg/beam/adapter assembly arrangement allows the leg to be tucked in under the worksurface or to be shared by two adjacent worksurfaces. Included hardware connects the adapter to the worksurface and to the storage table beam.

STEP 1: Position beam's end bracket over leg's horizontal, rectangular tube. Use Allen keys to secure top and bottom bracket ends with two supplied screws.

STEP 2: Attach Spine / Storage table beam adapter to the Storage table beam. Use Allen key and the supplied screw to secure.

STEP 3: Turn the worksurface upside down on a smooth surface and secure it to the leg/beam/adapter subassembly with supplied screws.

STEP 4: Rest the leg/beam/adapter/worksurface assembly on top of the storage spine. Adjust the desired position. Secure the assembly by driving two supplied screws through the bottom of the adapter, into the top of the storage cabinet.

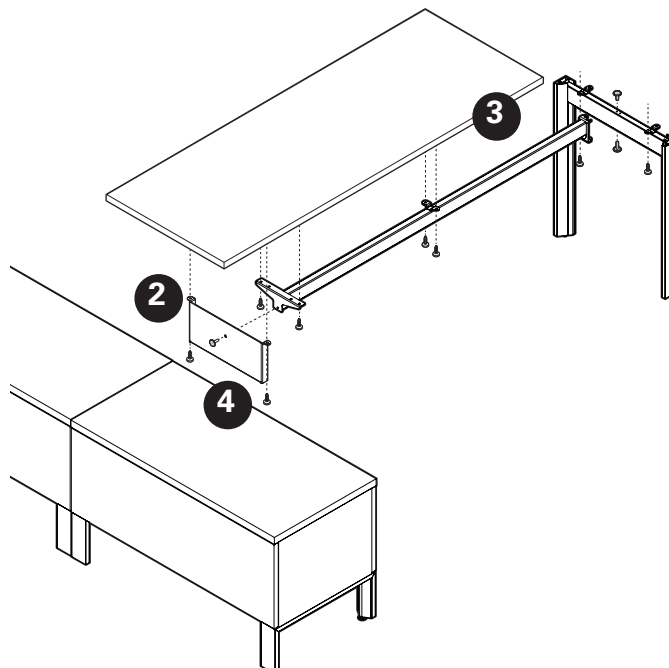

Sliding Return

NOTE:

Round legs:

Sliding Return can be installed anywhere along the front edge of worksurface supported by round legs.

Rectangular legs:

Sliding Return can be installed along the front edge of worksurface between Rectangular legs.

Sliding return can be installed under a seam of two adjacent worksurfaces supported by recessed, 3/4" back-to-back leg.

Ensure that back-to-back table installation is complete, level and structurally sound. Installation of Sliding Rail requires a special degree of accuracy of worksurface alignment. Failure to do so may result in binding of the sliding mechanism on the Sliding Rail.

Establish range of the Sliding Return.

STEP 1: Mark a line 3" in from (and parallel with) the front edge of worksurface.

STEP 2: Position the Sliding Rail and secure it with supplied screws. Always proceed from the second hole, leaving the first hole for installation of the Rail stop.

NOTE: the pair of screws provided to secure the rubber rail stops at either end of the rail are longer than the screws for securing the rail to the worksurface. Do not use these longer screws to secure the rail as the screws may penetrate through the top of the worksurface.

STEP 3: Secure leg support bracket to a leg frame with supplied machine screws (wide flat allen head).

STEP 4: Place the Sliding Return worksurface upside down on a clean surface. Secure the leg assembly to the worksurface with supplied wood screws. Ensure that the legs are set to the same height as the legs supporting the rest of the table installation.

STEP 5: Place eight supplied rubber spacers over pre-drilled holes. If you are converting an existing Return worksurface to a Sliding Return, mark a line 1" in from (and parallel with) the edge of the Return worksurface.

STEP 6: Align supporting brackets with rubber spacers / pre-drilled holes (or the marked line) and secure both brackets with supplied wood screws.

NOTE: In order to ensure a smooth sliding action, both brackets must be perfectly perpendicular to the edge of the return worksurface.

STEP 7: Slide the two glide blocks with bushings carefully onto the Rail as illustrated.

STEP 8: This step requires two people:

While the leg supported side of the Return rests on the floor have an assistant position supporting brackets under sliding glide blocks, align the holes and gently drive in two machine screws (metric M6 as provided). Do not tighten. In the same manner secure the second bracket to the second glide block and test smoothness of the slide. Carefully tighten all four metric screws while repeatedly testing smoothness of the slide. If the return binds on the Sliding Rail, then your support bracket(s) are not perpendicular to the rail - causing the glide blocks to jam.

STEP 9: Secure rail stops to both ends of the rail with supplied (longer) screws to prevent disengagement.

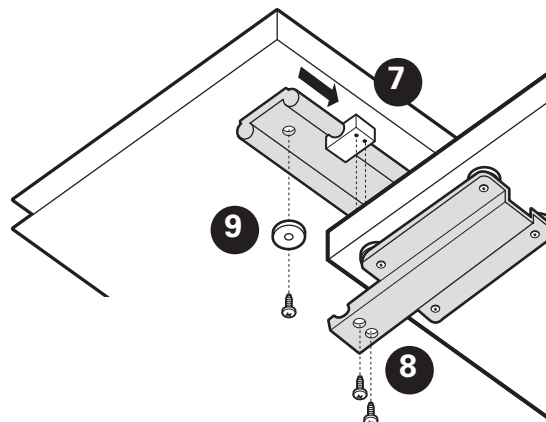
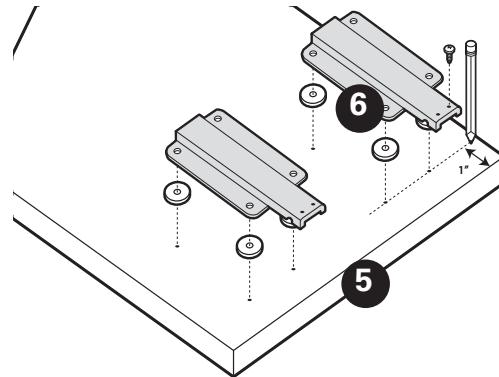
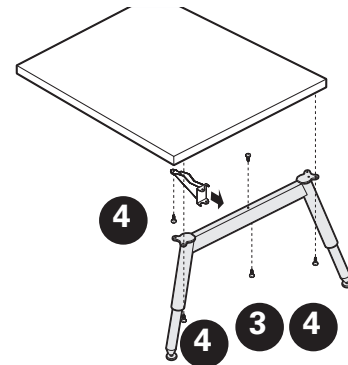
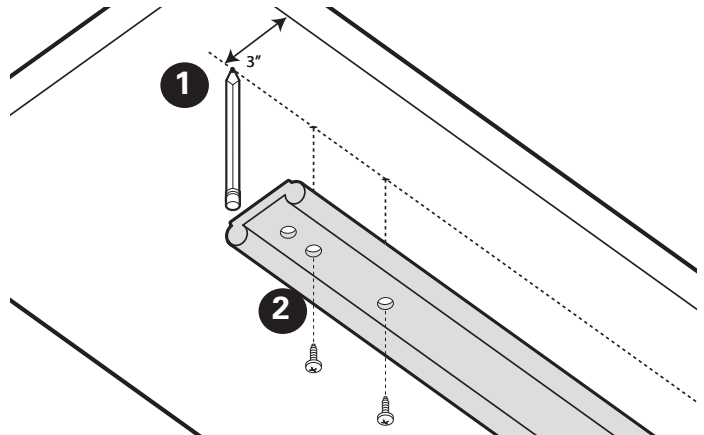

Round Table Supports

Round table structure consists of one main leg and two individual legs.

STEP 1: Position each individual leg's end bracket over the main leg's horizontal, rectangular tube.

STEP 2: Secure top and bottom bracket ends with the supplied screws. Level the whole assembly.

STEP 3: Install round worksurface.

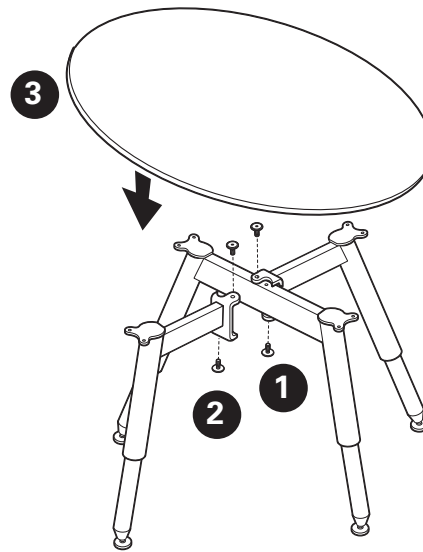

Pivoting Table Supports

Round and oval pivoting table structure consists of one main leg, leg bracket and a pivoting clamp. Place oval worksurface upside down on a clean surface.

STEP 1: Align clamp over pre-drilled holes.

STEP 2: Rotate pivoting clamp over disc to reveal screw holes and drive in 4 supplied screws (the clamp must be rotated 90° degrees to reveal the next screw hole).

STEP 3: Secure leg support bracket to leg with two screws.

STEP 4: Secure leg support bracket/leg assembly to worksurface with five supplied screws.

STEP 5: Increase leg height by 2" (two increments) to compensate for the height of the pivoting clamp. Rectangular legs (included in BRTPR2448C kit) designed specifically for this application are 2" taller.

Invert the table assembly.

STEP 6: Position table with pivoting bracket over the edge of the primary table as illustrated.

STEP 7: Tighten the set screws of the pivoting clamp, securing it to the primary table.

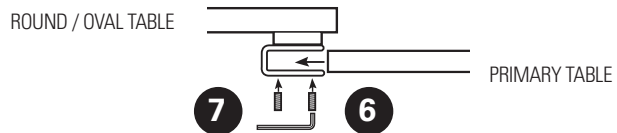
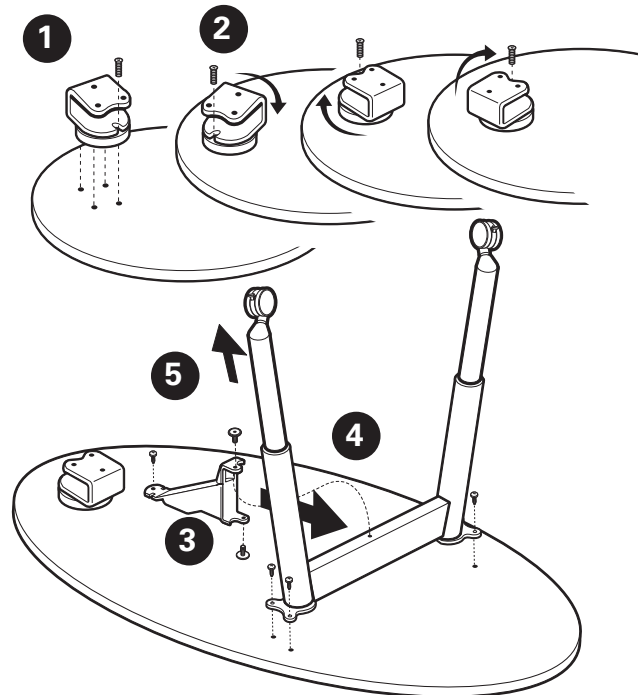

Power, Data and Cable Management

Overview

Wire basket

Above worksurface back-to-back Power trough with base feed and ceiling feed

Below worksurface back-to-back Power trough with base feed

Ceiling feed

Below worksurface Single sided Power trough with base feed

Storage Power box

Power delivery / cable management

At the basic level, table and floor based office equipment is serviced by a wall or floor power supply. As the operation grows, there might be a need to organize excessive cable clutter.

Wire basket (1) connects to the underside of worksurfaces with sprig brackets and cables are simply dropped and coiled into them.

Cable Snake(2) installed in proximity of floor monument to manage vertical cable clutter.

Table clamped, single circuit **Desk Top Power Data Modules (3)** deliver services to desk height, while tapping into wall or floor power supply. Again, the excessive cables can be managed with Cable Trays.

Ceiling pole BRTCPP (4) manages power and data cables between ceiling and above or below worksurface power troughs.

Above and Below Worksurface Power/Data Troughs (5) can be installed between back-to-back tables for extended below and above desk height power / data distribution. - 8 wire, 4-circuit system.

Single Sided Power/Data Troughs (6) can be installed to the underside of a single table.

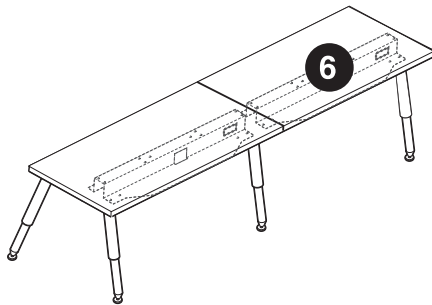
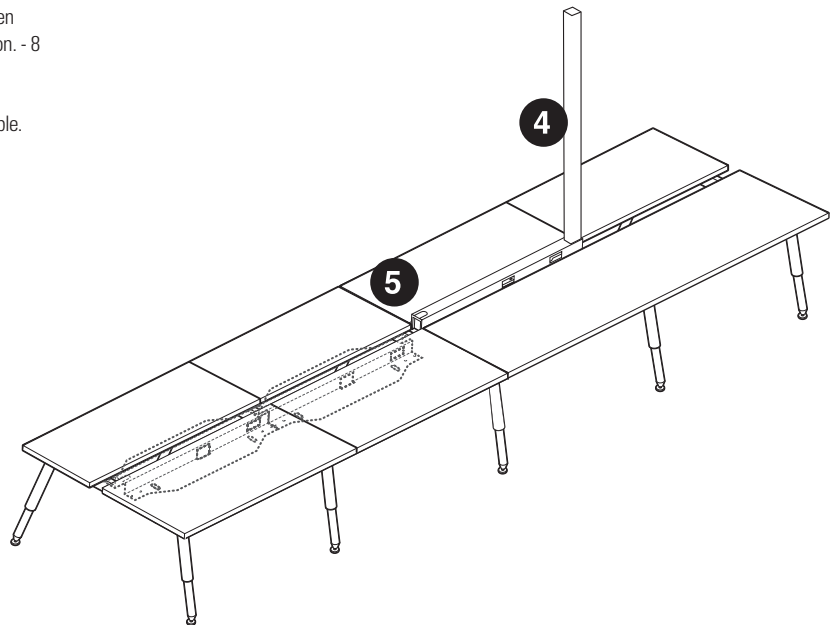
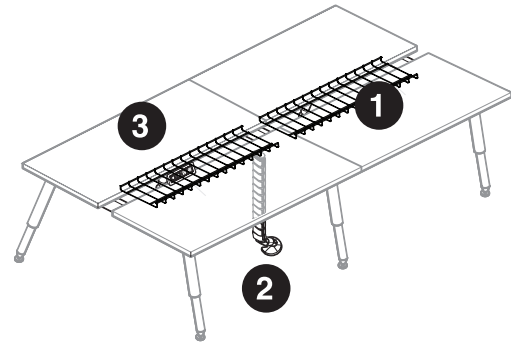

Storage power/data box BRTVCM (7) attaches to storage units and provides access to one duplex/data terminal on top storage surface. Integrated single circuit module can be plugged to floor monument under the storage, to a wall outlet or to a panel floor raceway duplex receptacle.

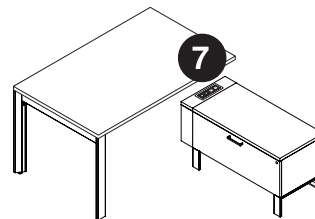

Wire Basket

Wire Basket

8" wide basket manages cable excess under single and back-to-back worksurfaces, as well as under storage cabinets. It is suspended on four spring steel brackets so it can be easily unclipped to rearrange cable connections from below the worksurface or below storage units.

Wire baskets are available in incremental sizes, usually about 8" shorter than the intended worksurface / storage span.

STEP 1) Identify the correct basket length. Attach supplied spring brackets on the basket as illustrated so that the hooks point inward. Center the basket below worksurface.

STEP 2) Secure by driving supplied screws through the four brackets into the worksurface.

Storage cabinet installation: bottoms of storage cabinets are provided with pre-drilled holes. Attach supplied spring brackets on the basket so that the hooks point inward. Secure the baskets by driving supplied screws through the four brackets into the storage cabinet's bottom.

Long Wire Baskets can span under several storage cabinets. As a general rule, specify Cable Basket min. 8" shorter than the storage cabinet spine assembly.

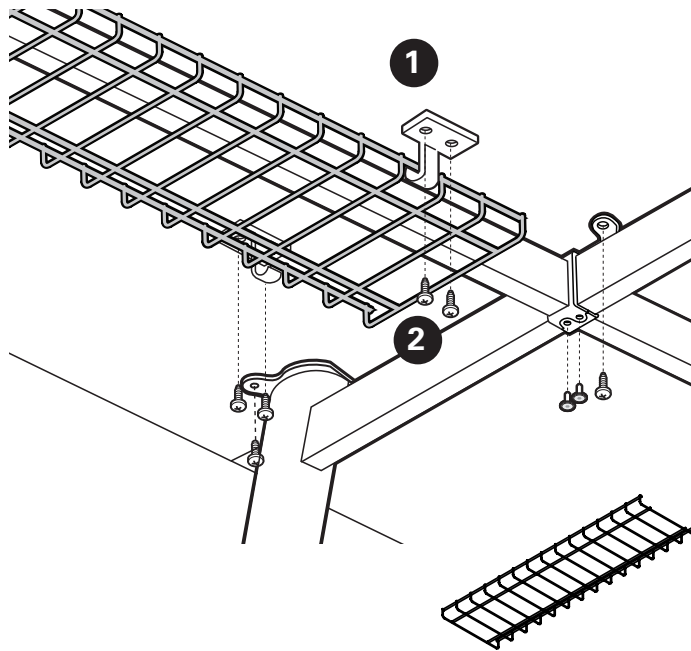

Below Worksurface Power Trough

NOTE: Install dividers, storage and table top accessories prior to proceeding with the installation of below surface power trough.

A) SUPPORTING STRUCTURE

Identify length and location of required Power Troughs and position them in accordance with lay-out plans. Install brackets on Power Troughs. Make sure that all Power Troughs are securely connected before proceeding with installation of electrical components.

B) ELECTRIC COMPONENTS

Identify type and location of required electrical components and position them in accordance with lay-out plans. Secure Power Feed to the Power Trough brackets (ensure that the liquid tight whip is long enough to reach the power source / floor monument). Proceed with connecting Power Distribution Assemblies and Jumper Harnesses on the ground, just below their future location. Install Duplex Receptacles as specified. Secure interconnected electrical components to Power Trough.

C) DATA/COMMUNICATION

Arrange cables below their future location into bundles under the tables. Install cable terminals and snap Terminal Plates into the openings in the middle of Power Trough. Proceed from one side of the table assembly, lift cable bundles and secure them to the Power Trough with extruded Data Cable Manager.

D) CONNECT TO THE BUILDING POWER SUPPLY

It is recommended that the connection to the building power supply be made under the supervision of a licensed electrician and according to applicable codes and regulations. Connection to the building power supply must be done by a licensed electrician. Do not connect or disconnect components while the system is under load. Disconnect the main power before servicing or reconfiguration.

E) WALK THROUGH / INSTALLATION INSPECTION

Below Worksurface Power Trough Installation

STEP 1: Install four brackets (two pairs of left and right brackets are required). Below worksurface Power troughs are provided with 4 pairs of mounting holes to accommodate the brackets at various table leg positions.

Two of back-to-back tables use narrower supporting beams and the legs on both sides are, therefore, inset below worksurfaces. To fit the Trough and brackets into this narrower space use a pair of mounting holes "B - B" to secure below worksurface Power Trough to a single assembly of two of back-to-back tables.

A back-to-back table assembly at the beginning of a multiple table run employs slightly longer supporting beams to accommodate the legs on the 'start-of-a-run' side to be inset below worksurfaces, and the shared leg to be right below the seam of two adjacent worksurfaces. Use a pair of mounting holes "B" to secure brackets to the Power Trough on the 'start-of-a-run' side, use the pair of mounting holes "A" to secure brackets to the Power Trough on the 'shared' leg side.

A back-to-back table assembly in the middle of a multiple table run employs the longest, interconnecting supporting beams - placing shared legs right under the seams of adjacent worksurfaces on both sides.

Use mounting holes "A" on both sides to secure brackets to the Power Trough.

Position the Power Trough over the brackets so that threaded studs on the brackets protrude through the holes in the Power Trough. Secure brackets with supplied thumb nuts.

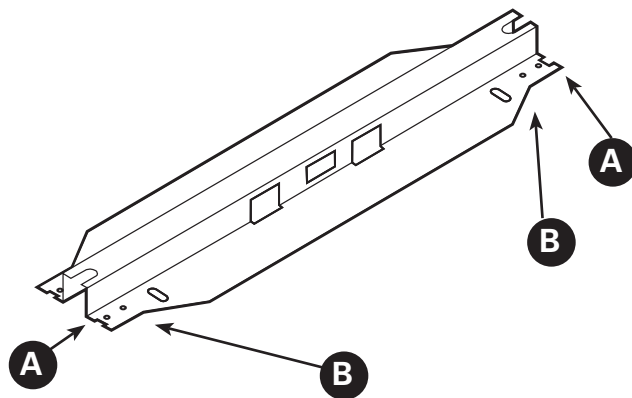

Below Worksurface Power Trough Installation

STEP 2: Engage Trough's brackets with the leg's horizontal beam. Ensure that tab "A" fits over the leg beam. Use tab "B" to locate the bracket against the leg worksurface bracket as illustrated.

STEP 3: Secure each bracket by driving supplied screws through tab "C" into the bottom of the worksurface.

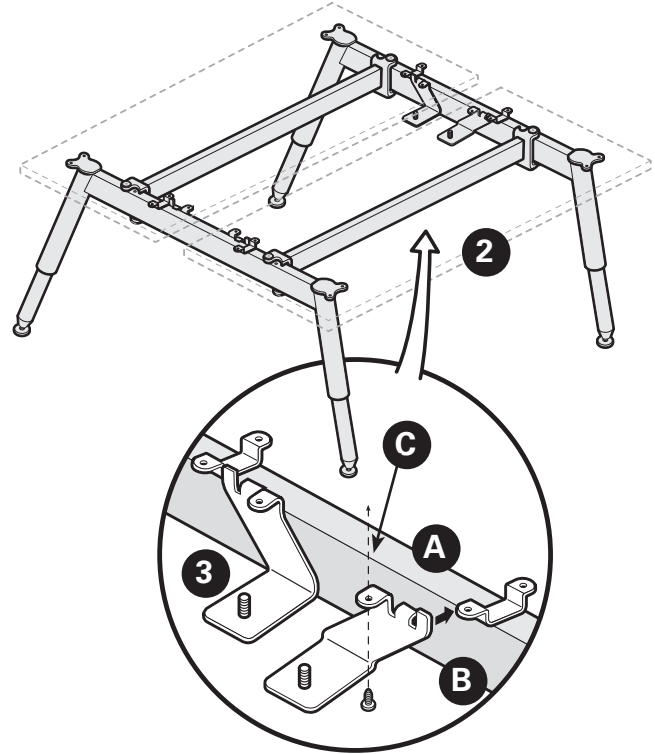

Power Trough - 120° Installation

Installation of 120° Power Troughs and Below worksurface Power Troughs on a worksurface supported by storage Towers.

120° Power Troughs and Power Troughs on a worksurface supported by storage Towers are secured to tables with two types of brackets: the standard trough-mounting brackets on one side (the same, above described rules apply; (A) position for shared application; (B) position for end of a run application) and narrow "Z" brackets securing the opposite side of the Power Troughs in the proximity of the 120° 'corner' leg or in the proximity of Storage Tower.

STEP 1: Install trough brackets

STEP 2: Preassemble "Z" brackets and power Troughs: Thread the threaded stud through the Power Trough as illustrated. (Notch in the front edge of the Power Trough prevents the "Z" bracket from rotating).

STEP 3: Engage Trough's brackets with the leg's horizontal beam. Ensure that tab "A" fits over the leg beam. Use tab "B" to locate the bracket against the leg worksurface bracket as illustrated.

STEP 4: Secure the Trough by driving supplied screws through tab "C" and through "Z" brackets into the bottom of worksurfaces.

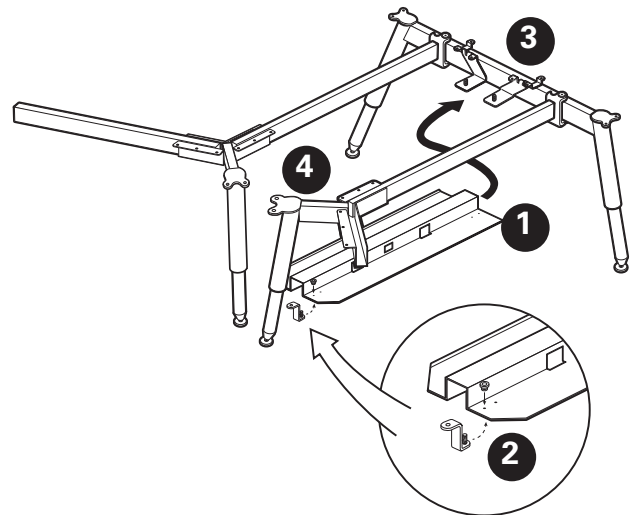

Power Trough Electric Components - Below Worksurface Trough Base Feed

Identify type and location of required electric components and position them in accordance with lay-out plans.

STEP 1: Secure Power Feed to the Power Trough brackets (ensure that the liquid tight whip is long enough to reach the power source / floor monument).

STEP 2: Lift the Power Trough on one side and rest the Power Feed mounting bracket on top of the Power Trough brackets.

STEP 3: Lower the Power Trough so that the Power Feed bracket is sandwiched between the Power Trough and Power Trough supporting brackets; ensure that threaded studs protrude through the holes in the Power Trough.

STEP 4: Secure all Power Troughs with supplied knurled thumb nuts.

STEP 5: Connect Power Distribution Housings and Jumper Harnesses on the ground, just below their future location.

NOTE : There is an arrow and a letter "N" on each Power Distribution Housing and on every Jumper Harness referring to the correct position in relation to each other.

STEP 6: Install Duplex Receptacles as illustrated, with circuit numbers in accordance with the electrical plans.

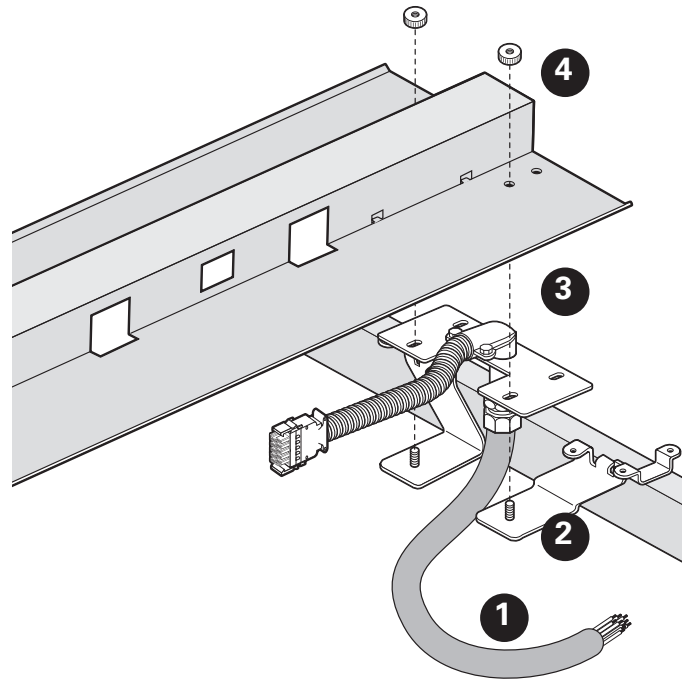
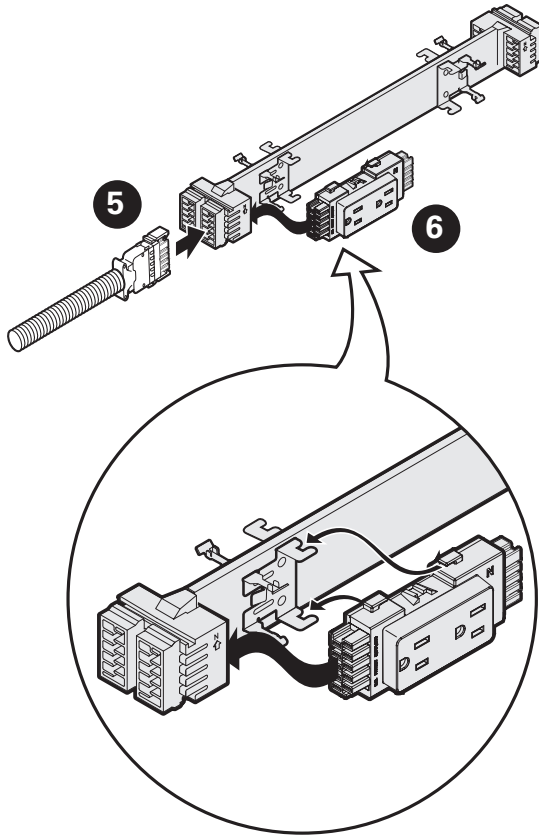

Power Trough Electric Components : Continued

STEP 7: Secure interconnected Electrical Components to Power Troughs: Proceed from the Power Feed by connecting its harness to the Power Distribution Housing.
 NOTE: There is an arrow and a letter "N" on each Power Distribution Housing and every Power Feed referring to the correct position in relation to each other.

STEP 8: Insert assembled Electrical Components into the Power Trough from the bottom. Ensure that all four Duplex Receptacles are located in their designated openings.

STEP 9: Insert Power Distribution Housing Lock into the gap between Power Trough and the bottom of the Duplex Receptacle.

STEP 10: Slide back to engage the opposite end as illustrated.

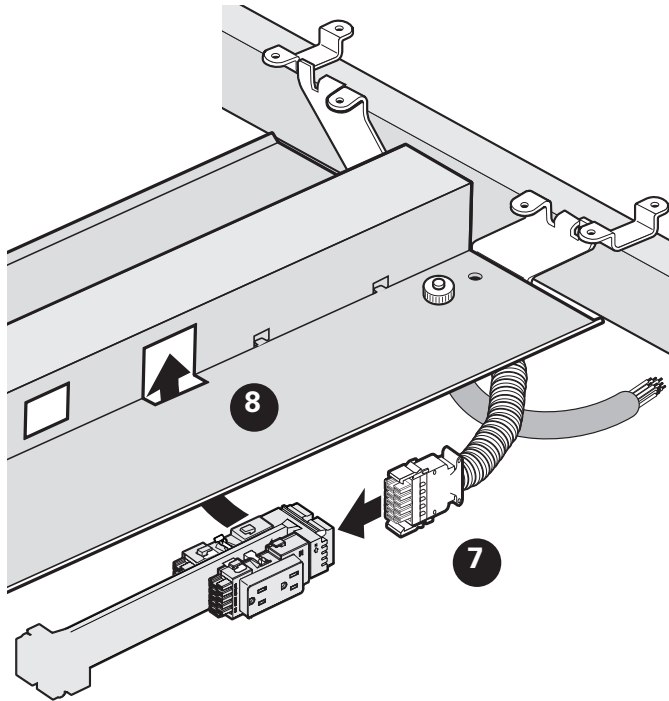

STEP 11: Repeat steps 9 and 10 under the opposite Duplex Receptacle. Proceed to the opposite end of Power Distribution Housing.
 Ensure that all electrical components are interconnected and secured to Power Troughs. Connect Power Feed to the building power supply.

NOTE: There must be only one power feed entry into each cluster of harnesses. WARNING! It is recommended that installation of the wiring system be made under the supervision of a licensed electrician in accordance with applicable codes and regulations. Connection to the building power supply must be done by a licensed electrician. Do not connect or disconnect components while the system is under load. Disconnect the main power before servicing or reconfiguration.

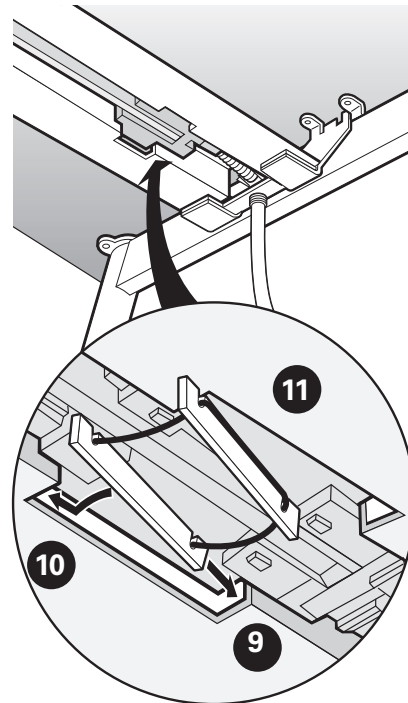

Organize data/communication cables on the ground just below their future location.

STEP 12: Thread cable through data/communication opening (located in the middle of each Power Trough). Connect terminals and snap terminal plate into data/communication opening.

STEP 13: Capture cable bundles in the extruded Data Cable Manager trough

STEP 14: Snap Data Cable Manager Trough into the bottom of Power Trough. Ensure that Data/communication Troughs are securely engaged with all tabs at the bottom of Power Troughs. (Refer to actual part)

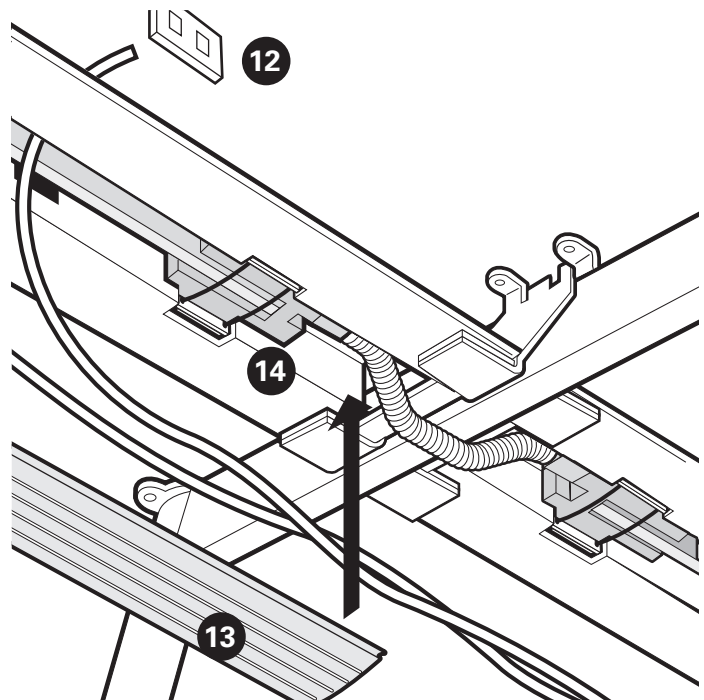

Single Sided Power Trough

STEP 1: Identify correct length of Single- sided Power Trough and position it up against the bottom of worksurface so that its shorter lip rests against the table supporting beam. Center it sideways so that its center becomes aligned with the center of the worksurface.

STEP 2: Secure it to the worksurface with supplied screws.

Identify type and location of required electric components and position them on the floor in accordance with lay-out plans.

STEP 3: Install Duplex Receptacles, with circuit numbers in accordance with the electrical plans. NOTE : There is an arrow and a letter "N" on each Power Distribution Housing, Duplex receptacle and on every Jumper Harness referring to the correct position in relation to each other.

STEP 4: Connect Power Distribution Housings, Jumper Harnesses and Base feed.

STEP 5: Slide Power Distribution Housing with Duplexes, Jumpers and Base feed into the Trough. Ensure that all Duplexes are properly seated in the openings.

STEP 6: Secure with supplied 1/4-20 screw and special die-cast washer. See detail illustration. The screws lead through the gap between Power Distribution Module terminals and into two weld-nuts inside the Trough.

STEP 7: Align Base feed plate with 4 threaded inserts on the Trough and secure with four supplied #10-24 screws.

STEP 8: Thread data/communication cables through Trough terminal opening and make jack/terminal plate connections.

STEP 9: Scoop up data/communication cables into the cable manager and snap the manager into the Trough while making sure that the groove in the extruded manager is engaged with all inwardly pointing Trough tabs.

Ensure that all electrical components are interconnected and secured to Power Troughs. Connect Power Feed to the building power supply.

NOTE: There must be only one power feed entry into each cluster of harnesses.
WARNING! It is recommended that installation of the wiring system be made under the supervision of a licensed electrician in accordance with applicable codes and regulations. Connection to the building power supply must be done by a licensed electrician. Do not connect or disconnect components while the system is under load. Disconnect the main power before servicing or reconfiguration.

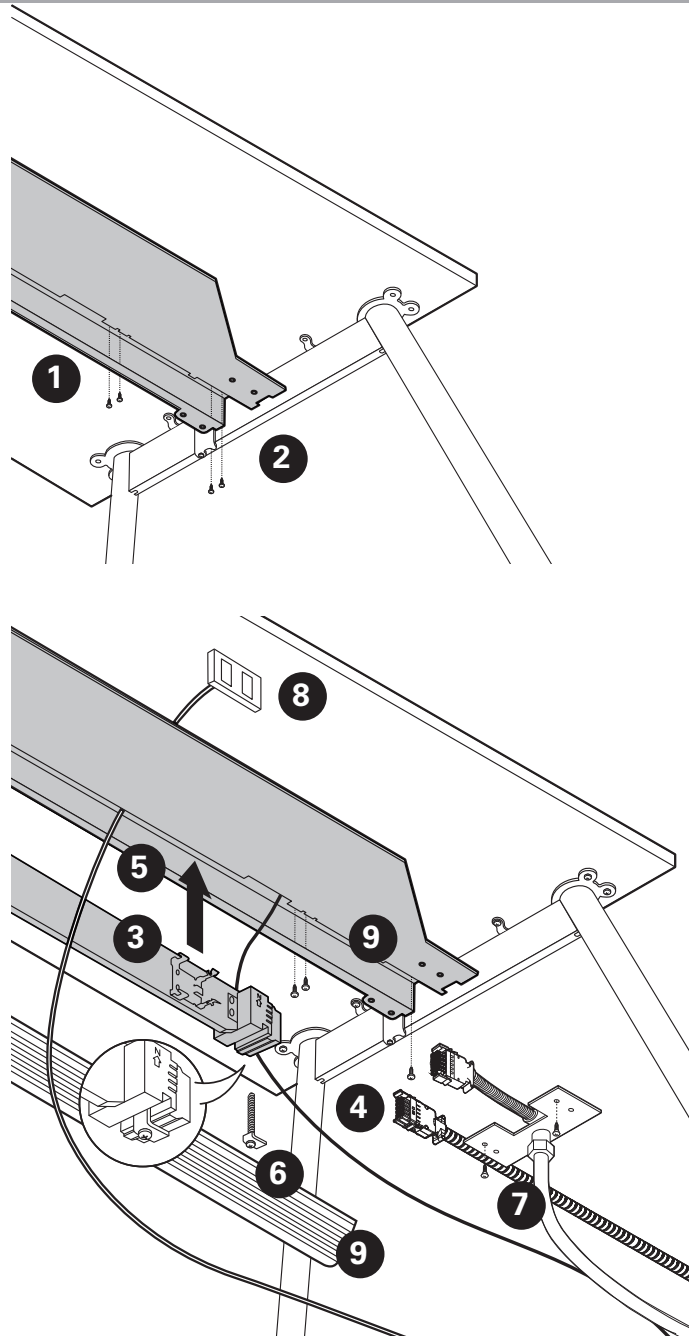

Above Worksurface Power Trough

Identify correct length of Above Worksurface Power Troughs and place them on worksurface in their respective locations.

Identify type and location of required electric components and position them in accordance with lay-out plans.

STEP 1: Install Duplex Receptacles, with circuit numbers in accordance with the electrical plans. NOTE : There is an arrow and a letter "N" on each Power Distribution Housing, Duplex receptacle and on every Jumper Harness referring to the correct position in relation to each other.

STEP 2: Connect Power Distribution Housings and Jumper Harnesses.

STEP 3: Thread Base feed's metal conduit with connector between worksurfaces, Connect Power Feed to the Power Distribution Module (ensure that the liquid tight whip is long enough to reach the power source / floor monument). If the plans call for Ceiling feed then connect it with Power Distribution Housing and let the rest of the metal conduit rest on the worksurface for now.

STEP 4: Slide Power Distribution Housing with Duplexes, Jumpers and Power feed into the Above Worksurface Power Trough. Ensure that all Duplexes are properly seated in the openings, and secure with supplied 1/4-20 screw and special die-cast washer. See detail illustration. The screws lead through the gap between Power Distribution Module terminals and into two weld-nuts inside the Trough.

STEP 5: Slide four Duplex retainers into the Power trough openings. Lower tabs of the retainer are provided with semi - spherical protrusions which snap into holes in the Power Trough - thus keeping the Duplexes in place.

STEP 6: Slide Ceiling feed opening cover in place if you are using Base feed; leave it off if you are using Ceiling feed.

STEP 7: Install Above Worksurface Power Trough End covers at the end of a trough run. No covers are installed between two adjacent Above Worksurface Power Troughs. Secure the End covers with two supplied screws. Ensure that the covers are aligned with sheet metal case of the Trough.

STEP 8: Lower the assembly into the gap between back-to-back worksurfaces

STEP 9: Insert bracket's tab in vertical position into elongated slots in Above Worksurface Power Trough.

STEP 10: Rotate the bracket upward

STEP 11: Secure brackets with supplied screws

STEP 12: Align Power Feed's mounting plate with Above Worksurface Power Trough and secure it to worksurface with four supplied screws.

STEP 13: Thread data/communication cable past the Power Distribution Module and out through data/com opening. Make cable / terminal jacks / terminal plate connections and snap terminal plate into the Above Worksurface Power Trough.

STEP 14: Scoop up data/communication cables into the cable manager and snap the manager into the Above Worksurface Power Trough while making sure that the groove in the extruded manager is engaged with all inwardly pointing Above Worksurface Power Trough tabs.

Ensure that all electrical components are interconnected and secured to Power Troughs. Connect Power Feed to the building power supply.

NOTE: There must be only one power feed entry into each cluster of harnesses.
WARNING! It is recommended that installation of the wiring system be made under the supervision of a licensed electrician in accordance with applicable codes and regulations. Connection to the building power supply must be done by a licensed electrician. Do not connect or disconnect components while the system is under load. Disconnect the main power before servicing or reconfiguration.

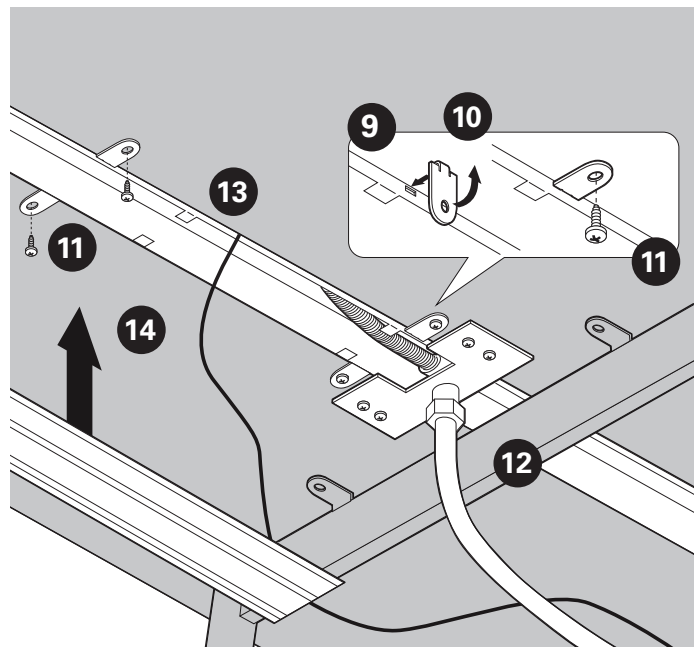
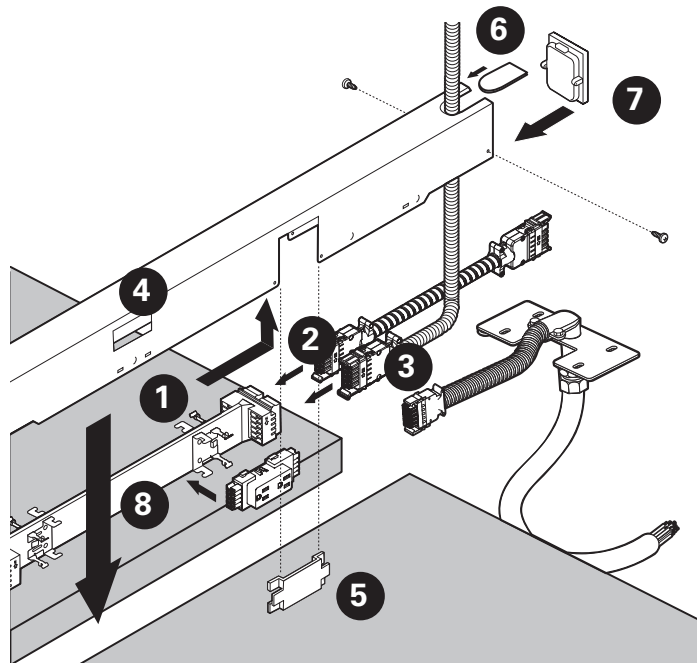

Ceiling Feed

Ceiling feed pole kit consists of a two-part vertical channel and two handed bottom brackets.

Ceiling feed pole installation on Above and Below Power troughs is identical. Above trough is illustrated. Ceiling feed harness has already been connected to the Power Distribution Module and data / communication cables, hanging from the ceiling, enter designated Power trough through its grommet.

STEP 1: Secure bottom brackets to the bottom of the extruded pole with four supplied screws as illustrated.

STEP 2: Organize data / communication cables and the ceiling feed metal conduit within the pole and snap the pole cover closed.

STEP 3: Insert Ceiling feed junction box bracket into the top of the channel.

STEP 4: Position the assembled pole over the Power trough.

STEP 5: Mark and cut hole in the ceiling tile. Reinstall the ceiling tile and secure top of the Ceiling feed pole to the ceiling tile grid.

STEP 6: Connect the Ceiling feed harness to the building power supply.

NOTE: There must be only one power feed entry into each cluster of harnesses.
WARNING! It is recommended that installation of the wiring system be made under the supervision of a licensed electrician in accordance with applicable codes and regulations. Connection to the building power supply must be done by a licensed electrician. Do not connect or disconnect components while the system is under load. Disconnect the main power before servicing or reconfiguration.

STEP 7: Slide a two-part Ceiling feed bezel over the pole and secure it to the ceiling tile with supplied screws.

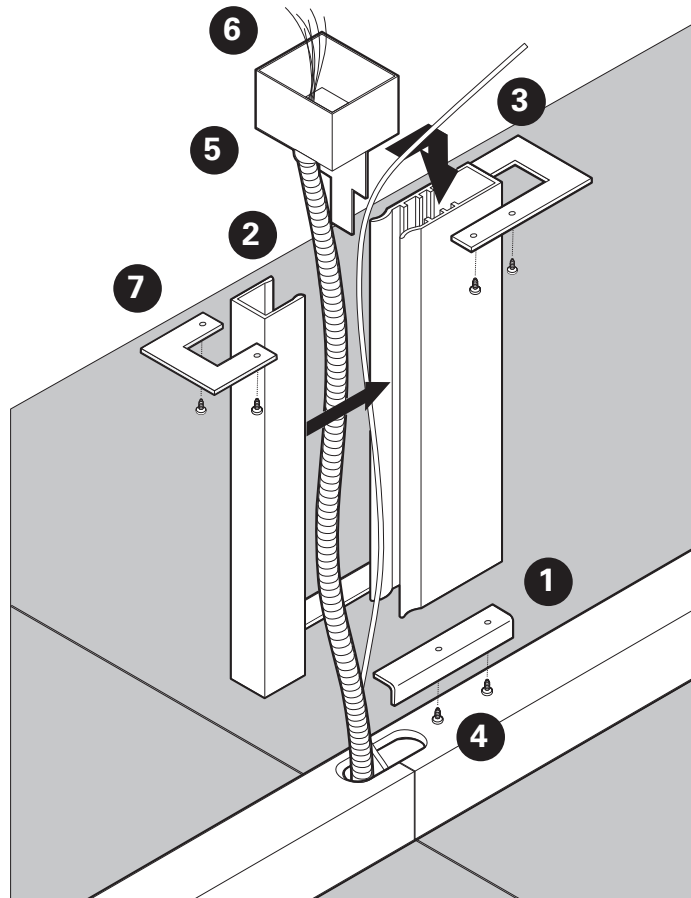

Power Distribution Storage Power Box

In order to secure Storage power box to Storage cabinets it is necessary to reposition one of the storage supporting legs so that it will support the Storage power box as well.

Every storage leg is provided with two hole patterns: 3+3 holes positioned closer to the edges of the leg extrusion and 2+2 hole pattern closer to the center of the extrusion.

STEP 1: Remove six screws securing the leg to the bottom of the storage unit. (3+3 hole pattern). Three of the six screws are machine thread screws. Store them in a safe place in case you will need to relocate the storage leg again in future. The remaining three long screws will be used.

STEP 2: Move the leg so that one half is located under the storage bottom, while the other half remains exposed. Align two of the 2+2 pattern holes with pre-drilled holes in the storage unit gable.

Use an Allen key to secure the leg with two screws.

STEP 3: Rest the Storage power box on the leg, press it against the storage cabinet side gable. Use Allen key to secure the bottom of the Storage power box with two screws.

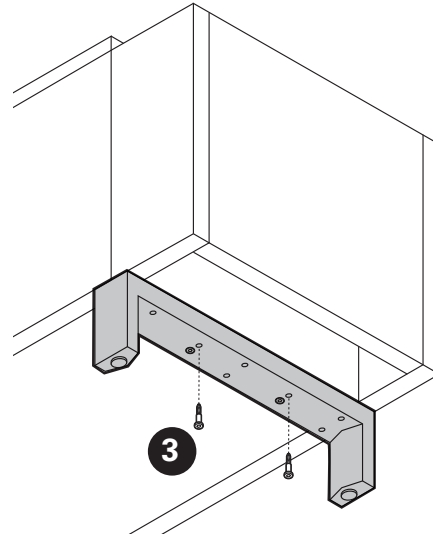
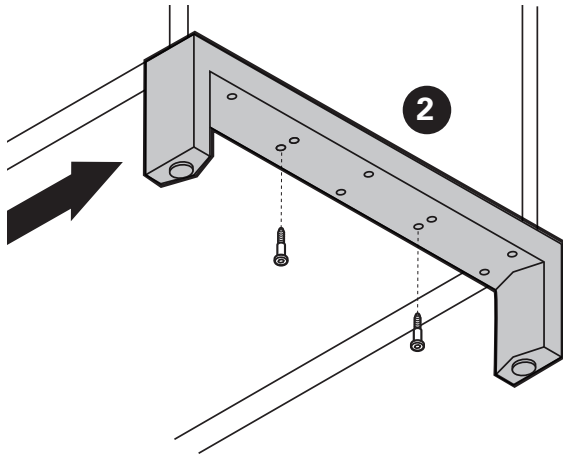
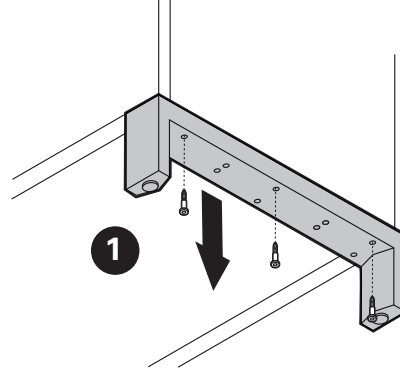

STEP 4: Lower top bracket (Left and Right brackets required) into the corner adjacent to the storage unit and rotate it so that the single-hole end of the bracket slides under storage unit top as illustrated.

STEP 5: Align the bracket with two pre-drilled holes and secure with supplied screws. Install the second bracket on the opposite side.

STEP 6: Open cabinet's door, drawer (removal of the drawer might be necessary) and secure both brackets to the storage unit's top with supplied wood screws.

STEP 7: Follow installation instructions included with the outlet/data module to secure it to the Storage Power Box top. Connect power / data cables and push the top over the box until the four connector pins snap in place.

Organize cables under storage cabinets by installing Cable basket.

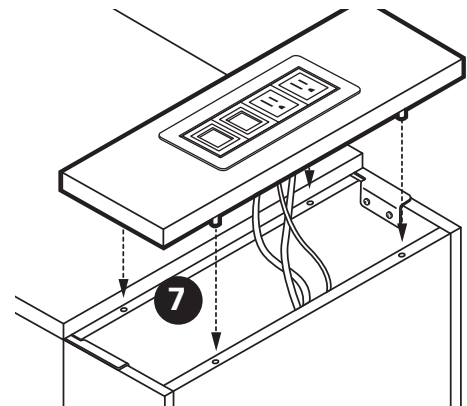
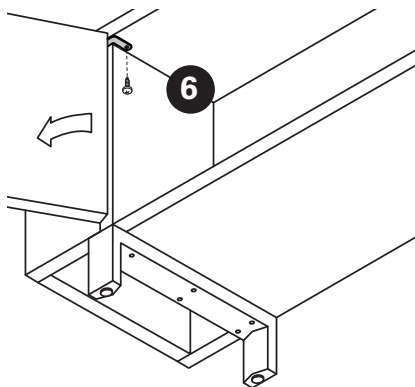
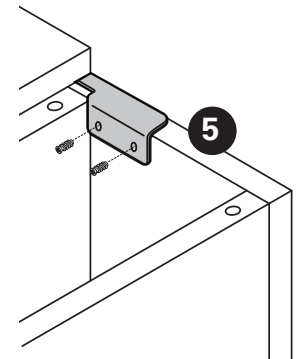
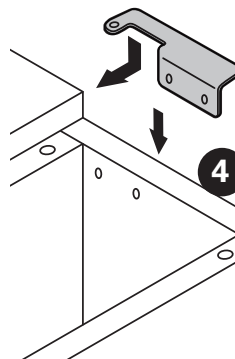

Accessories

Dividers Back-to-Back Divider LP
Glass

Side-to-Side Divider

Parallel divider with integrated modesty panel

Perpendicular end of run divider with integrated Modesty Panel

Modesty Panel Recessed
Flip Down

Gable

Parallel Dividers, Back-to-Back Tables, Glass And Laminate

36", 42", 48", 54", 60" and 72" wide dividers have two Back-to-back divider brackets. 78" and 84" dividers have three.

STEP 1: Back-to-back divider brackets can be set up to support glass dividers and laminate dividers as well.

To install laminate dividers insert the vertical brackets in the farthest positions A and secure them with screws C. Ensure that the screws are very tight.

To install glass dividers bring the vertical brackets snugly together B and secure them with screws C. Ensure that the screws are very tight.

STEP 2: Back-to-back worksurfaces are provided with pilot holes for accurate location of Back-to-back divider brackets. Align the brackets with pilot holes and secure with supplied screws.

STEP 3: Insert the glass or laminate divider into the bracket while making sure that it is seated all the way at the bottom, resting on shock-absorbent pads.

STEP 4: Use Allen key to gently adjust plastic set screws while keeping the divider in vertical position. Do not over tighten!

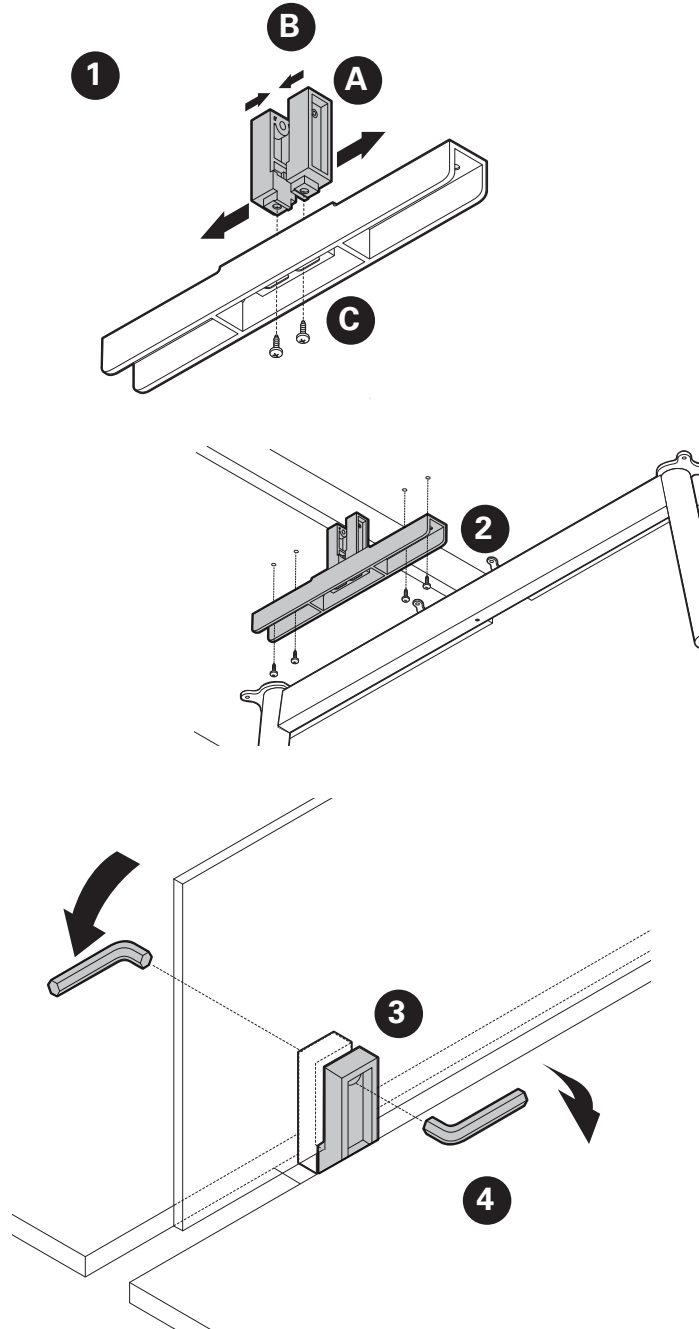

Side 2 Side Laminate Divider

Note: Side-2-side laminate divider can be installed in the middle of a worksurface and over two adjacent worksurfaces supported by round legs. Because rectangular legs occupy bottom corners of worksurfaces it cannot be installed over two adjacent worksurfaces unless they are supported by 34" deep Back-to-back leg.

STEP 1: Align the front bracket with pilot holes at the bottom of Side-to-side laminate divider and secure with supplied screws.

STEP 2: Slide the divider over the front edge of a worksurface at the desired location.

STEP 3: Align the rear bracket with pilot holes at the rear edge of Side-to-side laminate divider and secure with supplied screws.

STEP 4: Adjust divider's position and secure it to worksurface with supplied screws as illustrated.

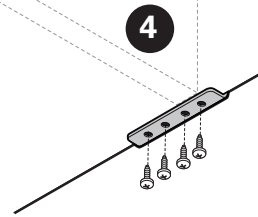
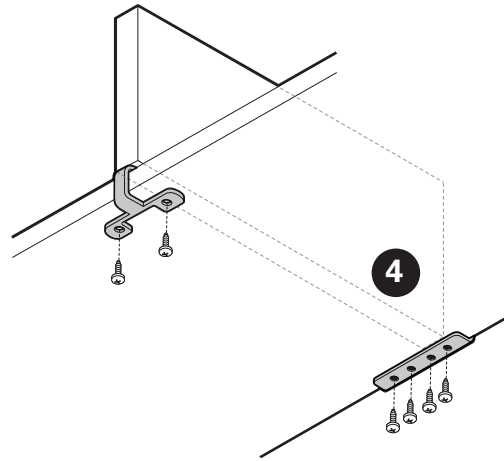
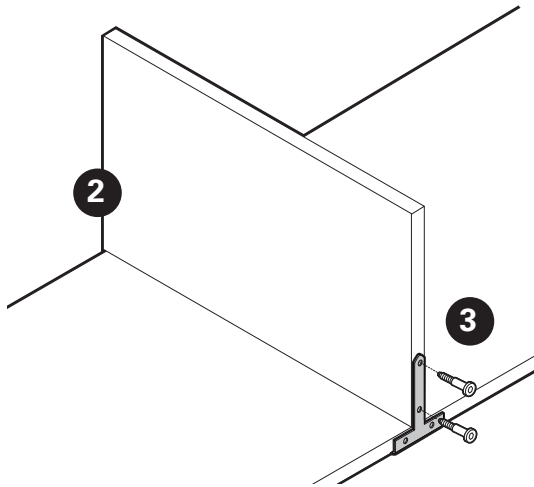
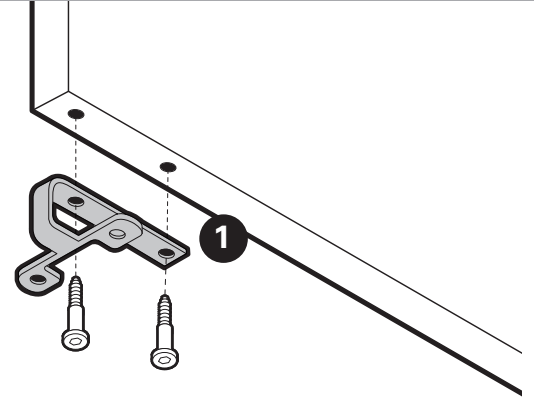

Parallel Dividers, Laminate Divider With Integrated Modesty Panel

Laminate parallel dividers are provided with 8 pilot holes.

STEP 1: Align the brackets with pilot holes and secure with supplied screws.

STEP 2: Have two people hold the divider with pre-installed brackets against the bottom of the table worksurface. Align the brackets with pilot holes in the worksurface as illustrated and secure with supplied screws. Drive in remaining screws.

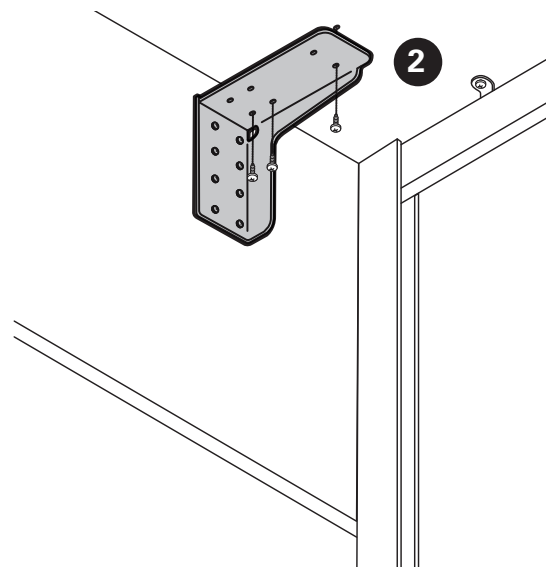
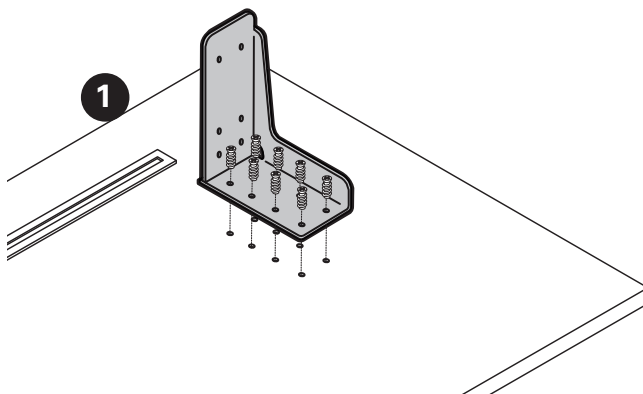
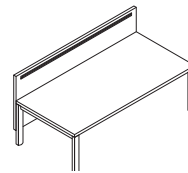

Perpendicular, End of Run

Note: the Perpendicular end-of-a-run divider can only be installed on rectangular legs. Remove vertical cable manager cover from both legs.

STEP 1: Align top brackets with pilot holes and secure with supplied screws.!

STEP 2: Slide the end-of-a-run divider top brackets between top of leg's horizontal beam and the bottom of the worksurface and secure with supplied screws. Note: two screws per each bracket.

STEP 3: Insert and rotate the end-of-a-run divider bottom bracket into the leg, slide it up against the bottom end-of-a-run divider edge.

STEP 4: Align the brackets with pilot holes in as illustrated and secure with supplied screws.

Trim the vertical cable manager cover and snap it back in place.

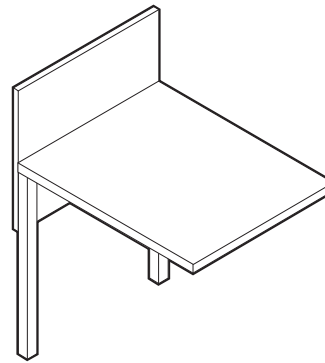
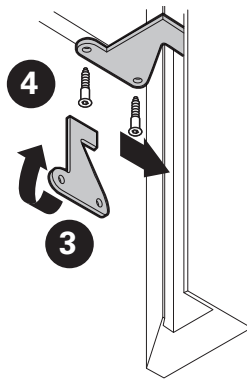
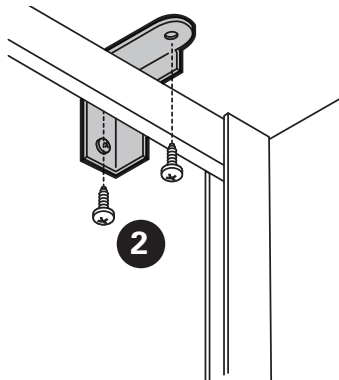
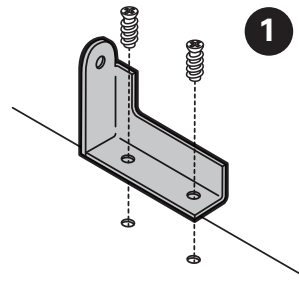

Modesty Panel, Recessed Flip Down

Recessed modesty panel flip down bracket kit consists of two pairs of brackets.

STEP 1: Position the small brackets on the modesty panel so that the bracket's wall with single hole A faces outer edge of the modesty. Align brackets with pilot holes and secure with supplied screws. Ensure that the two supplied shoulder screws B are installed in the top, smaller holes (one per each bracket).

STEP 2: Position the large brackets against the bottom of the worksurface panel so that the bracket's wall with the oblong hole C faces table legs. Align the second hole D (close to the bracket's bend) with the third pilot hole E and secure with supplied screws. Ensure that the brackets are perpendicular to the worksurface's edge and secure the remaining screws.

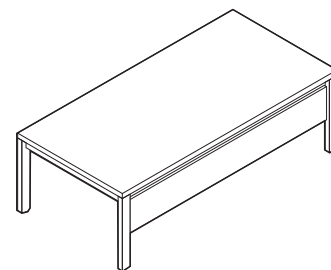
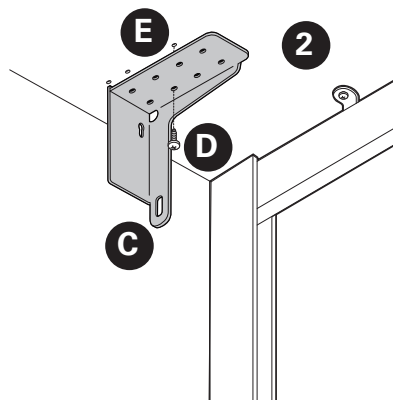
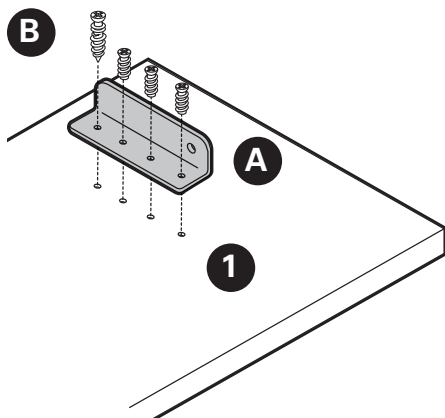

Modesty Panel, Recessed Flip Down Cont.

STEP 3: Suspend the modesty panel off the brackets by inserting both shoulder screws through the bracket's keyholes **F**.

STEP 4: Install joint connector screw as illustrated - the threaded stem screw **G** coming in from the leg side. Tighten with Allen keys.

STEP 5: Hold the center top edge of the modesty panel with one hand and the center bottom edge of the modesty panel with the other hand.

Lift the modesty panel gently upward, making sure that both sides move up evenly. Pull the top edge gently out to disengage both shoulder screws and rotate downward.

Ensure that opening and closing action is smooth and both shoulder screws engage the keyholes easily.

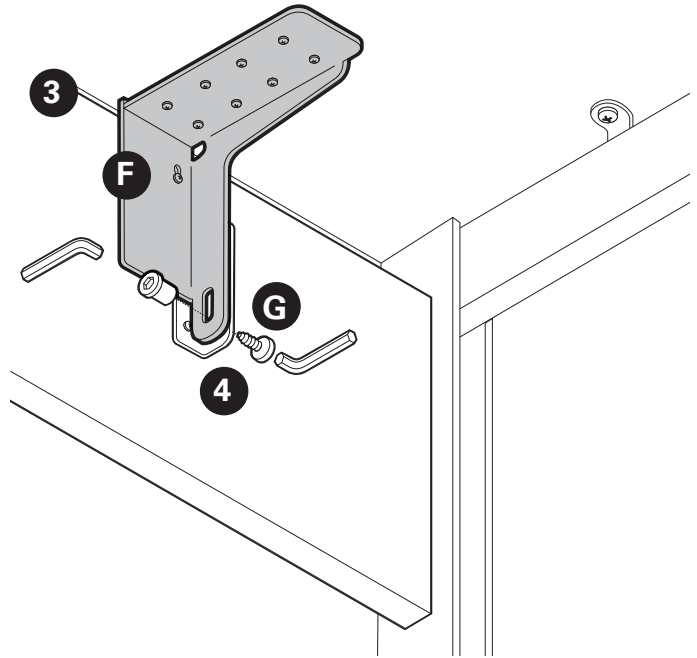

Rectangular Leg Gable

Note: the rectangular leg gable can only be installed on rectangular legs. Remove vertical cable manager cover from both legs.

STEP 1: Align top brackets with pilot holes and secure with supplied screws.

STEP 2: Slide the gable brackets between top of leg's horizontal beam and the bottom of the worksurface and secure with supplied screws.

STEP 3: Insert and rotate the gable bottom bracket into the leg, slide it up against the bottom gable edge.

STEP 4: Align the brackets with pilot holes in the gable as illustrated and secure with supplied screws.

Trim the vertical cable manager cover and snap it back in place.

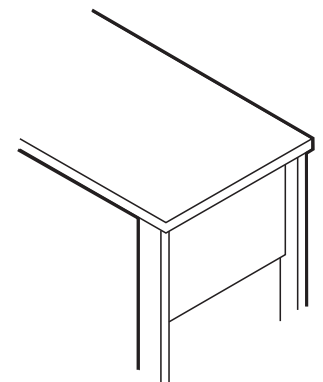
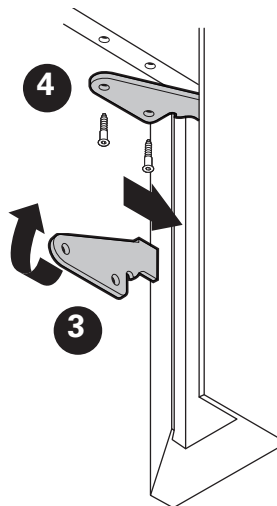
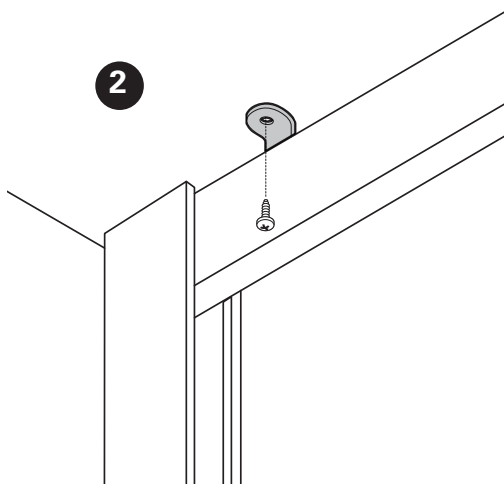
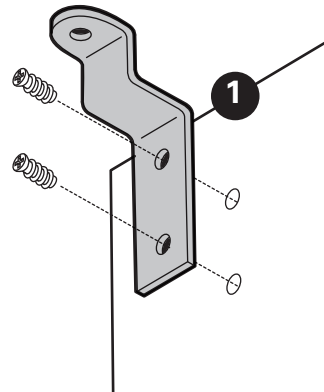

Storage Tower

To install storage towers in a worksurface-supporting configuration please see support beam install.

Wire basket

Please see wire basket install under storage spine.

Storage Spine

Storage units of equal depth can be configured to form longer, interconnected units supported by shared legs. The following steps describe how to convert single storage leg into a shared one:

Every storage leg is provided with two hole patterns: 3+3 holes positioned closer to the edges of the leg extrusion and 2+2 hole pattern closer to the center of the extrusion.

STEP 1: Remove six screws securing the leg to the bottom of the storage unit. (3+3 hole pattern). Three of the six screws are machine thread screws. Store them in a safe place in case you will need to relocate the storage leg again in future. The remaining three long screws will be used.

STEP 2: Move the leg so that one half is located under the storage bottom, while the other half remains with exposed. Align two of the 2+2 pattern holes with pre-drilled holes in the storage unit gable.

Use Allen key to secure the leg with two screws.

STEP 3: Remove support leg from the adjacent storage unit, rest the unit on the shared leg, press it against the storage cabinet's side gable. Use Allen key to secure the bottom of the adjacent storage unit with two screws.

Keep the removed leg and fasteners in a safe place for future reconfigurations.

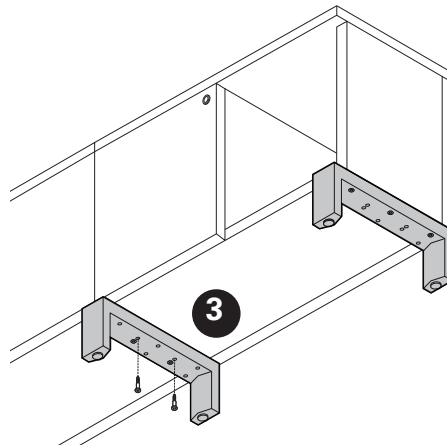
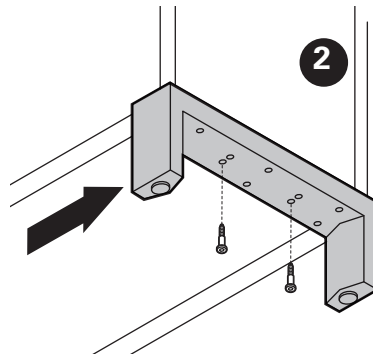
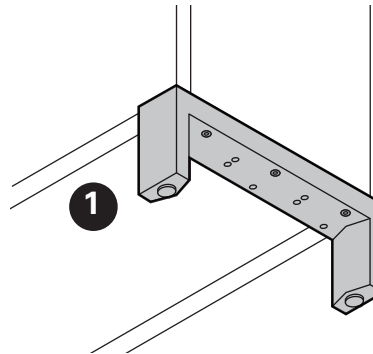



VALUE IS ALWAYS IN STYLE™

SHOWROOMS + DISTRIBUTION CENTERS THROUGHOUT THE UNITED STATES

Global US Headquarters
17 West Stow Road
Marlton, NJ 08053
Tel: (856) 596-3390
Tel: (800) 220-1900
Fax: (856) 596-5684

Troy Hill Corporate Center
7030 Troy Hill Drive
Elkridge, MD 21075
Tel: (301) 362-9400
Tel: (800) 863-7300
Fax: (301) 362-9444

10351 Windhorst Road
Tampa, FL 33619
Tel: (813) 621-6272
Tel: (877) 707-3966
Fax: (813) 621-7958

5 Document Drive
St. Louis, MO 63114
Tel: (314) 432-4463
Fax: (314) 432-4471

2000 Freeway Boulevard
Brooklyn Center, MN 55430
Tel: (763) 560-8196
Tel: (800) 829-2153
Fax: (763) 560-2098

16401 East 33rd Drive, Suite 50
Aurora, CO 80011
Tel: (303) 340-1617
Tel: (800) 275-8655
Fax: (303) 340-1657

119 Greentree Road
Marlton, NJ 08053
Tel: (856) 596-3390
Tel: (800) 220-1900
Fax: (856) 596-4472

1130 Connecticut Avenue
Washington, DC 20036
Tel: (202) 659-0230
Fax: (202) 659-0306

560 Sawgrass Corporate Parkway
Sunrise, FL 33325
Tel: (954) 846-8888
Tel: (800) 331-0529
Fax: (954) 846-8110

11617 West 81st Street
Lenexa, KS 66214
Tel: (913) 310-9963
Tel: (800) 796-0770
Fax: (913) 310-9976

901 South Labarre Road,
Suite 201
Metairie, LA 70001
Tel: (504) 834-6228
Tel: (800) 275-0663
Fax: (504) 835-9638

4675 East Cotton Center Boulevard
Suite 165
Phoenix, AZ 85040
Tel: (602) 426-0666
Fax: (602) 426-1148

One Harbor Street, Suite 104
Boston, MA 02210
Tel: (617) 406-5435
Tel: (800) 876-8980
Fax: (617) 406-5438

Harris Ridge Business Center
6135 Lakeview Road - Suite 350
Charlotte, NC 28269
Tel: (704) 494-4866
Fax: (704) 494-4889

Las Olas City Center
401 East Las Olas Boulevard,
Suite 230
Ft. Lauderdale, FL 33301
Tel: (954) 763-2684
Fax: (954) 763-6870

The Merchandise Mart
10th Floor, Suite 1035
Chicago, IL 60654
Tel: (312) 755-0843
Fax: (312) 755-0837

2025 West Beltline Road, #100
Carrollton, TX 75006
Tel: (972) 236-1366
Tel: (800) 929-2936
Fax: (972) 236-1372

12320 Bloomfield Avenue,
Unit A
Santa Fe Springs, CA 90670
Tel: (562) 484-9686
Tel: (800) 640-0301
Fax: (562) 484-9685

19 Connector Road, Unit 1
Andover, MA 01810
Tel: (978) 470-8463
Tel: (800) 876-8980
Fax: (978) 470-8920

The Millennium Building
10 10th Street, Suite 150
Atlanta, GA 30309
Tel: (404) 879-0998
Fax: (404) 879-9995

380 Leetsdale Industrial Drive
Leetsdale, PA 15056
Tel: (724) 385-1200
Tel: (800) 942-9999
Fax: (724) 385-1207

1879 Internationale Boulevard
Glendale Heights, IL 60139
Tel: (630) 681-2818
Tel: (800) 866-6497
Fax: (630) 681-1631

7865 Northcourt Road,
Building D, Suite 200
Houston, TX 77040
Tel: (713) 695-5777
Tel: (800) 935-6468
Fax: (713) 695-5778

44091 Nobel Drive
Fremont, CA 94538
Tel: (510) 897-4150
Tel: (888) 418-4800
Fax: (510) 897-4156

386 Park Avenue South
New York, NY 10016
Tel: (212) 545-9900
Tel: (888) 315-1301
Fax: (212) 545-5826

2124 Evergreen Boulevard
Duluth, GA 30096
Tel: (678) 602-4130
Tel: (800) 220-7328
Fax: (678) 602-4136

8712 LeSaint Drive
Fairfield, OH 45014
Tel: (513) 777-0009
Tel: (800) 552-3375
Fax: (513) 777-5863

25925 Telegraph Road
Suite 145
Southfield, MI 48034
Tel: (248) 357-7211
Fax: (248) 357-7241

6950 Alamo Downs Parkway,
Suite 100
San Antonio, TX 78238
Tel: (210) 684-8450
Tel: (800) 683-4000
Fax: (210) 684-3700

Oakesdale Commerce Center
820 Southwest 34th Street
Building W7, Suite A
Renton, WA 98057
Tel: (425) 291-9282
Tel: (888) 218-2600
Fax: (425) 291-9287



PROUD TO BE AWARDED
OFDA MANUFACTURER OF THE YEAR
2007, 2008, 2009, 2010, 2011 AND 2012



thinkglobal™

www.globaltotaloffice.com