

ROUGHING IN DIMENSIONS MAY VARY AND ARE SUBJECT TO CHANGE. NO RESPONSIBILITY IS ASSUMED FOR USE OF SUPERCEDED OR VOIDED DATA.



2100 SOUTH CLEARWATER DRIVE
DES PLAINES, ILLINOIS 60018-5999

FITTING NO.

E4JK

SUBMITTED MODEL NO.

JOB NAME

ITEM NO.

SUBMITTED AS SHOWN

SUBMITTED AS NOTED

SEE ATTACHED FOR
SUBMITTED MODIFICATION

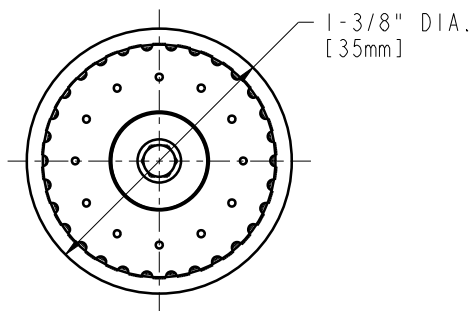
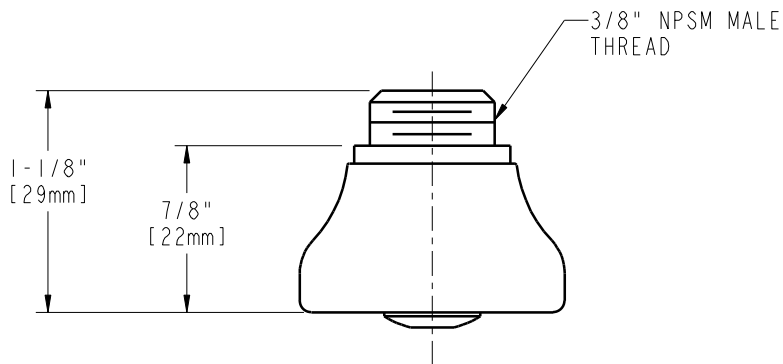

TECHNICAL DATA

- ROSE SPRAY OUTLET FITS GROUP B TYPE SPOUTS
- MULTI-STREAM SPRAY OUTLET
- 2.0 GPM [7.6 L/min.] MAXIMUM FLOW RATE
- FINISH: CHROME PLATE

DATE: 08-06-07

BY: SID

CHK'D:

APP'D:

REV:

E4JK