

**CHICAGO FAUCETS**  
a Geberit company

2100 South Clearwater Drive  
Des Plaines, IL 60018  
Phone: 847-803-5000  
Fax: 847-803-5454  
www.chicagofaucets.com

**REPAIR PARTS**

FITTING NO.

**350-317XKCP**

SUBMITTED MODEL NO.

ITEM NO.

BY: SID DATE: 08-31-09

CHK: *[Signature]* REV: 05-02-12

**FOR TECHNICAL ASSISTANCE**  
1-800-TEC-TRUE (1-800-832-8783)

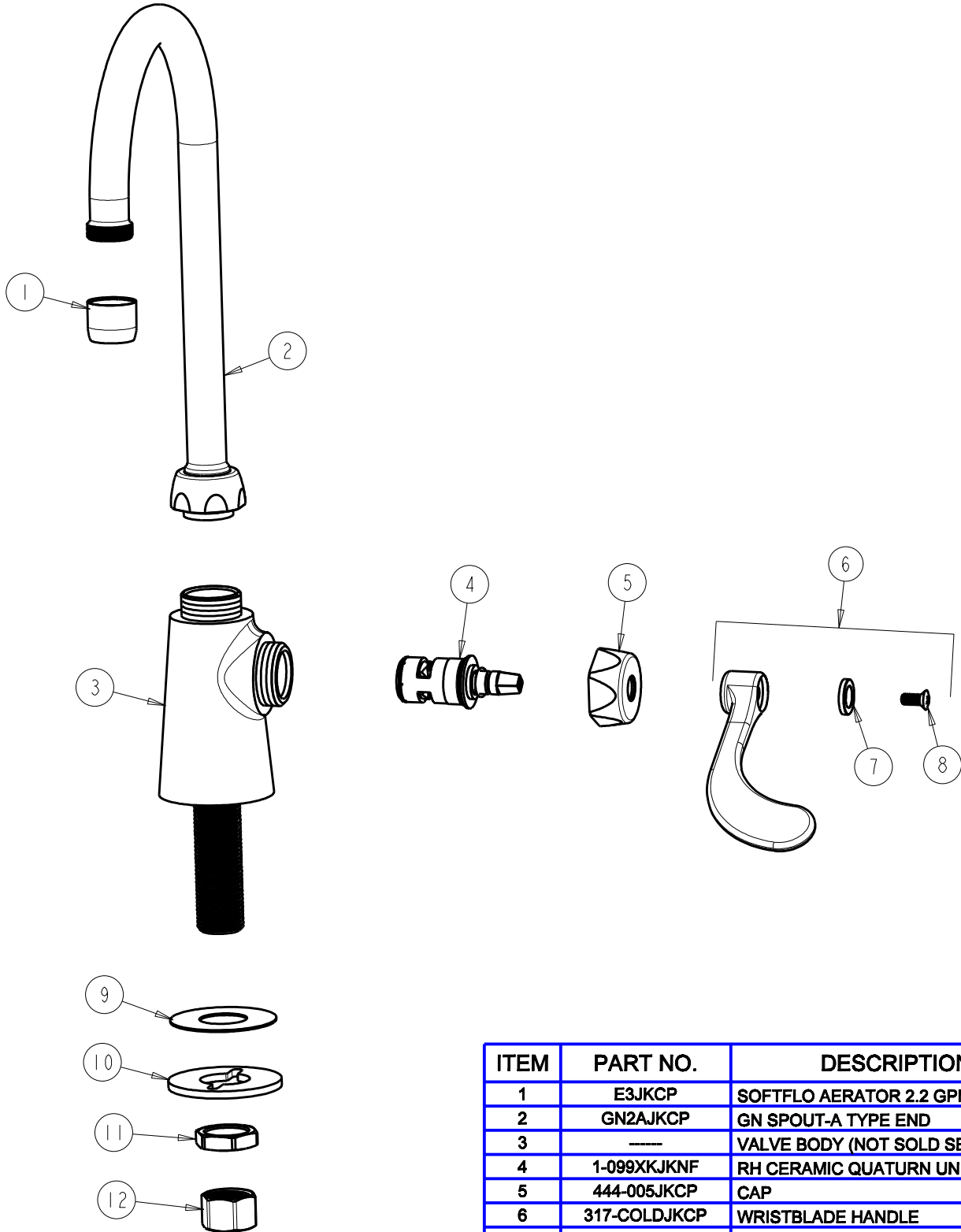

ITEM	PART NO.	DESCRIPTION
1	E3JKCP	SOFTFLO AERATOR 2.2 GPM
2	GN2AJKCP	GN SPOUT-A TYPE END
3	----	VALVE BODY (NOT SOLD SEPARATELY)
4	1-099XKJKNF	RH CERAMIC QUATURN UNIT
5	444-005JKCP	CAP
6	317-COLDJKCP	WRISTBLADE HANDLE
7	633-123JKNF	INDEX BUTTON (BLUE)
8	420-010JKRCF	SCREW, 10-32 UNC PH 1/2
9	52-007JKNF	WASHER, RUBBER
10	807-112JKNF	WASHER
11	49-004JKRBF	LOCKNUT
12	49-005JKRBF	COUPLING NUT