



CASEGOODS UPHOLSTERY LIGHTING RUGS ART ACCESSORIES



HOPLON | BOOKCASE

HOPLON is the strength of human soul, the fierce of the warriors. Composed by brass and leather, this unique shelf is inspired by the powerful structure of Spartan warriors.

Spartans were highly organized and their army was almost untouchable. In every warrior's soul there was the idea that he should return home carrying his hoplon, the golden shield, symbol of a winning battle.

Most of Spartans' victories came from their discipline and great organization as they believed that always the great god applies geometry to everything. HOPLON shelf represents the strength through organization, the strong structure that fits in your space's needs.

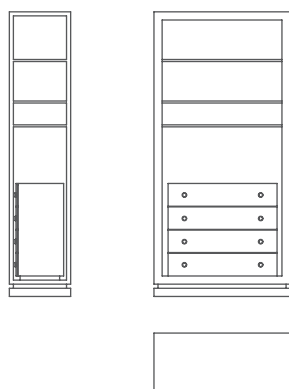

DIMENSIONS

WIDTH	100 cm 39,4"
DEPTH	45 cm 17,7"
HEIGHT	209 cm 82,3"

MATERIALS

Structure: Antique brushed brass
Drawers: poplar wood coated with synthetic leather

LEAD TIME

Production time is between 4 to 6 weeks for BRABBU collections.
Delivery time is not included.

All of our furniture can be made to measure and it is available in different finishes.