

Upper Storage Units

Right  ON SITE

07.14.2009

GEIGER

Installation Principles
59416

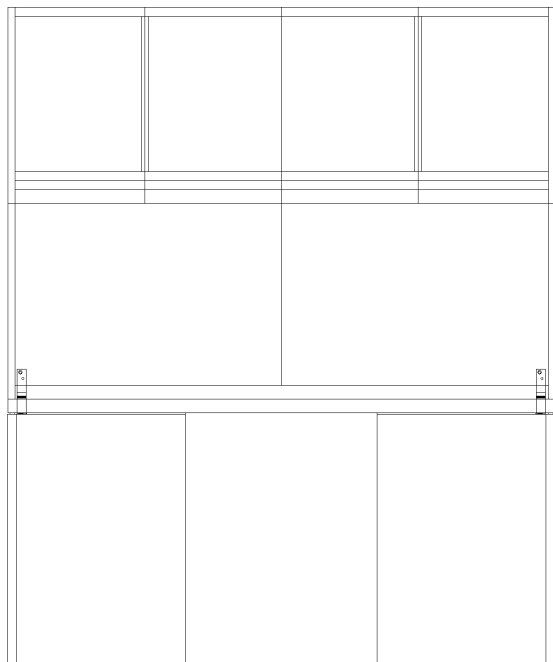

INSTALLATION TOOLS: To install Geiger upper storage units, you will need the following tools:

- Snips or scissors
- Screwdriver or power drill with screwdriver tip: Square (Robertson) #2
- CTBK kits, consisting of two hinged brackets, four 1" screws and four 3/4" screws

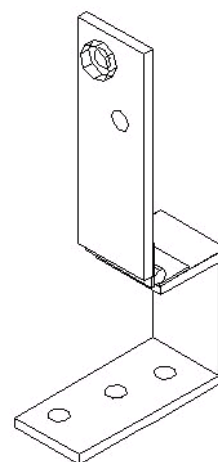

GENERAL NOTES: Correct installation of Upper Storage cabinets is important due to their weight and position above the user. These installation instructions are intended to be comprehensive. However, if you have additional questions, contact Geiger Customer Service at 1.800.456.6452.

As with all fine wood furniture, care should be taken not to scratch or dent the surfaces. Handle the product as few times as possible. Keep related parts together, but do not stack or lean pieces against each other.

Check plan view and elevation drawings to identify how many units go in each area or office, and make sure you are clear on how they are positioned or connected to each other. Never slide or drag Upper Storage Units across the floor, as the end panels may be damaged.

Product must be installed as shown using the screws and brackets provided. Product must be installed with the back of the unit adjacent to a wall. For free standing applications a special bracket kit must be requested from the manufacturer. Use of incorrect hardware could result in damage to the product, or installation failure.

Top Thickness	Part Number
1-3/16"	H59398-1
1-1/2"	H59398-2
2"	H59398-3

Countersink Head #2 Square tip

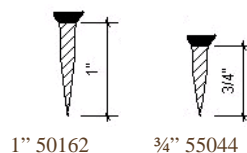

FINISHING TOUCHES

- Remove all masking tape from underneath cabinet, strip wire dividers, and install them in the holes provided in the bottom shelf.
- Wipe out all debris in cabinet (i.e. sawdust).
- Wipe down furniture using a soft damp cloth; always wipe with the grain direction. For greasy finger marks you may use a mild dishwashing soap diluted in warm water.
- Do not remove Care and Maintenance brochures supplied inside each top drawer.
- Do not use waxes, aerosol cleaners or abrasives as they may damage the finish.

Upper Storage Units

Right  ON SITE

07.14.2009

GEIGER

Installation Principles
59416

ATTACH SECURITY BRACKETS TO WORKSURFACE

Security brackets are installed to prevent movement of the Upper Storage Units.

STEP 1 – Trim the black plastic extrusion on the back modesty panel, or on the back edge of the pedestal to make room for the bracket. The bracket takes the place of the extrusion. The extrusion should be trimmed from the end of the worksurface to a point 2 ¼" from the end, or cut a 1 ¼" wide space from the inside edge of the end panel, if the cabinet does not run from one end of the worksurface to the other.

STEP 2 – Place the support panels or pedestals in their correct position.

STEP 3 – Place the worksurface on the support panels. Carefully slide the security bracket on to the back edge, in the space where the black plastic extrusion has been removed. You need a minimum of ¾" from the outside edge to clear the thickness of the Upper Storage end panels. **Leave the bracket hinged to facilitate placement of the upper storage unit.**

STEP 4 – Attach the security bracket to the underside of the worksurface with the 1" countersink screws provided. **DO NOT OVER-TORQUE SCREWS; STIPPING MAY RESULT.** Note that in some instances the bracket will be provided with a rubber spacer within the bracket for correct location.

STEP 5 – Place the worksurface, aligning the back edge of the worksurface flush to the back edge of the support panel, and secure the top with the screws provided.

PLACE THE UPPER STORAGE UNIT

STEP 6 – THE SUPPLIED CLOSED CELL FOAM MUST BE APPLIED TO THE FULL LENGTH OF THE END PANEL TO PREVENT ROCKING OR PIVOTING. Cut the closed cell foam to the length of the end panel. Peel off the paper backing, exposing the adhesive side to the bottom edge of the end panels.

STEP 7 – Carefully lift the Upper Storage Unit and place with back of end panels to back of top.

STEP 8 – Hinge the bracket upward and remove the safety bumper. Attach the security bracket to the inside face of the cabinet back, using the ¾" countersink screws provided.

STEP 9 – Install the tackboards per instructions.

Step 1

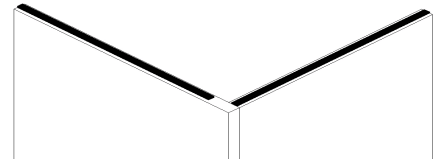

Steps 2, 3, & 4

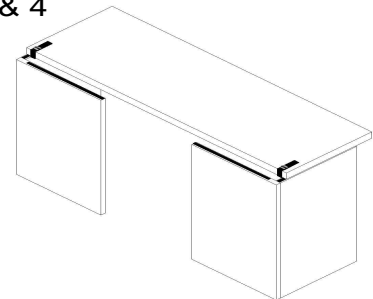

Step 5

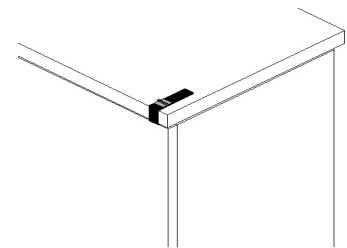

Steps 6 and 7

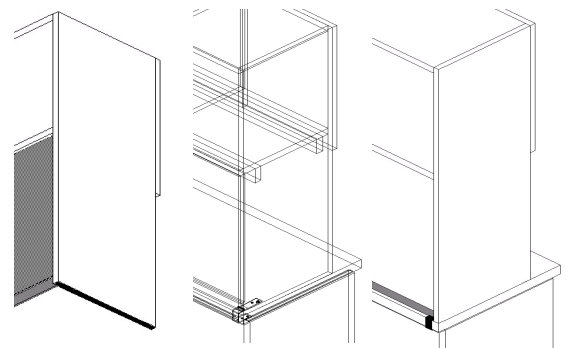

Steps 8 and 9

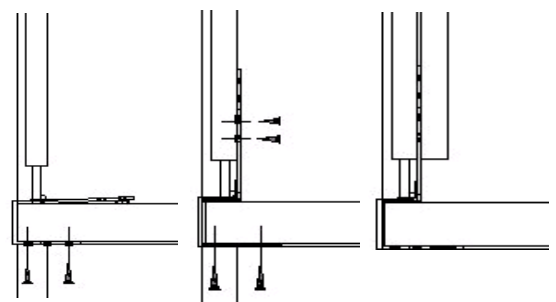

Upper Storage Units

Right  ON SITE

07.14.2009

GEIGER

Installation Principles
59416

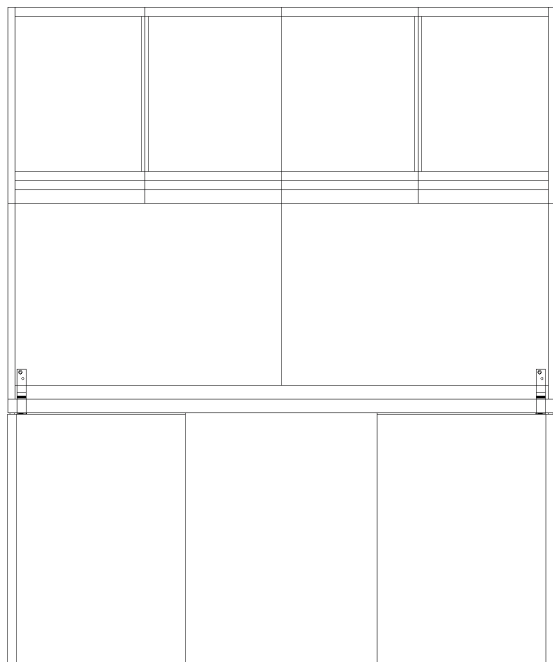

INSTALLATION TOOLS: To install Geiger upper storage units, you will need the following tools:

- Snips or scissors
- Screwdriver or power drill with screwdriver tip: Square (Robertson) #2
- CTBK kits, consisting of two hinged brackets, four 1" screws and four 3/4" screws

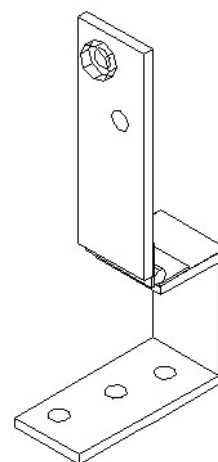

GENERAL NOTES: Correct installation of Upper Storage cabinets is important due to their weight and position above the user. These installation instructions are intended to be comprehensive. However, if you have additional questions, contact Geiger Customer Service at 1.800.456.6452.

As with all fine wood furniture, care should be taken not to scratch or dent the surfaces. Handle the product as few times as possible. Keep related parts together, but do not stack or lean pieces against each other.

Check plan view and elevation drawings to identify how many units go in each area or office, and make sure you are clear on how they are positioned or connected to each other. Never slide or drag Upper Storage Units across the floor, as the end panels may be damaged.

Product must be installed as shown using the screws and brackets provided. Product must be installed with the back of the unit adjacent to a wall. For free standing applications a special bracket kit must be requested from the manufacturer. Use of incorrect hardware could result in damage to the product, or installation failure.

Top Thickness	Part Number
1-3/16"	H59398-1
1-1/2"	H59398-2
2"	H59398-3

Countersink Head #2 Square tip

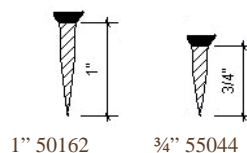

FINISHING TOUCHES

- Remove all masking tape from underneath cabinet, strip wire dividers, and install them in the holes provided in the bottom shelf.
- Wipe out all debris in cabinet (i.e. sawdust).
- Wipe down furniture using a soft damp cloth; always wipe with the grain direction. For greasy finger marks you may use a mild dishwashing soap diluted in warm water.
- Do not remove Care and Maintenance brochures supplied inside each top drawer.
- Do not use waxes, aerosol cleaners or abrasives as they may damage the finish.

Upper Storage Units

Right  ON SITE

07.14.2009

GEIGER

Installation Principles
59416

ATTACH SECURITY BRACKETS TO WORKSURFACE

Security brackets are installed to prevent movement of the Upper Storage Units.

STEP 1 – Trim the black plastic extrusion on the back modesty panel, or on the back edge of the pedestal to make room for the bracket. The bracket takes the place of the extrusion. The extrusion should be trimmed from the end of the worksurface to a point 2 ¼" from the end, or cut a 1 ¼" wide space from the inside edge of the end panel, if the cabinet does not run from one end of the worksurface to the other.

STEP 2 – Place the support panels or pedestals in their correct position.

STEP 3 – Place the worksurface on the support panels. Carefully slide the security bracket on to the back edge, in the space where the black plastic extrusion has been removed. You need a minimum of ¾" from the outside edge to clear the thickness of the Upper Storage end panels. **Leave the bracket hinged to facilitate placement of the upper storage unit.**

STEP 4 – Attach the security bracket to the underside of the worksurface with the 1" countersink screws provided. **DO NOT OVER-TORQUE SCREWS; STIPPING MAY RESULT.** Note that in some instances the bracket will be provided with a rubber spacer within the bracket for correct location.

STEP 5 – Place the worksurface, aligning the back edge of the worksurface flush to the back edge of the support panel, and secure the top with the screws provided.

PLACE THE UPPER STORAGE UNIT

STEP 6 – THE SUPPLIED CLOSED CELL FOAM MUST BE APPLIED TO THE FULL LENGTH OF THE END PANEL TO PREVENT ROCKING OR PIVOTING. Cut the closed cell foam to the length of the end panel. Peel off the paper backing, exposing the adhesive side to the bottom edge of the end panels.

STEP 7 – Carefully lift the Upper Storage Unit and place with back of end panels to back of top.

STEP 8 – Hinge the bracket upward and remove the safety bumper. Attach the security bracket to the inside face of the cabinet back, using the ¾" countersink screws provided.

STEP 9 – Install the tackboards per instructions.

Step 1

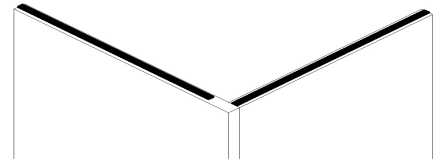

Steps 2, 3, & 4

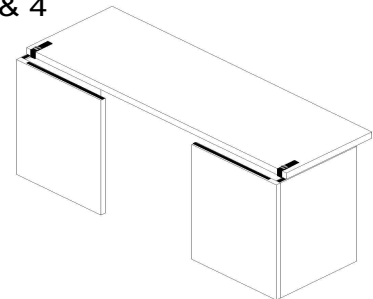

Step 5

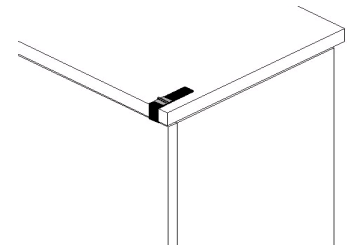

Steps 6 and 7

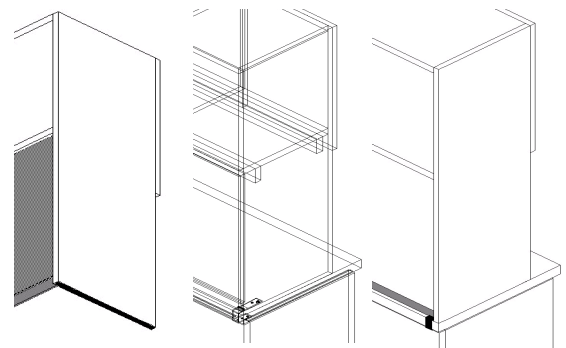

Steps 8 and 9

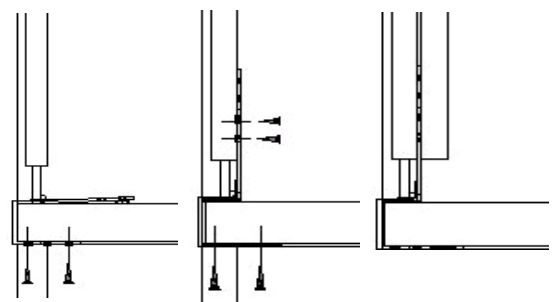

Side Tower-Overhead Combination

Revised 11/12/05

Installation of Side Tower-Overhead Combination units is easy when the correct SEQUENCE is followed.

Your unit consists of the following components:

1. Right Hand Side Tower
2. Left Hand Tower
3. Center Overhead
4. Lower Back Panel
5. Task Light
6. Tack Board
7. Temporary Overhead Support Fillers (2)

Installation Sequence:

- A. Carefully Place and position Towers on the worksurface. Separate them by the width of the center overhead.
- B. Install the lower back between the 2 side towers using the 4 L-brackets in the supplied kit. The side towers and back are pre-drilled to locate the brackets. The brackets should be on the front face of the back, and will be covered later by the tackboards.
- C. Apply the supplied felt strips on the bottoms of the 2 temporary overhead supports. Place them felt side down, against the Right and Left Side Towers, and clamp them in place.
- D. Carefully rest Center Overhead on the supports, hold securely while threading the hardware between the cabinets.
- E. Secure inter-cabinet hardware.

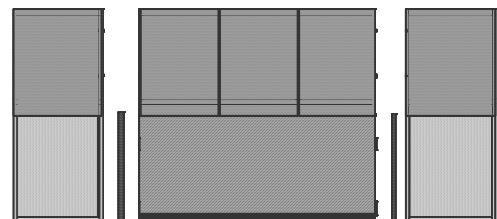
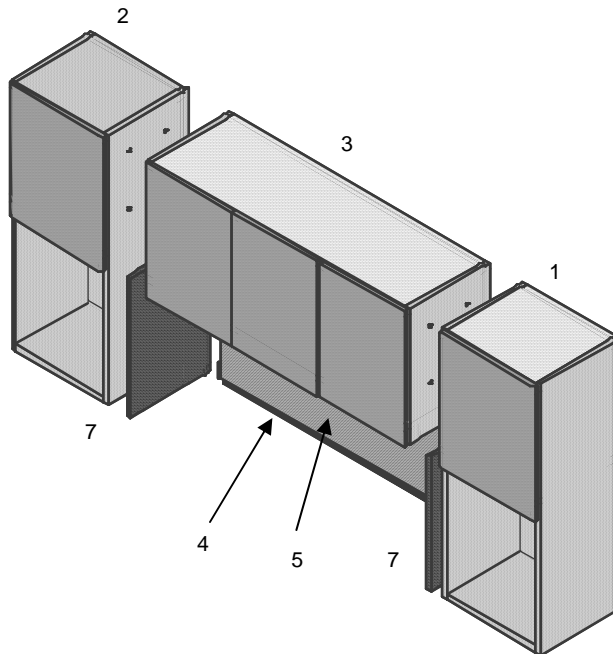

A,B

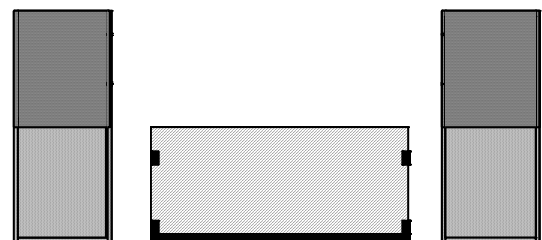

D,E

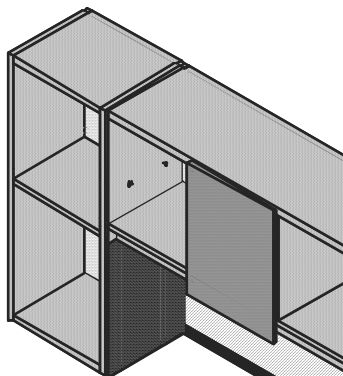

C



F. Install Tasklight using hardware provided.
G. Thread the cord from the tasklight through hole the back rail under the overhead (if provided) and into the wire management channel in the tackboard.

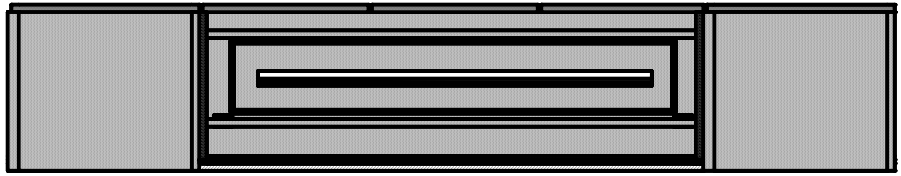

I. Position the tackboard under the cabinet so that a 1-1/2" inch gap exists between the worksurface and the underside of the tackboard and press firmly to engage the hook and loop material.

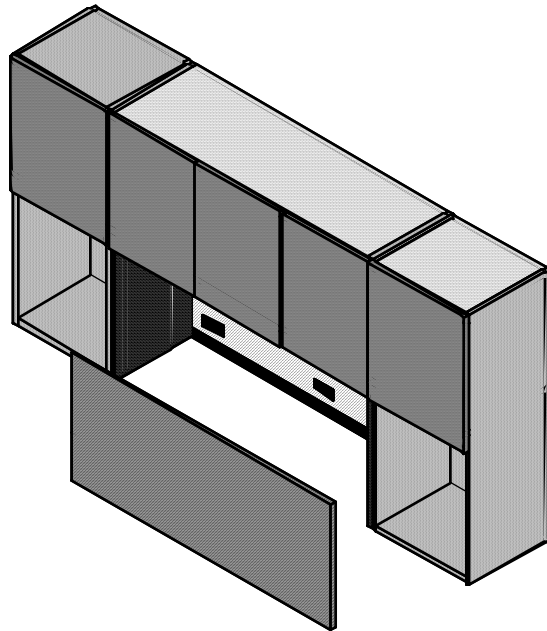

Tablet™, Petri™, Eco™ & Triuna™ Wall Mounted Overheads

Right  ON SITE

GEIGER

October 28, 2004

GENERAL NOTES

These installation instructions are intended to be comprehensive for Tablet, Petri, Eco and Triuna Wall Mounted Overheads. If you have questions contact Geiger Customer Service by dialing 1.800.456.6452.

As with all fine wood furniture, care should be taken not to scratch or dent the surfaces. Handle the product as few times as possible. Keep related parts together, but do not stack or lean pieces against each other. Never slide or drag furniture across the floor.

Product must be installed as shown using the screws and brackets provided. Use of incorrect hardware could result in damage to the product.

INSTALLATION TOOLS

- Cordless drill
- Drill Bits
- Screwdriver or screwdriver tip: square (Robertson) #2, Phillips #2
- Level
- Staple Gun with 5/8" or 3/4" staples

SCREWS - Not Provided

GETTING STARTED

Note: Geiger provides the bracketry required to hang the wall mounted overheads, however it is the responsibility of the installers to mount the brackets securely and appropriately to the wall. The dimensions provided allow for the installation of a Geiger wall mounted tackboard. If a tackboard is not to be used, the overhead can be mounted at any height.

WALL MOUNTED OVERHEAD WITH STANDARD TACKBOARD

Step 1 – The wall mounting cleat ships attached to the back of the overhead. Using a #2 Robertson bit screwdriver, remove the cleat from the cabinet.

Step 2 – Starting from the highest point of the floor, measure up to locate the hanging cleat.

Step 3 – Mark the desired height of the cleat and using a level, draw a line to locate the bottom of the cleat.

Step 4 – Locate the hanging cleat on the line, centered on the space the overhead will hang. The hanging cleat is made approximately 4" shorter than the cabinet to allow for lateral adjustment. Mark the rail with the drilling locations required for mounting.

Step 5 – Drill the hanging cleat (wall attached portion) for the mounting hardware i.e., screws, toggle bolts, etc. The first screws and/or toggles should be started 2" down and 2" over from the top corner of the cleat on both sides. Stagger the rest 6 – 8" apart per the diagram below. The top row should be 2" down from the top of the cleat and the bottom row should be 4" down from the top of the cleat. In addition, locate studs and secure with two screws per stud. It is the responsibility of the installer to use appropriate fastening hardware for the existing conditions.



Tablet™, Petri™, Eco™ & Triuna™ Wall Mounted Overheads

Right ON SITE

GEIGER

October 28, 2004

Tablet Wall Mount Overhead with Project Shelf. Shown with Plain Tackboard

Note: Overall height dimensions are dependant on leveling conditions. Blocking and wall construction is determined by others.

Technical Data

Overheads

Friday, October 22, 2004
Revision No. 0
Drawn By: John Leach

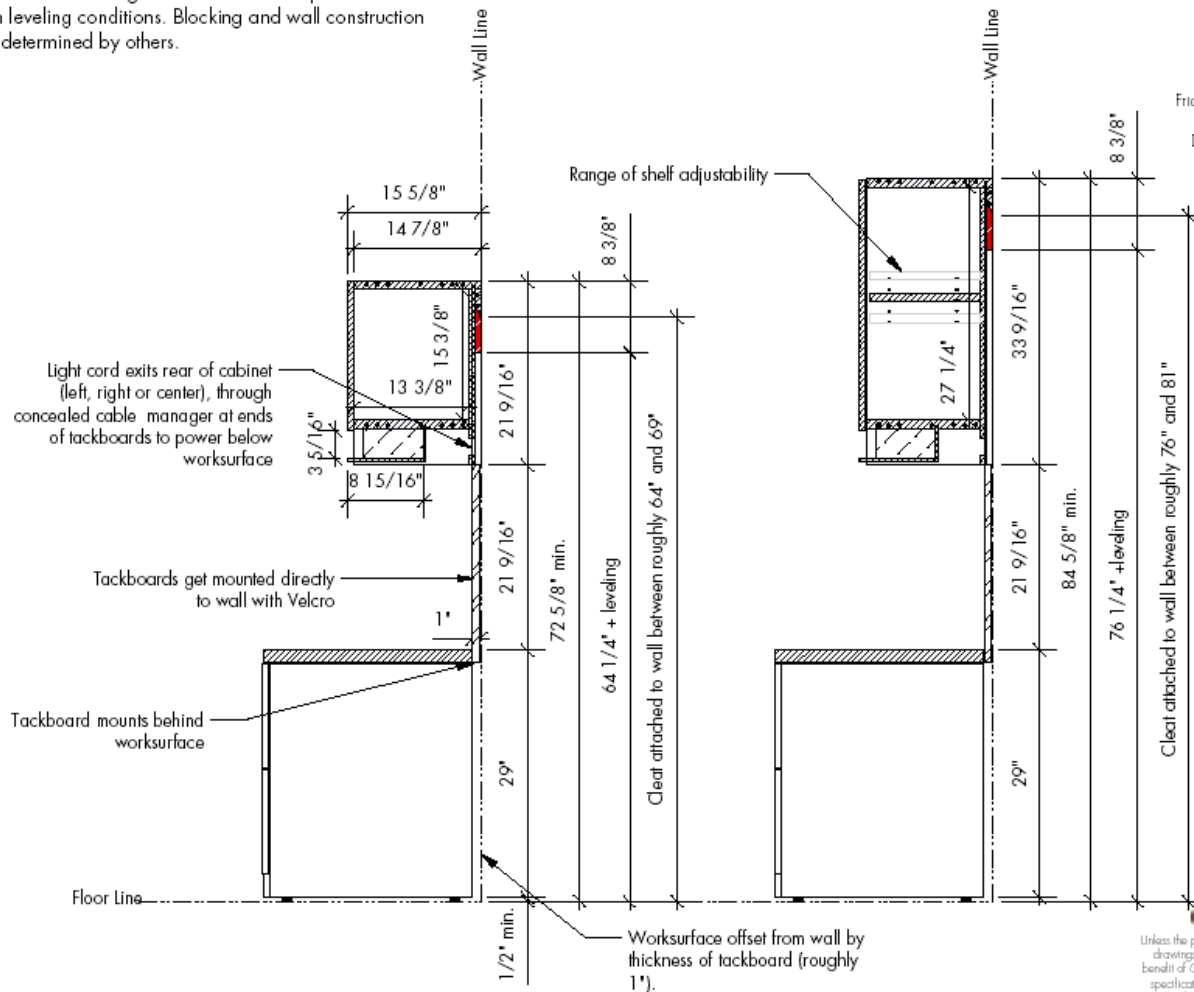

Step 6 – Raise the overhead above the hanging cleat and lower into position.

Step 7 –The bottom of the overhead has shoulder screws in place to accept the task light. Position the task light around the shoulder screws and tighten the shoulder screws to secure the fixture.

Step 8 – If a Geiger tackboard is being used, locate and staple the provided hook and loop strips to the wall.

Step 9 – Geiger tackboards provide wire management channels on the rear side. Pass the task light cord out the back of the cabinet and run it down the wire management channel in the tackboard.

Step 10 – Keeping the task light cord in the wire channel, hold the tackboard against the bottom side of the overhead and flush with the ends, press the tackboard against the wall engaging Velcro strips.

Note: *the hook and loop connection is very strong. Make sure the tack boards are aligned where desired before pressing hook and loop strips firmly together.*

Step 11 – Place the credenza or rear unit against the wall below the overhead. The tack board will extend approximately 1 1/2" below the worksurface.

Tablet™, Petri™, Eco™ & Triuna™ Wall Mounted Overheads

Right ON SITE

GEIGER

October 28, 2004

WALL MOUNTED OVERHEAD WITH DIVIDED TACKBOARD AND TOOLRAIL

Step 1 - The wall mounting cleat ships attached to the back of the overhead. Using a #2 Robertson bit screwdriver, remove the cleat from the cabinet.

Step 2 - Starting from the highest point on the floor, measure up to locate the hanging cleat.

Step 3 - Mark the desired height of the cleat and using a level, draw a line to locate bottom of the cleat.

Step 4 - Locate the hanging cleat on the line, centered on the space the overhead will hang. The hanging cleat is made approximately 4" shorter than the cabinet to allow for lateral adjustment. Mark the rail with the drilling locations required for mounting.

Tablet Wall Mount Overhead with Project Shelf. Shown with Toolrail Tackboard

Note: Overall height dimensions are dependant on leveling conditions. Blocking and wall construction is determined by others.

Technical Data

Overheads

Friday, October 22, 2004
Revision No. 0
Drawn By: John Leach

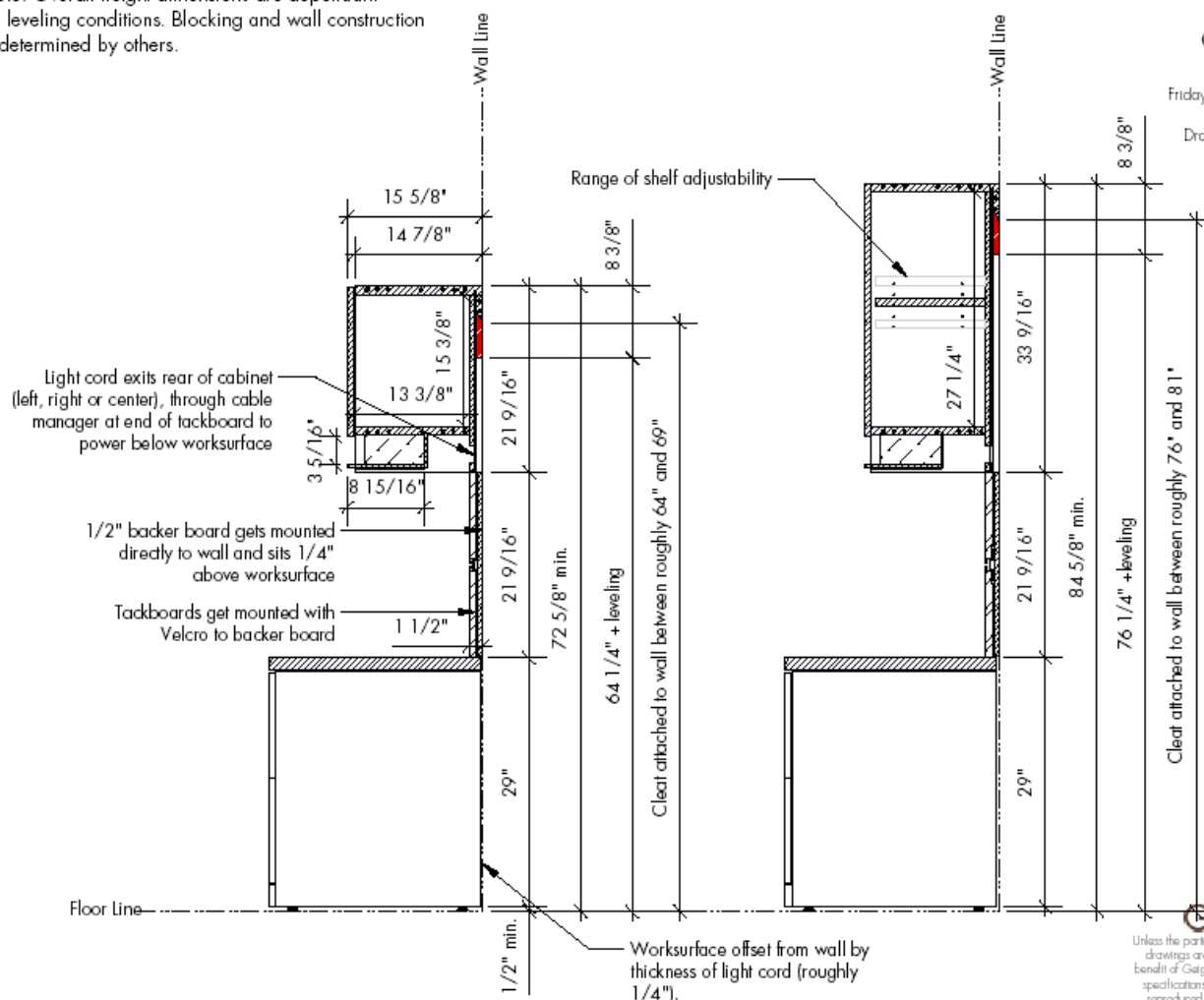

GEIGER

Unless the parties otherwise agree in writing, these drawings are the property of and true to the benefit of Geiger International, Inc. Drawings and specifications are confidential and must not be reproduced or used to manufacture products without Geiger's prior written permission.

Tablet™, Petri™, Eco™ & Triuna™ Wall Mounted Overheads

Right  ON SITE

GEIGER

October 28, 2004

Step 5 – Drill the hanging cleat (wall attached portion) for the mounting hardware i.e., screws, toggle bolts, etc. The first screws and/or toggles should be started 2” down and 2” over from the top corner of the cleat on both sides. Stagger the rest 6 – 8” apart per the diagram below. The top row should be 2” down from the top of the cleat and the bottom row should be 4” down from the top of the cleat. In addition, locate studs and secure with two screws per stud. It is the responsibility of the installer to use appropriate fastening hardware for the existing conditions.



Step 6 – Raise the overhead above the hanging cleat and lower into position.

Step 7 – The bottom of the overhead has shoulder screws in place to accept the task light. Position the task light around the shoulder screws and tighten the shoulder screws to secure the fixture.

Step 8 - Snap the wire management channel into the groove on the side of the backer board. Slide vertically until it aligns with height of the backer board.

Step 9 – Position backer board with wire management channels so that it sits flush to the end gables and directly underneath the overhead. The backer board should be positioned so that the large holes are below the toolrail.

Step 10 – Mount backer board directly to the wall at the smaller pre-drilled holes. Do not use larger holes for attaching to wall.

Step 11 - Snap sockets, which are bagged with the tackboards, into the large holes on the backer board.

Step 12 - Place tackboards against the backer board engaging velcro strips. Sockets should align with (piece) and snap into place. If wire management channels have been specified, be sure to use the shorter tackboards on the same side as the wire management channel. The tackboard will overhang the bottom of the backer board by ¼”. (Note: the hook and loop connection is very strong. Make sure the tackboards are aligned where desired before pressing hook and loop strips firmly together.)

Step 13 – Pass the task light cord out the back of the cabinet and run it down through the wire management channel.

Step 14 – Place the credenza or rear unit against the wall below the overhead. Level the worksurface to the bottom of the tackboard so that the tackboard sits directly above the worksurface.

FINISHING TOUCHES

- Remove all masking tape from underneath cabinet, back of drawers, etc.
- Wipe down furniture using a soft, damp cloth; always wipe with the grain direction. For greasy finger marks, you may use a mild dishwashing soap diluted in warm water. Wipe out all debris in cabinet.
- Do not use waxes, aerosol cleaners or abrasives as they may damage the finish.
- Leave Care and Maintenance brochures supplied inside each top drawer.

Triuna Collection

Right ON SITE INSTALLATION PRINCIPLES

03.11.96

Geiger BRICKEL

Triuna Collection Typical Configuration

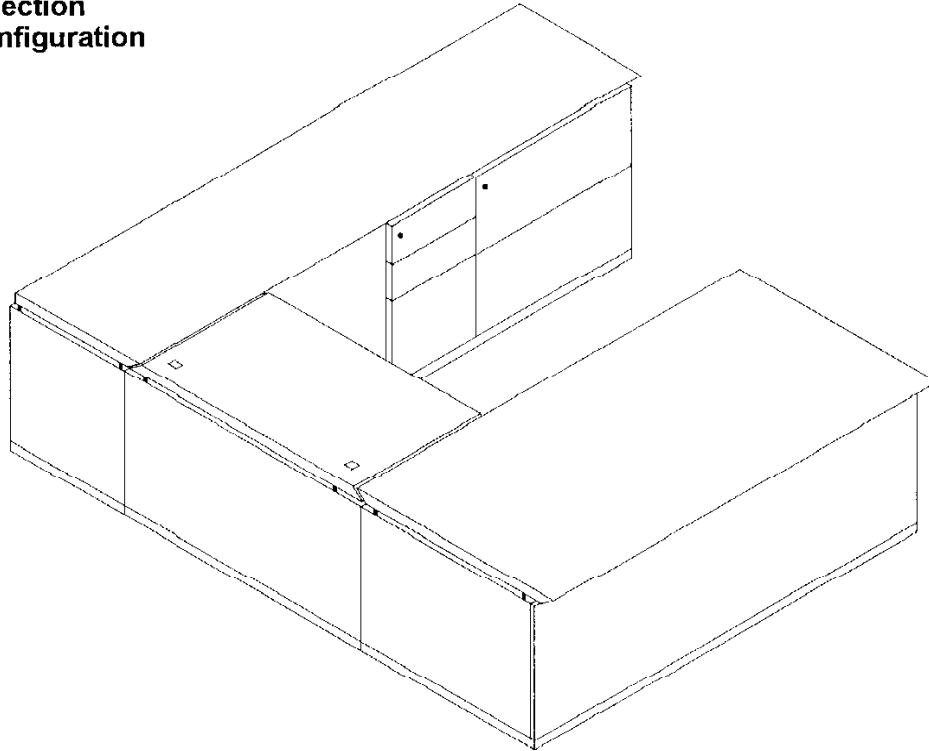

General Notes

This diagram is a representation of a typical Triuna configuration. Your configuration may differ. This reference guide illustrates the general installation principles used for installing the Triuna Collection. If you need additional information, phone 1.800.456.6452.

As with all fine wood furniture, care should be taken not to scratch or dent the surfaces. Handle the product as few times as possible. Keep related parts together, but do not stack or lean pieces against each other.

Check plan view and elevation drawings to identify how many units go in each area or office, and make sure you are clear on how they are positioned or connected to each other. Never slide or drag furniture across the floor.

Product must be installed as shown using the screws and brackets provided. Use of incorrect hardware could result in damage to the product.

To begin the installation, start with the wall based furniture. Build out into the middle of the room, taking care to level furniture to the highest spot in the floor.

Installation Tool Box

You will need the following tools to install the Triuna Collection:

- pry bar
- pencil
- 1/4" nut driver
- tape measure
- flat blade screwdriver
- 4 foot carpenters level
- cordless drill with phillips head, #2 square tip and 3/16" drill bits

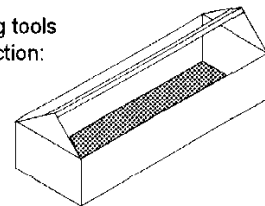

Finishing Touches

Remove masking tape from file bars located inside all file drawers.

Wipe out all debris from drawers (i.e., saw dust).

Wipe down furniture using a soft damp cloth; always wipe with the grain direction. For greasy finger marks you may use a mild dish washing soap.

Do not remove Care and Maintenance Brochures supplied inside each top drawer.

Do not use waxes, aerosol cleaners or abrasives as they may damage the finish.

Right ON SITE INSTALLATION PRINCIPLES

03.11.96

Typical Rear Unit with electrical access back

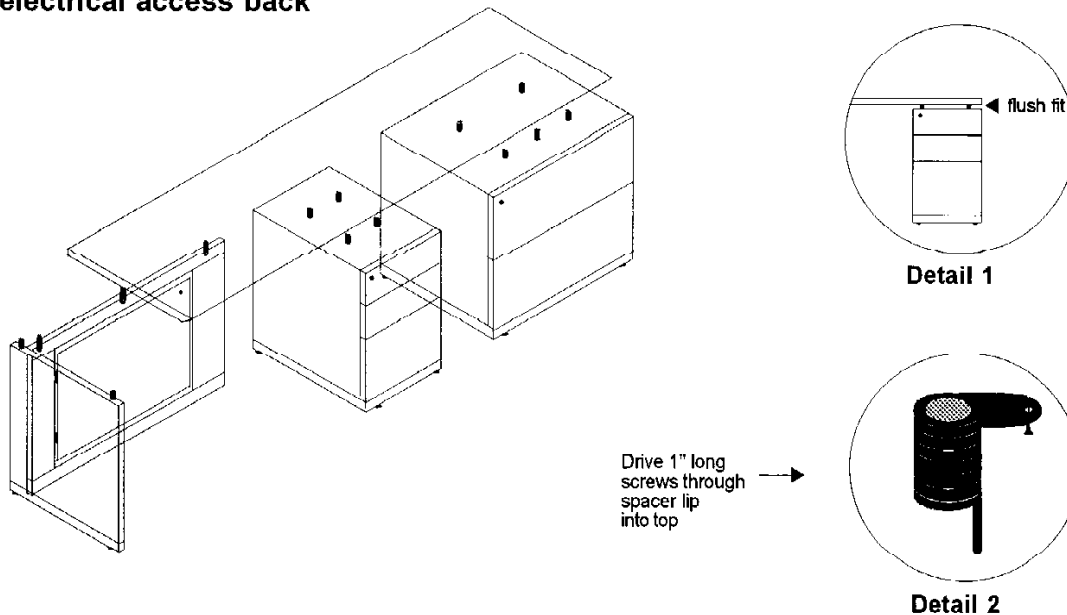

Principles for installing a basic Rear Unit with electrical access back:

Step 1 • Place floor units in their correct positions.

Step 2 • Locate, measure and install Mod-eez® shoulder screws for electrical access panels only (See Diagram "A"). Plain panels, proceed to Step 4.

Step 3 • Lift electrical access panel with door knob facing knee space area and slide panel ends downward over the shoulder screws until panel is flush with top and bottom of pedestal.

Step 4 • Level floor units by starting with one nearest wall and work outward. Place carpenter's level on top of unit and examine leveling from side to side. Adjust floor glides by turning them clockwise or counterclockwise as necessary. Place level running from front to back of same unit and adjust glides accordingly. Repeat this step for each unit. Check that all storage units are level with the same elevation as the other storage units. (Note: Proper leveling will result in a flush fit between panel ends and storage unit cases. There should be NO visible gaps.)

Special Note • If a Bridge Return with Panel has been ordered, the bridge panel must be installed prior to attaching the rear credenza and desk tops. To attach bridge panel, follow Steps 1–3 of "Typical U Return with Panel" instructions. When completed, return here and proceed to Step 5.

Step 5 • Remove 1-1/2" storage spacers from hardware box shipped separately. (See Diagram "C", Detail 8.) Place storage spacers into the machined holes on top of storage units.

Step 6 • Lift top and place down over floor units. Ends of top must be flush with sides of floor units (See Detail 1). The user edge detail overhang is 2". Refer to Edge Overhang Drawing.

Step 7 • Attach storage units to top. Start with the outer storage unit, follow instructions outlined in Diagram "B" for "Drawer Box Removal". Once drawer boxes are removed from unit, continue with instructions in Diagram "C" for "Attaching Pedestals and Low Storage".

Step 8 • Attach support panel to the underside of top by first removing supplied bag of screws from panel spacer. Drive 1" long wood screw through the hole of panel spacer into underside of top (See Detail 2). **Use only 1" long screws to attach panel spacers to tops.**

Step 9 • Reinstall drawer boxes. Refer to Diagram "B" for "Drawer Box Installation".

Step 10 • Recheck the level. Check to be sure that all the glides are touching the floor so that the unit is properly supported.

Step 11 • Install all Lock Plugs. Refer to Lock Plug Installation Instructions included with supplied Installation Key.

Right ON SITE INSTALLATION PRINCIPLES

03.11.96

Typical Desk

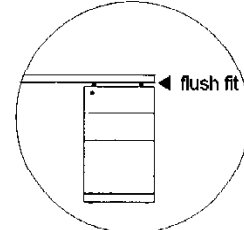
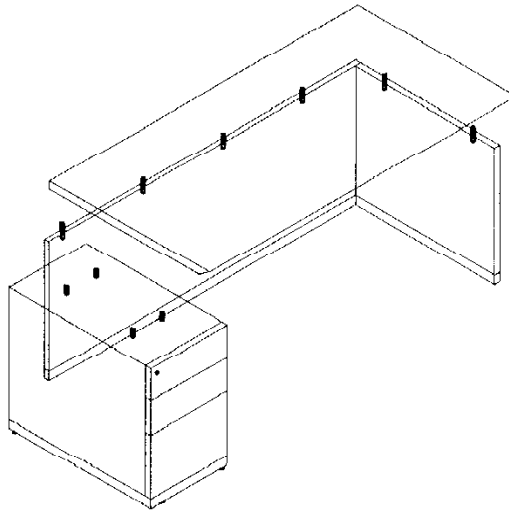

Detail 1

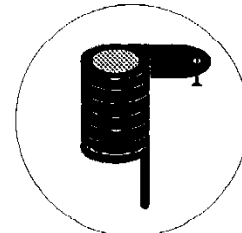

Detail 2

Drive 1" long
screws through
spacer lip
into top

Principles for installing a basic Desk:

Step 1 • Place floor units in their correct positions.

Step 2 • Level floor units by starting with the one nearest the wall. Place carpenter's level on top of unit and examine leveling from side to side. Adjust floor glides by turning them clockwise or counter-clockwise as necessary. Place level running from front to back of same unit and adjust glides accordingly. Repeat this step for each unit. Check that all pedestals are level with the same elevation as the other pedestals. (Note: Proper leveling will result in a flush fit at end of desk panel and back side of pedestal. There should be NO visible gaps.)

Step 3 • Attach pedestal to desk panel by first removing pedestal drawer boxes (See Diagram "B" for "Drawer Box Removal"). Next, remove supplied bag of screws taped to panel spacer on desk panel. Separate 1-1/2" and 1" screws. From inside pedestal case, predrill four 3/16" clearance holes, through back of pedestal case, one near each corner. Hold desk panel flush against back of pedestal case, drive 1-1/2" long screws through predrilled holes at back of pedestal case into desk panel.

Special Note • If a Bridge Return with Panel has been ordered, the bridge panel must be installed prior to attaching the desk and rear credenza tops. To attach bridge panel, follow Steps 1-3 of "Typical Bridge Return with Panel" instructions. When completed, return here and proceed to Step 4.

Step 4 • Remove 1-1/2" storage spacers from hardware box shipped separately. (See Diagram "C", Detail 8.) Place storage spacers into the machined holes on top of storage units.

Step 5 • Lift top and place down over floor units. Ends of top must be flush with sides of floor units (See Detail 1). The user edge detail overhang is 2". Refer to Edge Overhang Drawing.

Step 6 • Attach pedestals to top by following instructions in Diagram "C" for "Attaching Pedestals and Low Storage".

Step 7 • Complete the attachment of the desk panel to the underside of top by first removing supplied bag of screws from panel spacer. Drive 1" long wood screw through the hole of panel spacer into underside of top (See Detail 2). **Use only 1" long screws to attach panel spacers to tops.**

Step 8 • Reinstall drawer boxes. Refer to Diagram "B" for "Drawer Box Installation".

Step 9 • Recheck the level. Check to be sure that all the glides are touching the floor so that the unit is properly supported.

Step 10 • Install all Lock Plugs. Refer to Lock Plug Installation Instructions included with supplied Installation Key.

Right ON SITE INSTALLATION PRINCIPLES

03.11.96

Typical U Return With Panel

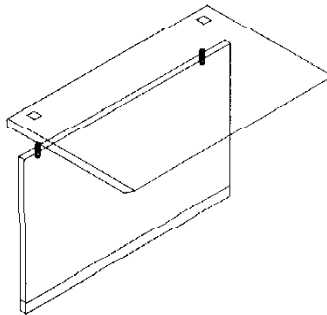

Principles for installing a basic U Return with Panel:

Step 1 • Measure bridge panel width to ensure you have allowed proper distance for installing bridge unit between Desk and Rear Unit. Make adjustments if necessary.

Step 2 • Place bridge panel in position (with panel spacers facing knee space area). Bridge panel must be flush at ends as well as top and bottom of adjoining panels. This can be accomplished by raising or lowering the floor glides on the bridge panel and the adjoining panels until a flush fit is acquired. There should be NO visible gaps.

Step 3 • Install supplied panel connecting plates at bottom of panel. Refer to Bracket Kit Installation Instructions included with each kit.

Note • You must complete Steps 4–10 for Desk and Steps 5–11 for Rear Unit before proceeding to Step 4 following.

Typical U Return Top only

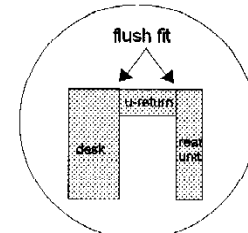
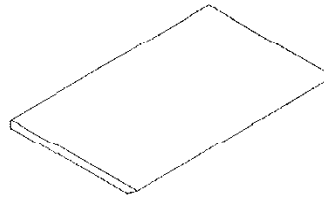

Detail 3

Step 4 • Install supplied flat brackets to underside of desk top and credenza top. Leave flat brackets loose to allow bridge top to be slid into place. Refer to Bracket Kit Installation Instructions included with each kit.

Step 5 • Once adjoining tops have been installed, slide bridge top into place. Align bridge top at rear so it is flush with desk top and rear unit top (See Detail 3). Now adjust side of bridge top until flush with user side of rear unit top. Complete the attachment of flat brackets to underside of bridge top at rear unit end and tighten all screws before proceeding to Step 6. (Note: Hold down top to prevent movement when driving screws.)

Step 6 • Push desk up tight to bridge top until flush. Complete attachment of brackets to underside of bridge top and tighten all screws.

Step 7 • Attach bridge panel to the underside of top by first removing supplied bag of screws from panel spacer. Drive 1" long wood screw through the hole of panel spacer into underside of top (See Detail 2). **Use only 1" long screws to attach panel spacers to tops.**

For U Return Top only
Follow steps 4, 5 and 6

Edge Overhang Detail

Edge Overhang is shown in relation to end panels, pedestals, and low storage unit fronts on user side of product.

2" Edge Overhang

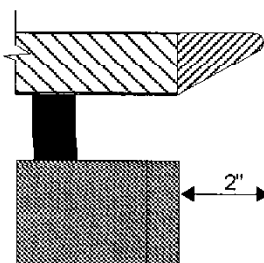

E12 Knife

Right ON SITE INSTALLATION PRINCIPLES

03.11.96

Diagram 'A'

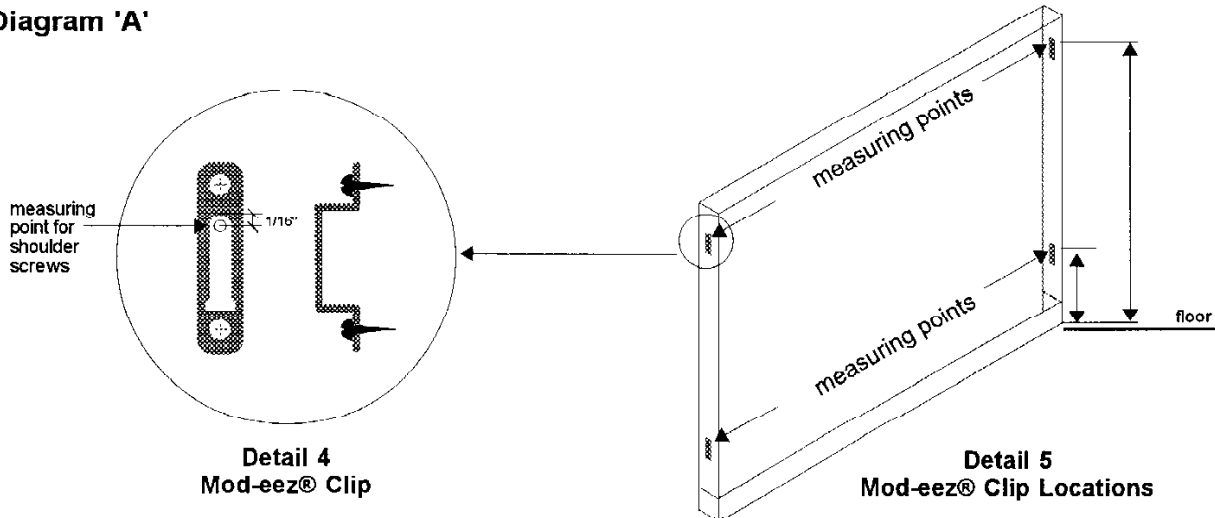

Mod-eez® Shoulder Screw Locations

Step 1 - Measure Mod-eez® clip locations on panel end or ends. Start from bottom of panel and measure upward to clip. You must take each measurement by starting at the bottom of the panel (See Detail 5). **Do not** measure from the floor. Stop 1/16" below the top of slot and note dimension (See Detail 4).

Step 2 - At the rear side of storage unit or support panel facing knee space area, measure inward at top and bottom of unit, either 5" or 6" (See Detail 6). With the dimensions taken in Step 1 measure from the bottom of the storage unit or support panel. Mark each hole location along the imaginary center line (See Detail 6). **Do not** measure from the floor.

Special Note - If a double storage Credenza Unit is ordered, the Electrical Access Panel should be recessed 5" in from the back of storage units.

Step 3 - Drill a 1/8" pilot hole, 1/2" deep into the marked locations on storage unit or support unit.

Step 4 - Screw shoulder screws into drilled holes.

Step 5 - Lift electrical access panel with door knob facing knee space area and slide panel end or ends downward over the shoulder screws until panel is flush with bottom of storage unit or support panel.

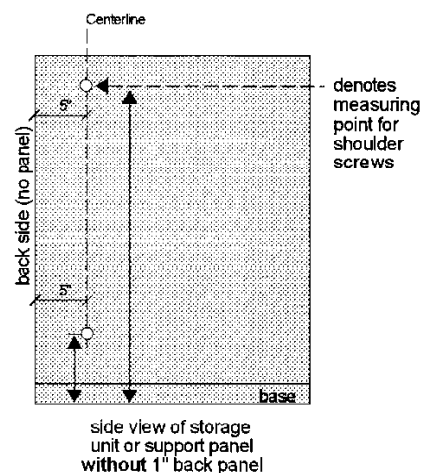
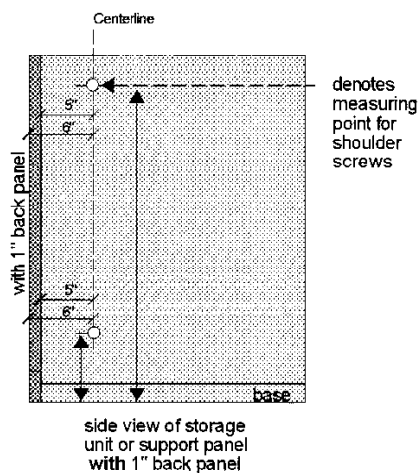

Detail 6
Shoulder Screw Locations

Right ON SITE INSTALLATION PRINCIPLES

03.11.96

Diagram 'B'

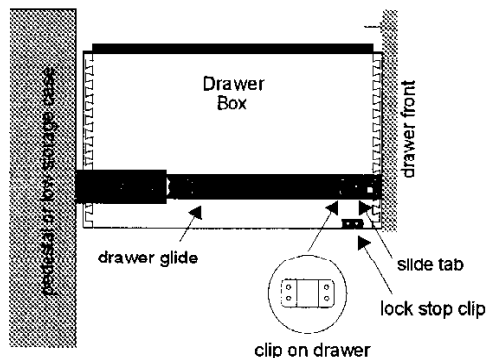

Drawer Box Removal

Step 1 • Start with top drawer and pull drawer box out until slides are fully extended.

Step 2 • Using a flat head screwdriver, place tip of screwdriver at bottom of slide tab and turn screwdriver in order to unsnap it from drawer box clip. Repeat for slide on other side of drawer box.

Step 3 • To remove box, you *must* lift front of box until rear clips release, then pull up and outward (see Detail 7). Use caution not to tear off lock stop clip. Keep drawer boxes in order to ensure proper alignment and veneer matching.

Step 4 • Repeat Steps 1–3 for each drawer box.

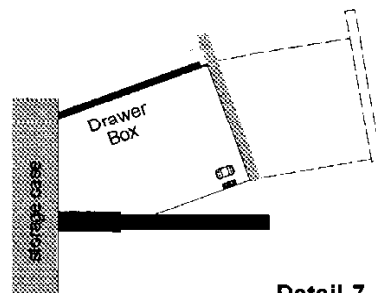

Detail 7

Drawer Box Installation

Step 1 • Start with bottom drawer and pull out slides until fully extended.

Step 2 • Place drawer box in position so that drawer box clips align directly over slide tabs.

Step 3 • Apply pressure to back sides of drawer box until it snaps down into place.

Step 4 • Push drawer in leaving approximately three inches open. Push down on front sides of drawer box until the clips snap into the slide tabs.

Step 5 • Close drawer slowly. There should be an evenly spaced 1/8" gap across the top of the drawer front. If not, repeat Steps 3 and 4.

Step 6 • Follow Steps 1–5 to install remaining drawer boxes.

Diagram 'C'

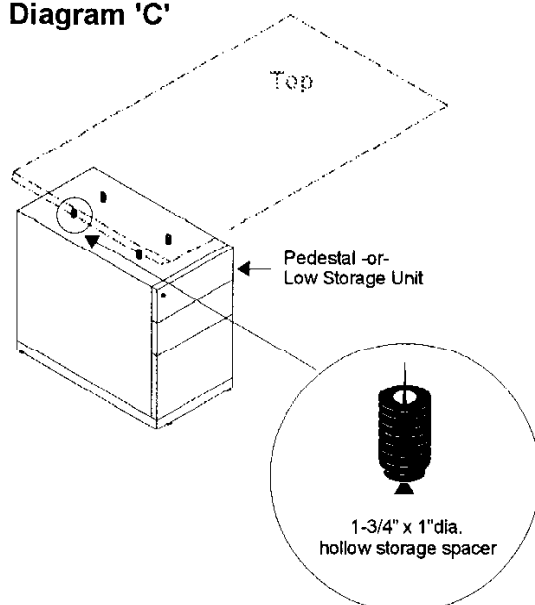

Detail 8

Attaching Pedestals and Low Storage

Step 1 • Starting with the outer storage unit, remove all drawer boxes (See Diagram "B").

Step 2 • Remove 2-1/2" long wood screws from supplied spacer hardware box.

Step 3 • From inside the storage unit case, drive 2-1/2" long wood screws upward through the pre-drilled holes in storage unit top, through the 1-1/2" spacer and into the underside of top. (Note: Hold down top to prevent movement when driving screws.)

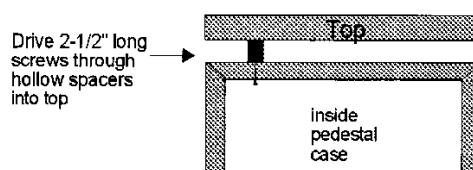

Drawer Removal and Installation

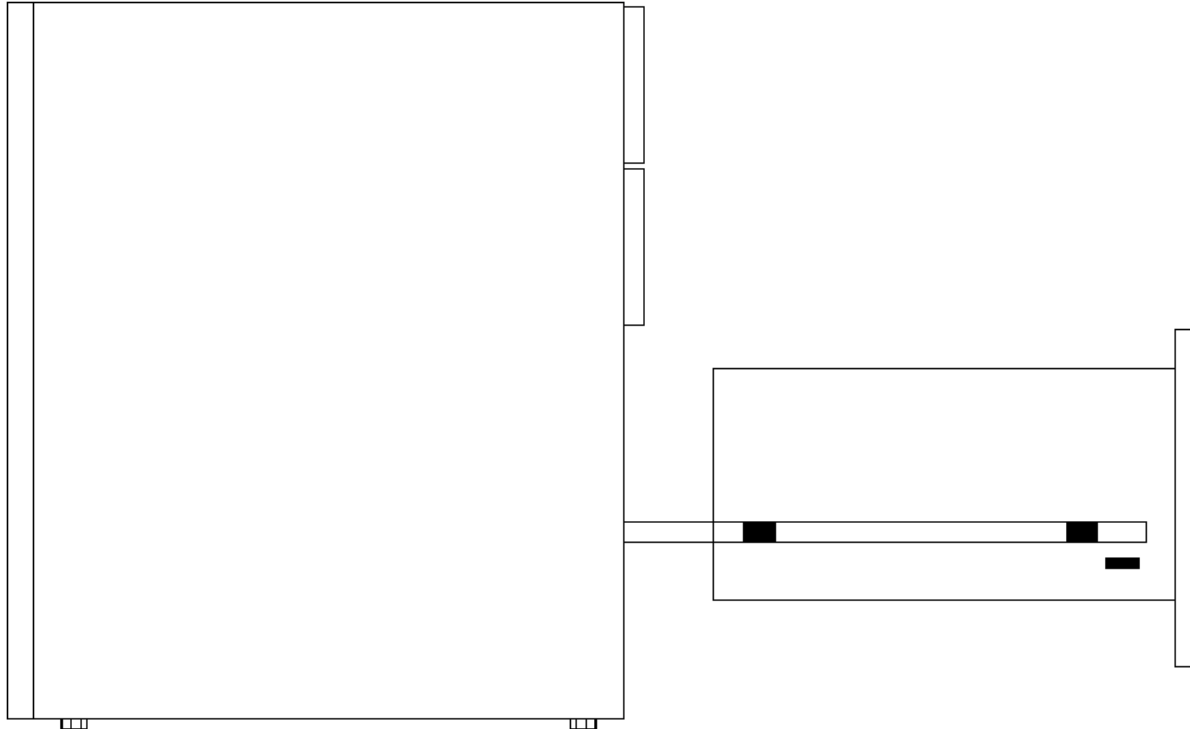

Removal

Step 1 - Pull drawer completely open.

Step 2 - Reach over the back of the drawer box and grasp the bottom of the drawer box.

Step 3 - Firmly pull up on the bottom of the drawer box, unseating it from the drawer slide clips at the rear of the drawer box.

Step 4 - Rotate the back of the drawer forward, until the drawer unseats itself from the drawer slide clips at the front of the drawer box. If the drawer binds in the slide clips, lightly pull up on the box.

Installation

Step 1 - Replace drawers into correct storage cabinets (grain on drawer fronts should match vertically).

Step 2 - Extend the drawer slides fully.

Step 3 - Gently move slide around the lock clip and align metal clips on the sides of the drawer box with the clips on the drawer slides.

Step 4 - Push the rear edges of the drawer down until the rear drawer clips snap down into the drawer slide.

Step 5 - Push drawer half way into the cabinet (to eliminate stress on the drawer slides) and push down firmly on the front edges of the drawer until the front clips snap completely into the drawer slides.