

greenplay[®]

group loop
collection[™]



made in chicago

greenplay[®]

group loop
collection[™]



made in chicago

Children's Furniture Group Loop Collection™

- Made in the USA
- Take back program
- Zero to Low VOC emissions finishes
- Urea formaldehyde free MDF with FSC certified veneers
- Recycled or composite materials
- Durable and long lasting for contract use in public venues
- Meets California Air Resources Board (CARB) requirements
- No additional labeling required for California Proposition 65
- May help qualify for LEED® points

Product Key:

multi-use caterpillar activity bench	multi-use glider activity station	multi-use go bus activity station
multi-use submarine activity station	tables clover activity table	tables vip table and chair set
seating greenplay berry book stool	seating vip table and chair set	seating vip bench

Finish Key:

	O: Orange stain on FSC certified birch veneer
	G: Green stain on FSC certified birch veneer
	Y: Yellow stain on FSC certified birch veneer
	N: Natural finish on FSC certified birch veneer
	VO: Variegated high density polyethelene, orange
	VB: Variegated high density polyethelene, blue
	CO: Wood composite, orange
	CB: Wood composite, blue

greenplay[®]

statement of line

made in chicago

multi-use

Caterpillar 5 Segment

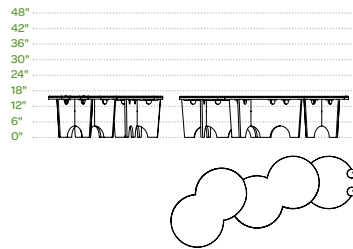

Caterpillar 5 Segment Junior

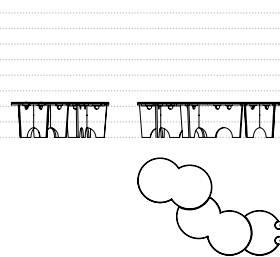

Glider Activity Station

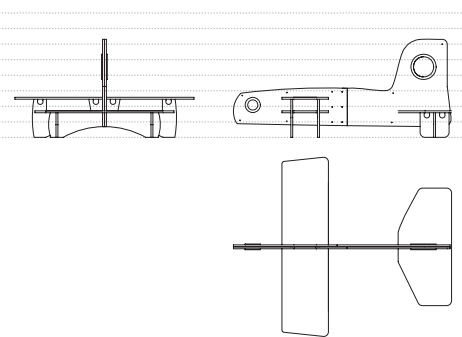

Go-Bus Activity Station

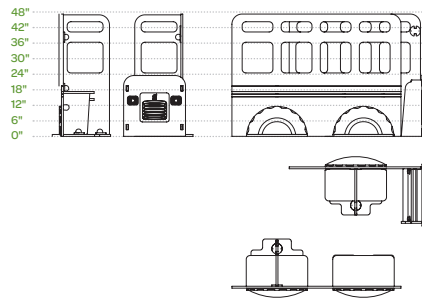

Submarine Activity Station

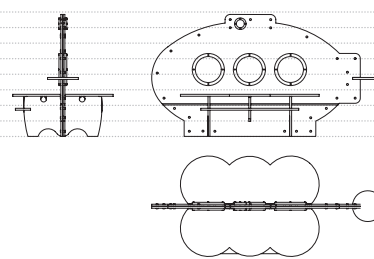

tables

Clover Activity Table 26-inch

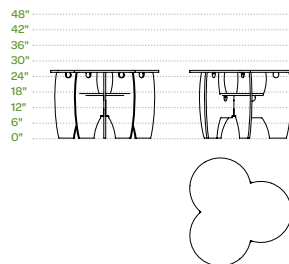

Clover Activity Table 22-inch

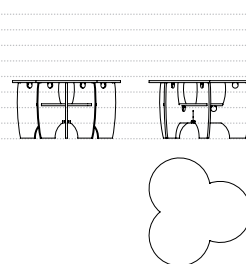

VIP Table

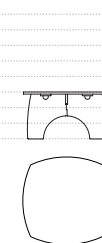

seating

Berry Book Stool

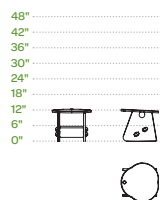

VIP Bench

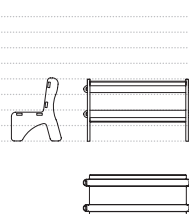

VIP Chair

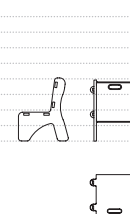

greenplay[®]

group loop
collection[™]



caterpillar activity bench[™]
made in chicago

caterpillar activity bench™

by Joe Fiacchino

for Skyline Design

greenplay



5 Segment Catalog # CAB78 with eyes / #AB78 without eyes

5 Segment Junior Catalog # CABJR55 with eyes / #ABJR55 without eyes

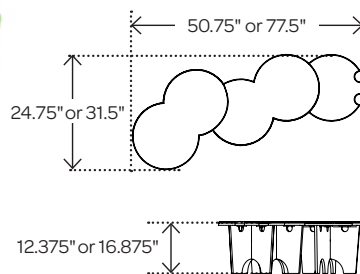

Responsibly Built:

Base: Constructed from urea formaldehyde-free MDF with FSC certified birch veneer. Zero or low VOC finishes.

Top: Post-consumer and/or post-industrial recycled plastic (HDPE) in green.



G HDPE



N

- Greenplay® is backed with a commitment to the creation of beautiful, long-lasting products that are healthy for both our children and the planet.
- Post-consumer recycled surfaces may vary slightly in appearance due to availability of recycled content.
- All Greenplay® items are shipped flat and unassembled in an effort to increase efficiency in shipping.
- All packaging is 30–40% post-consumer recycled and is 100% recyclable.
- Assembly is easy and fun.
- Please contact Skyline or your local Greenplay® representative for custom graphic and fabrication options.
- Skyline Design, Inc. reserves the right to alter pricing and design at any time without notice.
- Toys, children not included.
- **Made in Chicago.**

greenplay[®]

group loop
collection[™]



glider activity station[™]
made in chicago

glider activity station™

by Joe Fiacchino
for Skyline Design

greenplay



Catalog# GLDR

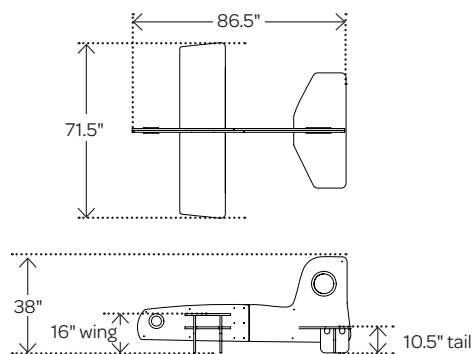

Responsibly Built:

Glider Body: Constructed from urea formaldehyde-free MDF with FSC certified birch veneer. Zero or low VOC finishes.

Wings/Trim/Tail: Composite wood from forest waste and/or shavings.



N

R

- Greenplay® is backed with a commitment to the creation of beautiful, long-lasting products that are healthy for both our children and the planet.
- Post-consumer recycled surfaces may vary slightly in appearance due to availability of recycled content.
- All Greenplay® items are shipped flat and unassembled in an effort to increase efficiency in shipping.
- All packaging is 30–40% post-consumer recycled and is 100% recyclable.
- Assembly is easy and fun.
- Please contact Skyline or your local Greenplay® representative for custom graphic and fabrication options.
- Skyline Design, Inc. reserves the right to alter pricing and design at any time without notice.
- Toys, children, Greenplay Berry Book Stool not included.
- **Made in Chicago.**

greenplay[®]

group loop
collection[™]



go-bus activity station[™]
made in chicago

go-bus activity station™

by Joe Fiacchino
for Skyline Design

greenplay



Catalog# BUS

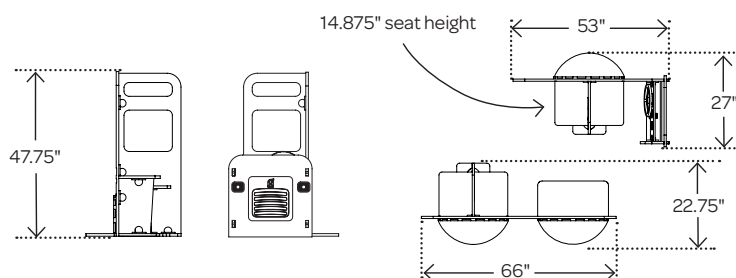

Responsibly Built:

Tires & Base: Post consumer and/or post-industrial recycled plastic (HDPE).

Panel: Constructed from urea formaldehyde-free MDF with FSC certified birch veneer. Zero or low VOC finishes.



- Greenplay® is backed with a commitment to the creation of beautiful, long-lasting products that are healthy for both our children and the planet.
- Post-consumer recycled surfaces may vary slightly in appearance due to availability of recycled content.
- All Greenplay® items are shipped flat and unassembled in an effort to increase efficiency in shipping.
- All packaging is 30–40% post-consumer recycled and is 100% recyclable.
- Assembly is easy and fun.
- Please contact Skyline or your local Greenplay® representative for custom graphic and fabrication options.
- Skyline Design, Inc. reserves the right to alter pricing and design at any time without notice.
- Children not included.
- **Made in Chicago.**

greenplay[®]

group loop
collection[™]



submarine activity station[™]
made in chicago

submarine activity station™

by Joe Fiacchino
for Skyline Design

greenplay

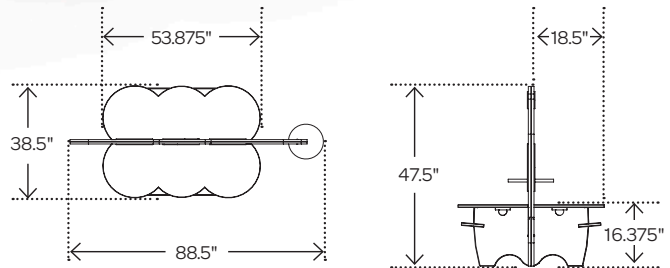

Catalog# SUB



Responsibly Built:

Panel: Constructed from urea formaldehyde-free MDF with FSC certified birch veneer. Zero or low VOC finishes.

Shelf/Trim: Composite wood from forest waste and/or shavings.



Y



CB



N

- Greenplay® is backed with a commitment to the creation of beautiful, long-lasting products that are healthy for both our children and the planet.
- Post-consumer recycled surfaces may vary slightly in appearance due to availability of recycled content.
- All Greenplay® items are shipped flat and unassembled in an effort to increase efficiency in shipping.
- All packaging is 30–40% post-consumer recycled and is 100% recyclable.
- Assembly is easy and fun.
- Please contact Skyline or your local Greenplay® representative for custom graphic and fabrication options.
- Skyline Design, Inc. reserves the right to alter pricing and design at any time without notice.
- Toys, children not included.
- **Made in Chicago.**

greenplay[®]

group loop
collection[™]



clover activity table[™]
made in chicago

clover activity table™

by Joe Fiacchino
for Skyline Design

greenplay

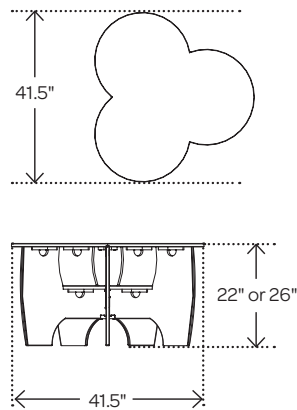

22-inch model Catalog # CAT22CO, CAT22CB, CAT22VO, CAT22VB

26-inch model Catalog # CAT26CO, CAT26CB, CAT26VO, CAT26VB



Responsibly Built:

Base: Constructed from urea formaldehyde-free MDF with FSC certified birch veneer. Zero or low VOC finishes.

Top: Post-consumer recycled plastic (HDPE) or composite wood.



- Greenplay® is backed with a commitment to the creation of beautiful, long-lasting products that are healthy for both our children and the planet.
- Post-consumer recycled surfaces may vary slightly in appearance due to availability of recycled content.
- All Greenplay® items are shipped flat and unassembled in an effort to increase efficiency in shipping.
- All packaging is 30–40% post-consumer recycled and is 100% recyclable.
- Assembly is easy and fun.
- Please contact Skyline or your local Greenplay® representative for custom graphic and fabrication options.
- Skyline Design, Inc. reserves the right to alter pricing and design at any time without notice.
- Toys, children, Greenplay Berry Book Stools not included.
- **Made in Chicago.**

greenplay[®]

group loop
collection[™]



greenplay berry book stool[™]
made in chicago

greenplay berry book stool™

by Joe Fiacchino
for Skyline Design

greenplay

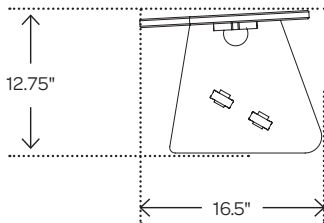
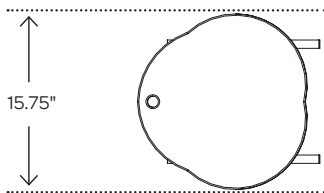

Catalog # BBSN, BBSO, BBSG, BBSY



Responsibly Built:

Top & Base: Constructed from urea formaldehyde-free MDF with FSC certified birch veneer. Zero or low VOC finishes.



- Greenplay® is backed with a commitment to the creation of beautiful, long-lasting products that are healthy for both our children and the planet.
- Post-consumer recycled surfaces may vary slightly in appearance due to availability of recycled content.
- All Greenplay® items are shipped flat and unassembled in an effort to increase efficiency in shipping.
- All packaging is 30–40% post-consumer recycled and is 100% recyclable.
- Assembly is easy and fun.
- Please contact Skyline or your local Greenplay® representative for custom graphic and fabrication options.
- Skyline Design, Inc. reserves the right to alter pricing and design at any time without notice.
- Toys, children not included.
- **Made in Chicago.**

greenplay[®]

group loop
collection[™]



vip table and chair[™]
made in chicago



Table Catalog# VIPTN, VIPTG, VIPTO, VIPTY

Chair Catalog# VIPCN, VIPCG, VIPCO, VIPCY

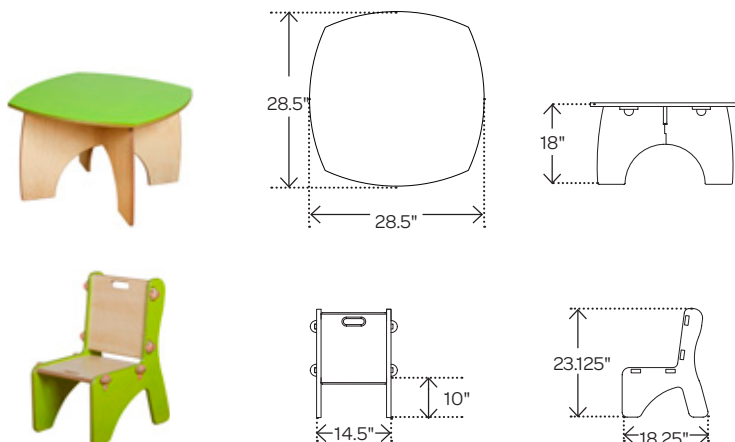

Responsibly Built:

Table & Chair: Constructed from urea formaldehyde-free MDF with FSC certified birch veneer. Zero or low VOC finishes.

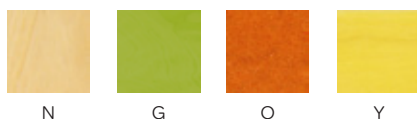

N

G

O

Y

- Greenplay® is backed with a commitment to the creation of beautiful, long-lasting products that are healthy for both our children and the planet.
- Post-consumer recycled surfaces may vary slightly in appearance due to availability of recycled content.
- All Greenplay® items are shipped flat and unassembled in an effort to increase efficiency in shipping.
- All packaging is 30–40% post-consumer recycled and is 100% recyclable.
- Assembly is easy and fun.
- Please contact Skyline or your local Greenplay® representative for custom graphic and fabrication options.
- Skyline Design, Inc. reserves the right to alter pricing and design at any time without notice.
- Toys, children not included.
- **Made in Chicago.**

greenplay[®]

group loop
collection[™]



vip bench[™]
made in chicago



Shown with VIP Table™ and VIP Chair™

Catalog# VIPBN, VIPBG, VIPBO, VIPBY

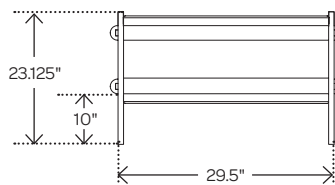
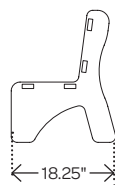

Responsibly Built:

Bench: Constructed from natural FSC certified birch veneer over wood composite. Zero or low VOC finishes.



N

G

O

Y

- Greenplay® is backed with a commitment to the creation of beautiful, long-lasting products that are healthy for both our children and the planet.
- Post-consumer recycled surfaces may vary slightly in appearance due to availability of recycled content.
- All Greenplay® items are shipped flat and unassembled in an effort to increase efficiency in shipping.
- All packaging is 30–40% post-consumer recycled and is 100% recyclable.
- Assembly is easy and fun.
- Please contact Skyline or your local Greenplay® representative for custom graphic and fabrication options.
- Skyline Design, Inc. reserves the right to alter pricing and design at any time without notice.
- Toys, children not included.
- **Made in Chicago.**

greenplay[®]

environments matter[®]

Since 1983 Skyline Design's time-tested fabrication methodology has awarded us industry-wide recognition as one of the premier fabricators of thematic and interpretive environments. Our greatest challenge is to ask ourselves how we can contribute to the well-being of the environment while continuing to create imaginative design.

Greenplay is backed with five years of research and development; we are committed to the creation of beautiful, long-lasting products that are healthy for both our children and the planet. We consider not only the palette of environmentally responsible materials for the production of Greenplay, but also the efficiencies of yield – our products are made with a minimum of scrap and waste. We have proactively sought methods for reduction of secondary finishing processes and have instituted programs for disassembly of the product for recycle.

At this time, we have established a comprehensive protocol for the sourcing and manufacture of Greenplay, which includes:

- **Sourcing Materials:** Careful investigation of materials and finishes used, including chain of custody from manufacturer, location of manufacturer, etc.
- **Efficiencies of Yield:** Utilizing entire sheets of material while minimizing waste and recycling what is not used.
- **Indoor Air Quality:** Very low- or zero-VOC finishes and materials are used in all pieces.
- **Shipping:** Each piece is shipped flat-packed or if pre-assembled, we blanket-wrap and ship via van line.
- **Recycling:** Glue is abandoned in favor of mechanical connections for easy breakdown for recycling.
- **Take-Back Program:** Greenplay pieces are returned to us; we then repurpose them for donation to Association House of Chicago, a foremost community resource offering comprehensive services in English and Spanish that helps families help themselves.



Awards:

Best New Product 2009 Metrocon,
www.metrocon.inf
Honorable Mention, The Bloom Awards,
Interiors & Sources Magazine, March 2009
Top-10 Green Building Product,
BuildingGreen.com, 2007

Memberships:

American Academy of Healthcare Interior Designers
(AAHID)
U.S. Green Building Council (USGBC)

The following is a list of materials currently used in the manufacture of Greenplay:

- **Recycled HDPE** (high density polyethylene): Consumer packaging such as detergent bottles are chipped up and heat-pressed to form sheets of material.
- **Urea formaldehyde-free MDF:** Formed from scraps of wood.
- **Urea formaldehyde-free MDF** with an FSC- (Forest Stewardship Council) certified wood veneer: They use the same product as above and then apply the veneer.
- **Forest Waste Panels:** Made from wood scraps and thin, otherwise useless pine branches, and then tinted with vegetable dyes (the color penetrates the material).
- **Mechanical Fasteners:** Steel, aluminum and recycled plastic.

Greenplay is considered sustainable for its use of these materials in addition to our cradle-to-cradle design approach. We look at the complete life of the piece from sourcing materials to manufacturing, and to considering what happens to each piece after its useful life.

COME PLAY WITH US!

made in chicago

greenplay[®]

limited warranty

Greenplay Limited Warranty (Standard Product Line)
Skyline warrants Greenplay products against defects in materials and workmanship under normal use for a period of three (3) years from date of purchase by the original purchaser.

This limited warranty applies under conditions of normal use only.

This warranty does not apply to and Skyline will not be responsible for:

- Normal wear and tear or color fastness of materials.
- Damages resulting from negligence, misuse, fire, accidents, the elements, acts of nature.
- Any repairs not specifically performed or approved by Skyline.
- This warranty does not cover damage resulting from inadequate maintenance, cleaning or care; any condition resulting from other than ordinary wear; or from any use for which the product was not designed.
- Skyline is not responsible for damage arising from failure to follow instructions relating to product assembly or product use. Do NOT use power tools to assemble Greenplay products.

Return Policy

If a Greenplay product is found defective in workmanship or materials upon delivery, Skyline will ship a new part and/or product or provide a refund upon return. This claim must be filed with Skyline within 48 hours after receipt of order. Customers will have 14 days from date of receipt to request a refund on defective product(s). Please call (888) 278-4660 for a written return authorization form to include with returned merchandise.

Return Authorization Policy

Due to the nature of the product, Skyline reserves the right to refuse any and/or all requests for the return/restock of product. Each request will be handled on an individual basis. Factory authorization consisting of a written Return Goods Authorization form (RGA) must be secured prior to the return of any product. The RGA must be used within 30 days of issuance and all returns must be shipped as pre-paid freight. Freight-collect returns will be refused. Missing parts and/or damages due to improper packaging

will be deducted from any credits that may be issued. A restocking fee of 25% of the net cost of the product shall apply (subject to Skyline's determination of value), upon final inspection at the factory.

Color & Finish Variations

Due to the variances in computer systems and imaging, we can not guarantee 100% color accuracy. Please request samples to confirm color prior to ordering. With the use of natural/recycled materials and handfinished techniques, variations may occur in color and texture between floor samples, printed illustrations and your furniture pieces. These variations do not indicate defectiveness of product and are therefore excluded as warranty items.

Conditions of Use

- To ensure that components are used correctly and safely, they must be assembled and used as directed per the included instructions.
- Greenplay components are intended for use indoors and away from outdoor weather.
- Furniture is not to be used in wet or humid areas.
- Furniture should not be stood upon (unless otherwise indicated for such use).
- Do not place anything hot directly on the furniture.
- When using components, children should always be supervised by adults.
- Cleaning Policy: Use a clean, damp, lint-free cloth.

End-of-Life

When a customer has decided to replace any Greenplay component (anytime after five years), it is recommended that they contact Skyline to arrange for take-back (per label). Custom Fabrication Warranty Policy:

- Unless damaged or defective upon arrival, items manufactured to clients' specifications cannot be returned. Client will sign off on a shop drawing and/or sample before a piece is manufactured to ensure the product is made to the correct specification. Skyline Design reserves the right to make changes to the design, color, materials and price at anytime. All components are subject to availability.



greenplay

finish maintenance

Finish Maintenance of Wood

This wood composite furniture is finished with a premium quality pre-catalysed or post-catalysed clear protective coating. Maintained properly, this finish will retain its functional and current appearance for many years to come.

NOTE: To ensure full performance, the clear protective coating requires a minimum of 30 days to cure from time of application. Greenplay is a fine furniture product intended solely for interior use.

Please follow these instructions:

Dusting and periodic cleaning:

Dampen a soft cloth in warm water mixed with a small amount of vinegar or mild detergent. Wipe the surface gently followed with a clean, dry cloth.

Aged Cleaning:

The surfaces may require major periodic cleaning from deposits of cooking fumes, smoke, and other residue. Although these contaminants are harmless to the finish, they should be removed to restore the finish to its original, new appearance. This can be done by simply washing the finish with dishwashing detergent or other wax-free detergents mixed with up to 5% solution in warm water. Rinse immediately with a dampened, clean wiper. Do not use ammonia-based cleaners.

This finish will resist most household reagents; however, spills of these product must be wiped down and rinsed with clean water immediately.

Avoid boiling water (steam), continual sunlight, high temperatures, etc. from coming into contact with the finished wood.

These simple steps will help the furniture to retain their fresh look for many years to come.

Finish Maintenance of High Density Polyethylene (HDPE)

Please follow these instructions:

Dusting and periodic cleaning:

Dampen a soft cloth in warm water mixed with a small amount of vinegar or mild detergent. Wipe the surface gently followed with a clean, dry cloth.

Option:

Use Mr. Clean Magic Eraser Original to remove crayon marks and fingerprints from HDPE. This will remove spots made by most water-based markers, not permanent markers. Rinse surfaces with clean, potable water after cleaning. (NOTE: Magic Eraser has an abrasive surface. The area cleaned by Magic Eraser may have a different appearance than surrounding surfaces).