

## Instructor Desk Assembly Instructions

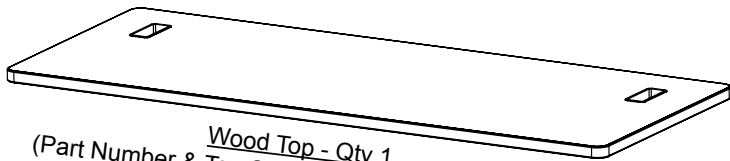

*Wood Top - Qty 1*  
(Part Number & Top Style Varies by Model Number)

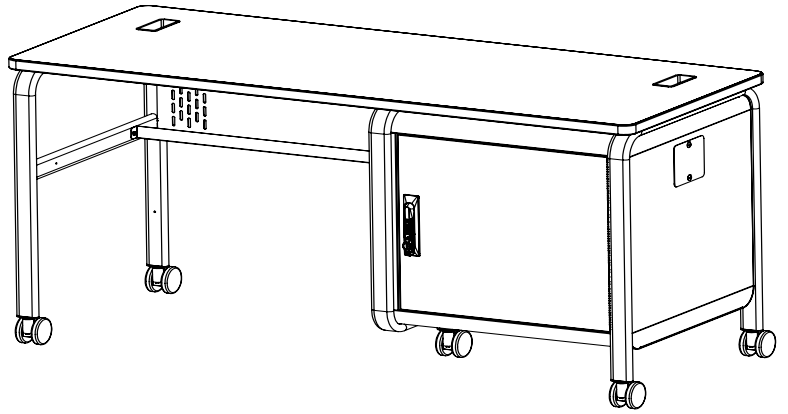
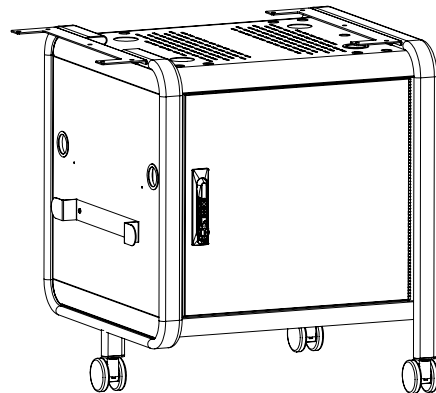

Pedestal Assembly - Qty 1  
060-0928 = Right Hand w/Casters  
060-0929 = Left Hand w/Casters  
060-0960 = Right Hand w/Glides  
060-0959 = Left Hand w/Glides

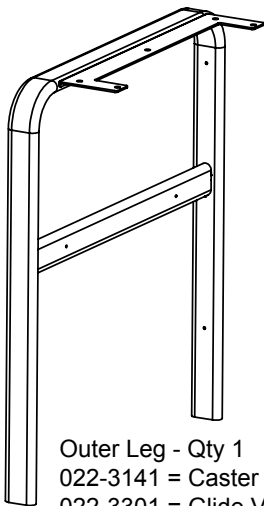

Outer Leg - Qty 1  
022-3141 = Caster Version  
022-3301 = Glide Version

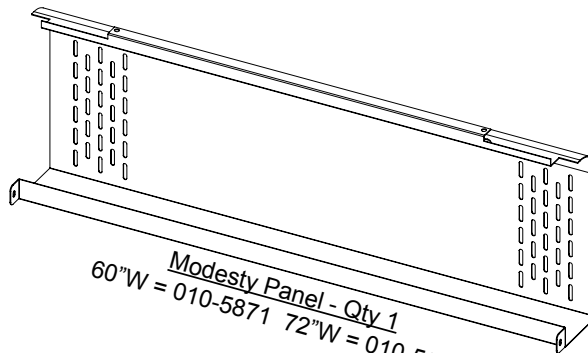

*Modesty Panel - Qty 1*  
60"W = 010-5871 72"W = 010-5860

Table comes with either glides or casters. NOT both.

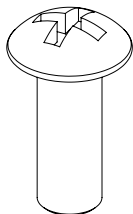

030-0304 - Qty 18  
1/4-20 x 5/8" Combo Screw

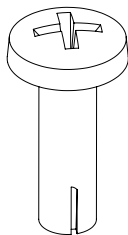

030-0984 - Qty 2  
10-24 x 5/8 Phillips  
Self Tap Screws

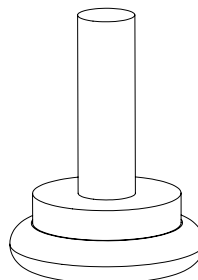

015-0084 - Qty 4  
Threaded Glide

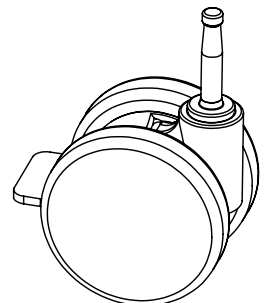

015-0175 - Qty 4  
2 1/2" Stem Caster  
w/Brake

# 1

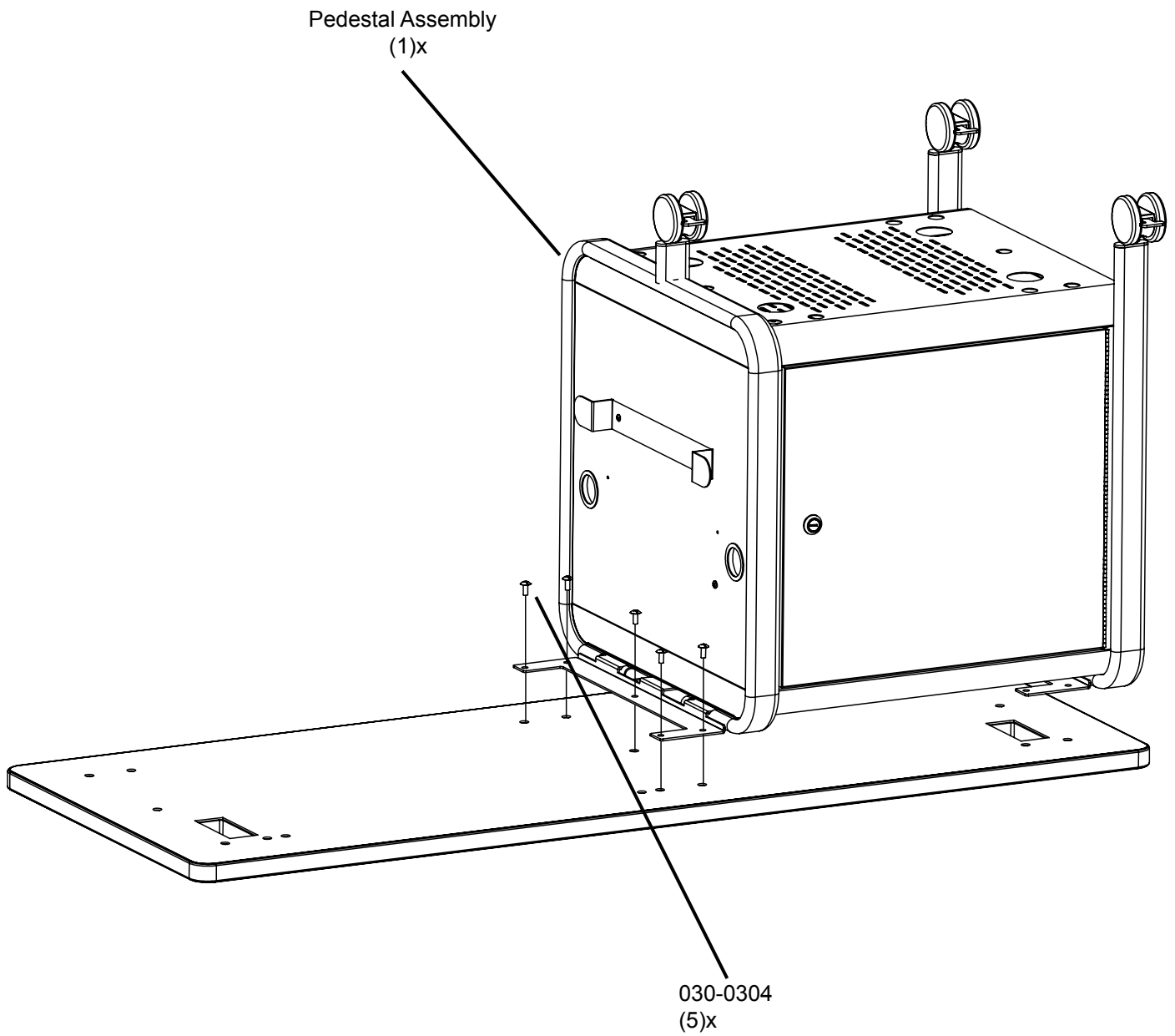

Attach pedestal to wood top as shown.

# 2

Open pedestal door and attach  
to wood top as shown.

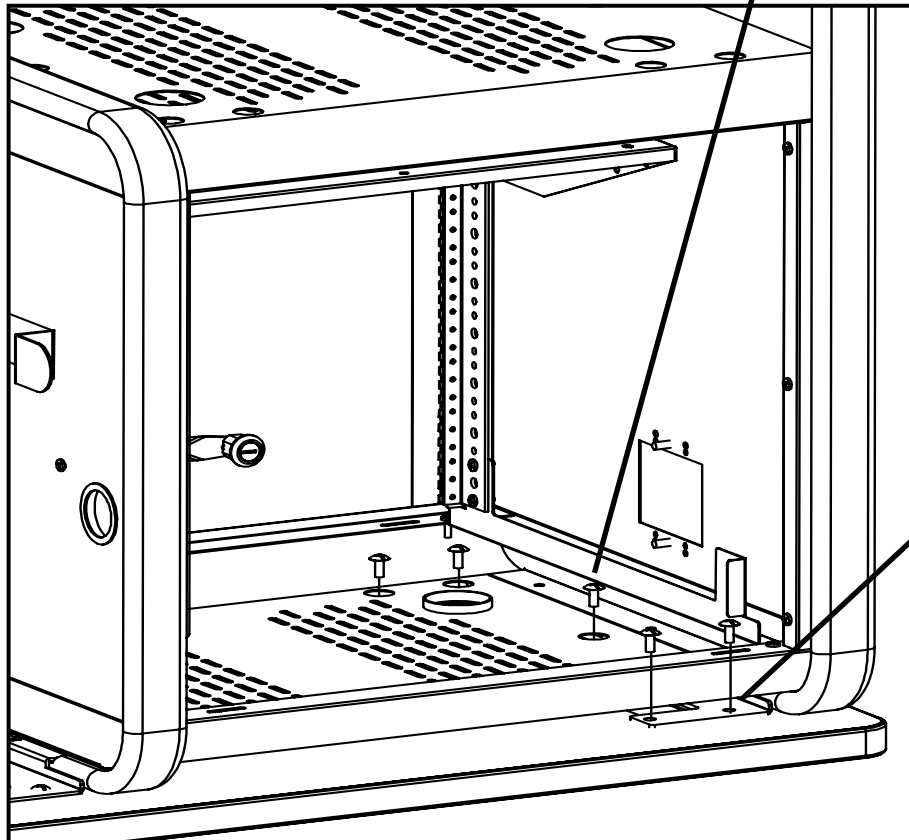
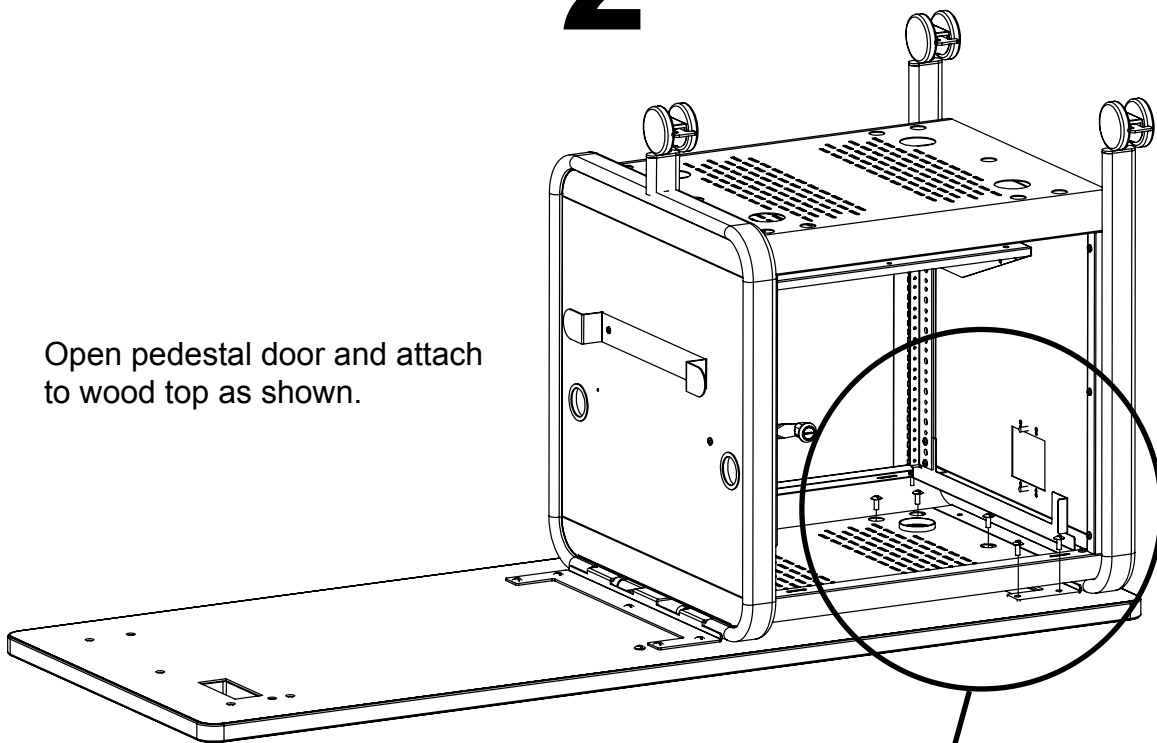

030-0304  
(5)x

DOOR REMOVED FOR CLARITY

# 3

DEPENDING ON YOUR MODEL INSTALL EITHER CASTERS OR GLIDES

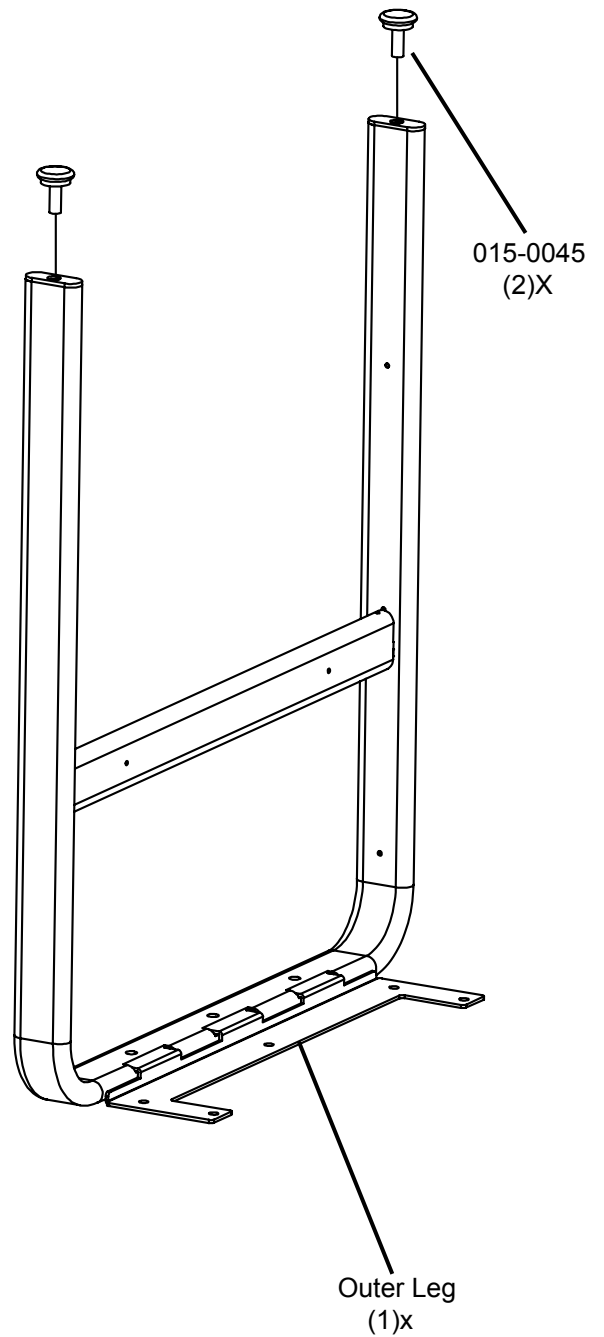
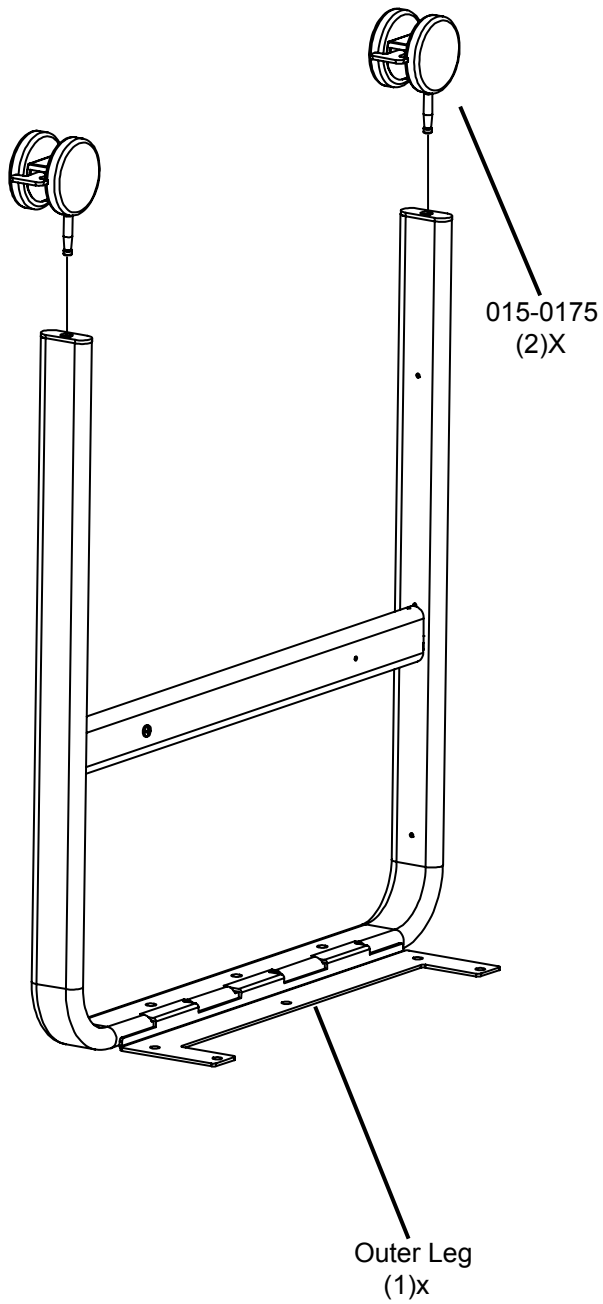

# 4

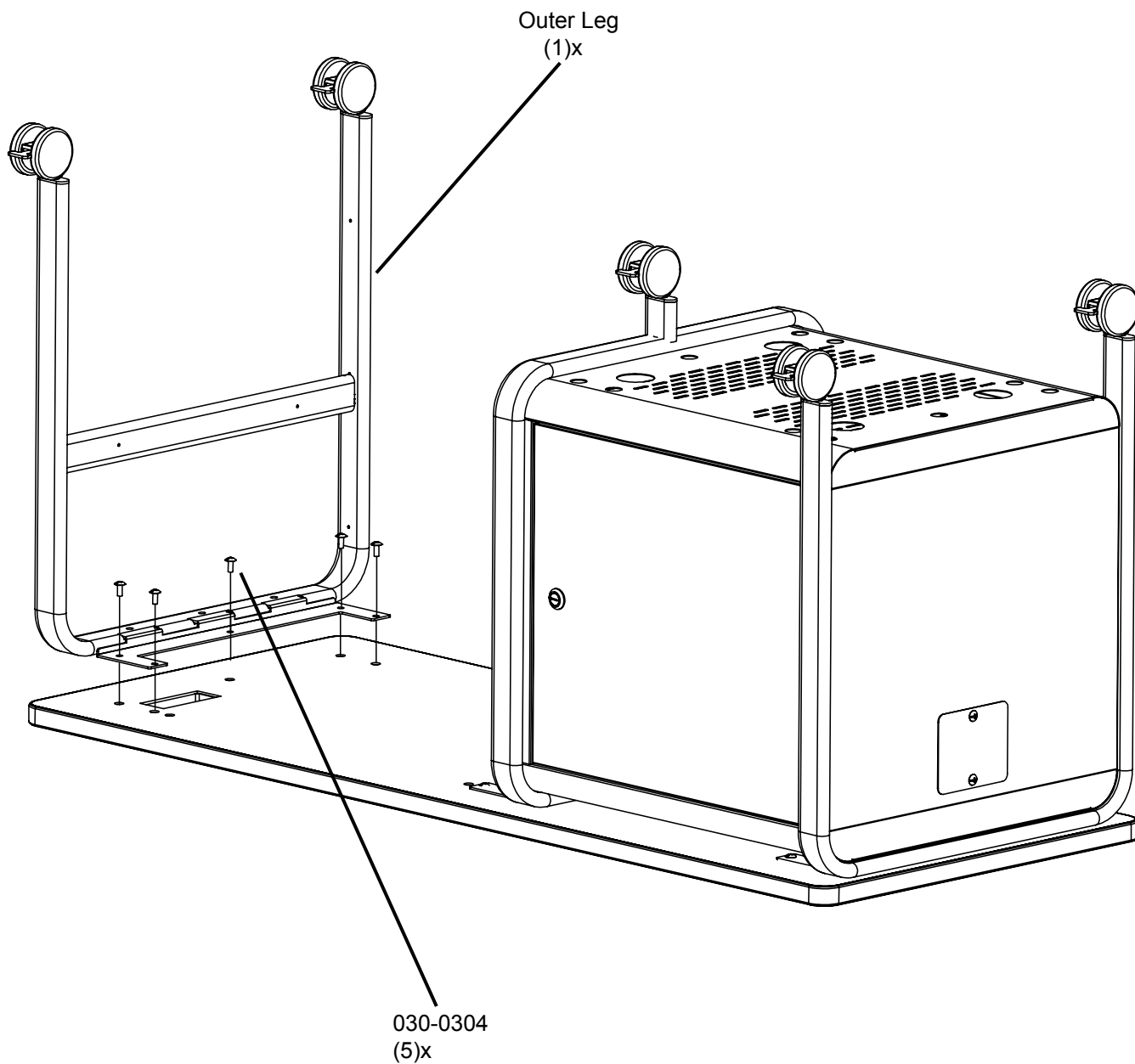

Attach outer leg to wood top as shown.

# 5

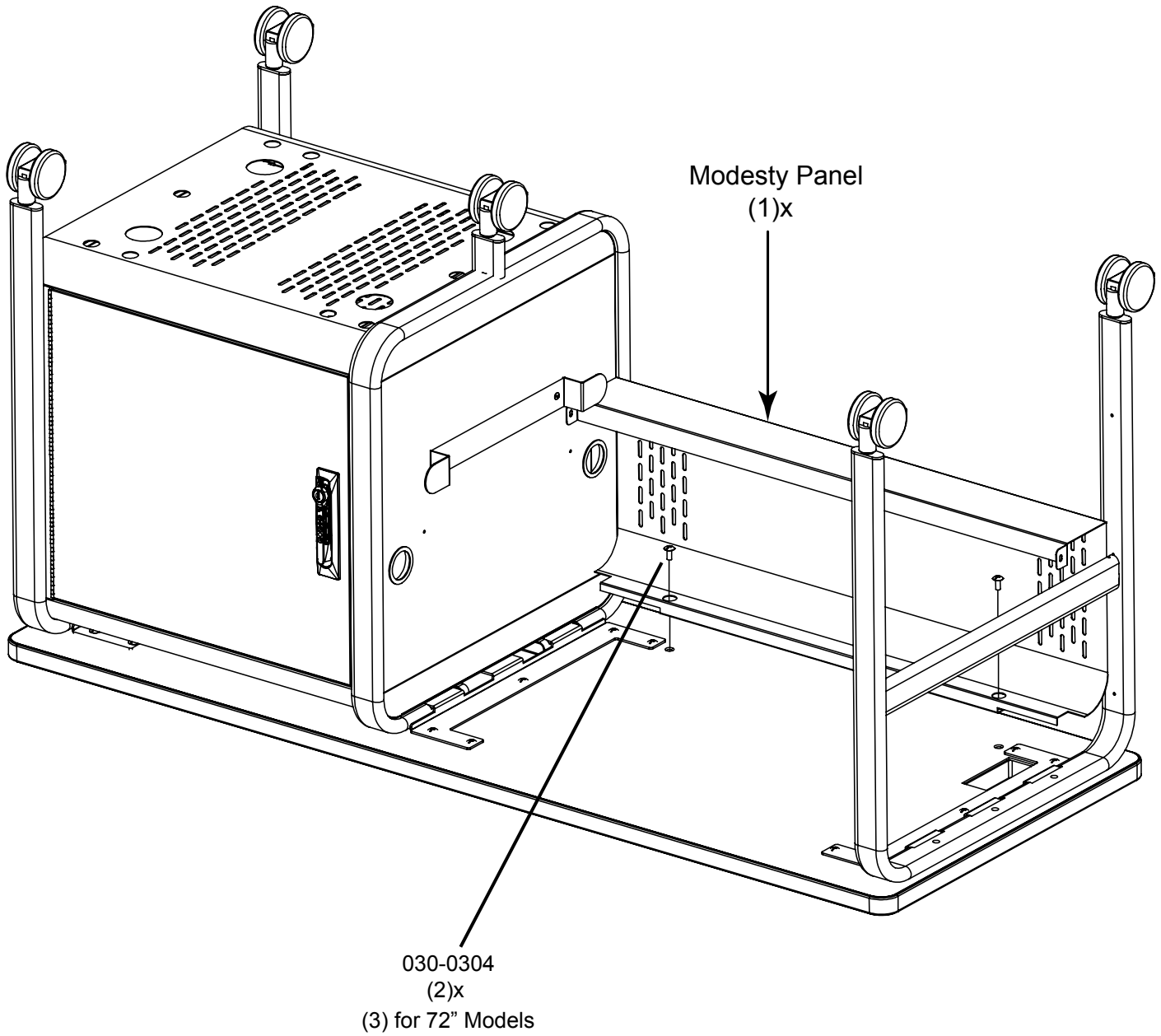

Slide modesty panel between outer leg and pedestal and attach to wood top as shown.

# 6

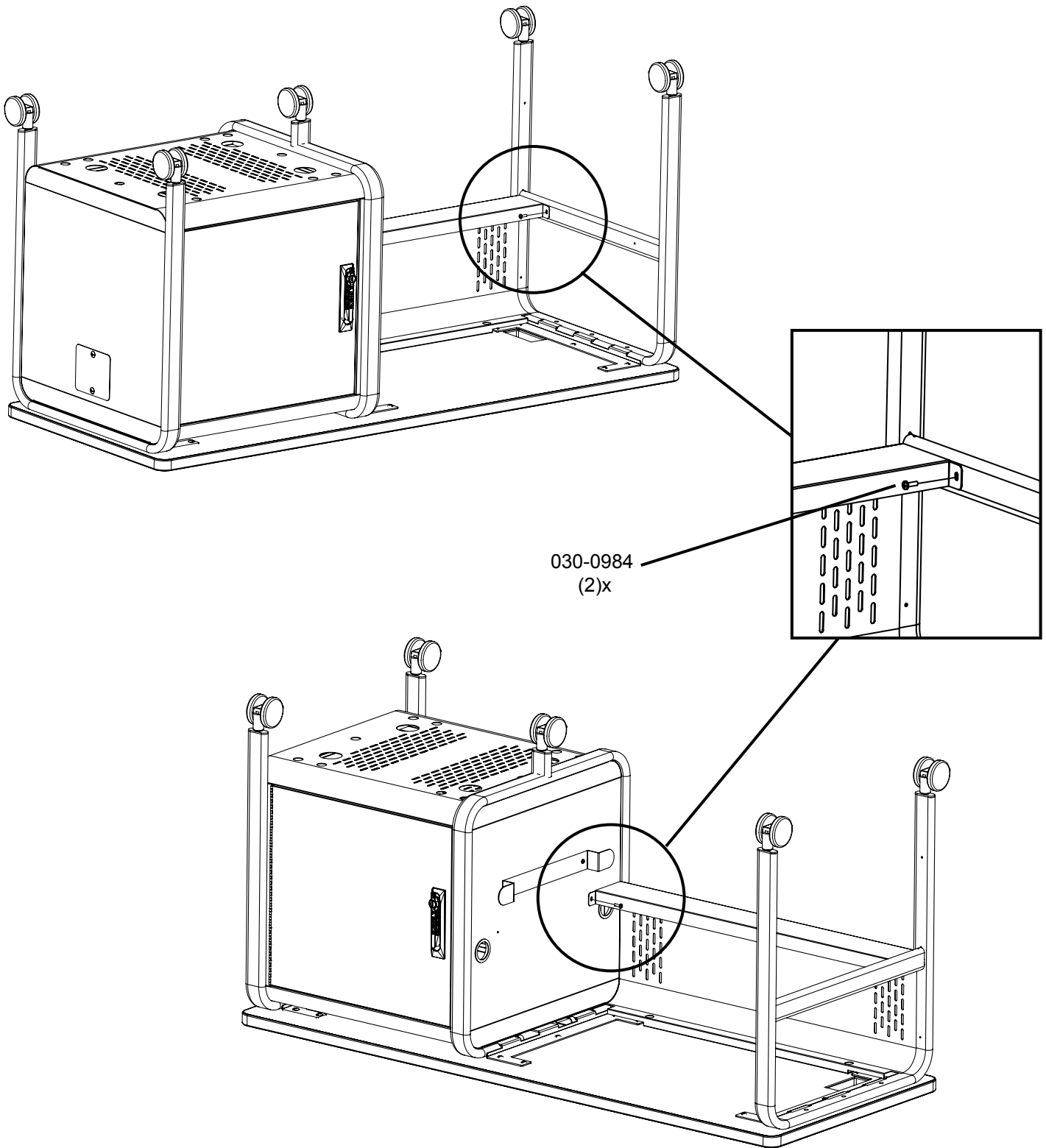

Attach modesty panel to leg and pedestal as shown.

# Models Including Fluid Up Power Unit

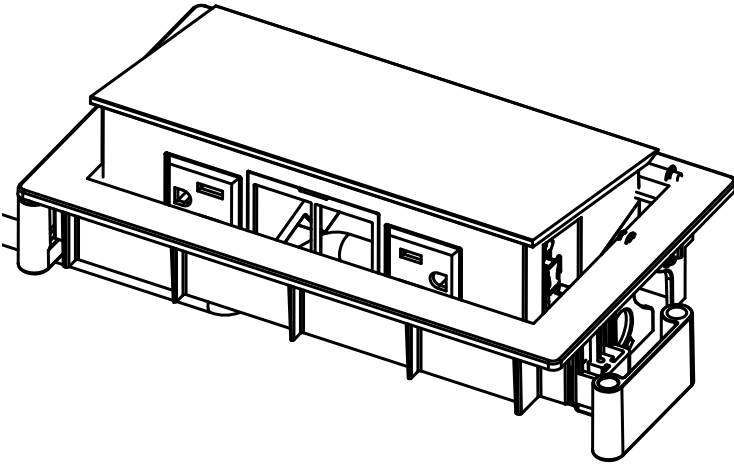

For desks including the Fluid Up Power Unit, mount the unit through the cut out and tighten from the underside using the thumb screws and locator slots. For further information, consult the assembly instructions supplied with the power unit.

## Optional ECF6 Unit (Sold Separately)

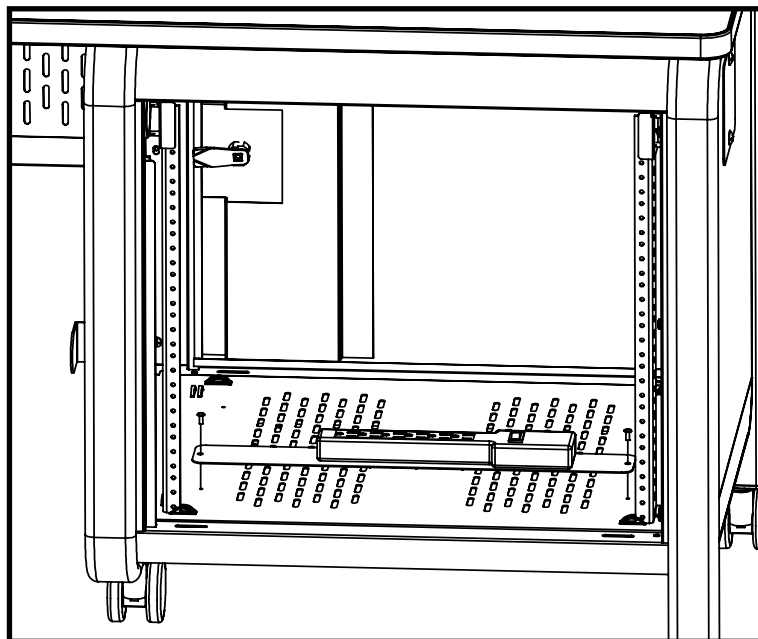

Attach optional electrical unit inside the pedestal on the bottom panel with the provided hardware. The unit can be mounted on either side of the panel, front or rear.



# Optional TCDPT Data Pass Through Plate (Sold Separately)

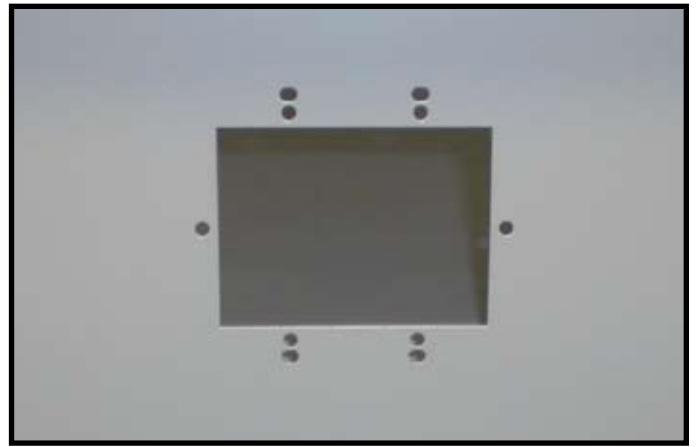

1) Remove the cover plate from the outer side of the pedestal.



2) Install the data pass through plate in the removed cover plate location with provided hardware.

Bretford  
11000 Seymour Avenue  
Franklin Park, IL 60131  
TEL: 847.678.2545  
800.521.9614  
FAX: 847.678.0852  
800.343.1779

Bretford Ltd.  
2 Etongate  
110 Windsor Road, Slough  
Berkshire SL1 2JA England  
TEL: 011 44 17 5353 9955  
FAX: 011 44 17 5353 9478

[www.bretford.com](http://www.bretford.com)

Part # 031-9205  
06.18.12 CG

9 of 9