

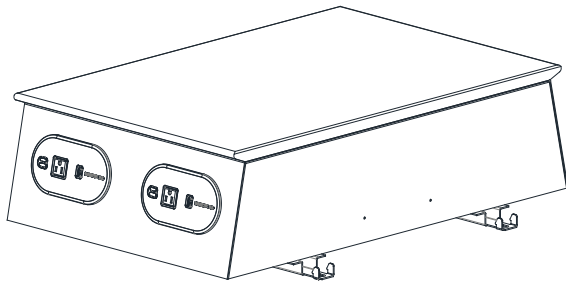

Motiv Power Bridge

Assembly Instructions



Power Bridge without PowerMat

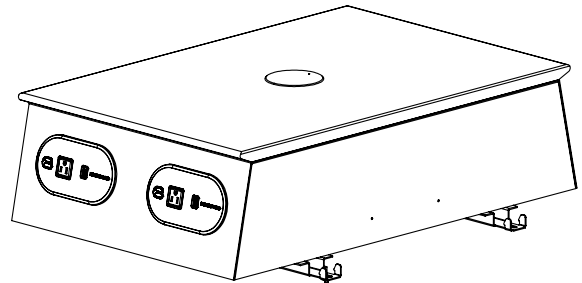

Power Bridge with PowerMat

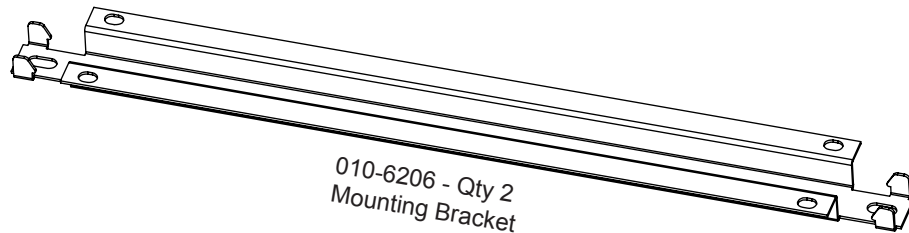

010-6206 - Qty 2
Mounting Bracket

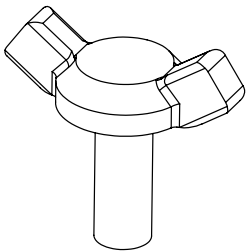

030-1179 - Qty 4
1/4-20 x 1/2" Wing Head
Thumb Screw

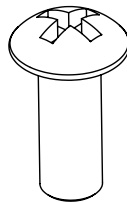

030-0291 - Qty 4
10-32 x 1/2" Phillips
Truss Screw

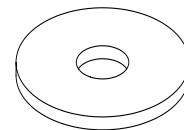

030-0305 - Qty 4
7/8" Washer

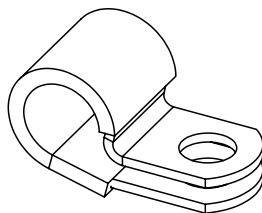

030-1404 - Qty 2
3/8" Cable Clamp

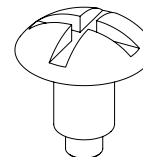

030-0325 - Qty 2
1/4-20 x 1/2 Combo Screw

1

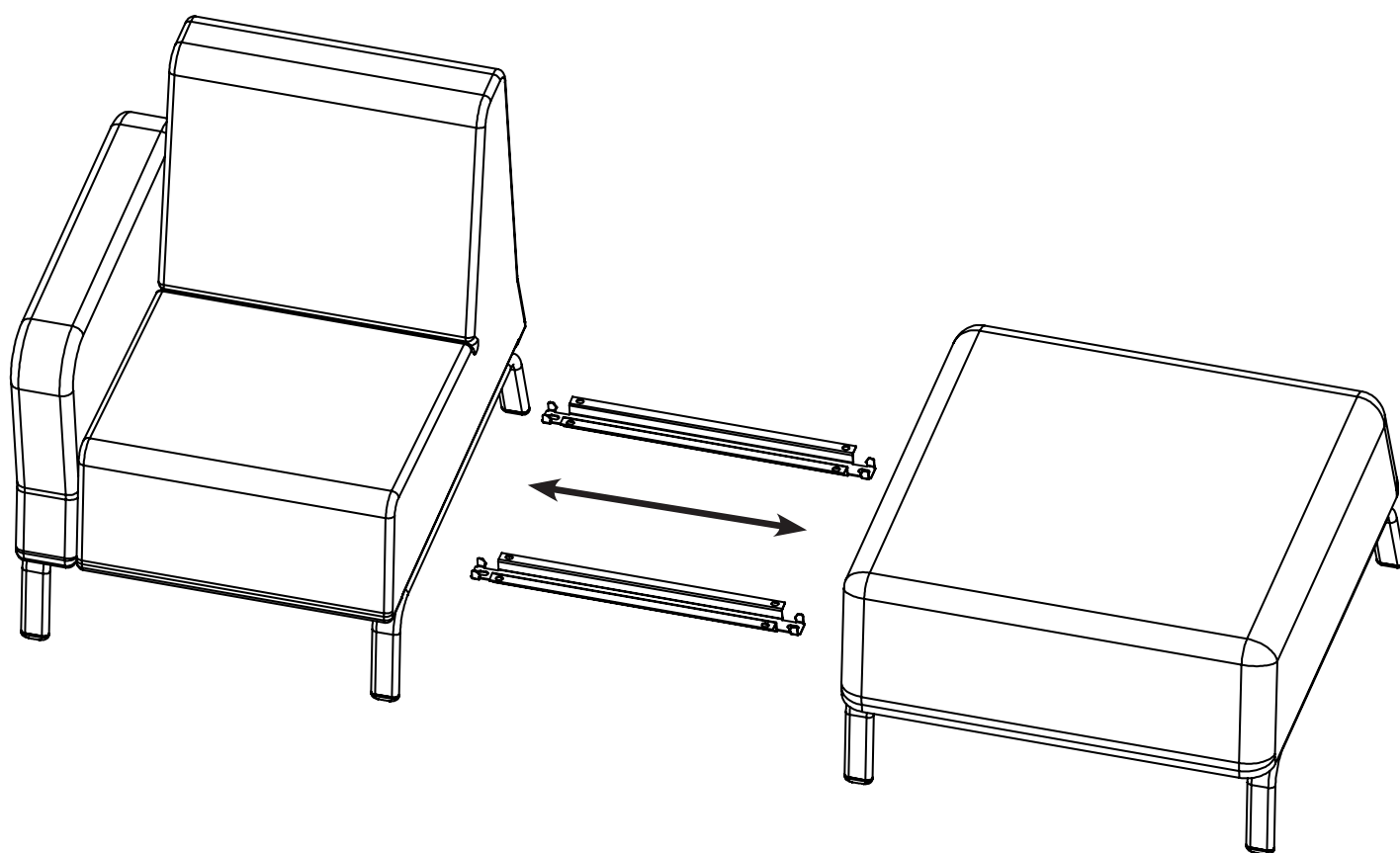

Position mounting brackets between seating pieces.

2

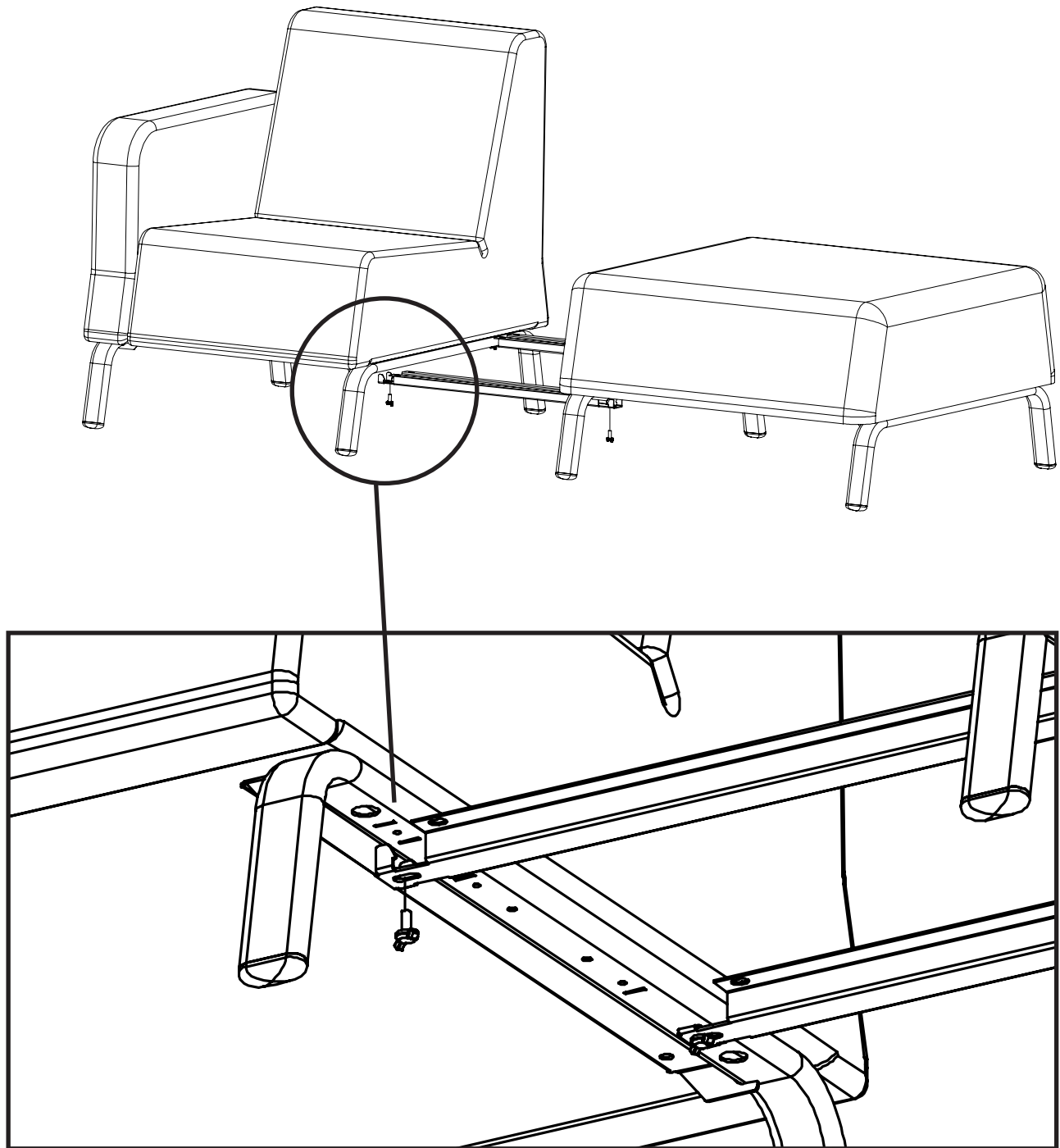

From underneath, mount brackets to the seating legs using winghead thumb screws.

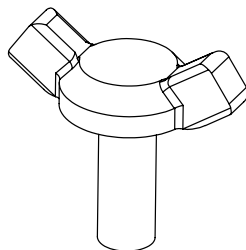

3

If your Power Bridge is a Daisy Chain Version (Models EDUMPB2FL or EDUMPB2PMFL), continue with these steps. If not, Skip to Step 8.



Turn your power bridge unit over.

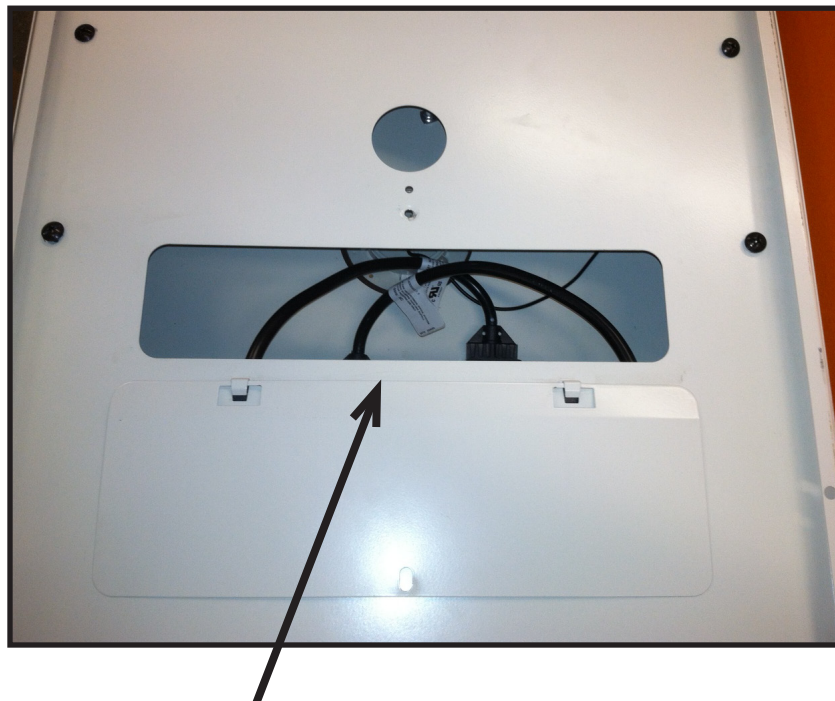

Remove access panel as shown.

4

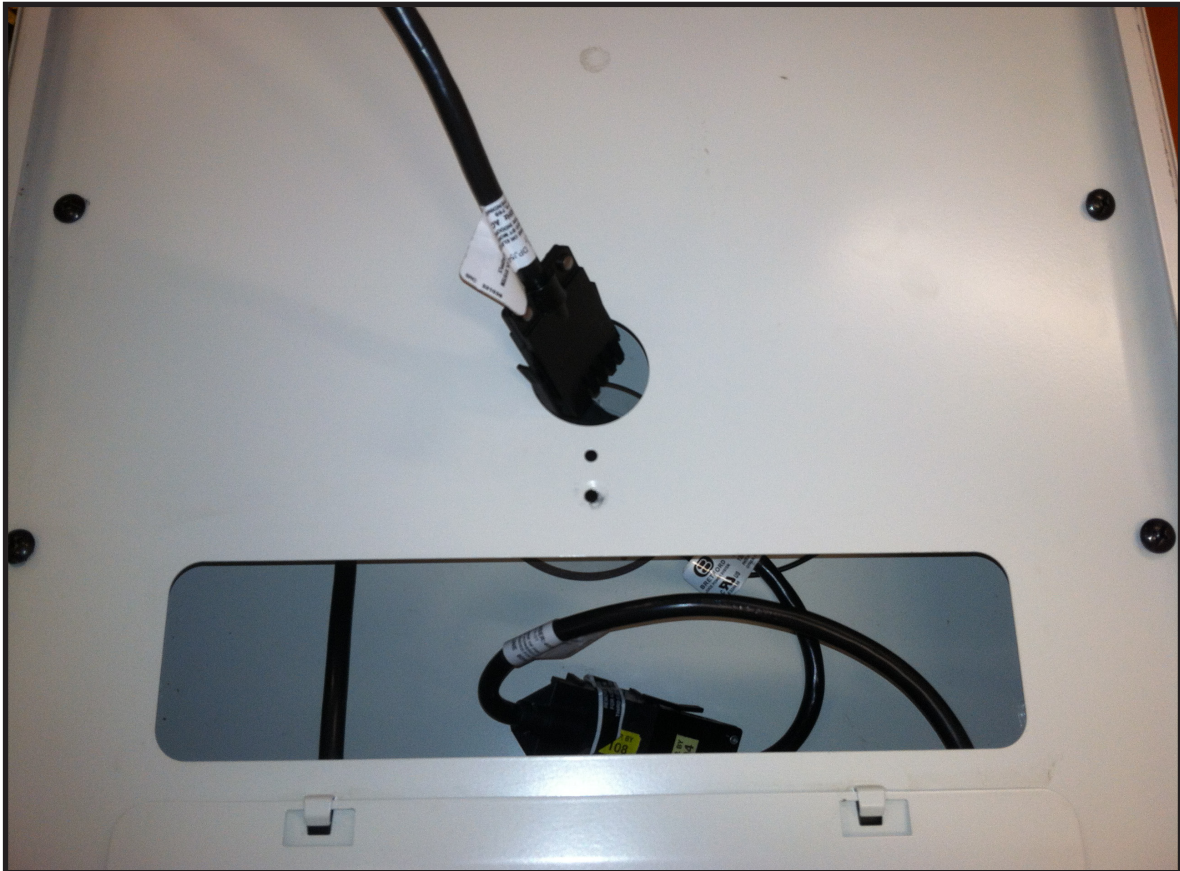

Feed jumper from adjacent unit into grommet hole as shown.

5

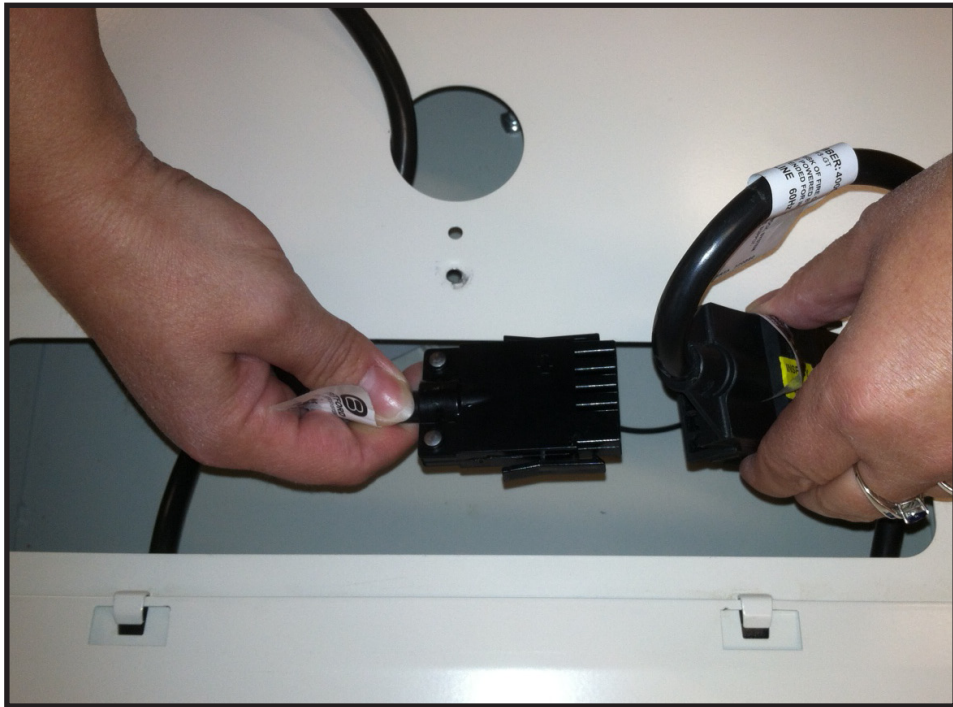

Connect jumper plug as shown.



Should look like this after connected.

6

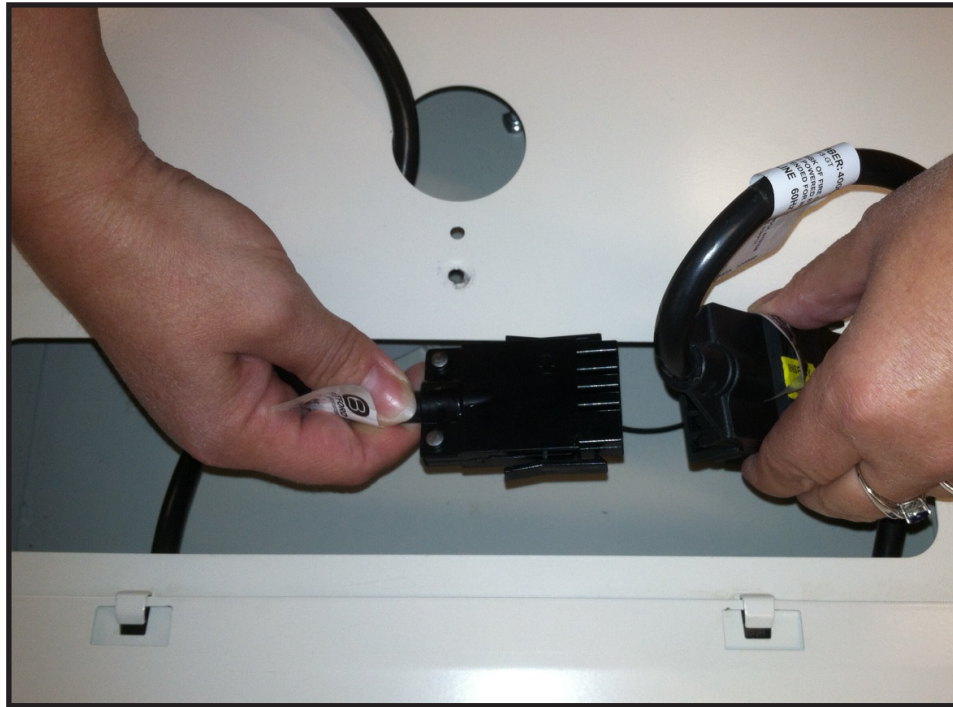

If you are continuing your run of power, connect your next jumper into the remaining plug inside your bridge unit as shown. If not, continue to Step 7.

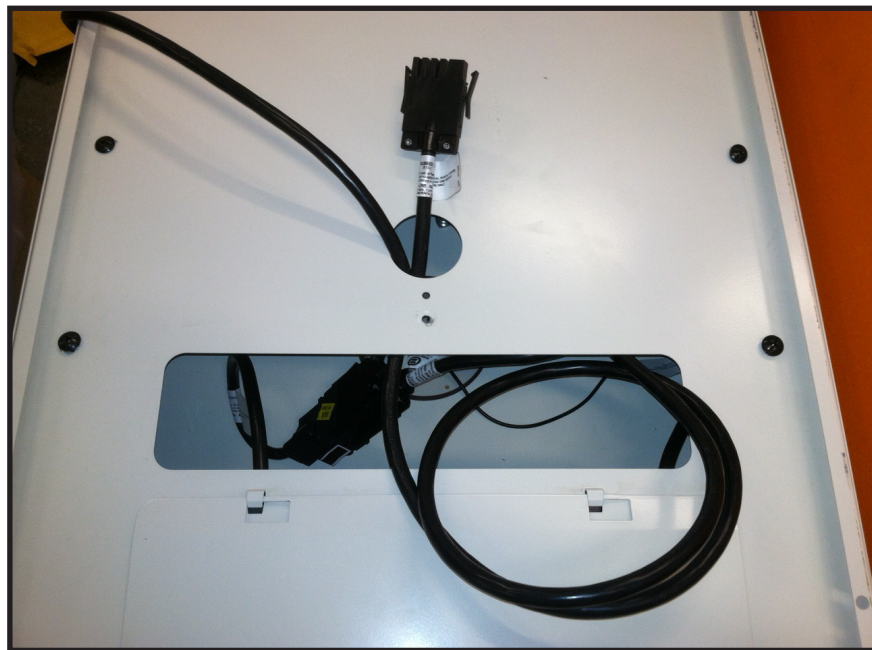

Feed the plug end of this jumper out through the grommet hole as shown.

7

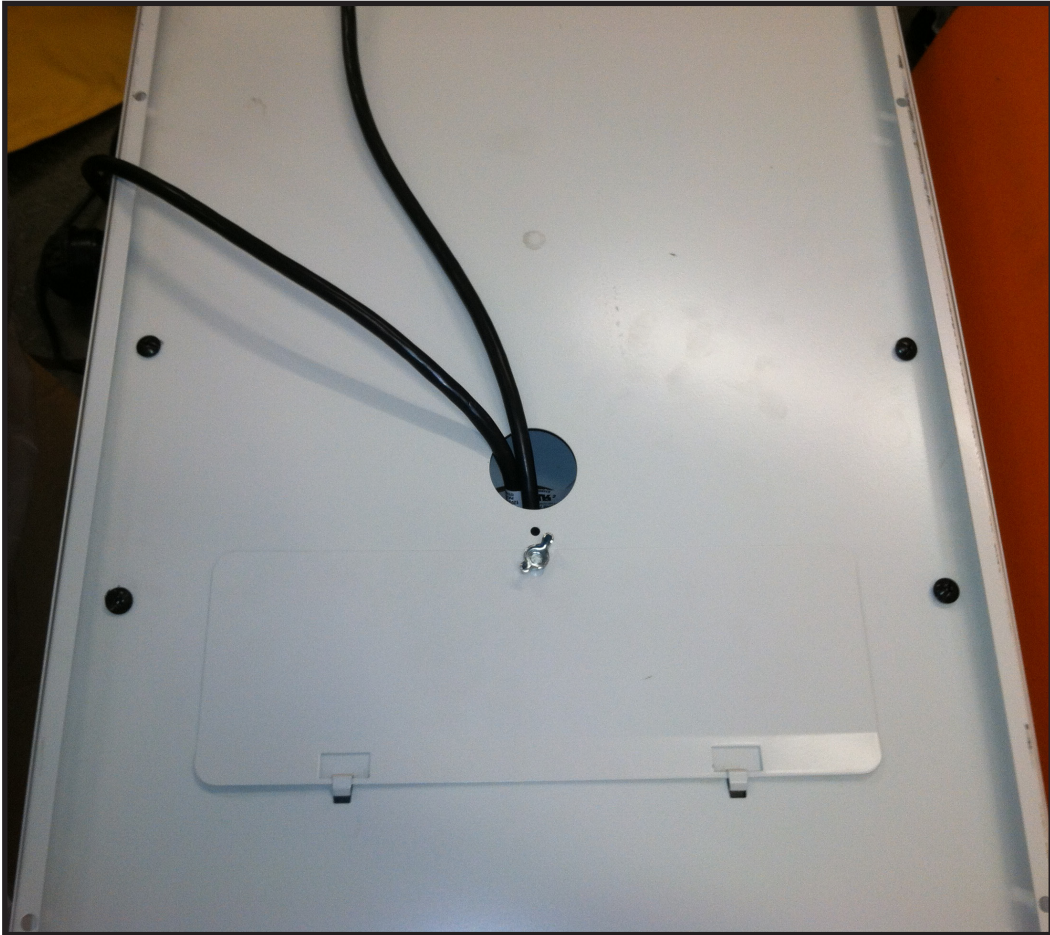

Reattach access panel.

8

Follow these instructions for Cord Management underneath Bridge Unit. Your cord clip holes are located on either side of the grommet hole.

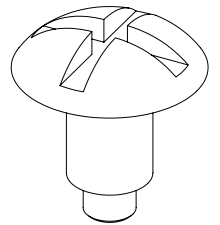
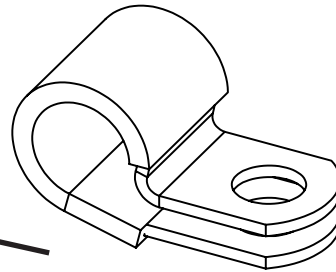

Slide cord clip on in this position.

Slide cord clip onto electrical cord in the position shown. Use screw to secure to bridge through provided hole. **NOTE:** There are 2 holes on either side of the grommet hole. You can use one or both for your cord management.



NOTE: Pictures shown are for instruction only. Your actual product will look different.

9

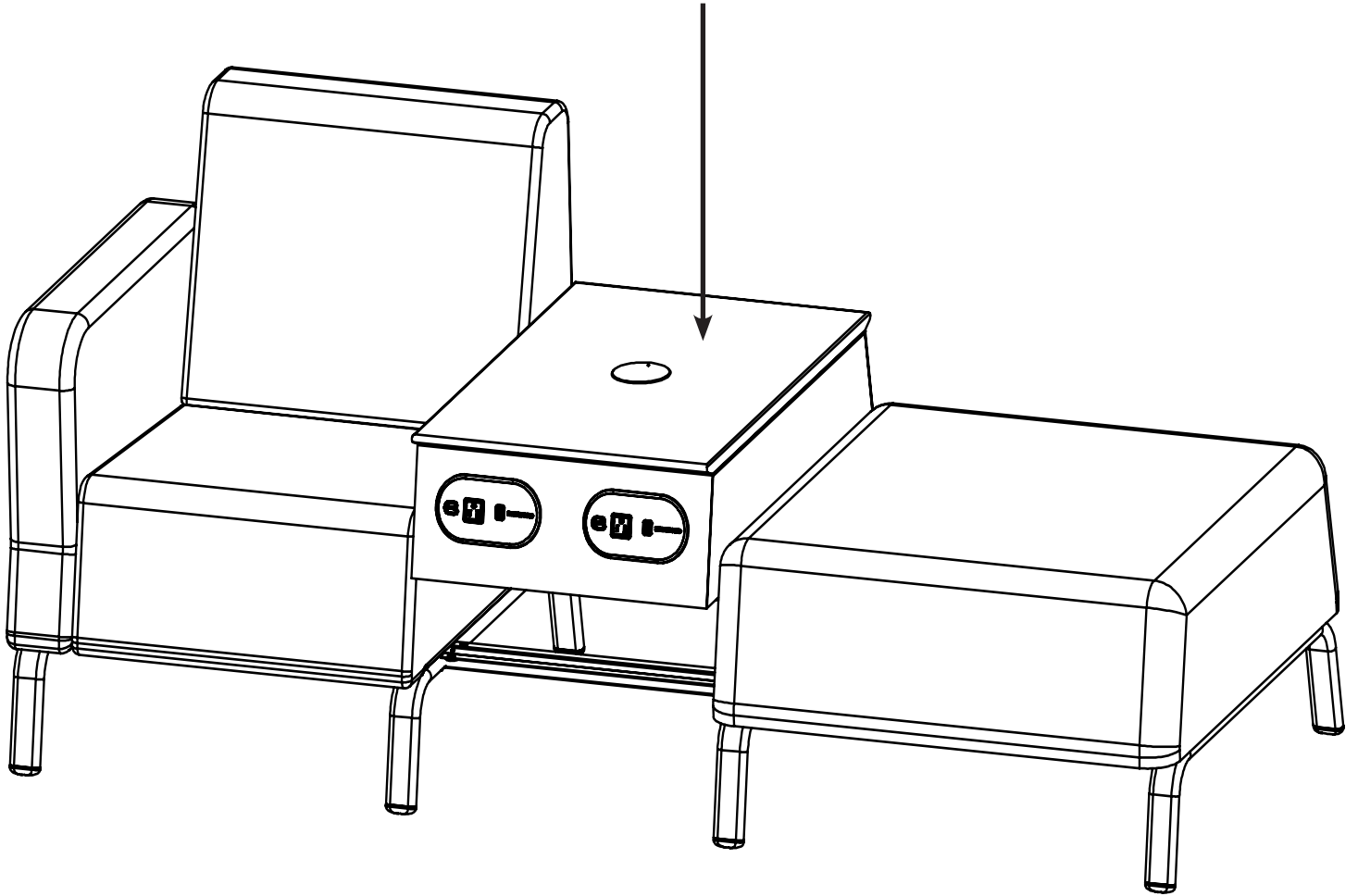

Lay power bridge assembly onto the mounting brackets.

10

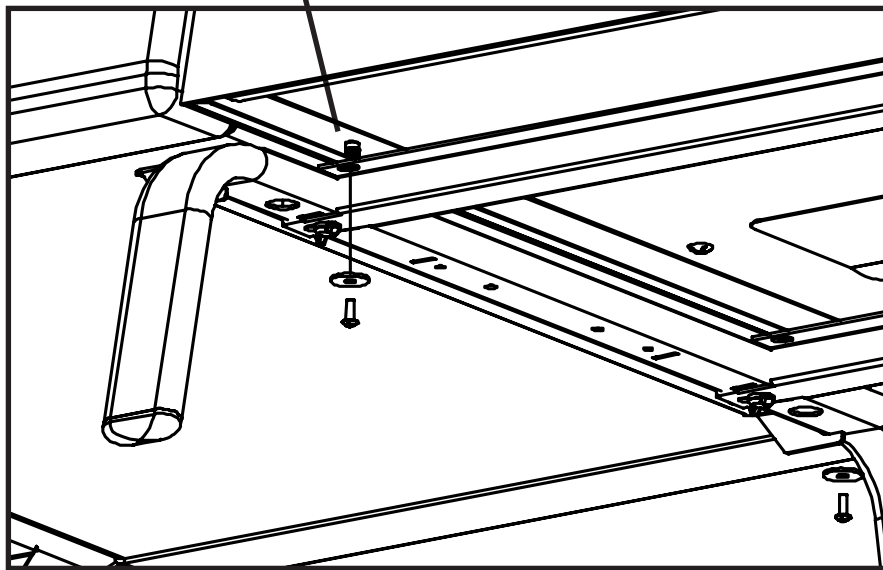
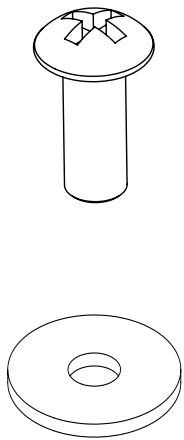
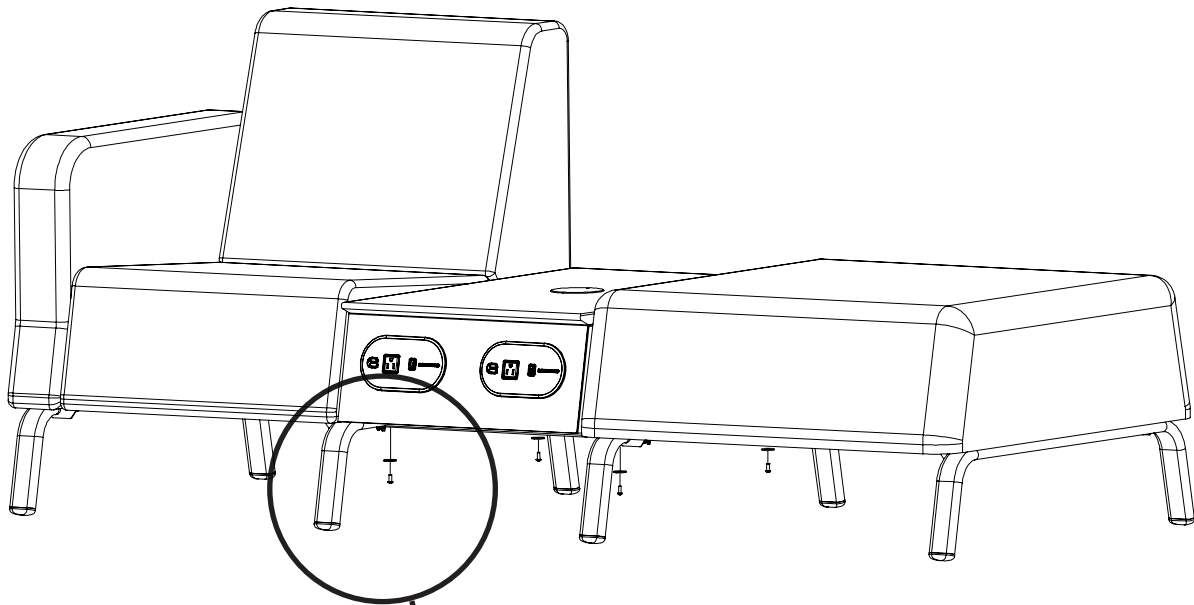

From underneath, secure power bridge assembly to mounting brackets with screws and washers.

Bretford®
11000 Seymour Avenue
Franklin Park, IL 60131
TEL: 847.678.2545
800.521.9614
FAX: 847.678.0852
800.343.1779

Bretford Ltd.
2 Etongate
110 Windsor Road, Slough
Berkshire SL1 2JA England
TEL: 011 44 17 5353 9955
FAX: 011 44 17 5353 9478

www.bretford.com

Part # 031-9262
Rev. 01 09.18.13 CG 11 of 11