

Motiv Seating Assembly Instructions

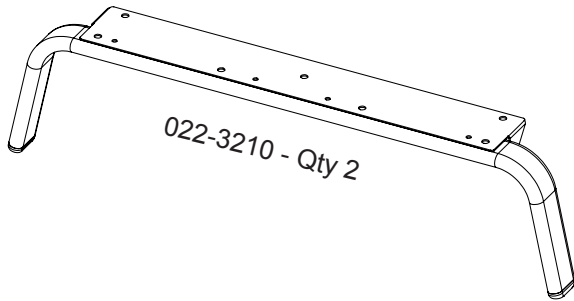

022-3210 - Qty 2

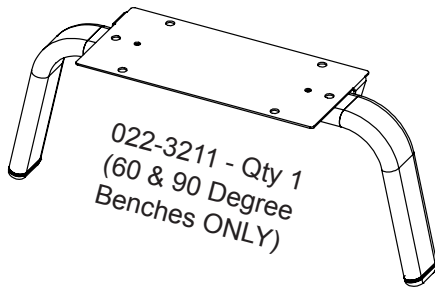

022-3211 - Qty 1
(60 & 90 Degree
Benches ONLY)

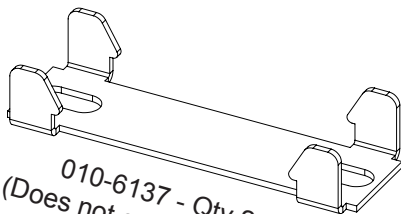

010-6137 - Qty 2
(Does not come with stand
alone products)

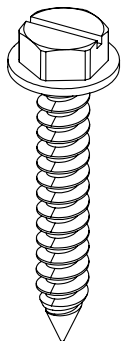

030-1634 - Qty 4
#14 x 1" L Slotted Hex Hd Screw

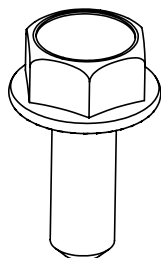

030-1424 - Qty 6 or 10*
5/16-18 x 3/4 Flange Screw
(*60 & 90 Degree Benches Qty 10)

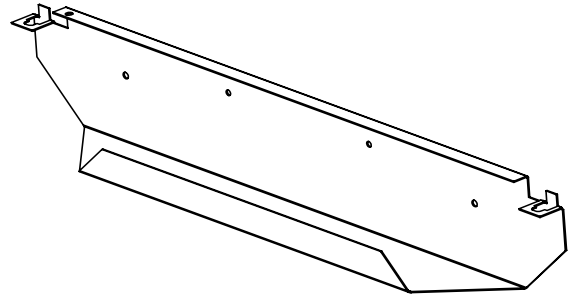

Wire Bin - Qty 1

(NOTE: Some Models May Not Come with a Wire Bin)

Part Number by Model

010-6188 = All "DB400" & "S300" Models
010-6189 = All "D560" Models
010-6190 = All "S350" Models
010-6191 = All "DB690" Models
010-6192 = All "DB660" Models
010-6193 = All "DB630" Models
010-9194 = All "DB600" & "L400" Models
010-6195 = All "C500" Models
010-6198 = All "L450" Models
010-6199 = All "C550" Models
010-6469 = All "H450" Models

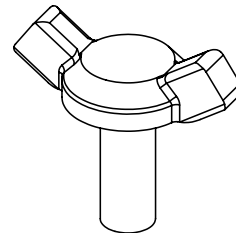

030-1179 - Qty 6 or 7*
1/4-20 x 1/2 Winghead Thumb Screw
(*60 & 90 Degree Benches Qty 7)

This hardware is ONLY for seating with power.

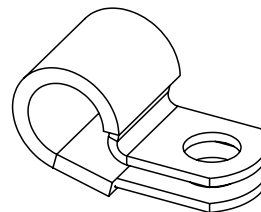

030-1404 - Qty 1 or 2*
3/8" Cable Clamp
(*Seating with 2 power - Qty 2)

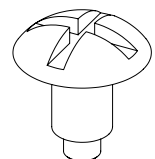

030-0325 - Qty 1 or 2*
1/4-20 x 1/2 Combo Screw
(*Seating with 2 power - Qty 2)

1

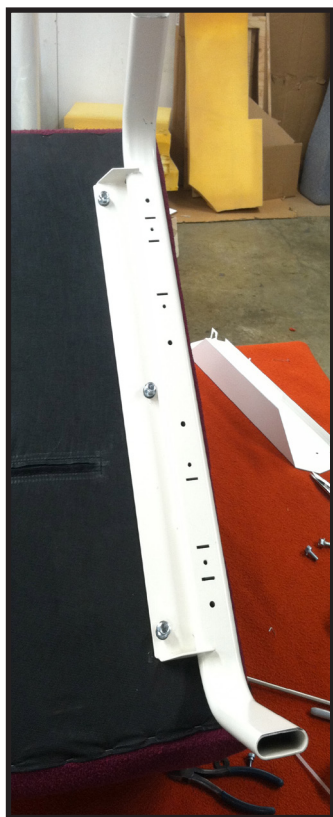

Install each leg with screws.
(For 60 & 90 degree bench models
you will install a third leg.)

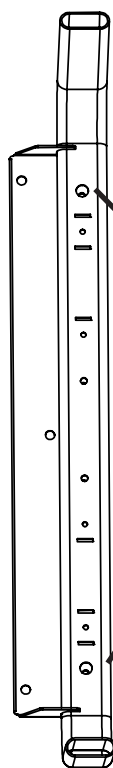
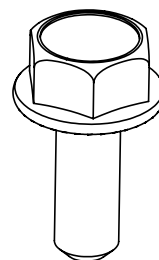

Two additional screws get installed
here. The outer legs only.

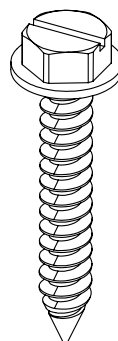

2

For Wire Bins Only

Bin should be located under zipper on power models.



Install wire bin with winghead screws. For models with power, make sure the bin is installed underneath zipper.

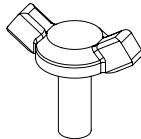

For 30, 60 & 90 degree bench models you will need to bend the wire bin on the scores. To insure the bin is bent in the correct dimension, lay the bin on a flat table surface. Over hang on side and bend the bin down on the side of the table.
NOTE: DO NOT Over Bend or Bend Back and Forth Repeatedly.

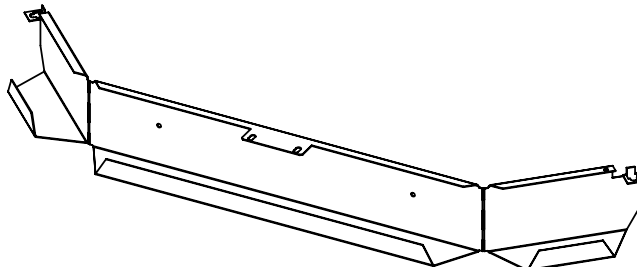

3

For Power Models Only

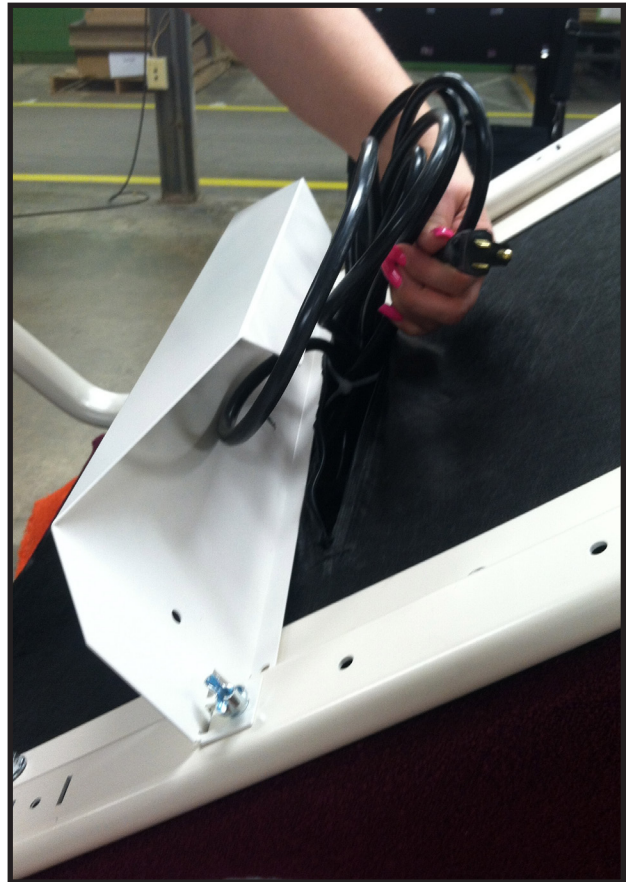

Unzip the zipper and pull the electrical cord out.

NOTE: For models having 2 power units, you will have 2 cords to pull out.

4

For Power Models Only

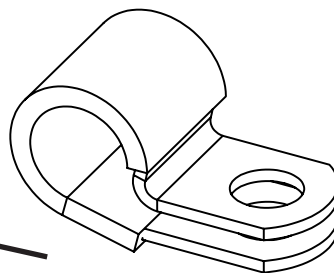

Slide cord clip on in this position.

Slide cord clip onto electrical cord in the position shown. Use screw to secure to wire bin through provided hole. **NOTE:** Install 2 clips for models having 2 power units using the holes on either side of the bin.



Ganging Product Together

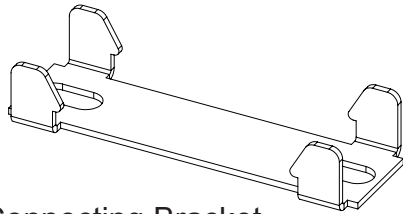

Connecting Bracket

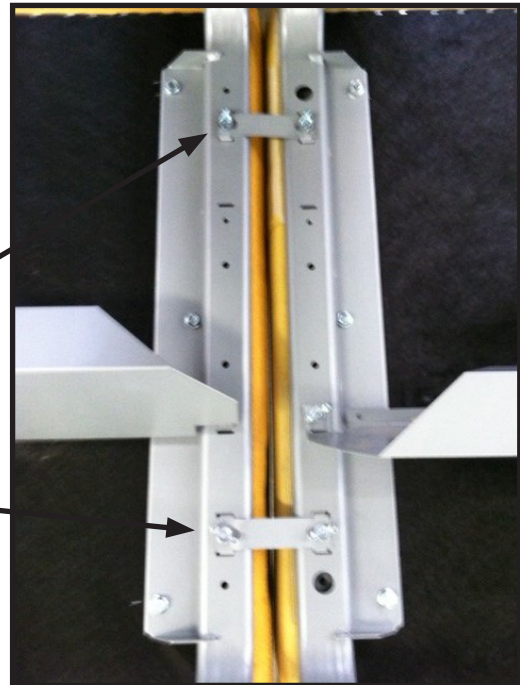
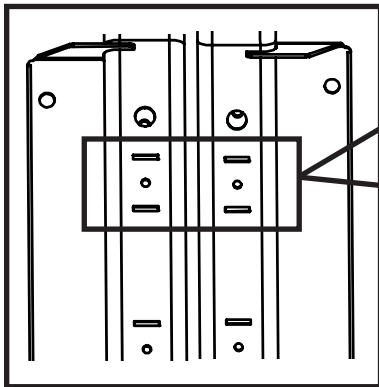

Align product next to each other. The connecting brackets are installed underneath the legs in the locations shown.

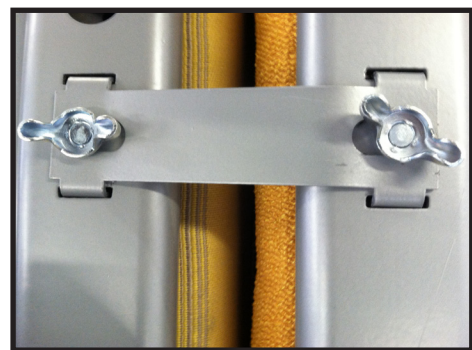
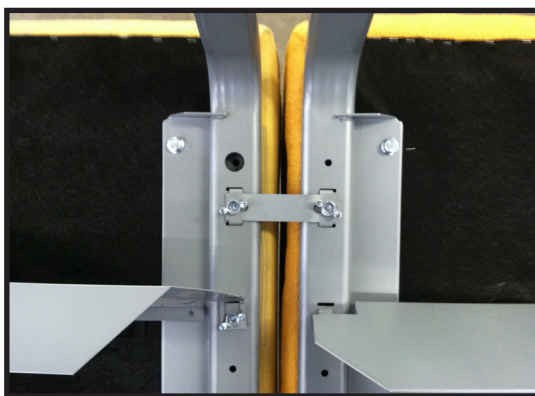

Use wing screws to attach brackets.

Daisy Chain Corner Benches

Installing Power Strip Unit (DPCF4)



The power strip mounts to the back wall of the wire bin.
Secure it in place with hardware provided.

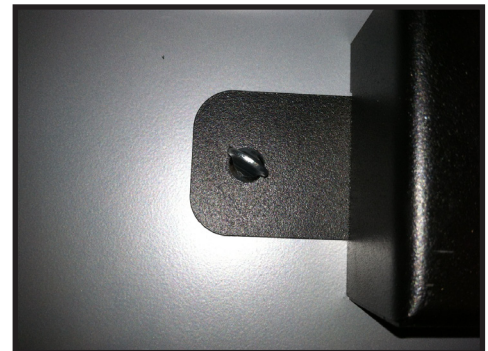

Bretford®
11000 Seymour Avenue
Franklin Park, IL 60131
TEL: 847.678.2545
800.521.9614
FAX: 847.678.0852
800.343.1779

Bretford Ltd.
2 Etongate
110 Windsor Road, Slough
Berkshire SL1 2JA England
TEL: 011 44 17 5353 9955
FAX: 011 44 17 5353 9478

www.bretford.com

Part # 031-9345
Rev. 02 09.18.13 CG

7 of 7