

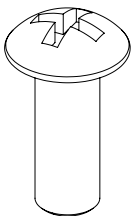

# Flip and Nest Tables Assembly Instructions

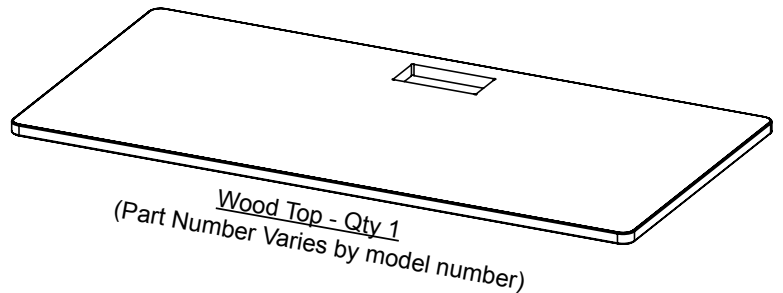

030-0402 - Qty 8 or 12\*  
#10-32 x 5/8" Combo Screw  
\*8 for Models w/EDUF Prefix  
12 for Models w/EDUFM & EDUFDP Prefix

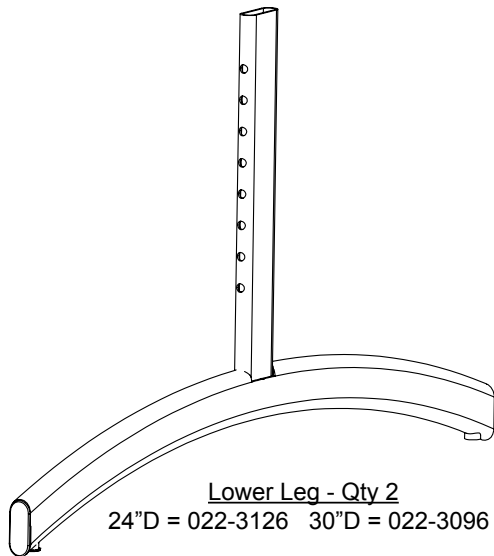
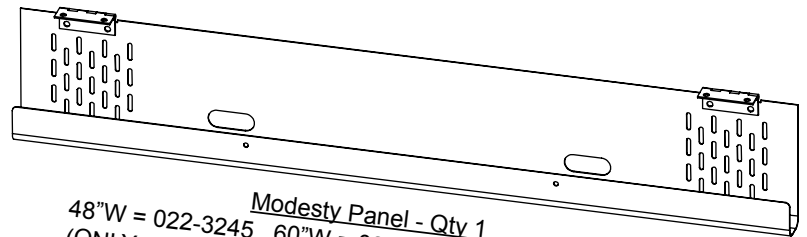
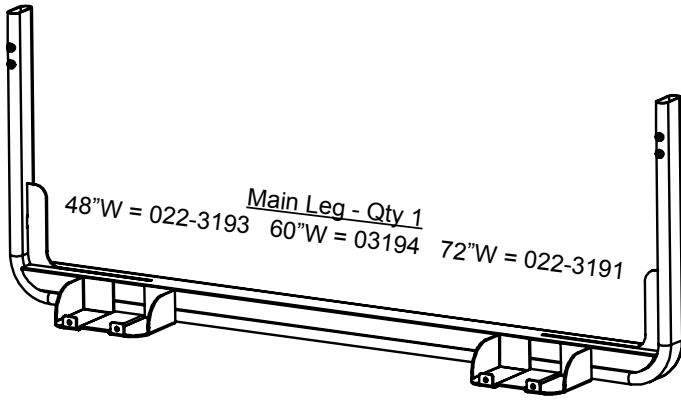
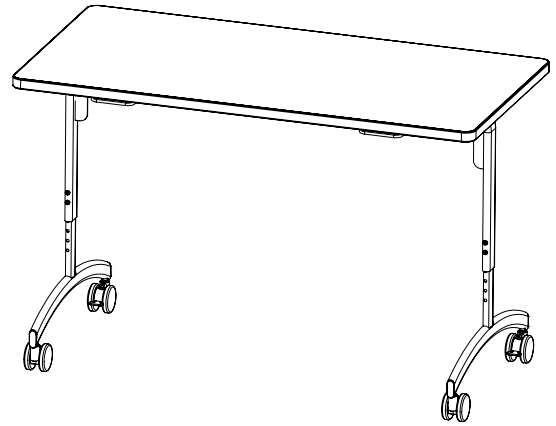
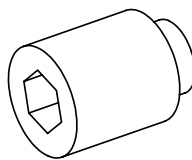

030-0396 - Qty 4  
3/8-16 x 1/2" Socket  
Set Screw

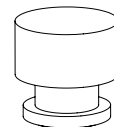

030-1646 - Qty 2  
Black Rubber Bumper

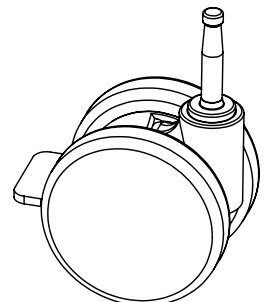

015-0175 - Qty 4  
2 1/2" Stem Caster  
w/Brake

# 1

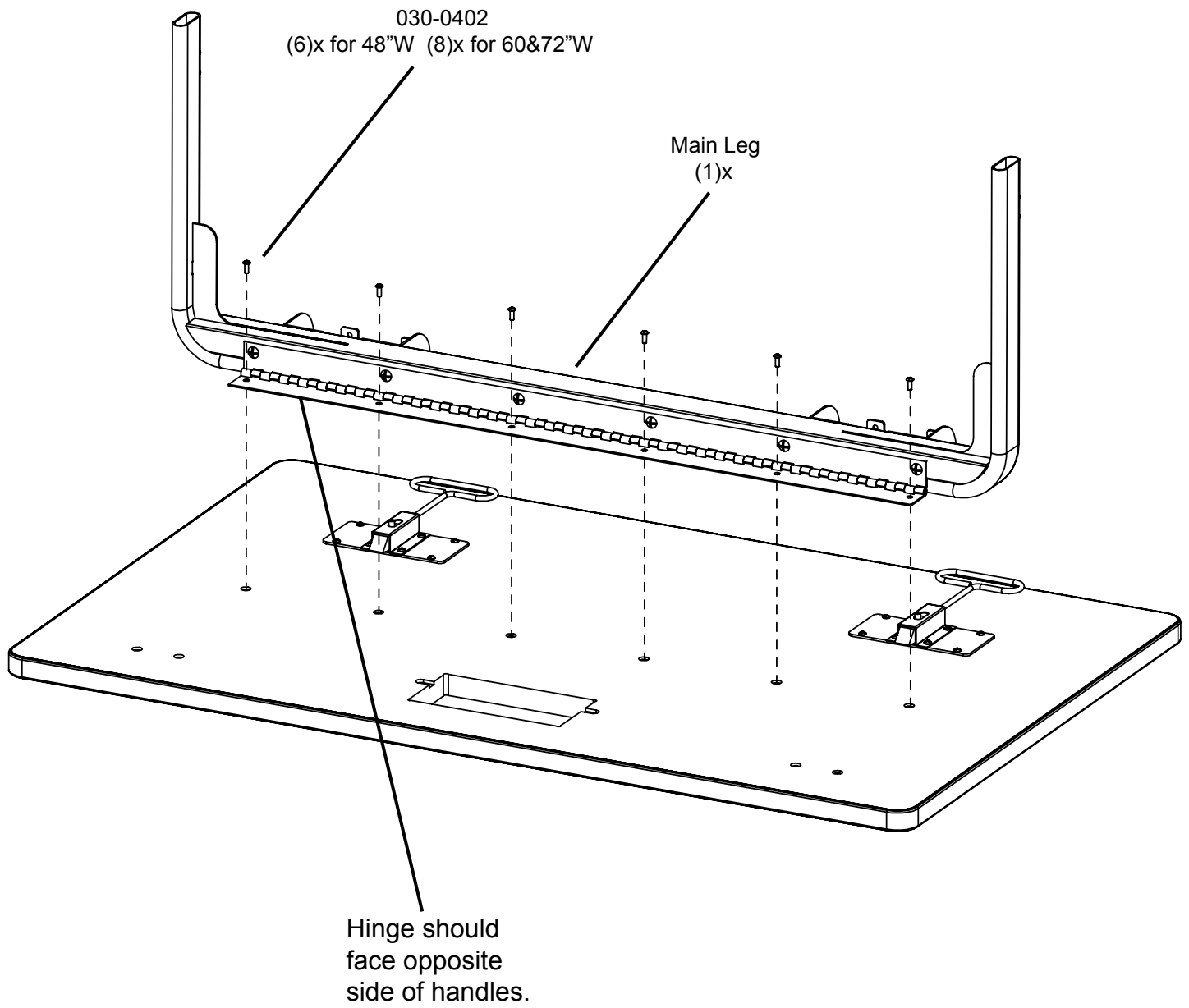

# 2

Models with prefix EDUFM & EDUFDP receive a modesty panel. Models with prefix EDUF do not. If your table does not come with a modesty panel, skip this step.

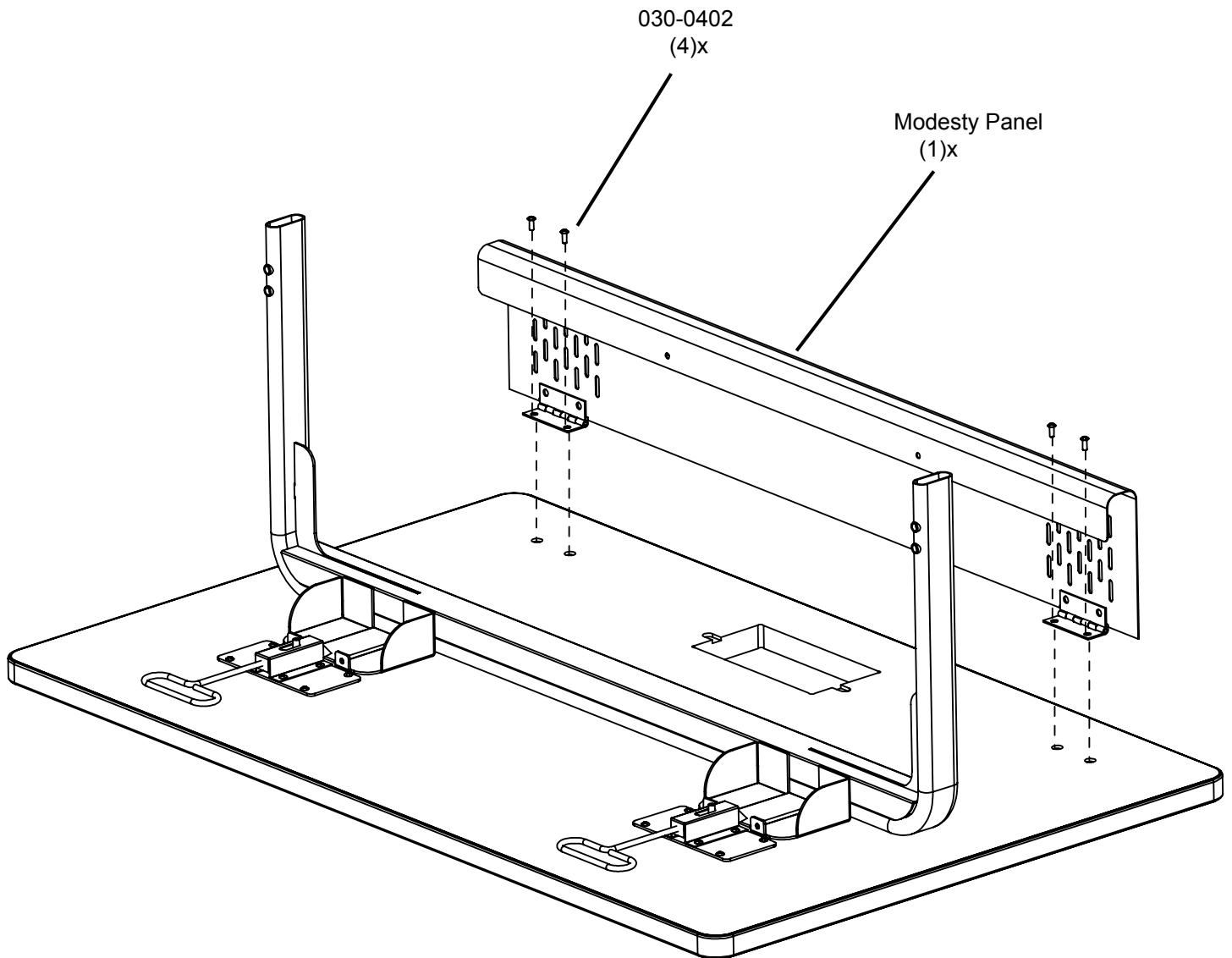

3

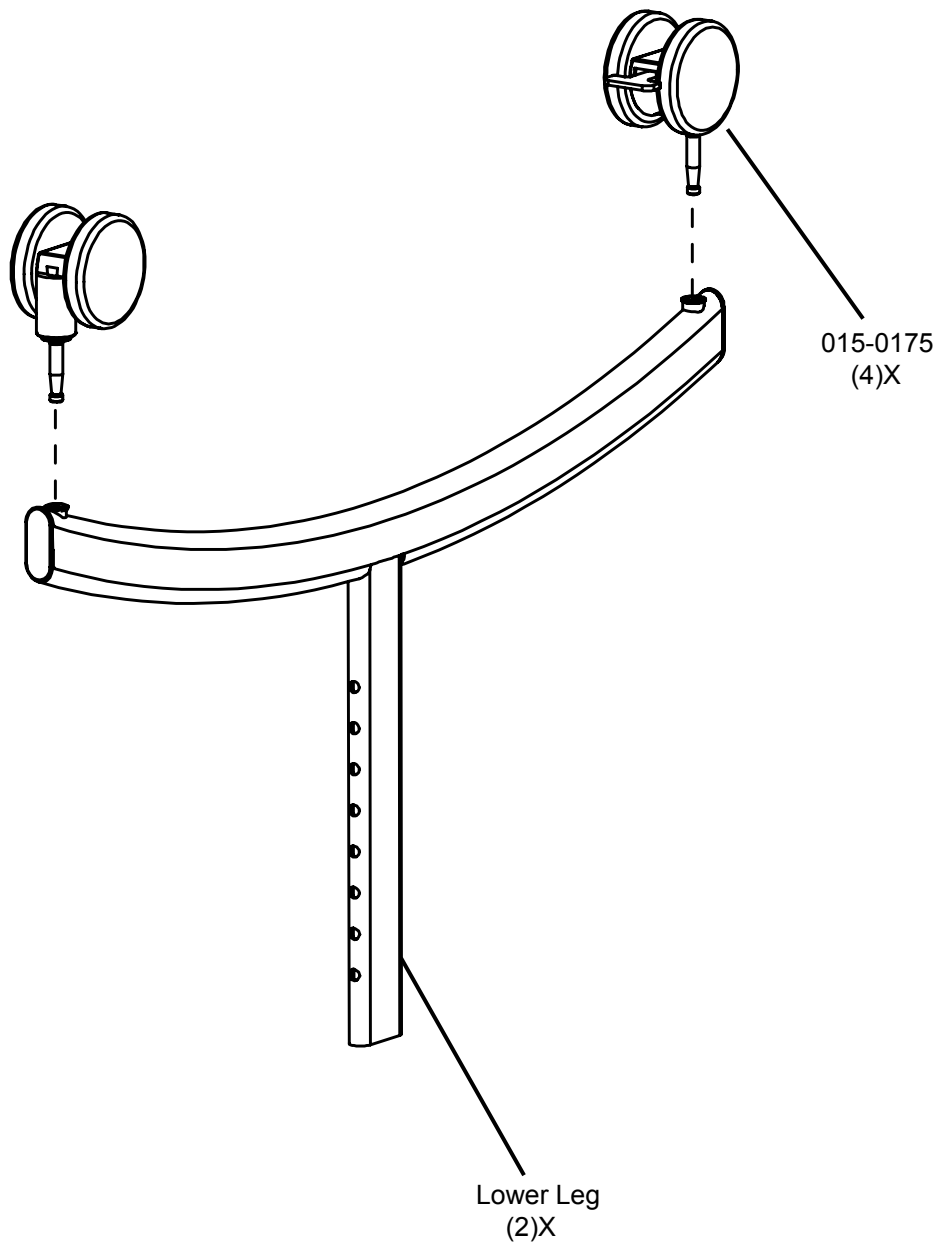

# 4

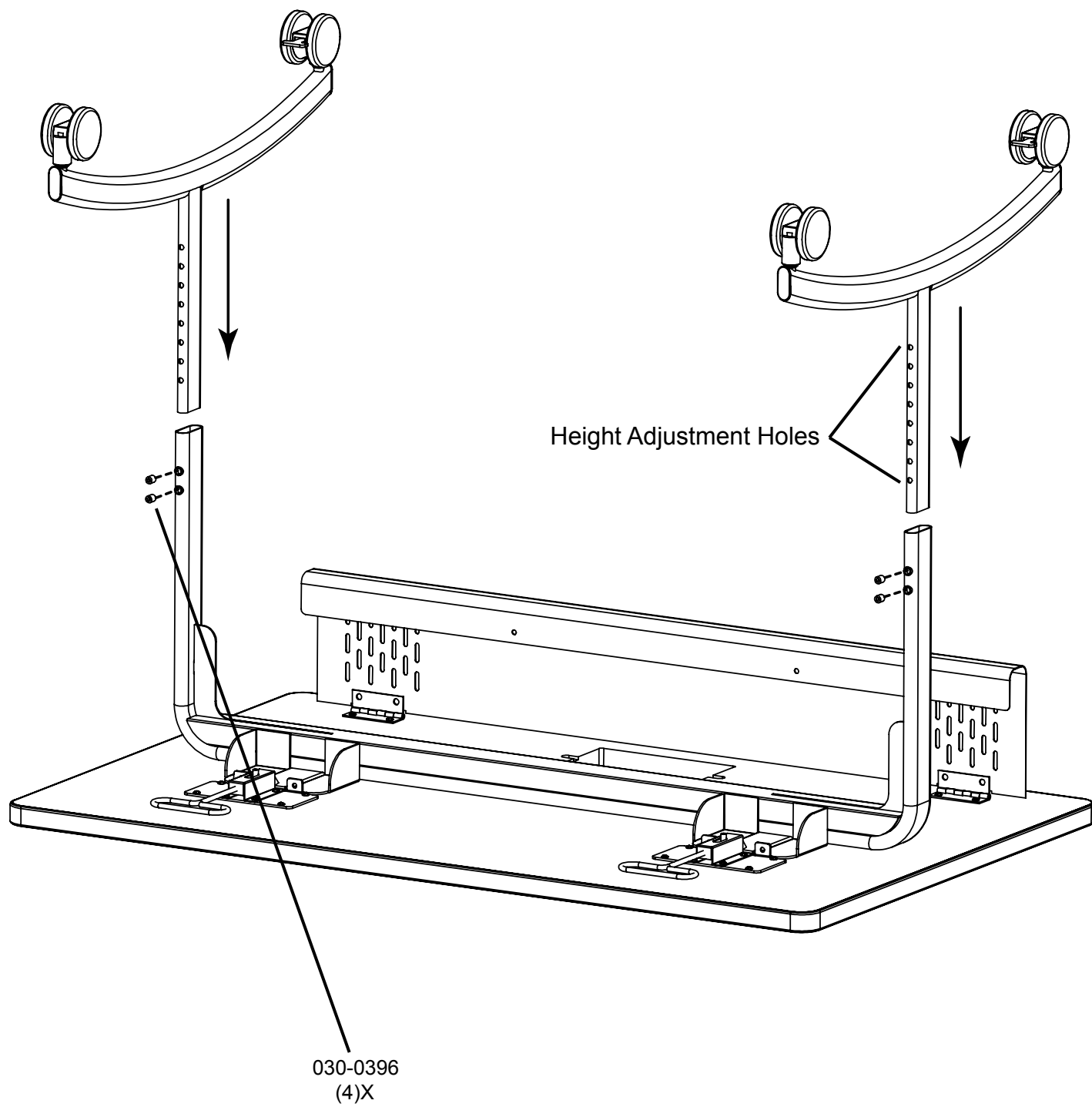

# 5

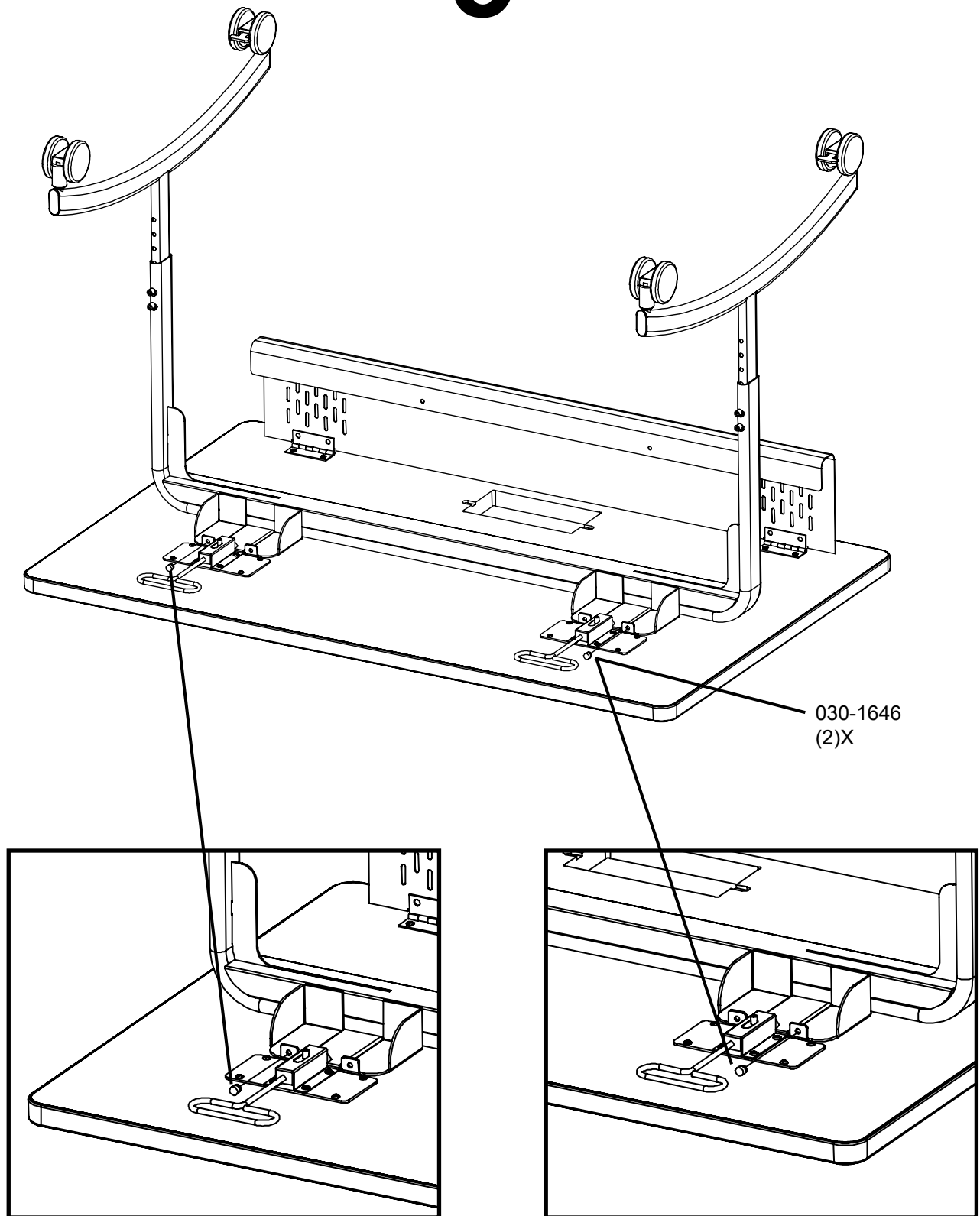

Install bumpers on the outer holes of the leg assembly as shown.

# Models Including Fluid Up Power Unit

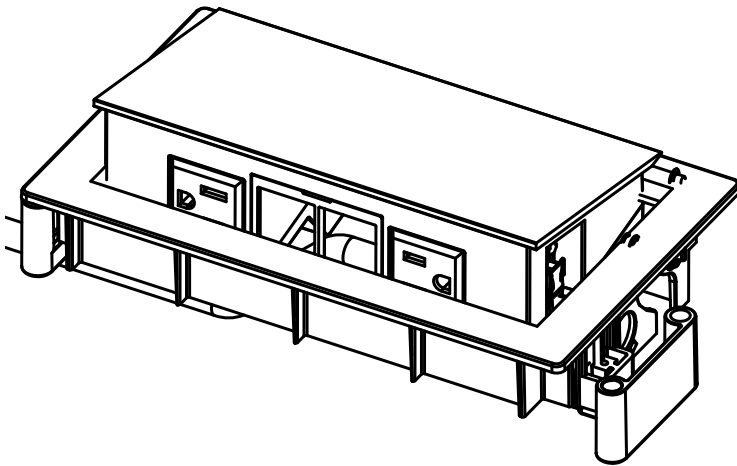

For desks including the Fluid Up Power Unit, mount the unit through the cut out and tighten from the underside using the thumb screws and locator slots. For further information, consult the assembly instructions supplied with the power unit.

## Flipping Table

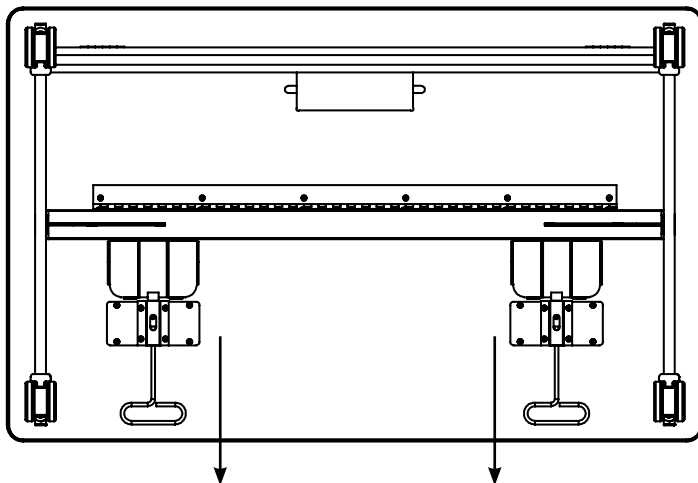

Pull handles forward to lift table.

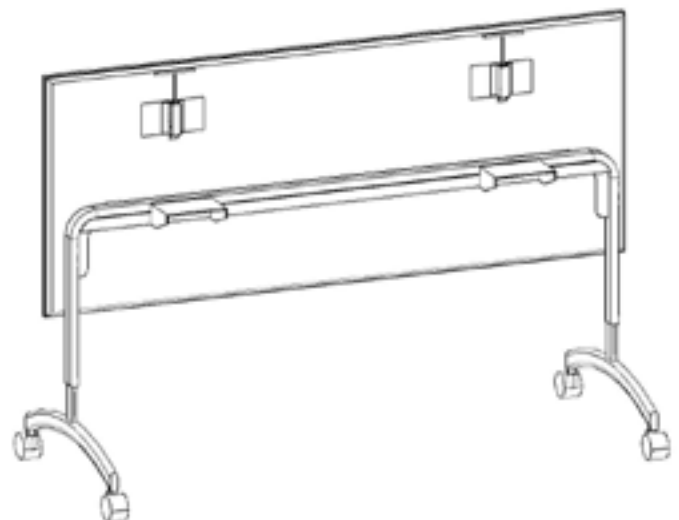

Bretford  
11000 Seymour Avenue  
Franklin Park, IL 60131  
TEL: 847.678.2545  
800.521.9514  
FAX: 847.678.0852  
800.343.1779

Bretford Ltd.  
2 Elongate  
110 Windsor Road, Slough  
Berkshire SL1 2JA England  
TEL: 011 44 17 5353 9955  
FAX: 011 44 17 5353 9476

[www.bretford.com](http://www.bretford.com)