

# Cardanic Systems

Gimbal Based Mounting Systems  
for SILL PRO Series Floodlights



# sillux®

Light. Ideas. Systems.



# Cardanic Systems

## Gimbal Ring Based Floodlight Modules



Modules w/square gimbal as shown are special order items, modular frame w/circular gimbals standard.

- Cardanic Systems offer unique mounting solutions for the PR020 and PR021 Floodlights
- Floodlights are mounted in gimbal rings in modular frames enabling highly flexible field-adjustable aiming angles
- Direct and indirect applications
- Available in standard suspended or pole mount configurations, or easily individually specify your own modular configurations.
- Pole Mast system suitable for free standing interior and exterior applications
- PR020C and PR021C floodlights are state-of-the art engineered compact floodlights, with fixture bodies and door frames cast of specially formulated high purity GD-ALSi12 aluminum
- PR020C, with a lens diameter approximately 7", accommodates from 35W to 100W H.I.D. or Halogen lamps, and can be configured with one of 12 beam patterns
- PR021C, with a lens diameter of approximately 12", accommodates from 50W to 150W H.I.D. or Halogen lamps, and can be configured with one of 8 beam patterns
- Perfect solution for historical buildings, museums, lobbies, theatres, malls, entertainment/sports complexes, etc.
- Cardanic Systems carry an overall IP65 rating



# Cardanic Systems

## Pole Mast Configurations

### P2D - PR020C

Pole Mast System for (2) PR020 Floodlights

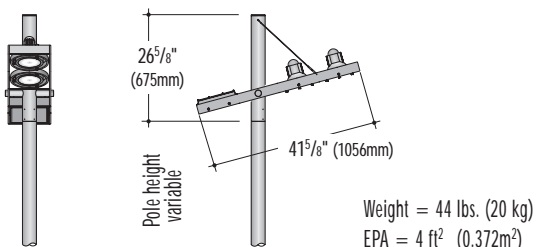

### P3D - PR020C

Pole Mast System for (3) PR020 Floodlights

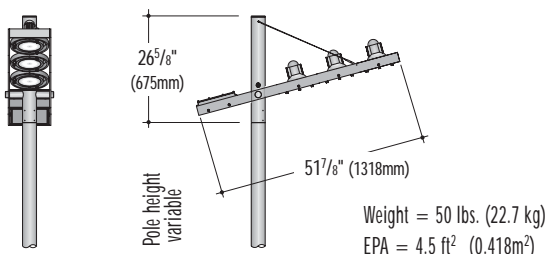

### P2D - PR021C

Pole Mast System for (2) PR021 Floodlights

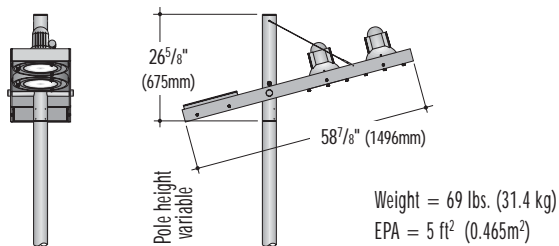

### P3D - PR021C

Pole Mast System for (3) PR021 Floodlights

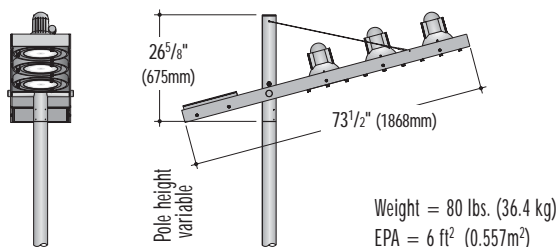

Suspension cable lengths field adjustable +/- 2 inches. All poles shown with Cardanic Frame assembly tilted 15° upwards (standard), for other tilt options consult factory for details.



# Cardanic Systems - Specify Standard Configurations





## Standard Configuration

## Fixture Series

## Beam Pattern

## Lamp Type/ Wattage

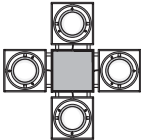
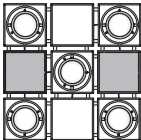
## Lamp Color

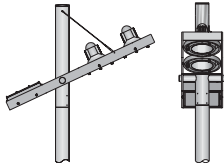
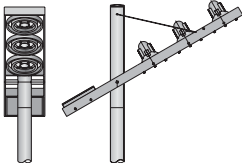
Standard Configurations	Fixture Series	Beam Pattern	Lamp Type/Wattage	Lamp Color	
 <b>C4I</b> 4 Fixture Suspended Cross - Indirect  <b>C4D</b> 4 Fixture Suspended Cross - Direct	<b>PRO20C</b>  Projector Floodlight PRO20 fitted for Cardanic Systems	<b>SN</b> Narrow Spot <b>SM</b> Medium Spot <b>FN</b> Narrow Flood <b>FM</b> Medium Flood <b>HN</b> Horizontal Narrow <b>HM</b> Horizontal Medium <b>VN</b> Vertical Narrow <b>VM</b> Vertical Medium	<u>Ceramic Metal Halide</u> <b>H035T6</b> 35W T6 G12 <b>H070T6</b> 70W T6 G12	<b>830</b> 3000°K <b>NOL</b> Lamp not included	
 <b>S5I</b> 5 Fixture Suspended Square - Indirect <b>S5D</b> 5 Fixture Suspended Square - Direct		<b>SP</b> 10° Spot <b>WS</b> 12° Spot <b>FL</b> 25° Spot	<u>Halogen PAR Lamp</u> <b>060PAR38<sup>1</sup></b> 60W PAR38 <b>080PAR38<sup>1</sup></b> 80W PAR38	Lamp Color not applicable <b>NOL</b> Lamp not included	
		<b>SP</b> 15° Spot <b>FL</b> 25° Spot <b>WF</b> 60° Wide Flood	<u>Ceramic Metal Halide PAR Lamp</u> <b>070PAR38</b> 70W PAR38 <b>100PAR38</b> 100W PAR38	<b>830</b> 3000°K <b>NOL</b> Lamp not included	
		 <b>R2I</b> 2 Fixture Suspended - Indirect <b>R2D</b> 2 Fixture Suspended - Direct	<b>PRO21C</b>  Projector Floodlight PRO21 fitted for Cardanic Systems	<u>Ceramic Metal Halide</u> <b>H150T6</b> 150W T6 G12	<b>830</b> 3000°K (clear lamp) <b>NOL</b> Lamp not included
<b>HC050</b> 50W Medium Base <b>HC070</b> 70W Medium Base <b>HC100</b> 100W Medium Base <b>HC150</b> 150W Medium Base				<b>830</b> 3000°K (clear lamp) <b>C830</b> 3000°K (coated lamp) <b>NOL</b> Lamp not included	
<u>Metal Halide</u> <b>H050</b> 50W Medium Base <b>H070</b> 70W Medium Base <b>H100</b> 100W Medium Base <b>H150</b> 150W Medium Base		<b>730</b> 3000°K (clear lamp) <b>C729</b> 2900°K (coated lamp) <b>NOL</b> Lamp not included			
<u>High Pressure Sodium</u> <b>S070</b> 70W Medium Base <b>S100</b> 100W Medium Base <b>S150</b> 150W Medium Base		Lamp Color not applicable (ranges 1900°K to 2200°K) <b>NOL</b> Lamp not included			
<u>Quartz Halogen</u> <b>Q100M</b> 100W T10 Medium Base <b>Q150M</b> 150W T10 Medium Base		Lamp Color Not Applicable <b>NOL</b> Lamp not included			
 <b>P3D</b> 3 Fixture Pole Mount - Direct <b>P3I</b> 3 Fixture Pole Mount - Indirect					

<sup>1</sup>120V only    <sup>2</sup>PRO20 w/Quartz Halogen only    <sup>3</sup>All lamp types not available for 347V, consult factory for details.

<sup>1</sup>120V only    <sup>2</sup>PRO20 w/Quartz Halogen only    <sup>3</sup>All lamp types not available for 347V, consult factory for details.

## Finish

## Voltage

## Lens Accessories

## Options

Finish	Voltage	Lens Accessories	Options
<b>WH</b> White <b>BK</b> Black <b>BZ</b> Bronze <b>SV</b> Silver <b>SP</b> Specify RAL#	<b>12V<sup>2</sup></b> <b>120</b> <b>277</b> <b>347<sup>3</sup></b>	<b>FG</b> Flush Glass <b>LR</b> Colored Red <b>LG</b> Colored Green <b>LB</b> Colored Blue <b>LY</b> Colored Yellow <b>RL</b> Ring Louver Internal <b>DF</b> Dichroic Filter (consult factory for details)	<b>RLX</b> Ring Louver External <b>S18</b> Snoot 180° <b>S36</b> Snoot 360° <b>WG</b> Wire Guard <b>SLR</b> Field Rotatable Spread Lens  NOTE: RLX, S18, S36 and WG options may not be combined with each other. Consult factory for custom shielding options.

### PRO20C -101 Modular Frame w/Circular Gimbal (Fixture Module for Direct or Indirect applications)

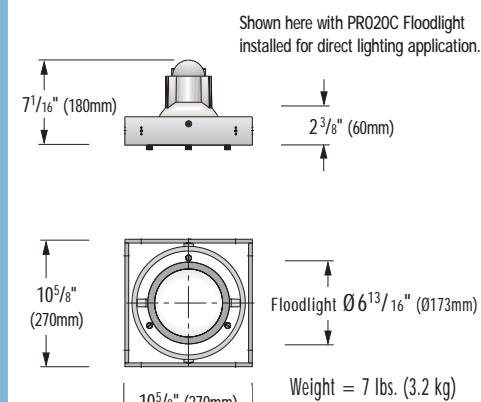

### PRO20C -130 Ballast Module (Holds up to 4 x 100W electronic ballasts)

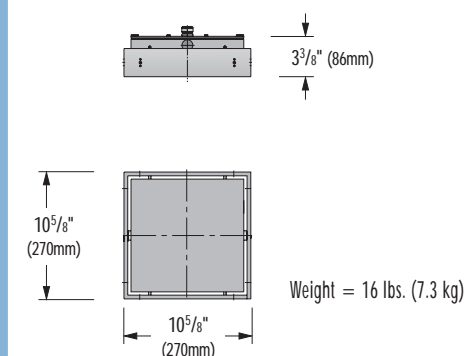

### PRO21C -101 Modular Frame w/Circular Gimbal (Fixture Module for Direct or Indirect applications)

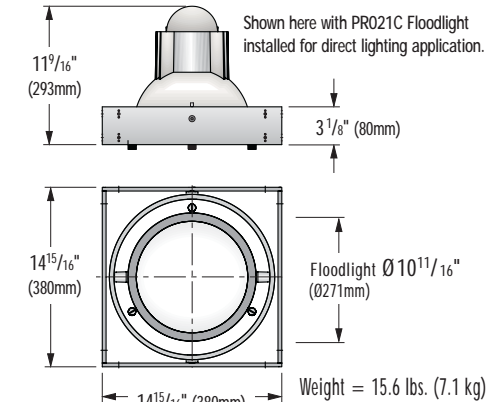

### PRO21C -130 Ballast Module (Holds up to 4 x 150W electronic ballasts)

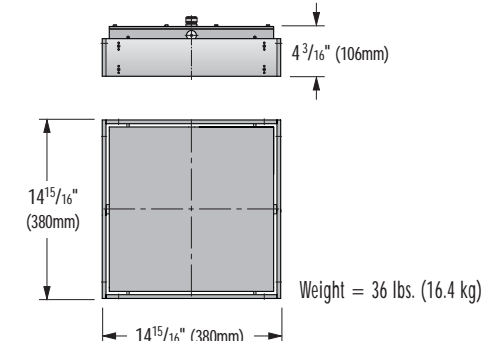

### All Cardanic Fixture Frames Range of Aiming Angles

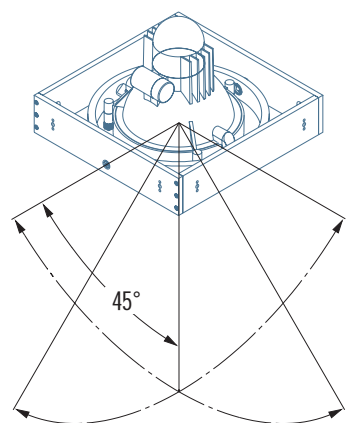

### Intermediate Connectors (same size for both PRO20C/PRO21C)

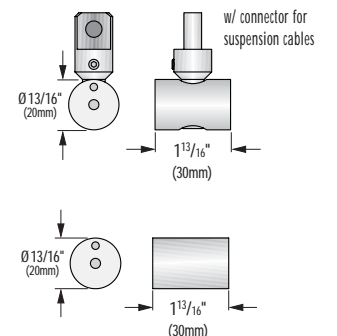





# Suspended Modular Components

A.	PR020C/PR021C	PR020/PR021 Floodlight fitted for mounting with Cardanic Systems
B.	PR020/PR021 101 00	Frame w/Circular Gimbal (Fixture Module)
C.	PR020/PR021 102 00	Frame w/Square Gimbal* (Fixture Module)
D.	PR020/PR021 130	Frame for up to four electronic ballasts (Ballast Module)
E.	PR020/PR021 110 00	Intermediate connector
F.	PR020/PR021 111 00	Intermediate connector for steel cable mounting
G.	PR020/PR021 115 00	Decorative End connector*
H.	PR020/PR021 116 00	End connector for steel cable mounting*
I.	PR020/PR021 120 00	Cable suspension for surface mounting
	PR020/PR021 100 00 (not shown)	Empty frame for spacing

\*Modular frame w/square gimbal and end connectors are special order items, consult factory for details

Cardanic Systems modular components can be individually configured for any space.

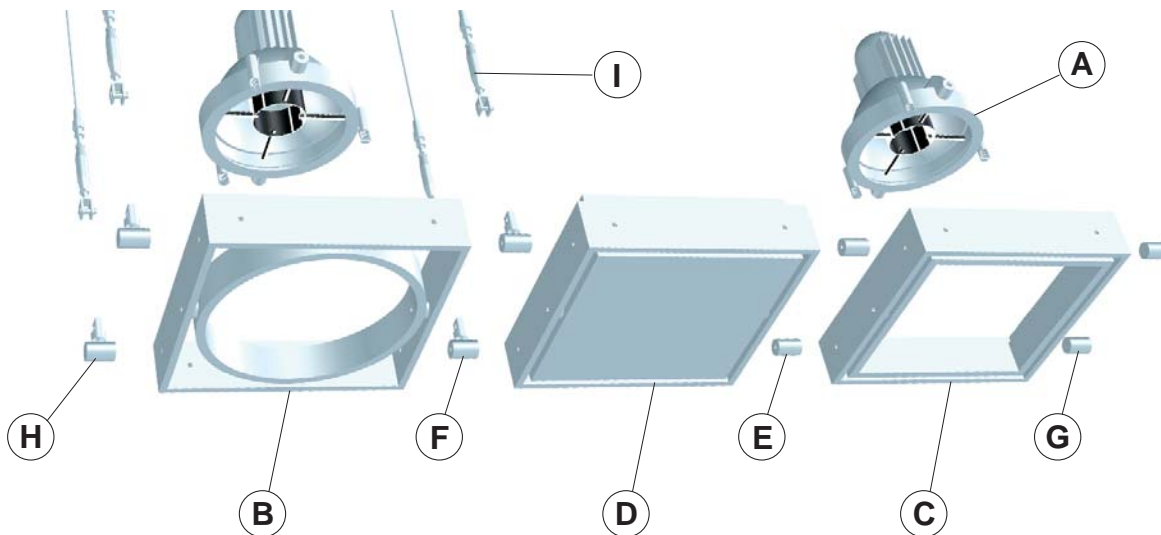

Refer to the PR020C/PR021C spec sheets for more details. Consult factory for assistance.



# Individual Modular Specification for Suspended Configurations



<b>Position: A1</b> <input type="checkbox"/> <b>Fixture Module</b> Specify fixture: PR02_C - _____ - _____ - _____ - _____ _____ - _____ - _____ - _____ Specify fixture orientation: <input type="checkbox"/> <b>Direct Application</b> <input type="checkbox"/> <b>Indirect Application</b> <hr/> <input type="checkbox"/> <b>Ballast Module</b> <hr/> <input type="checkbox"/> <b>Empty Frame</b>	<b>Position: B1</b> <input type="checkbox"/> <b>Fixture Module</b> Specify fixture: PR02_C - _____ - _____ - _____ - _____ _____ - _____ - _____ - _____ Specify fixture orientation: <input type="checkbox"/> <b>Direct Application</b> <input type="checkbox"/> <b>Indirect Application</b> <hr/> <input type="checkbox"/> <b>Ballast Module</b> <hr/> <input type="checkbox"/> <b>Empty Frame</b>	<b>Position: C1</b> <input type="checkbox"/> <b>Fixture Module</b> Specify fixture: PR02_C - _____ - _____ - _____ - _____ _____ - _____ - _____ - _____ Specify fixture orientation: <input type="checkbox"/> <b>Direct Application</b> <input type="checkbox"/> <b>Indirect Application</b> <hr/> <input type="checkbox"/> <b>Ballast Module</b> <hr/> <input type="checkbox"/> <b>Empty Frame</b>
Bottom View		
<b>Position: A2</b> <input type="checkbox"/> <b>Fixture Module</b> Specify fixture: PR02_C - _____ - _____ - _____ - _____ _____ - _____ - _____ - _____ Specify fixture orientation: <input type="checkbox"/> <b>Direct Application</b> <input type="checkbox"/> <b>Indirect Application</b> <hr/> <input type="checkbox"/> <b>Ballast Module</b> <hr/> <input type="checkbox"/> <b>Empty Frame</b>	<b>Position: B2</b> <input type="checkbox"/> <b>Fixture Module</b> Specify fixture: PR02_C - _____ - _____ - _____ - _____ _____ - _____ - _____ - _____ Specify fixture orientation: <input type="checkbox"/> <b>Direct Application</b> <input type="checkbox"/> <b>Indirect Application</b> <hr/> <input type="checkbox"/> <b>Ballast Module</b> <hr/> <input type="checkbox"/> <b>Empty Frame</b>	<b>Position: C2</b> <input type="checkbox"/> <b>Fixture Module</b> Specify fixture: PR02_C - _____ - _____ - _____ - _____ _____ - _____ - _____ - _____ Specify fixture orientation: <input type="checkbox"/> <b>Direct Application</b> <input type="checkbox"/> <b>Indirect Application</b> <hr/> <input type="checkbox"/> <b>Ballast Module</b> <hr/> <input type="checkbox"/> <b>Empty Frame</b>
Bottom View		
<b>Position: A3</b> <input type="checkbox"/> <b>Fixture Module</b> Specify fixture: PR02_C - _____ - _____ - _____ - _____ _____ - _____ - _____ - _____ Specify fixture orientation: <input type="checkbox"/> <b>Direct Application</b> <input type="checkbox"/> <b>Indirect Application</b> <hr/> <input type="checkbox"/> <b>Ballast Module</b> <hr/> <input type="checkbox"/> <b>Empty Frame</b>	<b>Position: B3</b> <input type="checkbox"/> <b>Fixture Module</b> Specify fixture: PR02_C - _____ - _____ - _____ - _____ _____ - _____ - _____ - _____ Specify fixture orientation: <input type="checkbox"/> <b>Direct Application</b> <input type="checkbox"/> <b>Indirect Application</b> <hr/> <input type="checkbox"/> <b>Ballast Module</b> <hr/> <input type="checkbox"/> <b>Empty Frame</b>	<b>Position: C3</b> <input type="checkbox"/> <b>Fixture Module</b> Specify fixture: PR02_C - _____ - _____ - _____ - _____ _____ - _____ - _____ - _____ Specify fixture orientation: <input type="checkbox"/> <b>Direct Application</b> <input type="checkbox"/> <b>Indirect Application</b> <hr/> <input type="checkbox"/> <b>Ballast Module</b> <hr/> <input type="checkbox"/> <b>Empty Frame</b>
Bottom View		

Each position block represents one location, as viewed from below, of a potential 9 unit square configuration. Use any combination of contiguous position blocks. In each position of desired configuration, use check boxes to designate either Fixture Module, Ballast Module or Empty Frame. Halogen PAR 38 lamp fixtures do not require ballast boxes; for all other fixtures specify one Ballast Module for every four fixtures maximum. SELUX engineering will determine suspension locations. Consult factory with any questions or help in specifying your own Modular Cardanic Systems configuration.



## LIGHT

Artificial light is perhaps the most fundamental requirement of modern civilization. For over fifty years, SELUX has been a leader in the development of advanced lighting products that have helped transform light from a mundane necessity into a vital, vibrant architectural and design element.

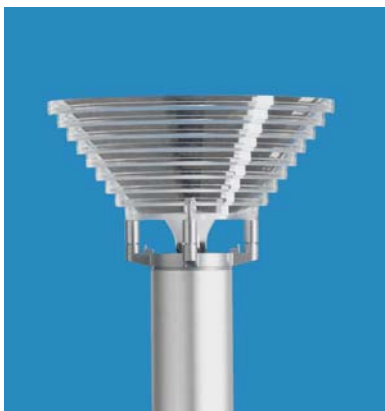

## IDEAS

As multinational companies SELUX and SILL call upon the talents of engineers and designers in both the US and Europe to deliver the most innovative concepts in lighting design. And in our New York facility, we back up this global perspective with the strength of American technology and manufacturing capability.



## SYSTEMS

At SELUX we believe in a systems approach. Each design features a variety of mounting configurations and reflector options. This system-oriented flexibility allows for a tremendous variety of visual and photometric effects.



## SELUX Corporation

5 Lumen Lane,  
P.O. Box 1060,  
Highland, NY 12528  
800/735-8927 • 845/691-7723  
Fax 845/691-6749  
seluxus@selux.com  
www.selux.com/usa

**se'lux**

Light. Ideas. Systems.

## A COMMITMENT TO SERVICE

SELUX is committed to the highest standard of customer service. Our engineers will preview and check preliminary layouts and design parameters and suggest various configurations supported by detailed mechanical and photometric specifications. Our customer service specialists will assist you in ordering and expediting your order every step of the way until delivery.



Berlin • Bern • London • Lyon • Milan • New York • Stockholm • Sydney • Vienna • Madrid

